

TOP "B" BARS SHOWN IN CLOSURE POUR. FOR OTHER REINFORCING IN THE CLOSURE POUR, SEE CLOSURE POUR DETAIL. (STAGE 2)

END BENT 1 DIAPHRAGM DETAILS

- EB1-1 2-#8 K11 (OVER EXT. GDR.) (4'-9" MIN. SPLICE)
- EB1-2 2-#8 K12 (OVER EA. INT. GDR.) (4'-9" MIN. SPLICE)
- EB1-3 2-#8 K13 (OVER GDR. 6) (4'-9" MIN. SPLICE)
- EB1-4 3-#6 K14 (TYP. EA. BAY)
- EB1-5 8-#4 S1 AND 8-#5 S2 AT 1'-0" CTS. (TYP. EA. BAY)

BENT 1 DIAPHRAGM DETAILS

- BI-1 2-#4 U1, 5-#4 U2 AT 1'-0" CTS. (TYP. EA. BAY)
- BI-2 1-#4 K17, 2-#4 K18 & 2-#4 K19 (TYP. EA. FACE) (TYP. EA. BAY)
- BI-3 5-#4 K15 BETWEEN GDRS. (TYP. EXT. GDRS.)
- BI-4 5-#4 K16 BETWEEN GDRS. (TYP. INT. GDRS.)

END BENT 2 DIAPHRAGM DETAILS

- EB2-1 2-#8 K11 (OVER EXT. GDR.) (4'-9" MIN. SPLICE)
- EB2-2 2-#8 K12 (OVER EA. INT. GDR.) (4'-9" MIN. SPLICE)
- EB2-3 2-#8 K13 (OVER GDR. 6) (4'-9" MIN. SPLICE)
- EB2-4 3-#6 K14 (TYP. EA. BAY)
- EB2-5 8-#4 S1 AND 8-#5 S2 AT 1'-0" CTS. (TYP. EA. BAY)

SLAB REINFORCING

- 40-#4 B1 @ 1'-2" CTS. (TOP OF SLAB) (2 BAR RUN)
- 40-#6 B2 @ 1'-2" CTS. (TOP OF SLAB) **
- 40-#6 B3 @ 1'-2" CTS. (TOP OF SLAB) **
- 39-#6 B4 @ 1'-2" CTS. (TOP OF SLAB)

CLOSURE POUR REINFORCING

- CP-1 6-#4 B1 @ 1'-2" CTS. (TOP OF SLAB) (2 BAR RUN)
- CP-2 6-#6 B2 @ 1'-2" CTS. (TOP OF SLAB) **
- CP-3 6-#6 B3 @ 1'-2" CTS. (TOP OF SLAB) **
- CP-4 5-#6 B4 @ 1'-2" CTS. (TOP OF SLAB)

PROJECT NO. I-5972
 JOHNSTON COUNTY
 STATION: 36+93.50 -Y1-

SHEET 2 OF 2

STATE OF NORTH CAROLINA
 DEPARTMENT OF TRANSPORTATION
 RALEIGH

SUPERSTRUCTURE
 PLAN OF SPANS
 SPANS A AND B
 STAGE 2

REVISIONS

NO.	BY:	DATE:	NO.	BY:	DATE:
1			3		
2			4		

SHEET NO. **S-12**
 TOTAL SHEETS **54**

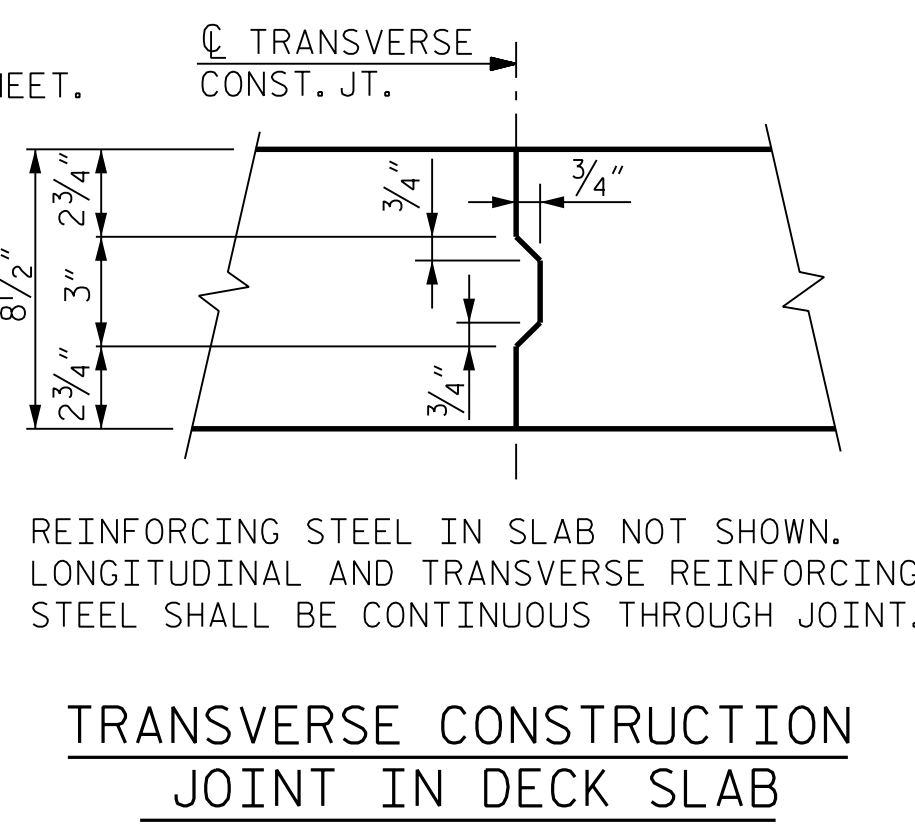
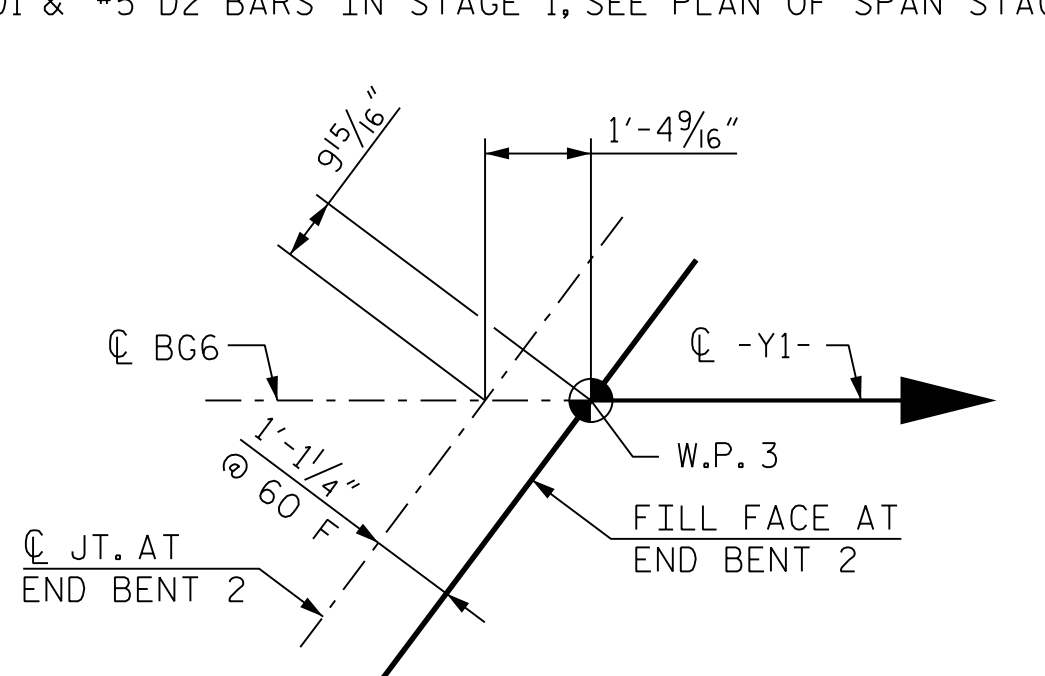
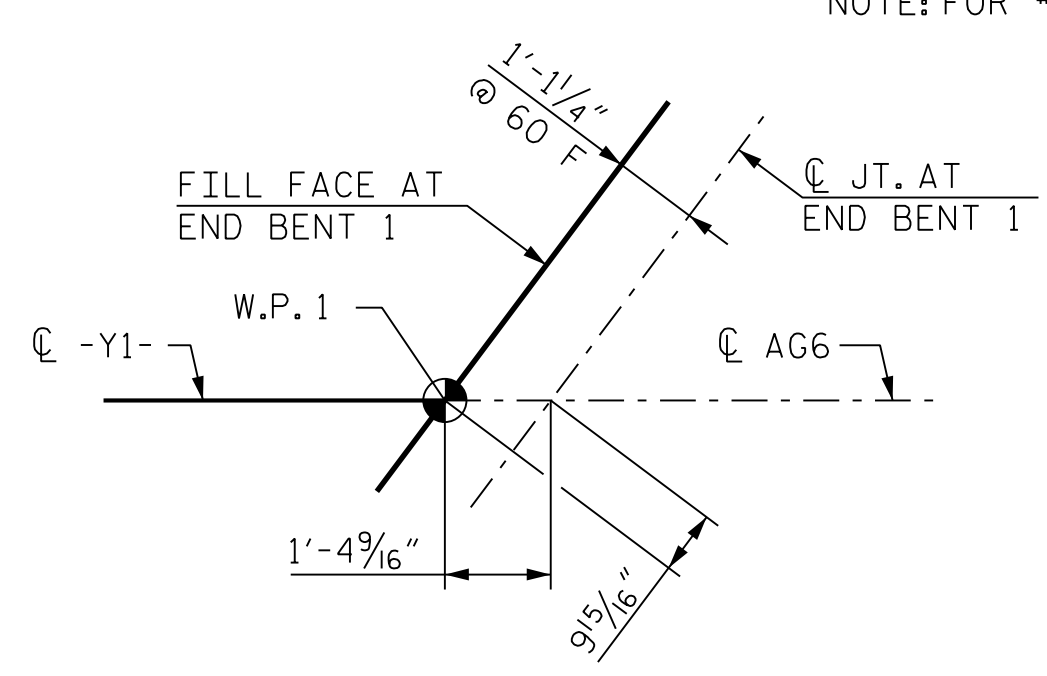
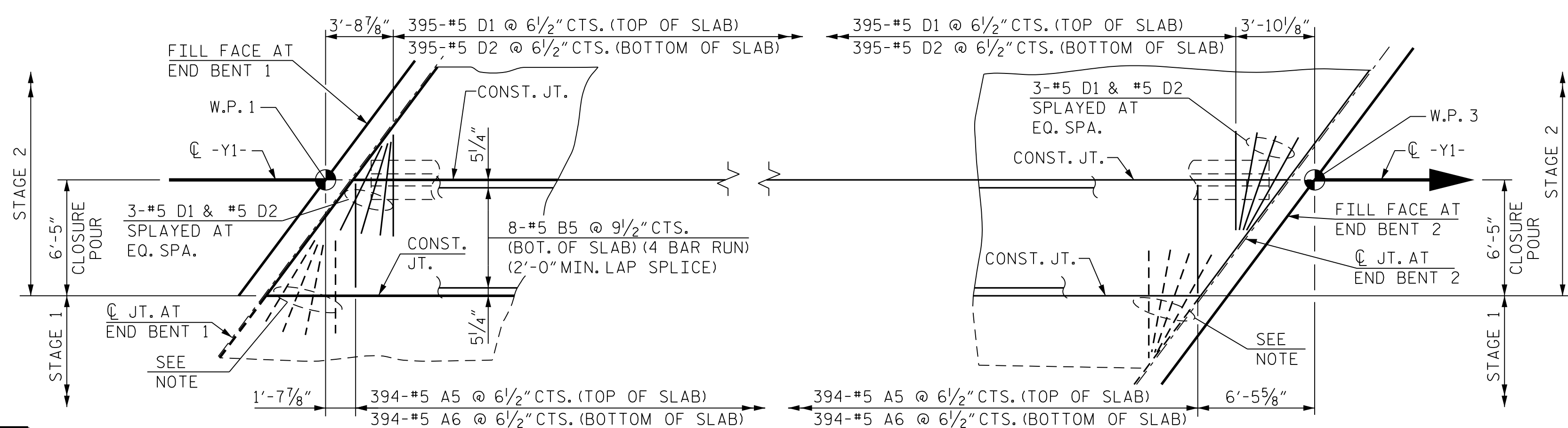

RK&K
 P: (919) 878-9560
 8601 Six Forks Road, Forum 1 Suite 700
 Raleigh, North Carolina 27615 | NC License No. F-0112

Engineers | Construction Managers | Planners | Scientists
 www.rk.com

10/4/2021

RESPONSIVE PEOPLE | CREATIVE SOLUTIONS

DOCUMENT NOT CONSIDERED FINAL UNLESS ALL SIGNATURES COMPLETED

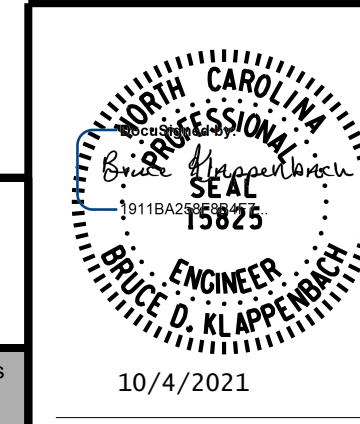

R:\Structures\DON\BR_500066\Final\I5972_SMU_S2_500066.dgn
 10/4/2021 10:44:20 AM
 bhag

DRAWN BY: B. A. HAAG DATE: JUN 2021
 CHECKED BY: B. D. KLAPPENBACH DATE: JUN 2021
 DESIGN ENGINEER OF RECORD: B. D. KLAPPENBACH DATE: JUN 2021