

UTILITIES BY OTHERS

ALL PROPOSED UTILITY WORK SHOWN ON THIS SHEET WILL BE DONE BY OTHERS. NO PAYMENT WILL BE MADE TO THE CONTRACTOR FOR PROPOSED UTILITY WORK SHOWN ON THIS SHEET.

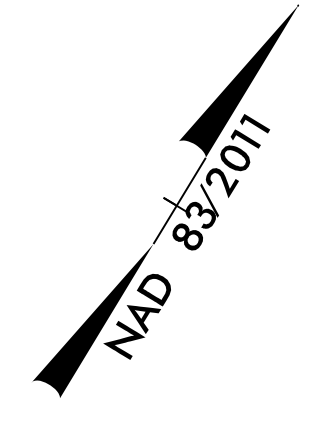

MATCHLINE -L- STA. 70+00 SEE SHEET UO-03

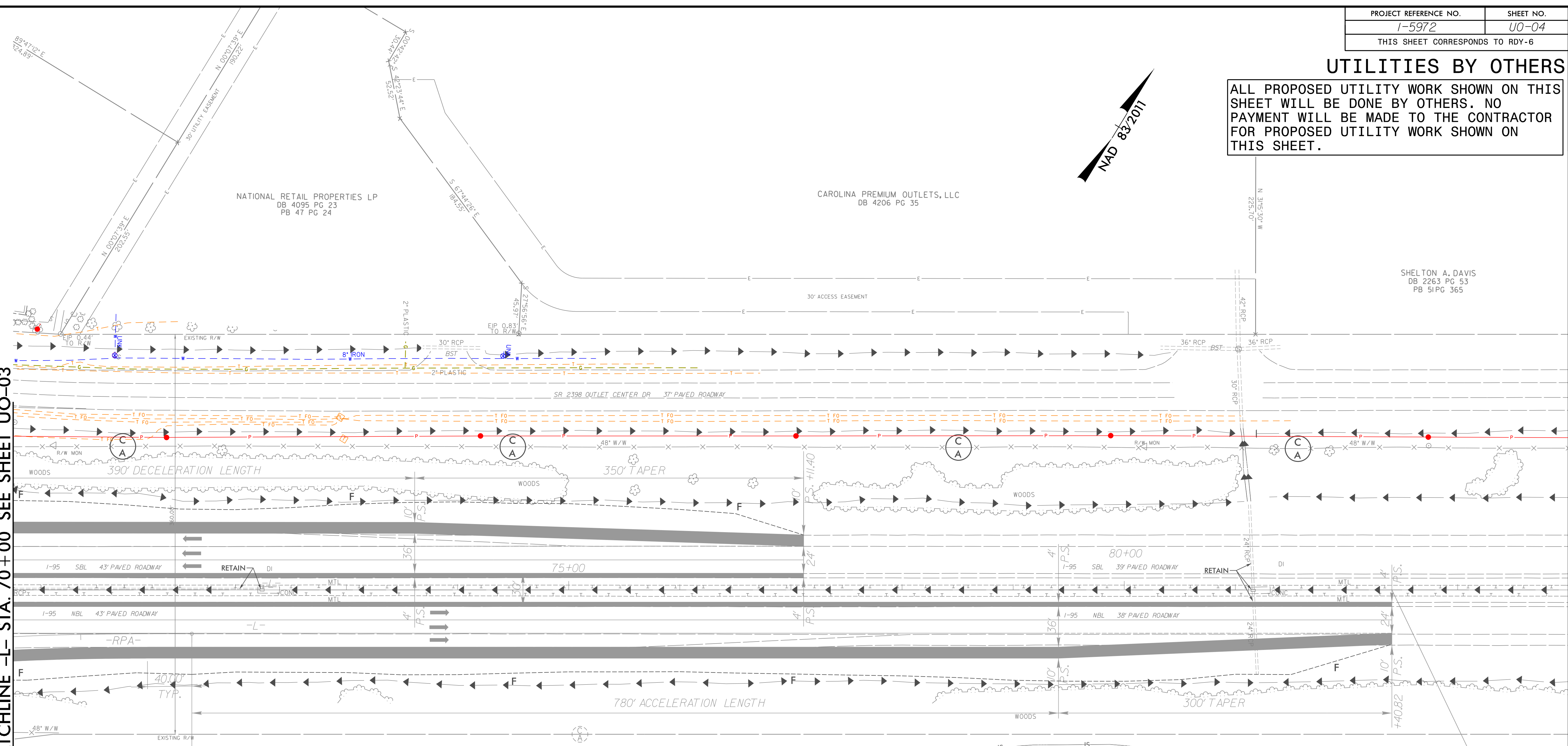

-RPA- ST Sta. 10+00.00 =
-L- POT Sta. 71+60.82 (39' RT)

END CONSTRUCTION
-L- Sta. 82+40.82

JOHN TIMOTHY HUGHES
JAMES WILLIAM HUGHES
DB 1253 PG 564

NOTE:
1. ALL EXISTING POWER ROUTING/CONNECTIVITY PROVIDED BY DUKE ENERGY AND GOOGLE EARTH

UTILITY OWNERS ON THIS SHEET
DUKE ENERGY - POWER (DIST)
CENTURYLINK - TELECOM AND FIBER OPTIC
CONterra ULTRA BROADBAND - FIBER OPTIC
TIME WARNER CABLE/CHARTER - CABLE
NCDOT - TRAFFIC AND FIBER OPTIC
PIEDMONT NATURAL GAS - NATURAL GAS
TOWN OF SMITHFIELD - WATER, SEWER, & POWER

RK&K
P: (919) 878-9560
8601 Six Forks Road, Forum 1, Suite 700
Raleigh, North Carolina 27615-3960
NC License No. F-0112

Engineers | Construction Managers | Planners | Scientists
www.rkk.com
Responsive People | Creative Solutions

5/14/99

I:\18\2021\Utilities\UB0\Pro\15972_Ut_rdy\06_U004.dgn