

8/17/99

MATCHLINE
-Y3- STA. 20+50
SEE SHEET 5

PROJECT REFERENCE NO. 1-5972	SHEET NO. 9
ROADWAY DESIGN ENGINEER MICHAEL T. MERRITT	HYDRAULICS ENGINEER ROBERT B. HUSKEY
<p>DOCUMENT NOT CONSIDERED FINAL UNLESS ALL SIGNATURES COMPLETED</p>	

NAD 83/2011

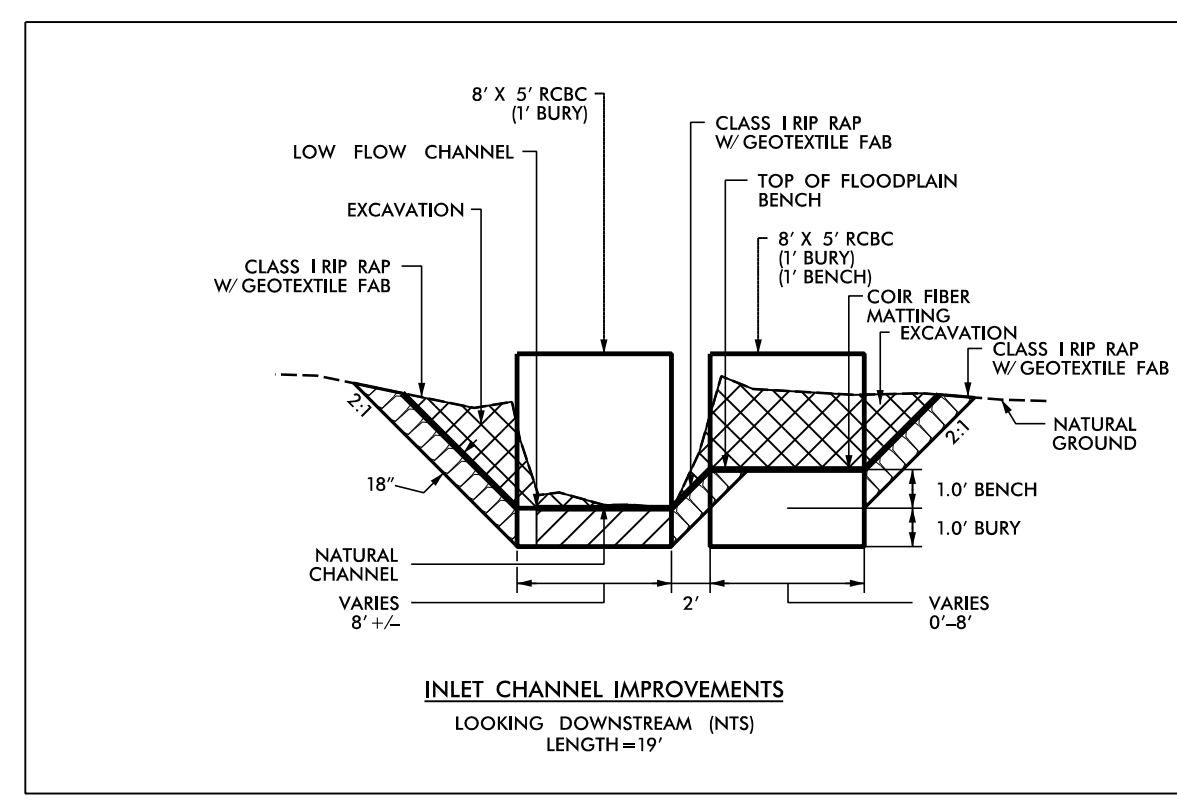
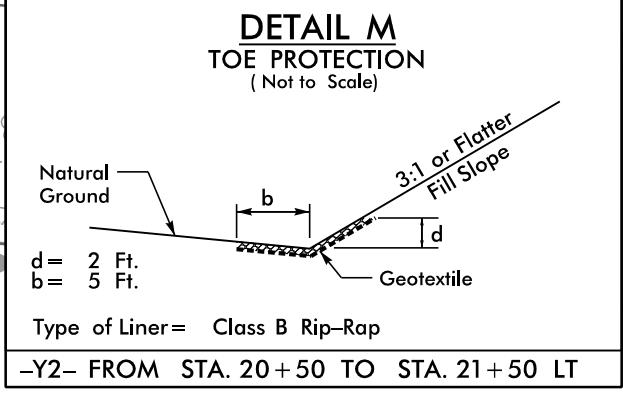
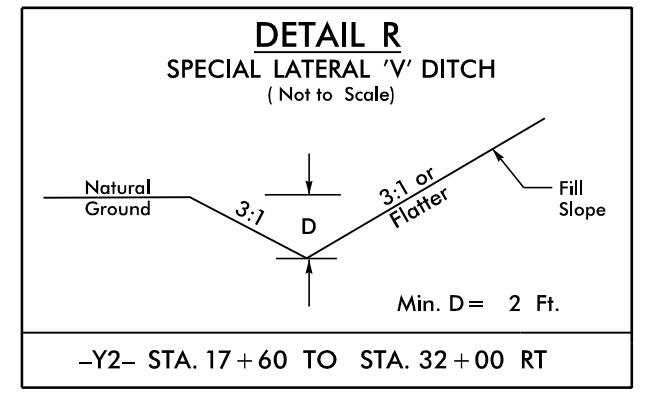
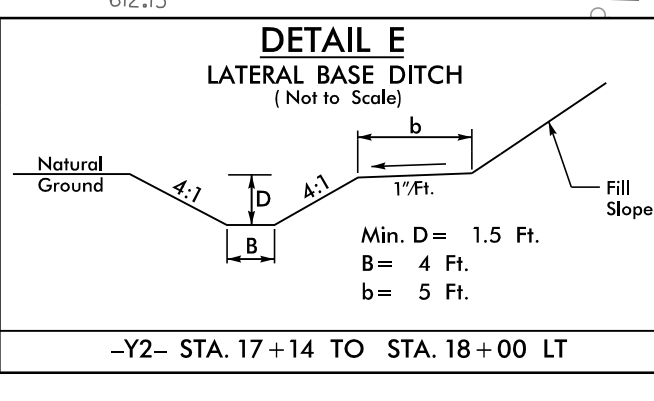
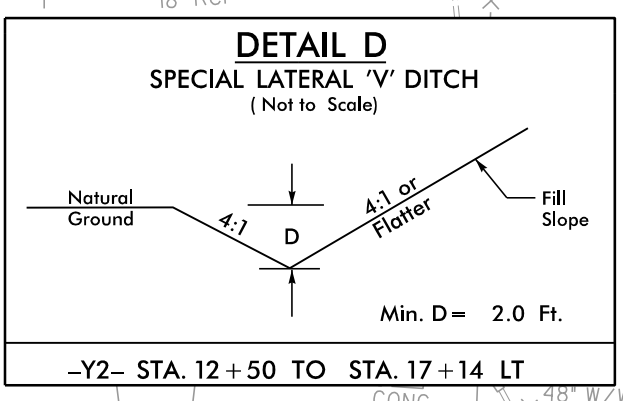
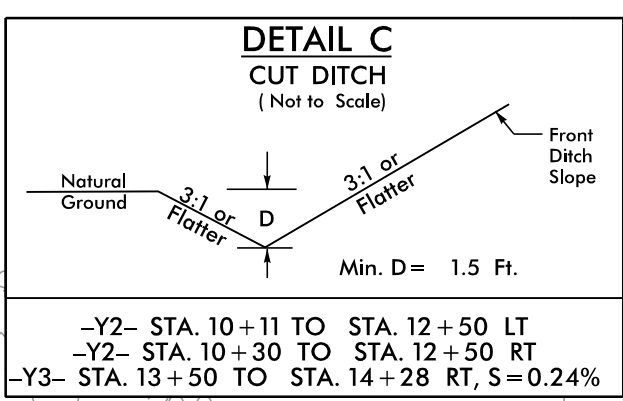

CHANNEL IMPROVEMENTS TOTALS:
55 TONS CL I RIP RAP
80 SY GEO FAB
23 SY COIR FIBER MATTING
29 CY DDE

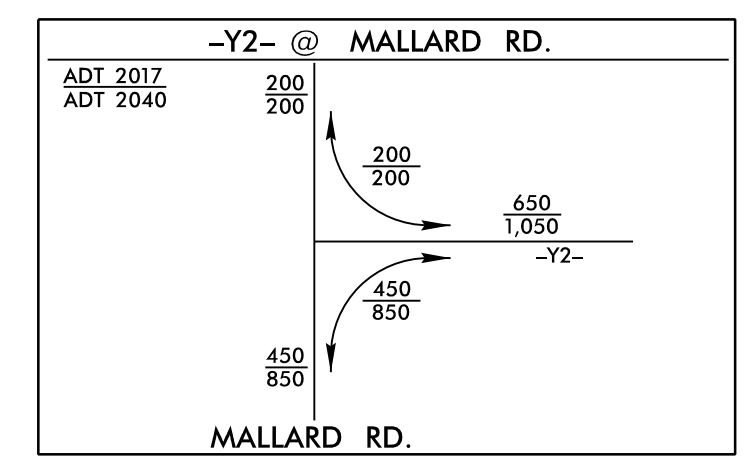
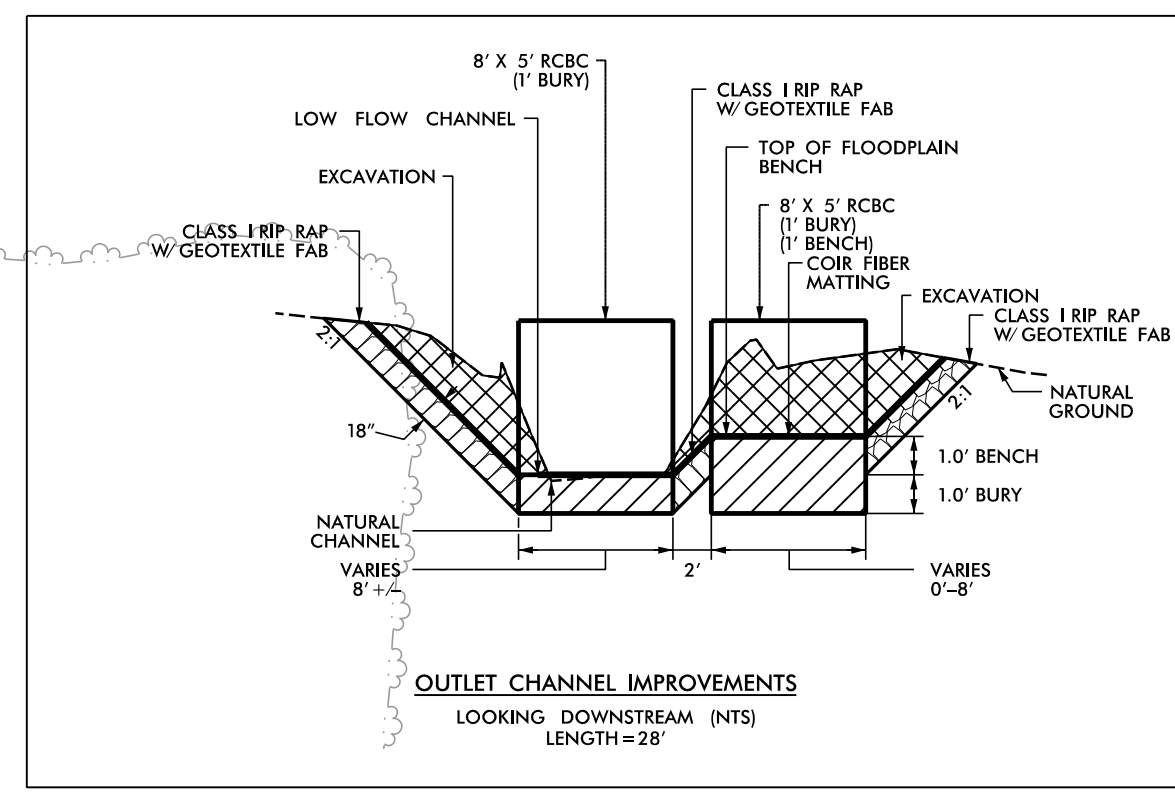
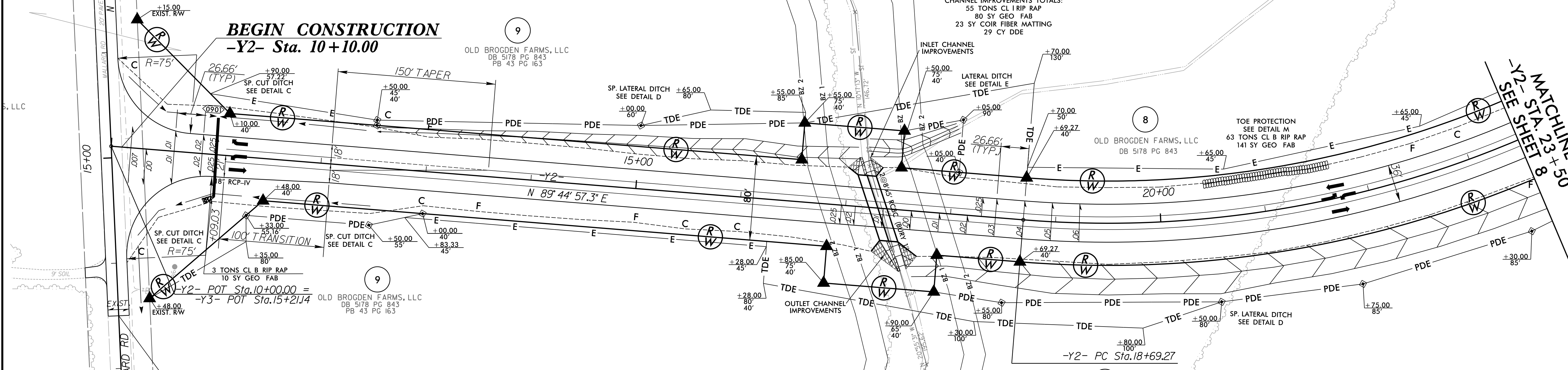

-Y2-
PI Sta. 24+96.11
 $\Delta = 64^{\circ} 09' 43.2''$ (LT)
D = 5' 43' 46.5"
L = 1,119.84'
T = 626.84'
R = 1,000.00'
Se = 0.06

NOTE:
ALL DRIVE RADII ARE 10' UNLESS OTHERWISE NOTED

FOR -Y2- PROFILE SEE SHT. 13
FOR -Y3- PROFILE SEE SHT. 18
FOR CULVERT CONST. PLANS SEE SHTS. C1-1 THRU C1-5

RK&K
P: (919) 878-9560
8601 Six Forks Road, Forum 1, Suite 700
Raleigh, North Carolina 27615-3960
NC License No. F-0112

Engineers | Construction Managers | Planners | Scientists
www.rkk.com
Responsive People | Creative Solutions

10/5/2023 R:\Roadway\Pro\15972_Rdy_psh09.dgn