

09.08/299

See Sheet 1A For Index of Sheets
See Sheet 1B For Conventional Symbols
See Sheets 1C-1F For Survey Control Sheets

STATE OF NORTH CAROLINA
DIVISION OF HIGHWAYS

IREDELL COUNTY

**LOCATION: SR 1100 BRAWLEY SCHOOL ROAD FROM
SR 1116 TALBERT ROAD TO
1000' EAST OF US 21
TYPE OF WORK: UTILITY BY OTHERS**

NOTE:
ALL PROPOSED UTILITY WORK SHOWN ON THIS SHEET WILL
BE DONE BY OTHERS. NO PAYMENT WILL BE MADE TO THE
CONTRACTOR FOR PROPOSED UTILITY
WORK SHOWN ON THIS SHEET.

TIP PROJECT: R-3833C

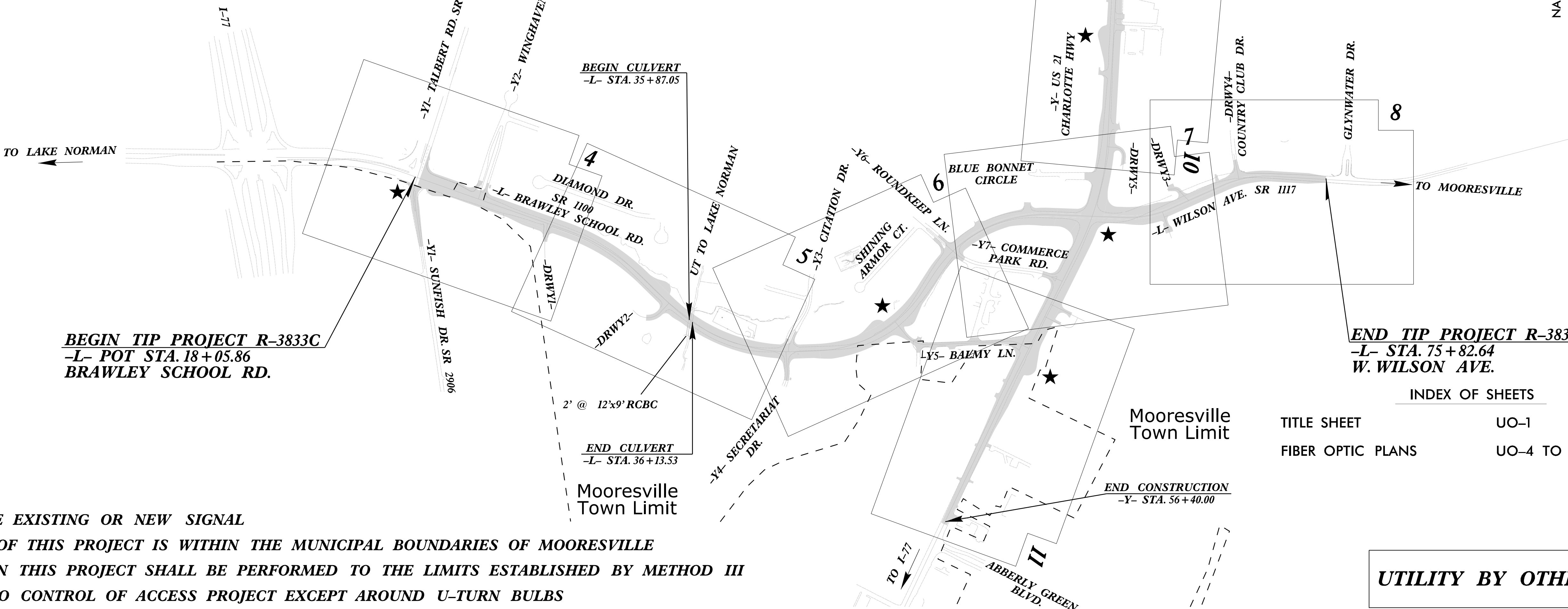
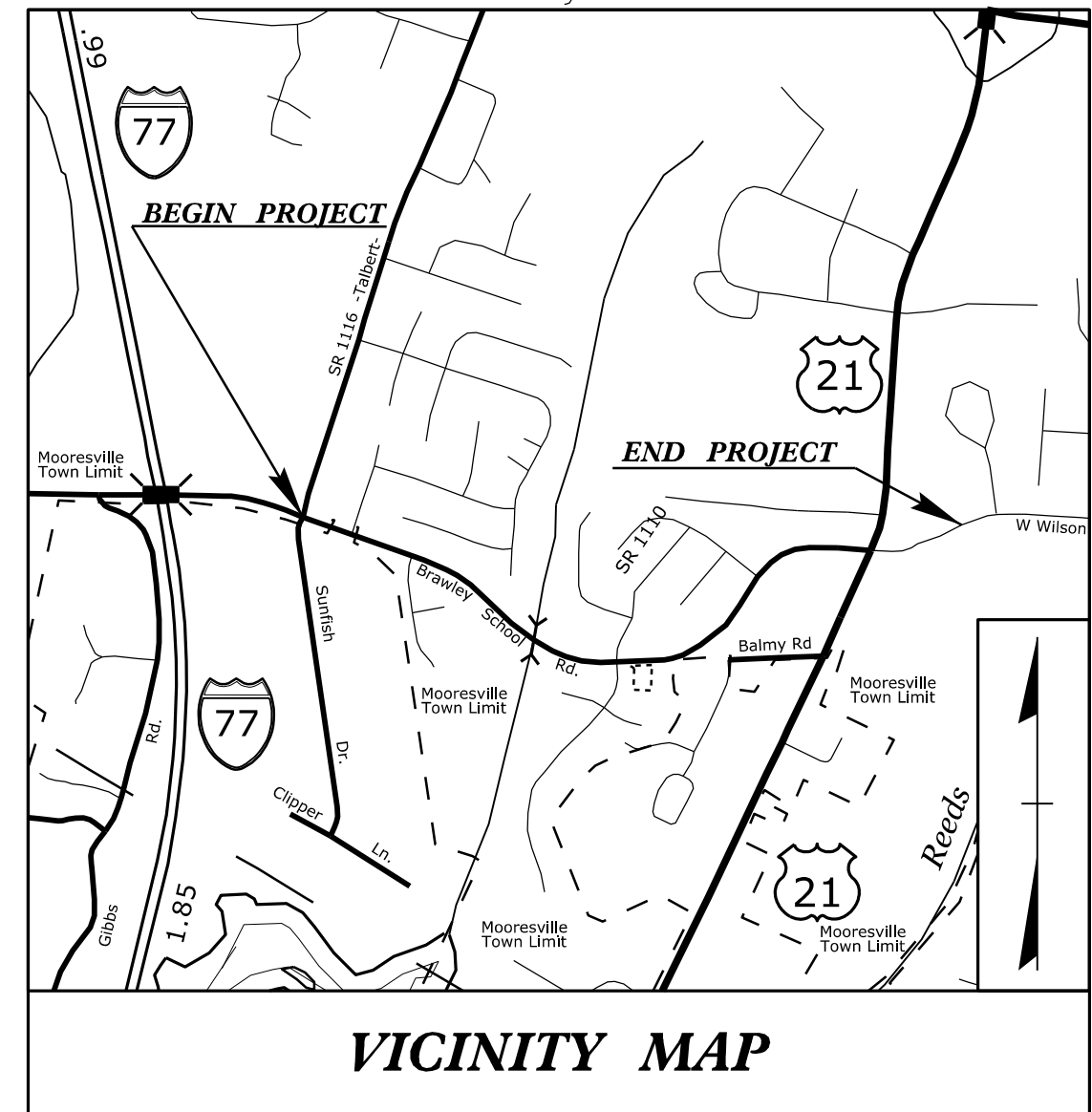

★ UPGRADE EXISTING OR NEW SIGNAL
A PORTION OF THIS PROJECT IS WITHIN THE MUNICIPAL BOUNDARIES OF MOORESVILLE
CLEARING ON THIS PROJECT SHALL BE PERFORMED TO THE LIMITS ESTABLISHED BY METHOD III
THIS IS A NO CONTROL OF ACCESS PROJECT EXCEPT AROUND U-TURN BULBS

INDEX OF SHEETS	
TITLE SHEET	UO-1
FIBER OPTIC PLANS	UO-4 TO UO-11

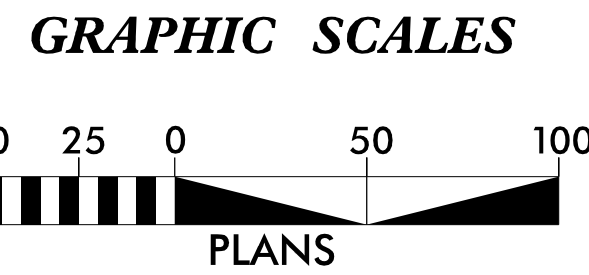

- UTILITY OWNERS WITH CONFLICTS**
- (A) POWER DISTRIBUTION - DUKE ENERGY
 - (B) COMMUNICATIONS - AT&T
 - (C) COMMUNICATIONS - CONTERRA
 - (D) COMMUNICATIONS - CHARTER (SPECTRUM)
 - (E) COMMUNICATIONS - WINDSTREAM
 - (F) COMMUNICATIONS - TDS (CONTINUUM)
 - (G) COMMUNICATIONS - LEVEL3 (CENTURYLINK)
 - (H) GAS - DOMINION ENERGY

Prepared In The Office of:

Stantec
Stantec Consulting Services Inc.
801 Jones Franklin Road
Suite 300
Raleigh, NC 27606
Tel. (919) 851-6866 Fax. (919) 851-7024
www.stantec.com License No. F-0672

for the North Carolina Department of Transportation
2012 STANDARD SPECIFICATIONS

STANTEC CONTACT:
MELVIN R. BRIGGS
UTILITY COORDINATOR

NC DOT DIVISION 12 CONTACT:
CHAD DREWERY
DIVISION 12 UTILITY ENGINEER

ROADWAY DESIGN ENGINEER
A. DEAN SARVIS, P.E.
PROJECT ENGINEER

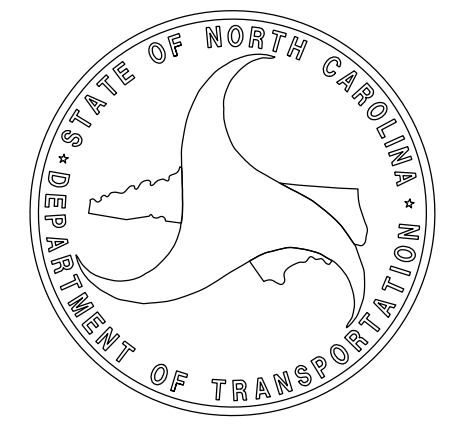

4/3/2023 C:\Users\aboykin\Desktop\Brawley School Rd_MBriggs_Utl\IR3833C_Utl_1_tsh_u0-01_tsh.dgn aboykin