

GEOTECHNICAL ENGINEER

ENGINEER

DocuSigned by: *M. H. Stephens* 08/18/2023

DOCUMENT NOT CONSIDERED FINAL UNLESS ALL SIGNATURES COMPLETED

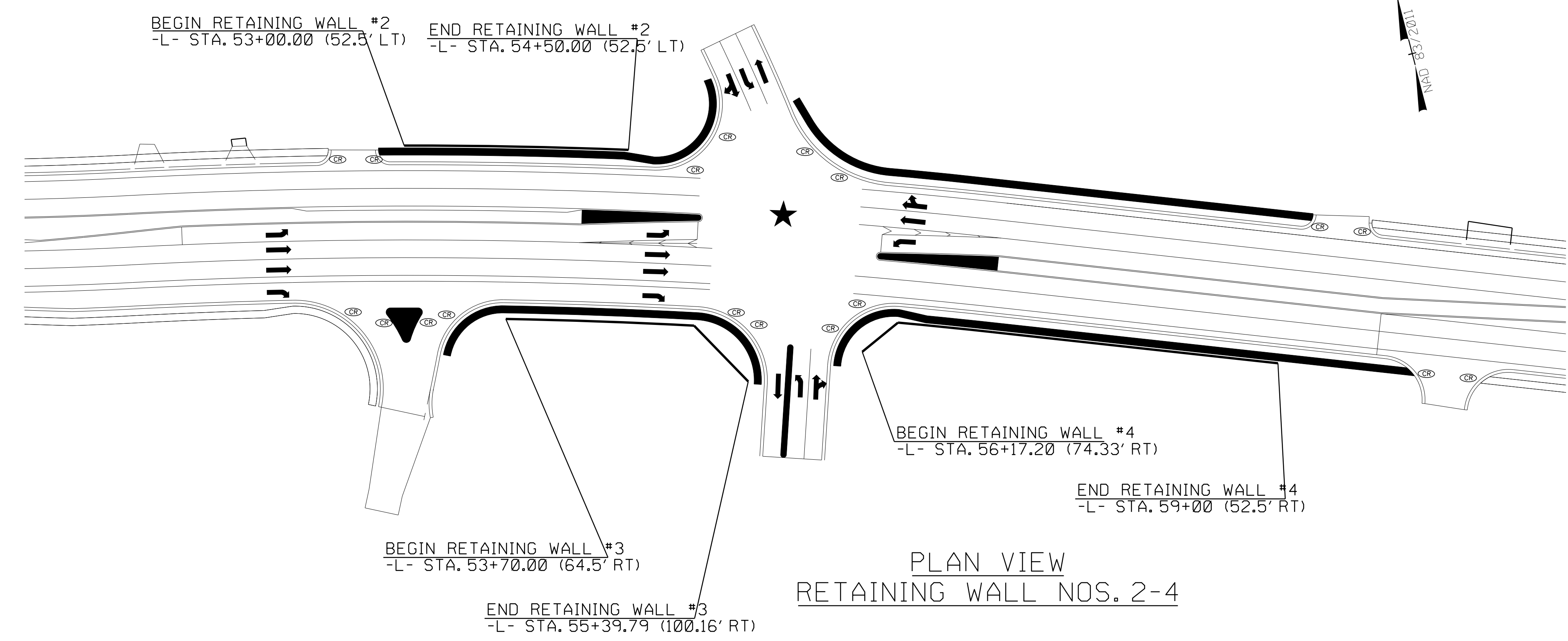

ESTIMATED WALL QUANTITIES

RETAINING WALL NO.	RETAINING WALLS (SQ. FEET)
2	470
3	610
4	1,035

NOTES
 1) RETAINING WALL NOS. 2, 3, AND 4 ARE STANDARD BLOCK RETAINING WALLS. SEE STANDARD DETAIL NO. 454.01 (SHEET W-3) AND SECTION 454 OF THE STANDARD SPECIFICATIONS.
 2) WALL AREA MEASURED FROM THE TOP OF WALL TO THE TOP OF FOOTING.

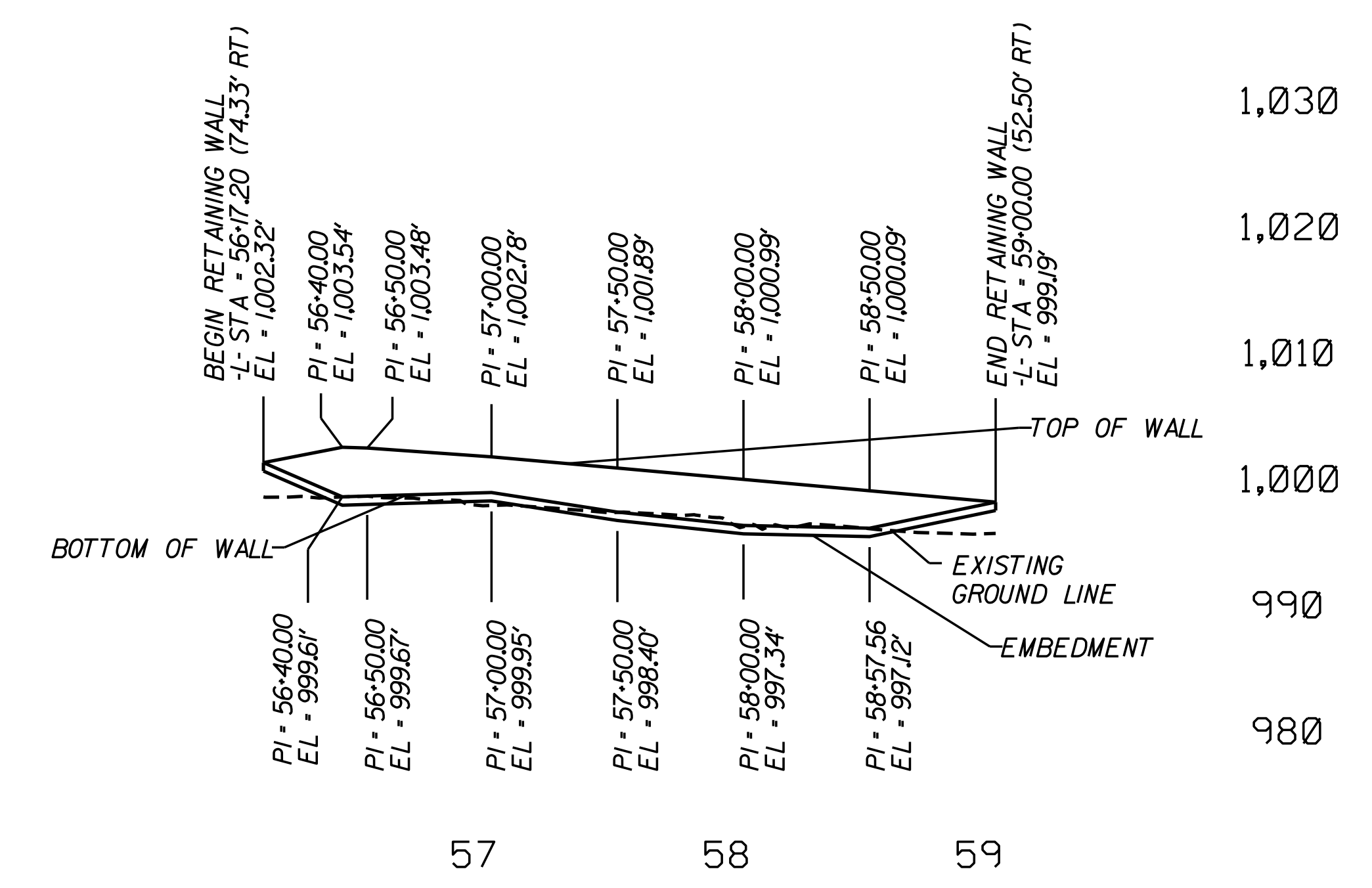
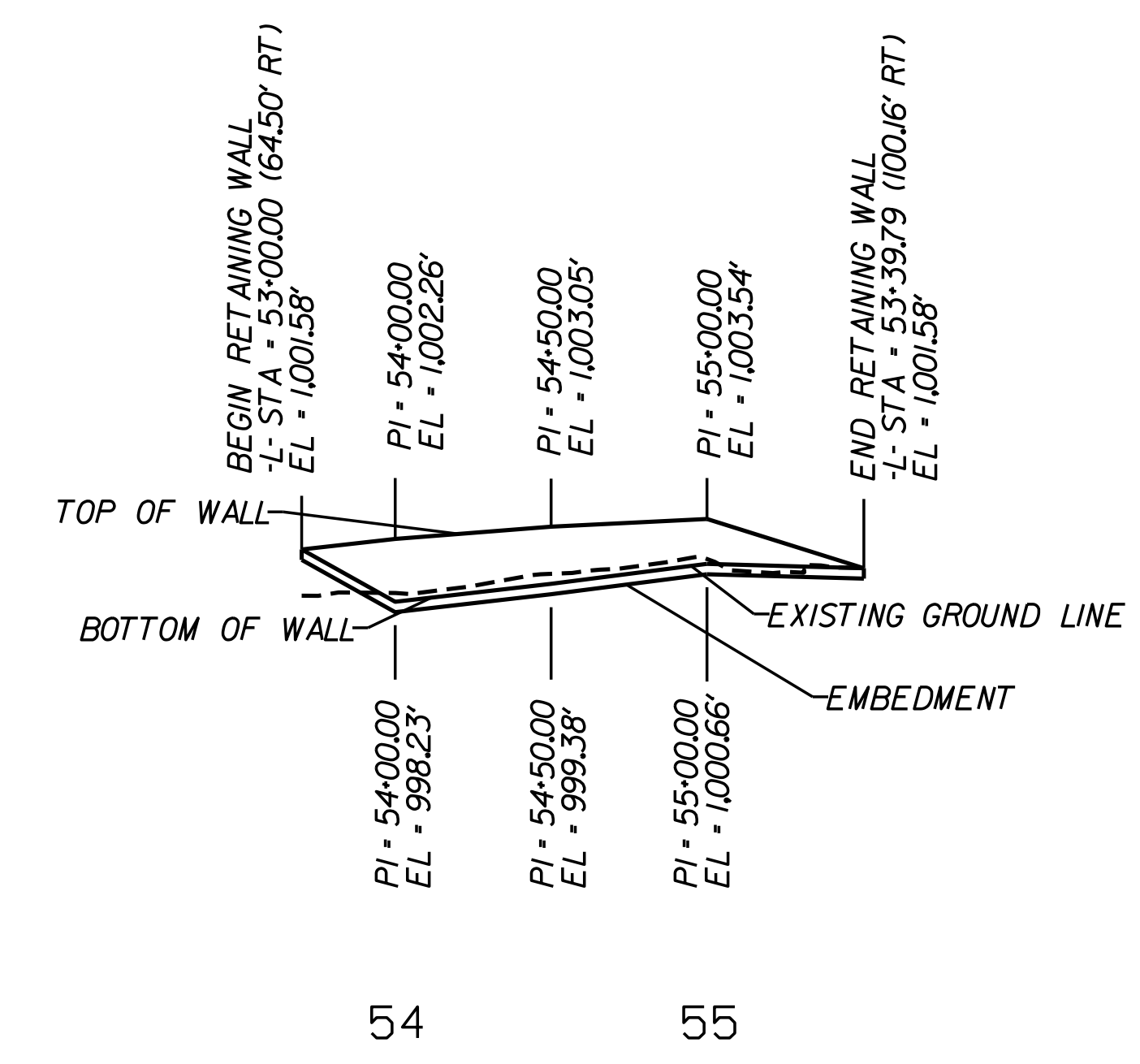
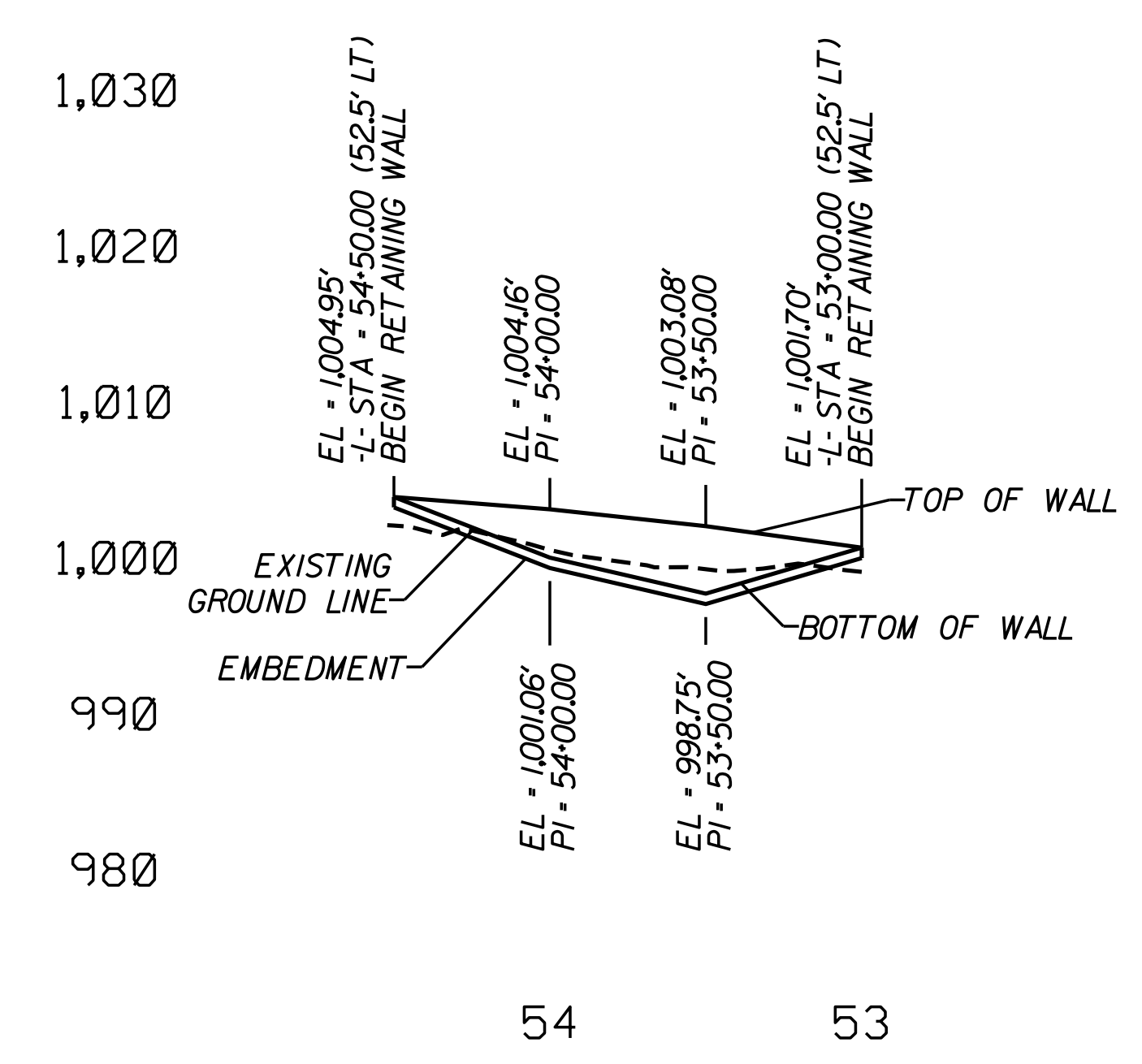

PROJECT NO.: 44395.1.1 (U-5824)
 FORSYTH COUNTY
 STATION: STA -L- 53+00 TO -L- 59+00
 SHEET 1 OF 5 WALL NOS. 2, 3, AND 4

PREPARED BY: MHS DATE: 2/3/23
 REVIEWED BY: SCC DATE: 2/3/23

NORTH CAROLINA
DEPARTMENT OF TRANSPORTATION
DIVISION OF HIGHWAYS

GEOTECHNICAL
ENGINEERING UNIT

RETAINING WALL NOS. 2-4
STANDARD SEGMENTAL
BLOCK RETAINING WALLS

REVISIONS					
NO.	BY	DATE	NO.	BY	DATE
1	MHS	8/23	3		
2			4		

SHEET NO. W-1