

DEFAULT PHASING DIAGRAM

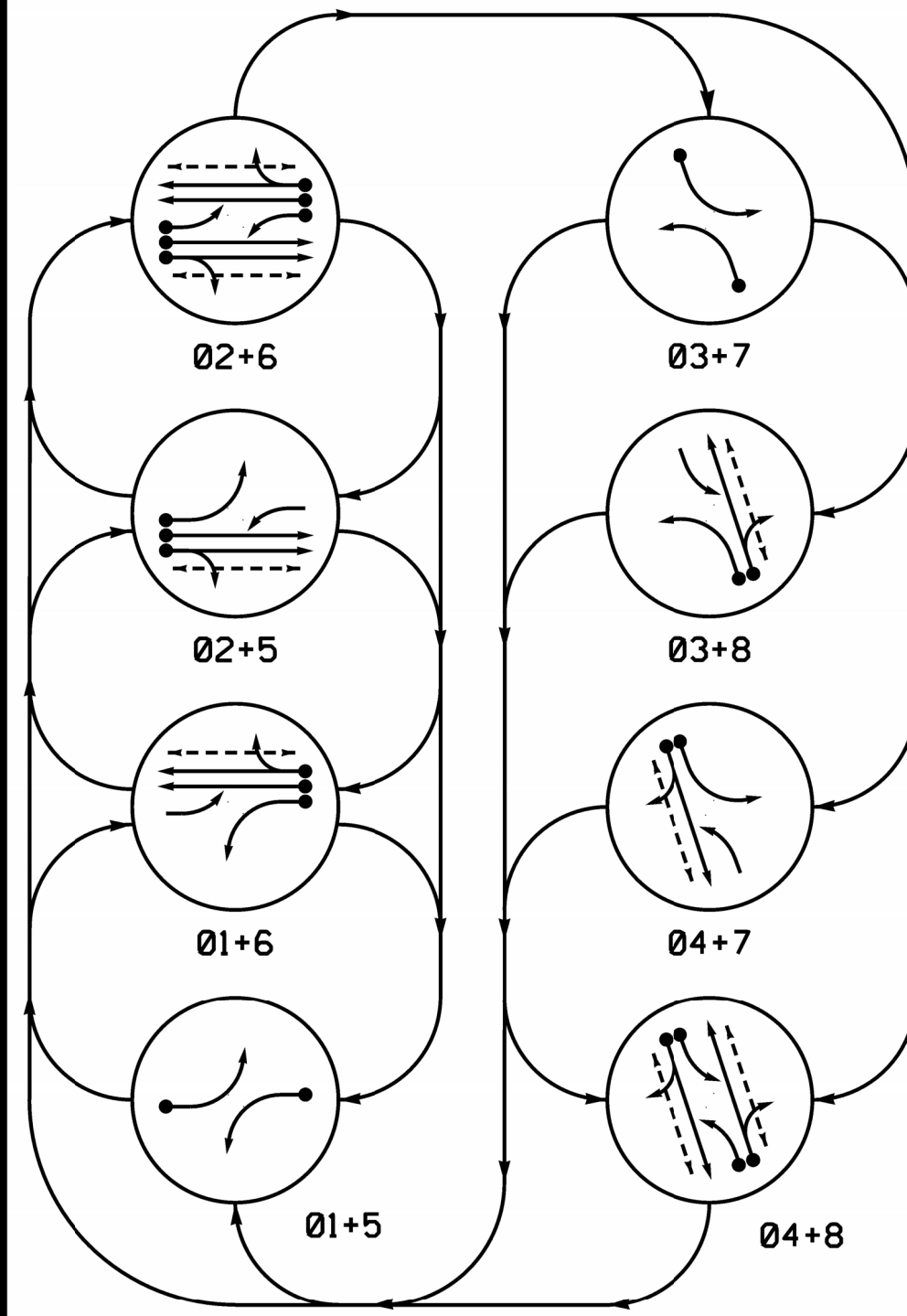

DEFAULT PHASING TABLE OF OPERATION

SIGNAL FACE	PHASE								FLASH
	01+5	01+6	02+5	02+6	03+7	03+8	04+7	04+8	
11	---	---	---	---	---	---	---	---	---
21,22	R	R	G	G	R	R	R	R	Y
31	---	---	---	---	---	---	---	---	---
41,42,43	R	R	R	R	---	---	---	---	---
51	---	---	---	---	---	---	---	---	---
61,62	R	G	R	G	R	R	R	R	Y
71	---	---	---	---	---	---	---	---	---
81,82,83	R	R	R	R	R	G	R	G	R
P21,P22	DW	DW	W	W	DW	DW	DW	DW	DRK
P41,P42	DW	DW	DW	DW	DW	DW	W	W	DRK
P61,P62	DW	W	DW	W	DW	DW	DW	DW	DRK
P81,P82	DW	DW	DW	DW	DW	W	W	W	DRK

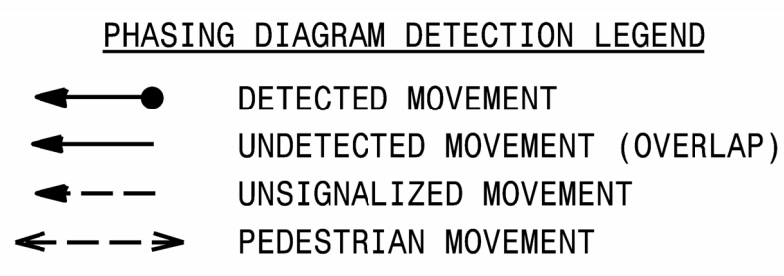

ALTERNATE PHASING DIAGRAM

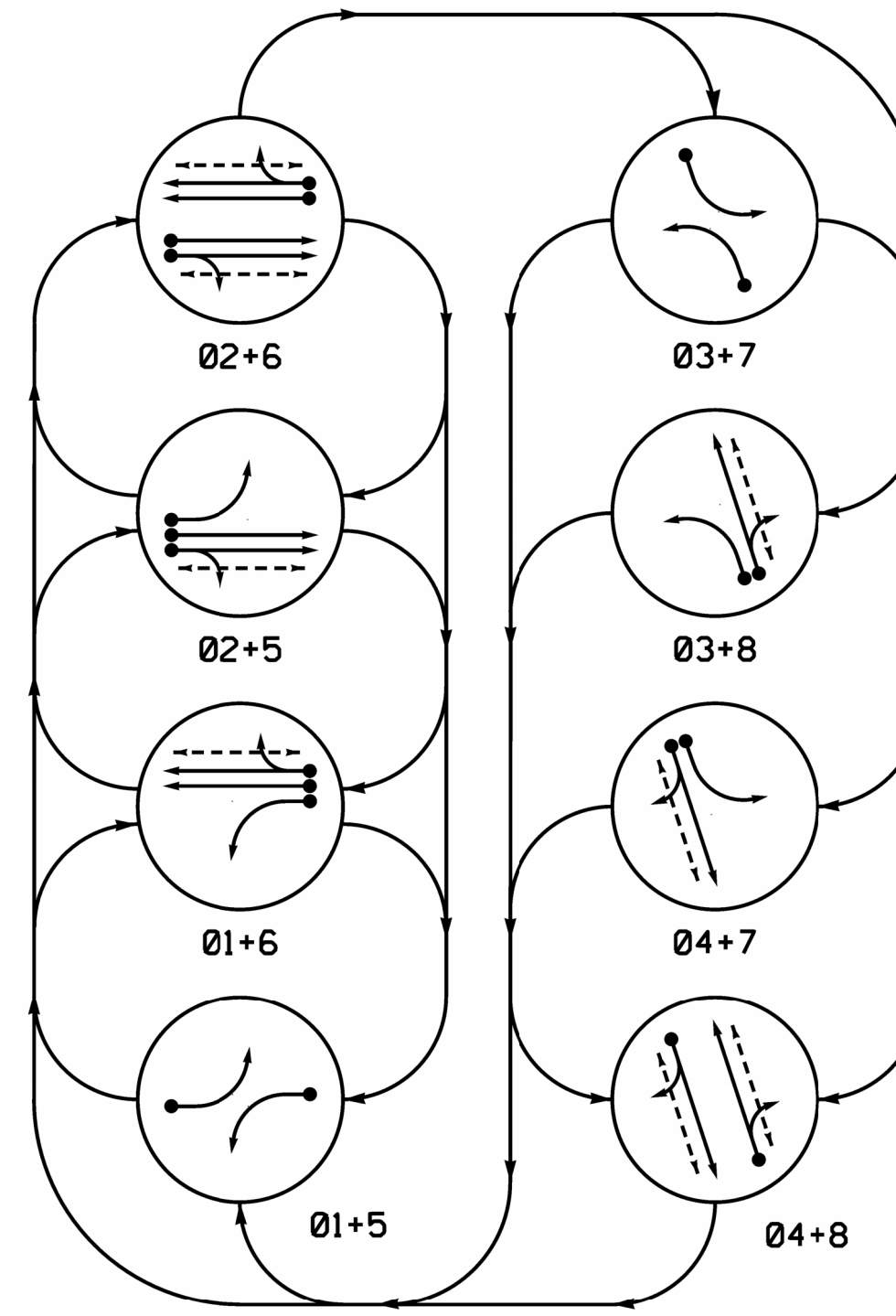

ALTERNATE PHASING TABLE OF OPERATION

SIGNAL FACE	PHASE								FLASH
	01+5	01+6	02+5	02+6	03+7	03+8	04+7	04+8	
11	---	---	---	---	---	---	---	---	---
21,22	R	R	G	G	R	R	R	R	Y
31	---	---	---	---	---	---	---	---	---
41,42,43	R	R	R	R	---	---	---	---	---
51	---	---	---	---	---	---	---	---	---
61,62	R	G	R	G	R	R	R	R	Y
71	---	---	---	---	---	---	---	---	---
81,82,83	R	R	R	R	R	G	R	G	R
P21,P22	DW	DW	W	W	DW	DW	DW	DW	DRK
P41,P42	DW	DW	DW	DW	DW	DW	W	W	DRK
P61,P62	DW	W	DW	W	DW	DW	DW	DW	DRK
P81,P82	DW	DW	DW	DW	DW	W	W	W	DRK

SIGNAL FACE I.D.
All Heads L.E.D.

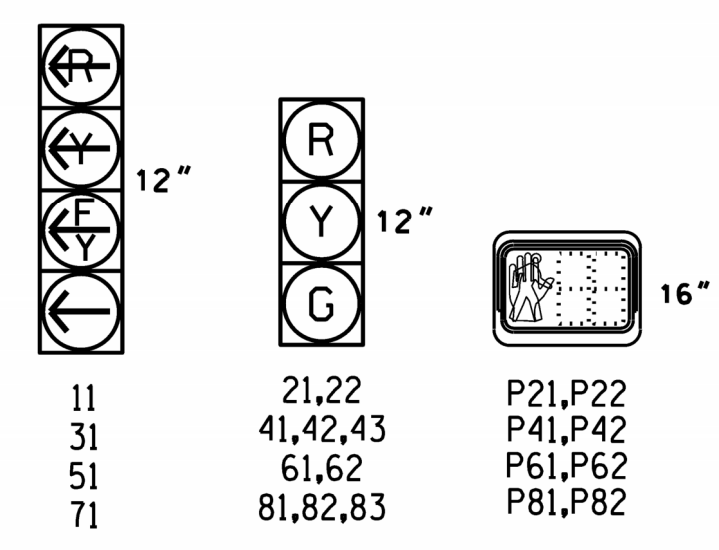

MAXTIME DETECTOR INSTALLATION CHART

LOOP	SIZE (FT)	DISTANCE FROM STOPBAR (FT)	TURNS	NEW LOOP	PROGRAMMING							
					CALL PHASE	DELAY TIME	EXTEND TIME	EXTEND	INITIAL	CALL	DELAY DURING GREEN	NEW CARD
1A	6X40	0	2-4-2	X	1	15.0*	-	X	-	X	-	X
2A	6X6	300	5	X	2	-	-	X	X	X	-	X
2B	6X6	300	5	X	2	-	-	X	X	X	-	X
3A	6X40	0	2-4-2	X	3	15.0*	-	X	-	X	-	X
4A	6X40	0	2-4-2	X	4	10.0	-	X	-	X	-	X
5A	6X40	0	2-4-2	X	5	15.0*	-	X	-	X	-	X
6A	6X6	300	5	X	6	-	-	X	X	X	-	X
6B	6X6	300	5	X	6	-	-	X	X	X	-	X
7A	6X40	0	2-4-2	X	7	15.0*	-	X	-	X	-	X
8A	6X40	0	2-4-2	X	8	10.0	-	X	-	X	-	X
S5	6X6	+300	6	X	-	-	-	-	-	-	-	X
S6	6X6	+300	6	X	-	-	-	-	-	-	-	X
S11	6X6	+250	6	X	-	-	-	-	-	-	-	X
S12	6X6	+250	6	X	-	-	-	-	-	-	-	X

8 Phase Fully Actuated (Old Hollow Road CLS) Signal System #: D09-29_Walkertown

NOTES

- Refer to "Roadway Standard Drawings NCDOT" dated January 2018 and "Standard Specifications for Roads and Structures" dated January 2018.
- Do not program signal for late night flashing operation unless otherwise directed by the Engineer.
- Phase 1 and/or phase 5 may be lagged.
- Phase 3 and/or phase 7 may be lagged.
- Set all detector units to presence mode.
- Omit "WALK" and flashing "DON'T WALK" with no pedestrian calls.
- Program pedestrian heads to countdown the flashing "Don't Walk" time only.
- Metal poles, pedestal poles, and pedestrian signal heads shall be black in color. Vehicle signal heads shall be standard yellow in color.
- The Division Traffic Engineer will determine the hours of use for each phasing plan.
- Maximum times shown in timing chart are for free-run operation only. Coordinated signal system timing values supersede these values.

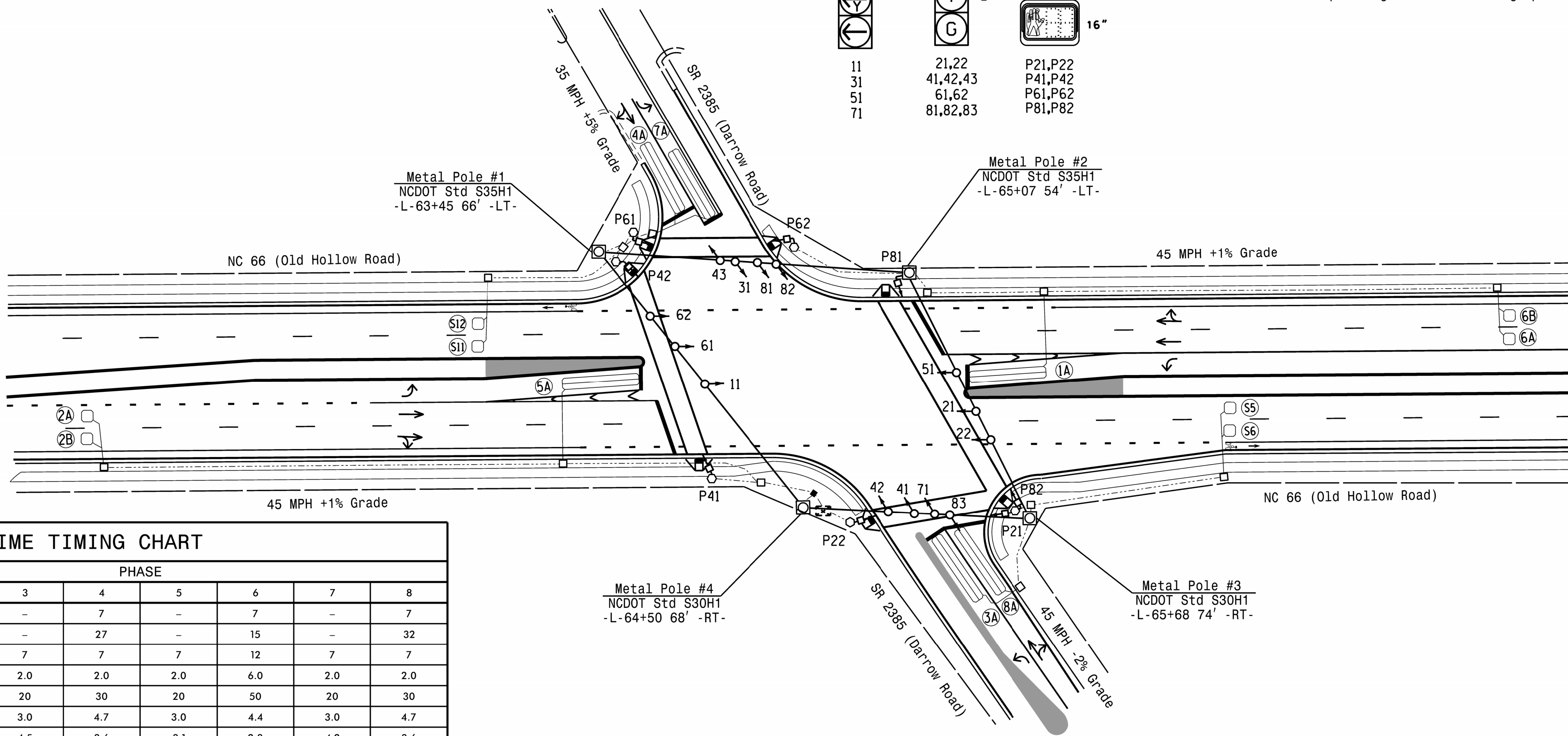

MAXTIME TIMING CHART

FEATURE	PHASE							
	1	2	3	4	5	6	7	8
Walk *	-	7	-	7	-	7	-	7
Ped Clear *	-	16	-	27	-	15	-	32
Min Green *	7	12	7	7	7	12	7	7
Passage *	2.0	6.0	2.0	2.0	2.0	6.0	2.0	2.0
Max I *	20	50	20	30	20	50	20	30
Yellow Change	3.0	4.4	3.0	4.7	3.0	4.4	3.0	4.7
Red Clear	2.9	2.3	4.5	3.6	3.1	2.3	4.2	3.6
Added Initial *	-	2.5	-	-	-	2.5	-	-
Maximum Initial *	-	34	-	-	-	34	-	-
Time Before Reduction *	-	15	-	-	-	15	-	-
Time To Reduce *	-	30	-	-	-	30	-	-
Minimum Gap	-	3.0	-	-	-	3.0	-	-
Advance Walk	-	3	-	3	-	3	-	3
Non Lock Detector	X	-	X	X	X	-	X	X
Vehicle Recall	-	MIN RECALL	-	-	-	MIN RECALL	-	-
Dual Entry	-	-	-	X	-	-	-	X

* These values may be field adjusted. Do not adjust Min Green and Passage times for phases 2 and 6 lower than what is shown. Min Green for all other phases should not be lower than 4 seconds.

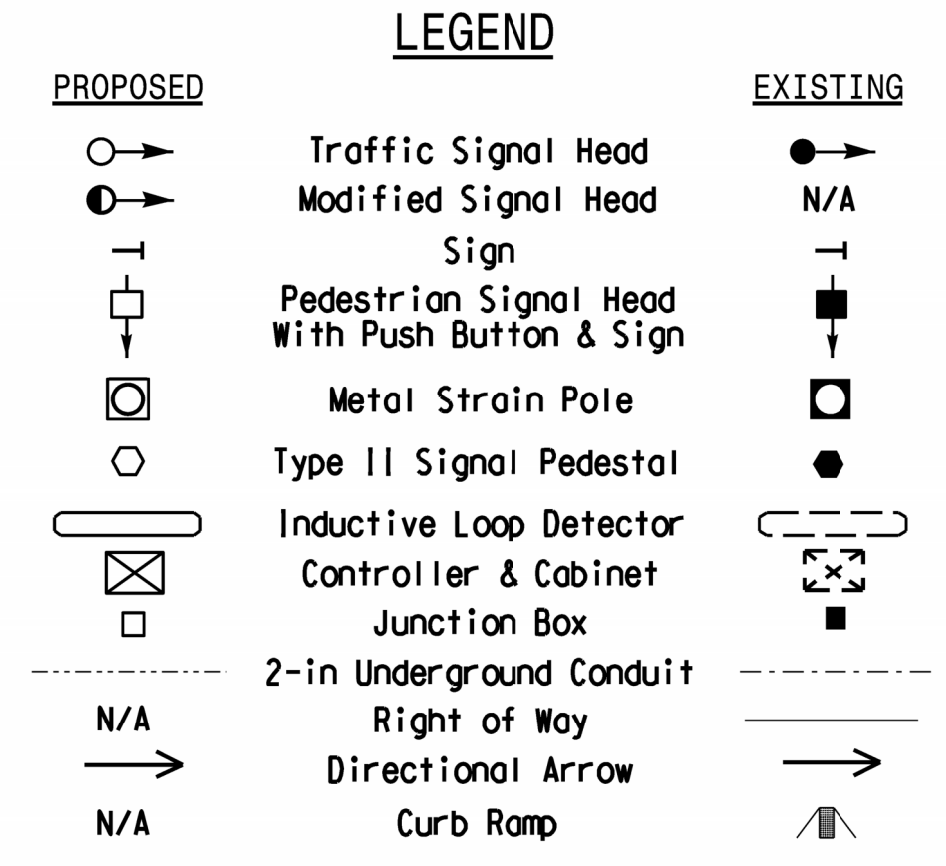

Signal Upgrade - Final Design

Prepared in the Office of:

NC FIRM LICENSE No: P-0339
320 Executive Court
Hillsborough, NC 27278
(919) 732-3883
(919) 732-6676 (FAX)

Prepared For:

750 N. Greenfield Pkwy, Garner, NC 27525

NC 66 (Old Hollow Road) at SR 2385 (Darrow Road)

Division 9 Forsyth County Walkertown

PLAN DATE: August 2023 REVIEWED BY: E. Sirgany

PREPARED BY: M. Parker REVIEWED BY:

REVISIONS	INIT.	DATE

DOCUMENT NOT CONSIDERED FINAL UNLESS ALL SIGNATURES COMPLETED

SEAL

Edward W. Sirgany
9/7/2023
DATE

SIG. INVENTORY NO. 09-0654