

TIP NO. U-5824	SHEET NO. PMP-4
APPROVED: <i>Faith E. Johnke</i> DATE: 9/15/2023	
SEAL	
Prepared in the Office of:	
	<small>NC FIRM LICENSE No. P-0339 320 Executive Ct. Hillsborough, NC 27278 (919) 732-3883 (919) 732-6676 (FAX)</small>

NAD 83/2011

CURB RAMP LOCATIONS (BACK OF CURB REFERENCE POINT)	
1	-L- STA. 37+08.94, 48.50' RT (TYPE 1)
2	-L- STA. 37+44.07, 48.50' RT (TYPE 1)
3	-L- STA. 41+43.65, 64.37' RT (STANDARD)
4	-L- STA. 42+10.91, 68.27' RT (STANDARD)

BIKE LANES ARE 4' WIDE UNLESS DIMENSIONED OTHERWISE

MATCHLINE -L- STA 37 + 00.00
(SEE SHEET 3)

MATCHLINE -L- STA 50 + 00.00
(SEE SHEET 5)

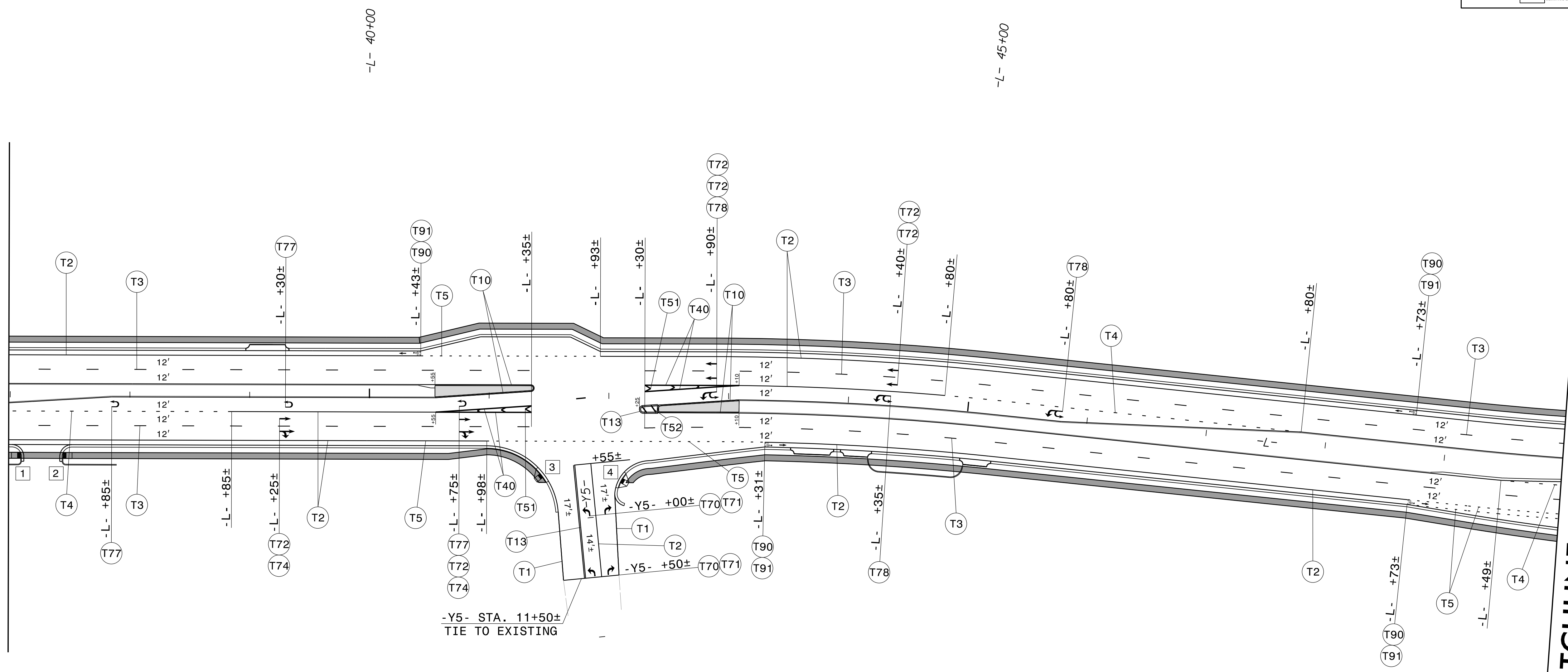

REVISIONS

10-AUG-2023 18:33
U5824_PMP-4.dgn
Faith.E.Johnke