

F-F
STA. 80+00

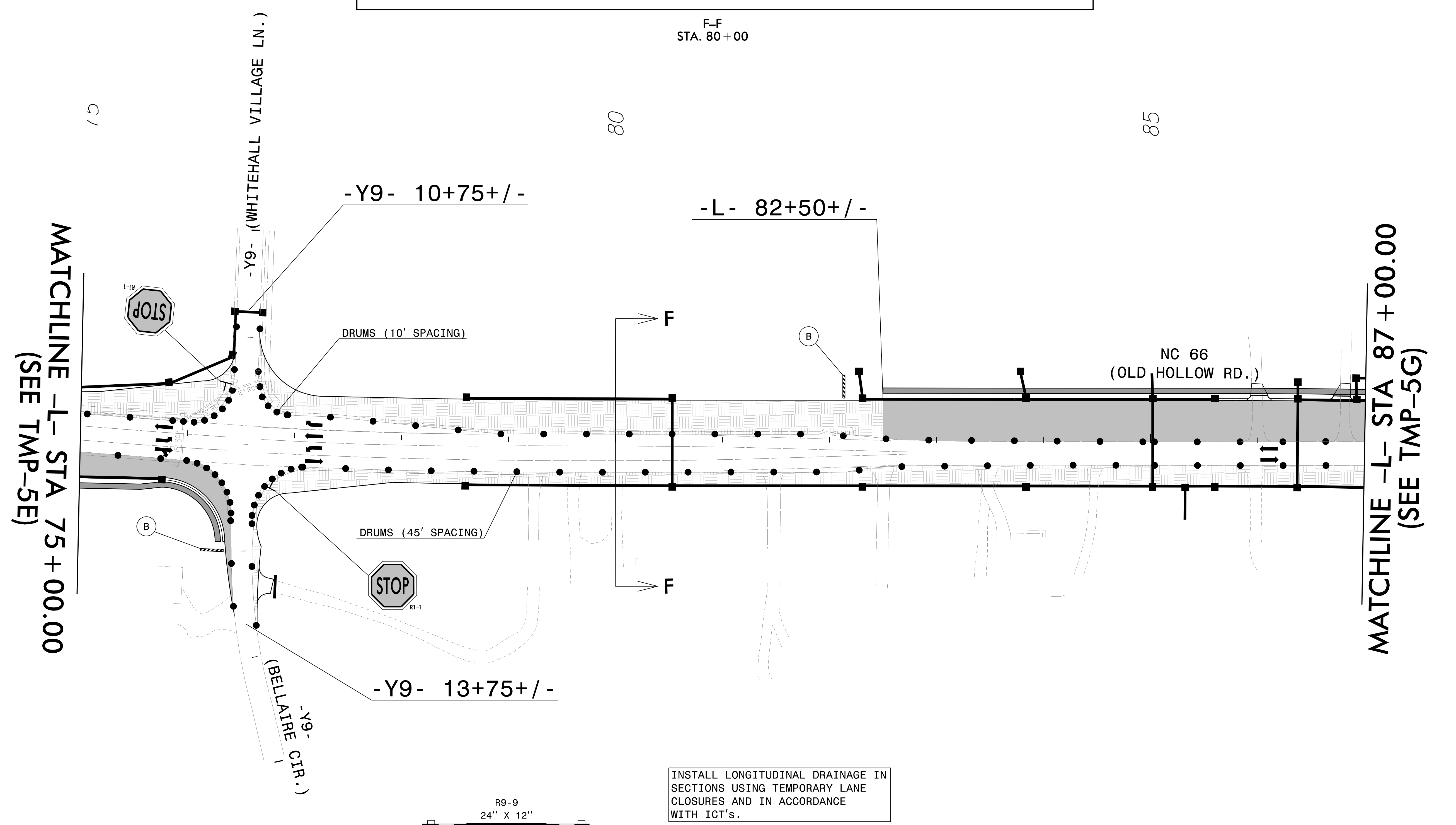

MATCHLINE -L- STA 75+00.00
(SEE TMP-5E)

MATCHLINE -L- STA 87+00.00
(SEE TMP-5G)

DRUMS (10' SPACING)

DRUMS (45' SPACING)

INSTALL LONGITUDINAL DRAINAGE IN SECTIONS USING TEMPORARY LANE CLOSURES AND IN ACCORDANCE WITH ICT'S.

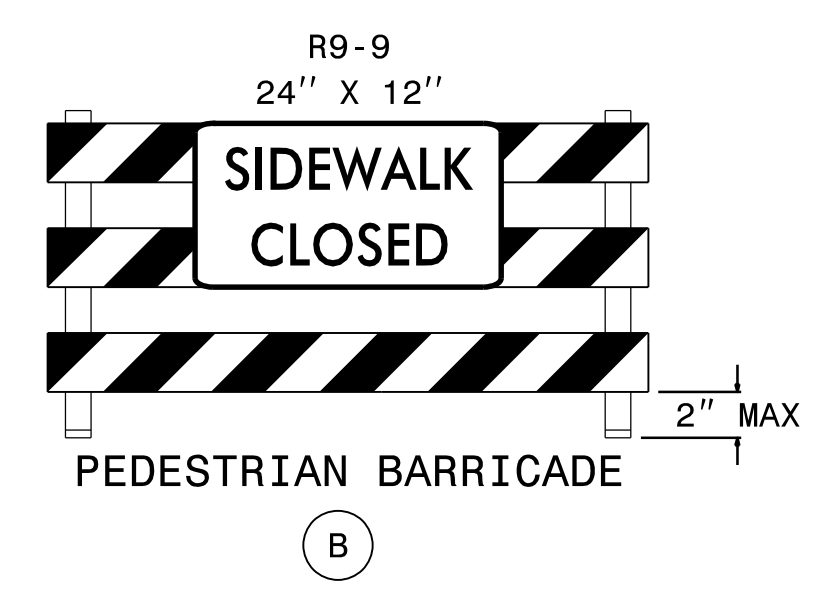

PREVIOUSLY GRADED

WORK AREA

APPROVED: *Faith E. Jahnske*
DATE: 9/15/2023

SEAL

FAITH E. JAHNSKE
ENGINEER
SEAL 046981
NORTH CAROLINA PROFESSIONAL ENGINEER

DOCUMENT NOT CONSIDERED FINAL UNLESS ALL SIGNATURES COMPLETED

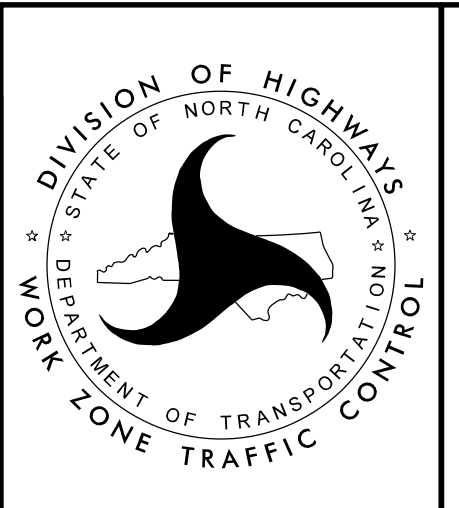

PHASE IA
DETAIL

15-AUG-2023 14:54
U5824-1C-TMP-5F.dgn
Faith.Jahnske