

PROJECT REFERENCE NO. U-5824	SHEET NO. 7
RW SHEET NO.	
ROADWAY DESIGN ENGINEER 9/15/2023 NORTH CAROLINA PROFESSIONAL SEAL 046981 FAITH E. JAHNKE	HYDRAULICS ENGINEER 9/15/2023 NORTH CAROLINA PROFESSIONAL SEAL 054713 HE YANG
DOCUMENT NOT CONSIDERED FINAL UNLESS ALL SIGNATURES COMPLETED	
Prepared in the Office of: SUMMIT	NC FIRM LICENSE NO: P-0339 300 EXECUTIVE CT HILLSBOROUGH, NC 27278 (919) 732-3881 (919) 732-6676 (FAX)

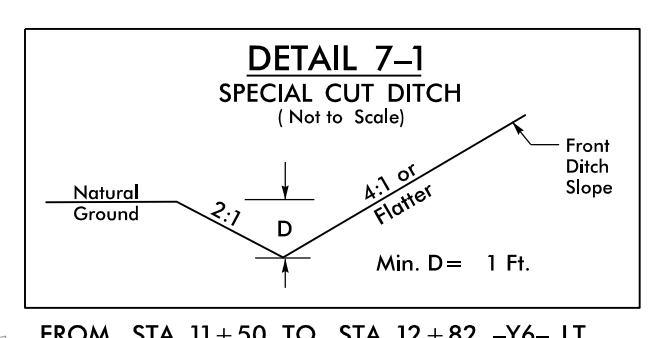

-Y7B-
 PI Sta 12+35.76
 $\Delta = 12' 41" 34.4" (RT)$
 $D = 5' 43" 46.5"$
 $L = 221.53'$
 $T = 111.22'$
 $R = 1,000.00'$

-L-
 PI Sta 50+18.92
 $\Delta = 4' 43" 39.8" (LT)$
 $D = 2' 29" 28.0"$
 $L = 189.78'$
 $T = 94.95'$
 $R = 2,300.00'$
 $SE = 3\%$
 $RO = 144'$

-L-
 PI Sta 54+10.21
 $\Delta = 9' 11" 11.0" (RT)$
 $D = 1' 33" 09.8"$
 $L = 591.63'$
 $T = 296.45'$
 $R = 3,690.00'$
 $SE = 2\%$
 $RO = 96'$

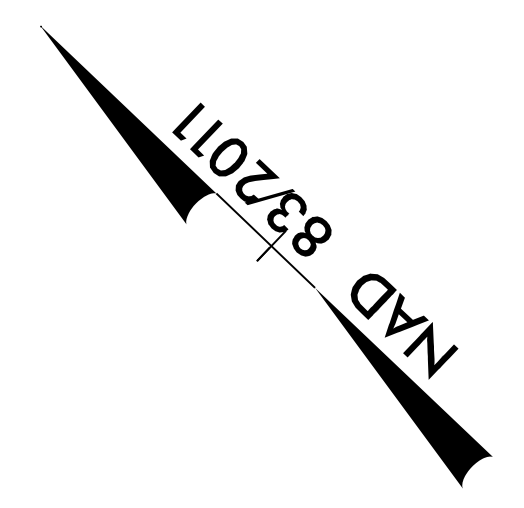
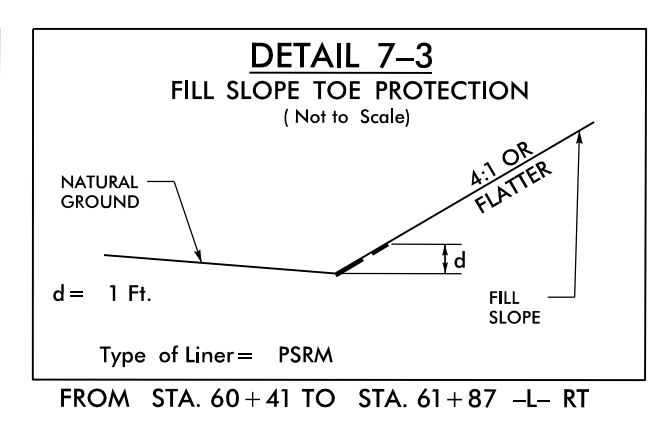
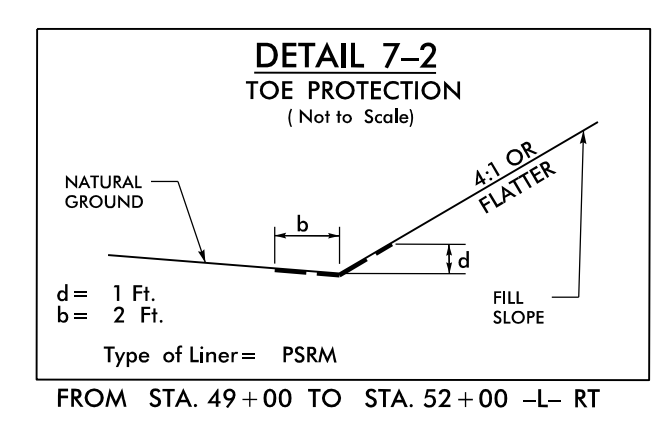

MATCHLINE -L- STA 50+00.00
(SEE SHEET 6)

MATCHLINE -L- STA 63+00.00
(SEE SHEET 8)

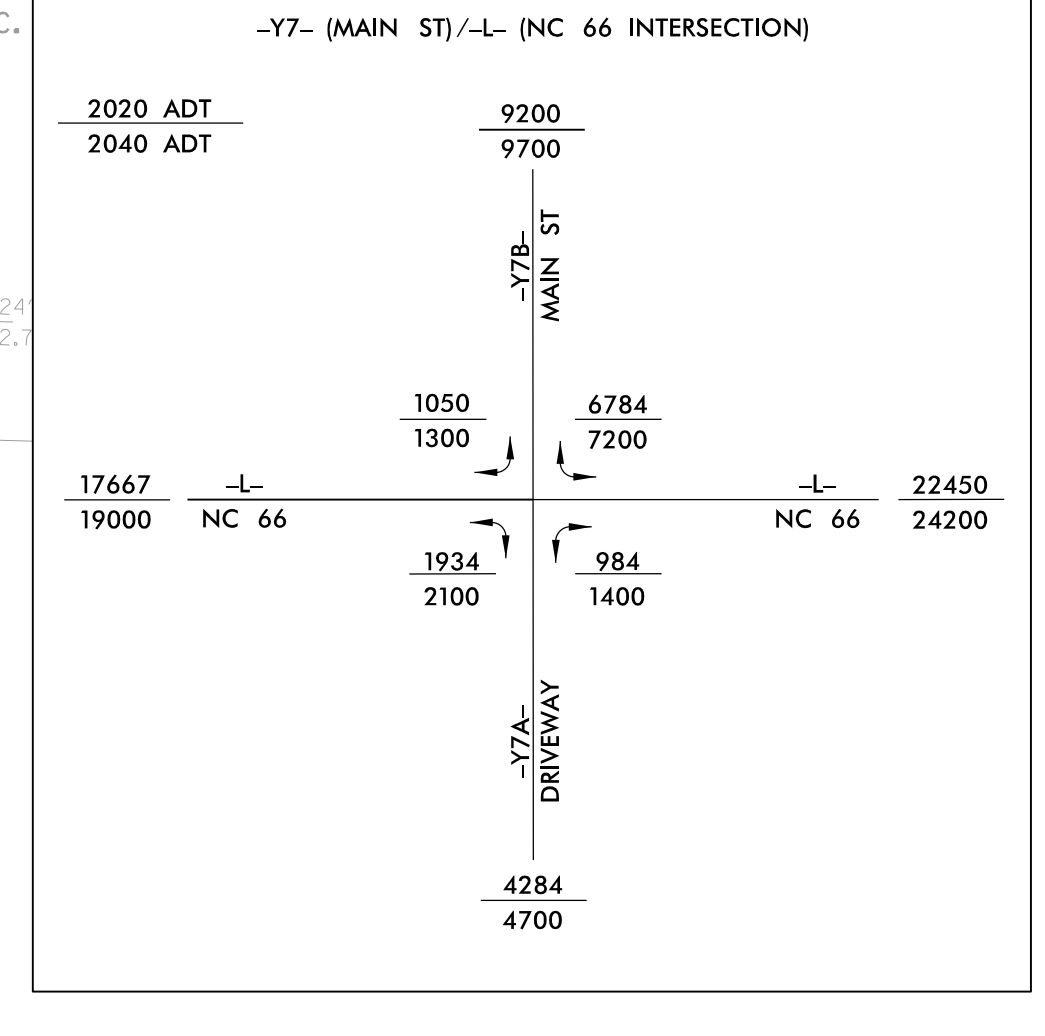
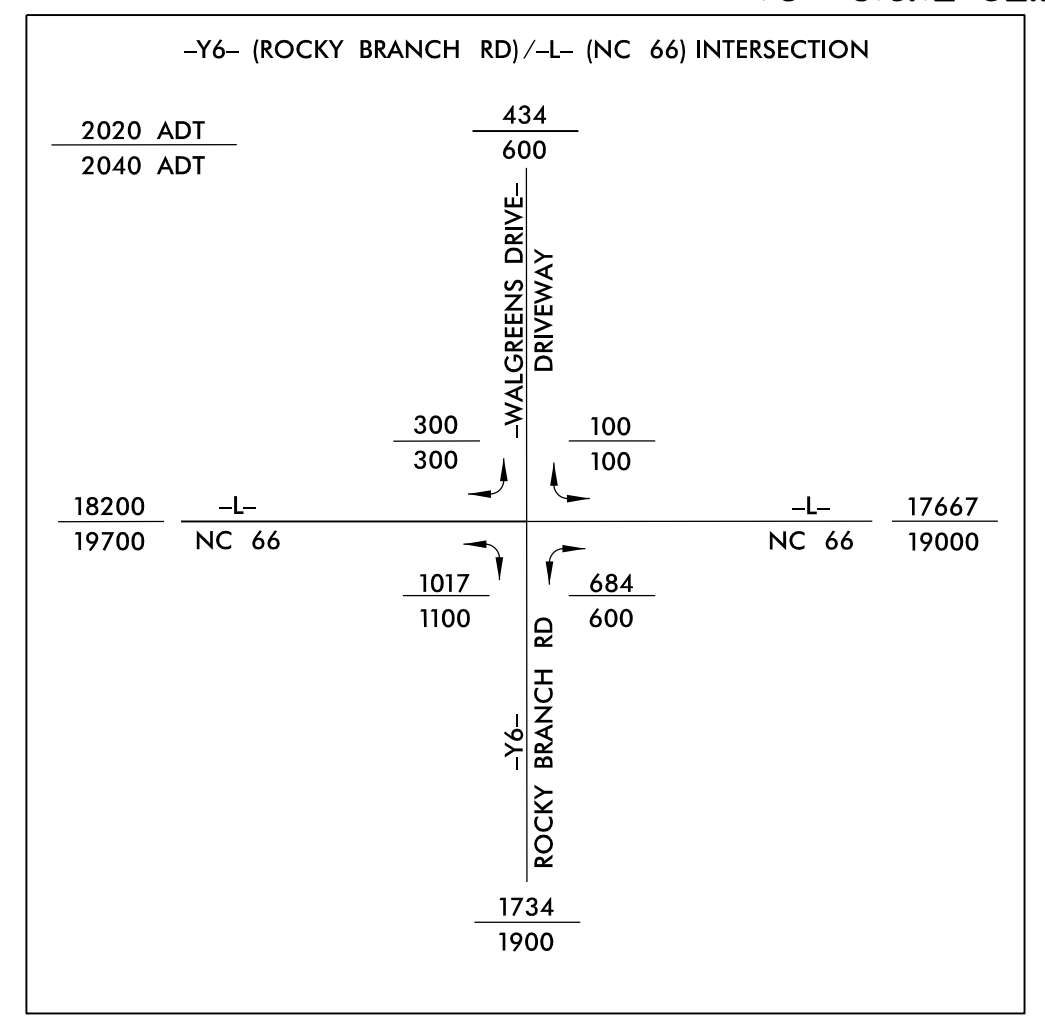
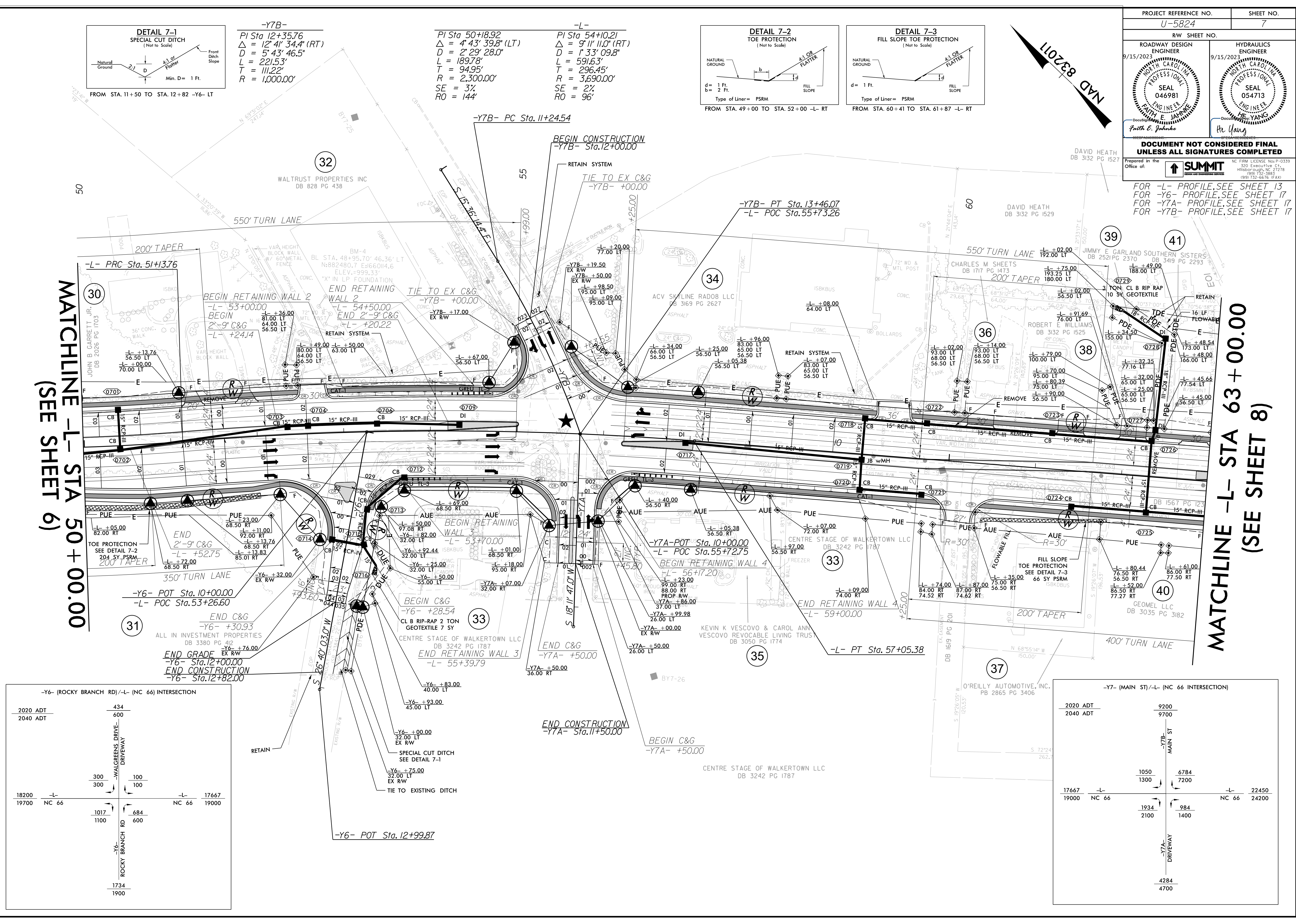

REVISIONS

8.17.2023
06:52:11, R:\C:\ash\c...
06-SEP-2023 15:17
06:52:11, R:\C:\ash\c...
06-SEP-2023 15:17
06:52:11, R:\C:\ash\c...