

15+00

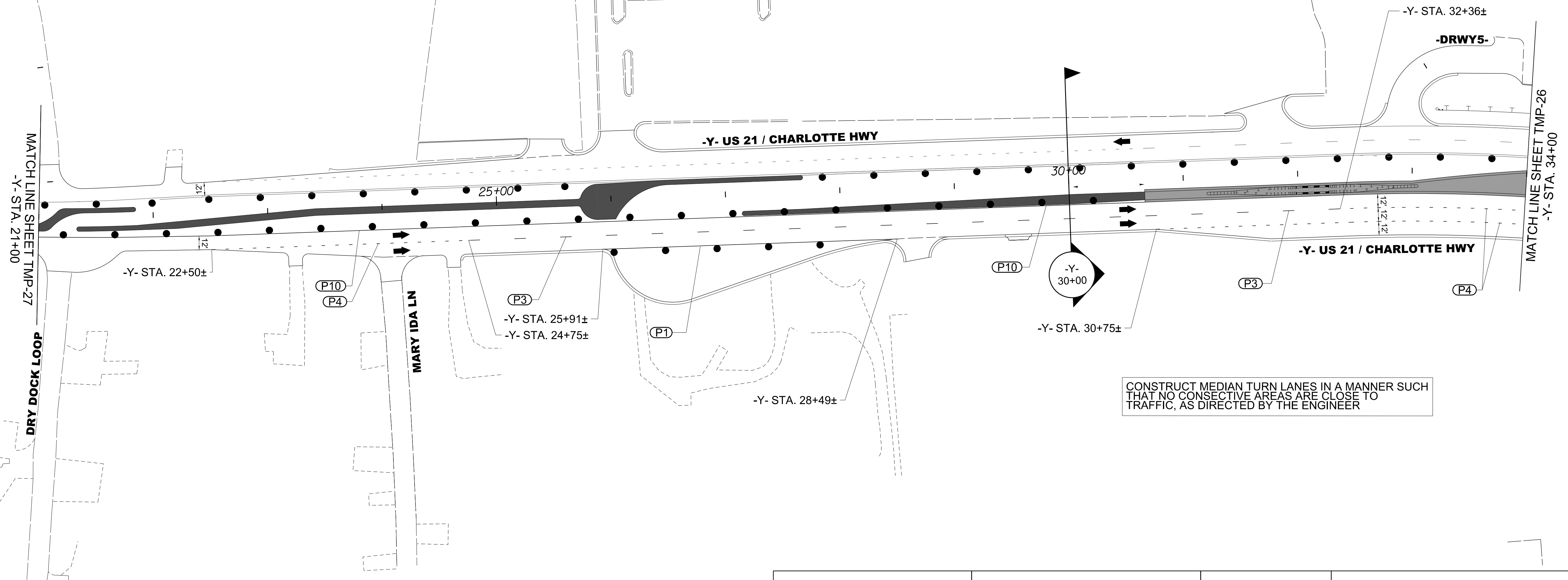

CONSTRUCT MEDIAN TURN LANES IN A MANNER SUCH THAT NO CONSECUTIVE AREAS ARE CLOSE TO TRAFFIC, AS DIRECTED BY THE ENGINEER

5/1/2023
 U:\Traffic\Transportation Management\Plan\TCP\PLAN SHEETS\IR-3833C-TMP-28_PHASE 3.dgn
 angood

Stantec Consulting Services Inc.
 801 Jones Franklin Road
 Suite 300
 Raleigh, NC 27606
 Tel. 919.851.6866
 Fax. 919.851.7024
 www.stantec.com
 License No. F-0672

5/1/2023

**DOCUMENT NOT CONSIDERED FINAL
 UNLESS ALL SIGNATURES COMPLETED**

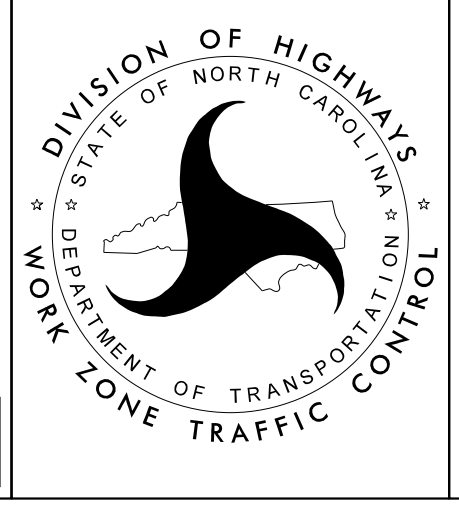

**-L- BRAWLEY SCHOOL RD
 PHASE III
 STEP 1**