

09.08/2019

See Sheet 1A For Index of Sheets
See Sheet 1B For Conventional Symbols

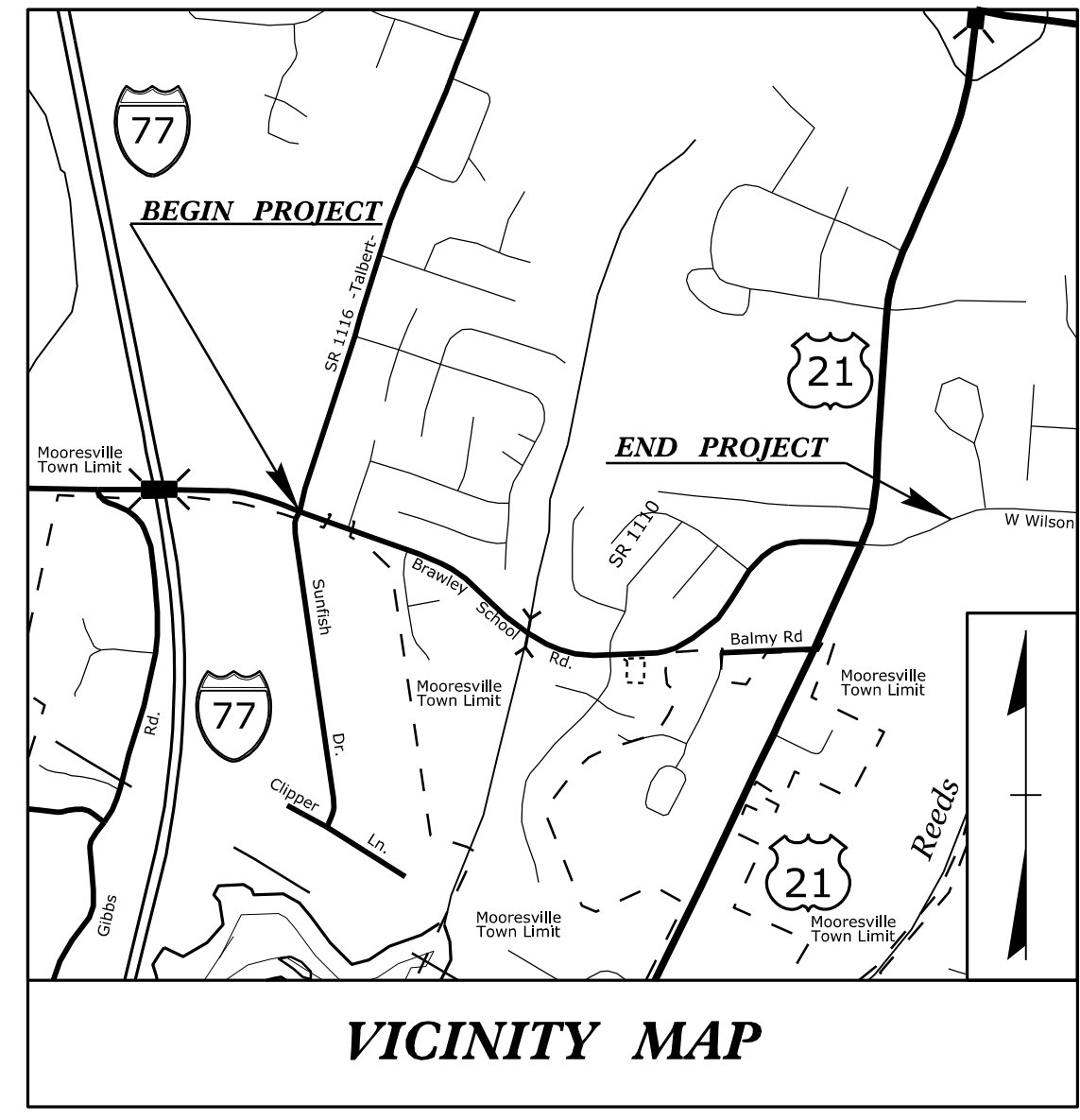

STATE OF NORTH CAROLINA
DIVISION OF HIGHWAYS
IREDELL COUNTY

**LOCATION: SR 1100 BRAWLEY SCHOOL ROAD FROM
SR 1116 TALBERT ROAD TO
1000' EAST OF US 21**
**TYPE OF WORK: GRADING, PAVING, WIDENING,
DRAINAGE, CULVERT, WALLS, SIGNALS**

STATE	STATE PROJECT REFERENCE NO.	SHEET NO.	TOTAL SHEETS
N.C.	R-3833C	1	
STATE PROJ. NO.	F.A. PROJ. NO.	DESCRIPTION	
34554.1.3		P.E	
34554.2.4		R/W	
34554.2.5		UTIL	
34554.3.3		CONSTRUCTION	

TIP PROJECT: R-3833C

CONTRACT: C204852

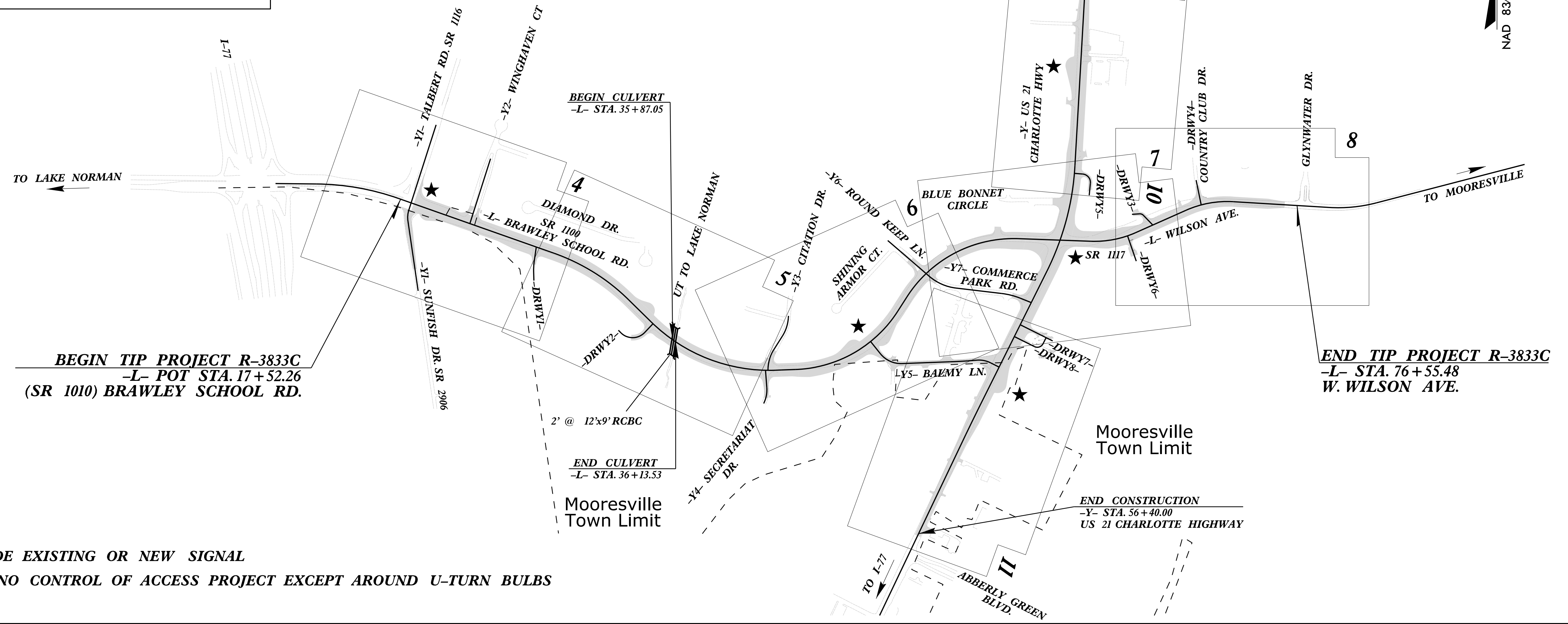

★ UPGRADE EXISTING OR NEW SIGNAL
THIS IS A NO CONTROL OF ACCESS PROJECT EXCEPT AROUND U-TURN BULBS

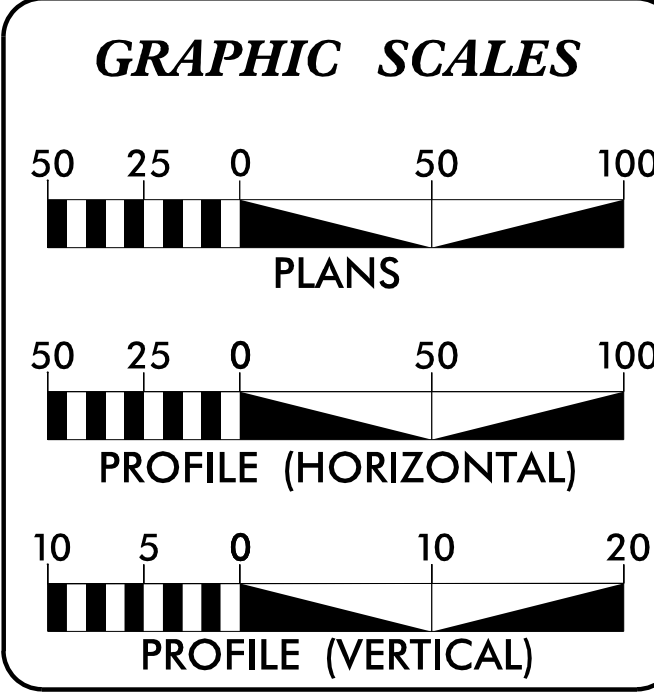

DESIGN DATA

ADT 2023 =	21172
ADT 2040 =	28200
K =	10 %
D =	55 %
T =	4 % *
V =	45 MPH
* TTST =	1% DUAL = 3%
FUNCTIONAL CLASSIFICATION =	MAJOR RURAL COLLECTOR

PROJECT LENGTH

ROADWAY LENGTH TIP PROJECT R-3833C = 1.113 miles
STRUCTURE LENGTH TIP PROJECT R-3833C = 0.005 miles
TOTAL LENGTH TIP PROJECT R-3833C = 1.118 miles

Prepared In The Offices of:

Stantec
Stantec Consulting Services Inc.
801 Jones Franklin Road
Suite 300
Raleigh, NC 27606
Tel: (919) 851-5890
www.stantec.com
License No. F-2012

TGS ENGINEERS
709 HILLSBOROUGH ST., SUITE 200
RALEIGH, NC 27603
PH: (919) 773-8687
CORP. LICENSE NO. C-2075

FALCON ENGINEERING
FALCON ENGINEERING, INC.
1741 HEBBY ROAD, SUITE 110
CARY, NC 27513
PHONE: (919) 671-1885
www.falconeng.com
Corporate License Number C01918

for the North Carolina Department of Transportation

2018 STANDARD SPECIFICATIONS

RIGHT OF WAY DATE:
SEPTEMBER 30, 2018

LETTING DATE:
OCTOBER 17, 2023

STANTEC CONTACT:
A. DEAN SARVIS, P.E.
PROJECT ENGINEER

NCDOT DIVISION 12 CONTACT:
BRYAN SOWELL, PE
PROJECT MANAGER

HYDRAULICS ENGINEER

DocuSigned by:
Benjamin J. Henegar
SIGNATURE: [Signature]
P.E.
8/16/2023

ROADWAY DESIGN ENGINEER

DocuSigned by:
A. Dean Sarvis
SIGNATURE: [Signature]
P.E.
8/16/2023

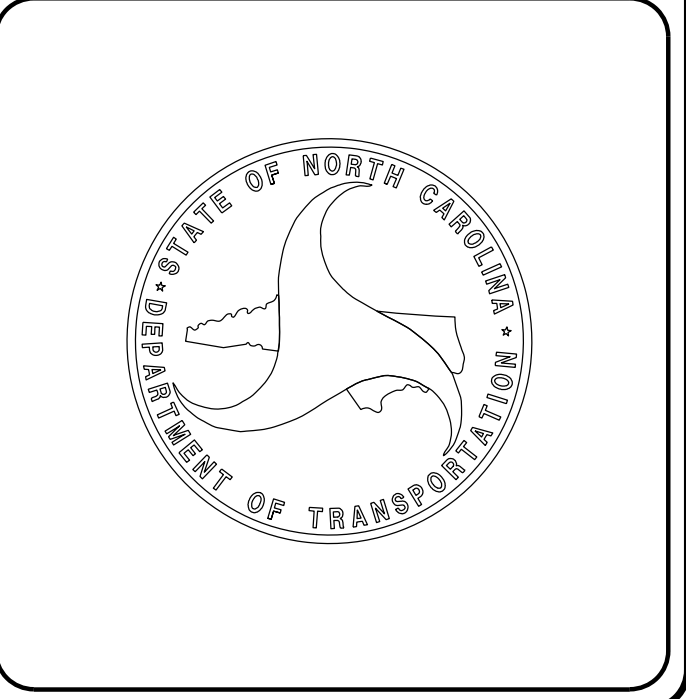

8/16/2023
U:\Roadway\Proj\NR3833C.rdy_tsh.dgn
DSarvis