

09/28/2019

See Sheet 1A For Index of Sheets
See Sheet 1B For Conventional Symbols

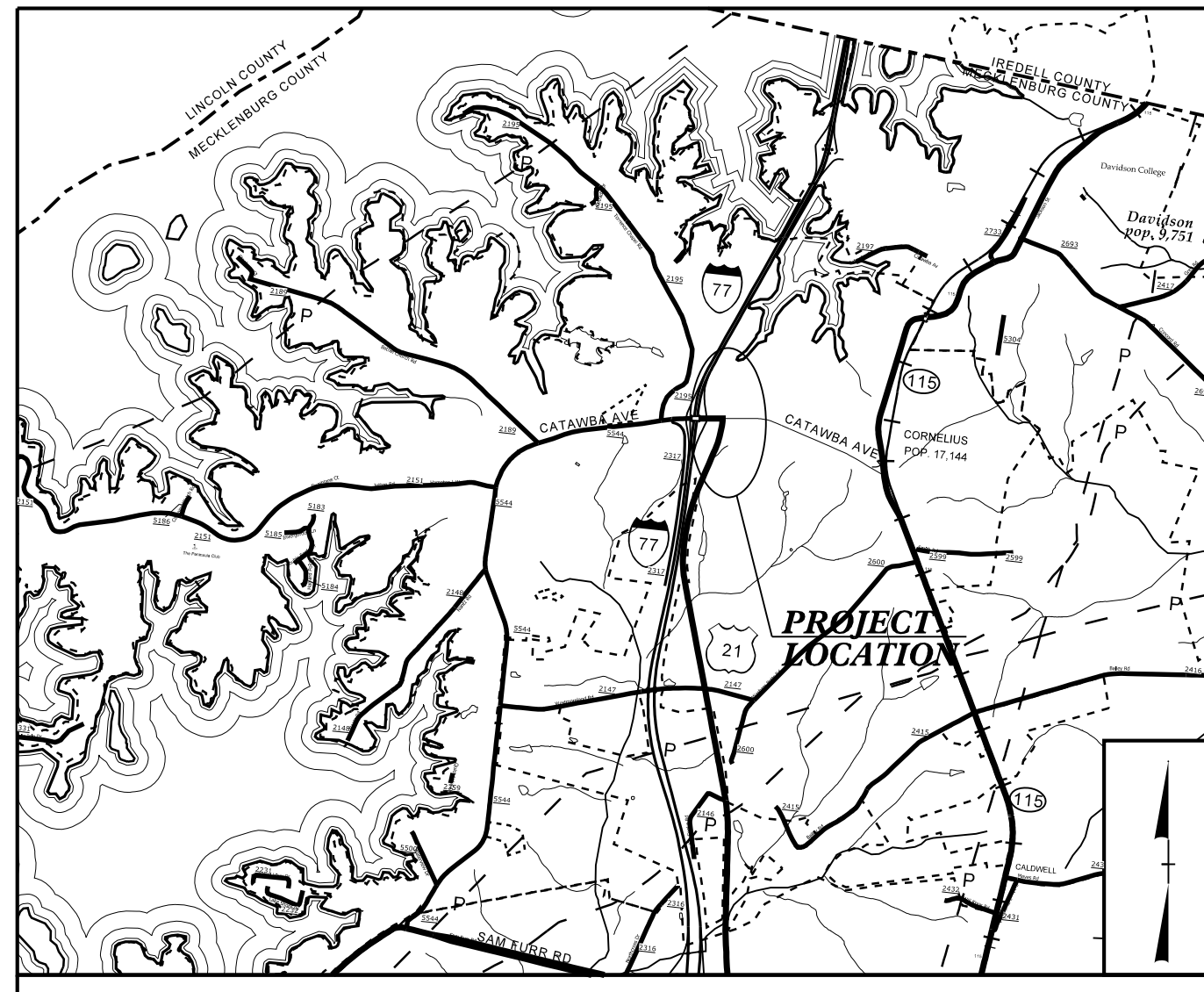

VICINITY MAP N.T.S

STATE OF NORTH CAROLINA
DIVISION OF HIGHWAYS

MECKLENBURG COUNTY

**LOCATION: DUAL ROUNDABOUTS NORTH AND SOUTH OF
SR 5544 (CATAWBA AVE.) AND
US 21 INTERSECTION IN CORNELIUS**

TYPE OF WORK: GRADING, DRAINAGE, PAVING, SIGNALS AND WALLS

STATE	STATE PROJECT REFERENCE NO.	SHEET NO.	TOTAL SHEETS
N.C.	C-5621	1	
STATE PROJ. NO.	F.A. PROJ. NO.	DESCRIPTION	
50146.1.F1	N/A	PE	
50146.2.1	N/A	RW, UTILITY	
50146.3.1	CMS-0021(020)	CONST.	

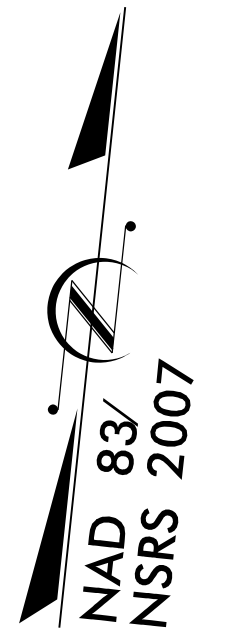

TIP PROJECT: C-5621

CONTRACT: C204495

-RA2- CENTER OF CIRCLE =
-Y2- STA. 10+00.00 (O/S 7.5')
-Y6- STA. 14+15.78 (O/S 7.5')
-Y7- STA. 10+00.00 (O/S 7.5')

BEGIN TIP PROJECT C-5621
-L- STA. 11+30.00

BEGIN CONSTRUCTION
-L- STA. 10+75.23

BEGIN CONSTRUCTION
-DRIVEI- STA. 10+25.00
BEGIN CONSTRUCTION
-Y4- STA. 10+80.00

-RA1- CENTER OF CIRCLE =
-Y1A- STA. 18+56.89 (O/S 7.5')
-Y1B- STA. 10+00.00 (O/S 7.5')
-Y4- STA. 12+66.96 (O/S 7.5')

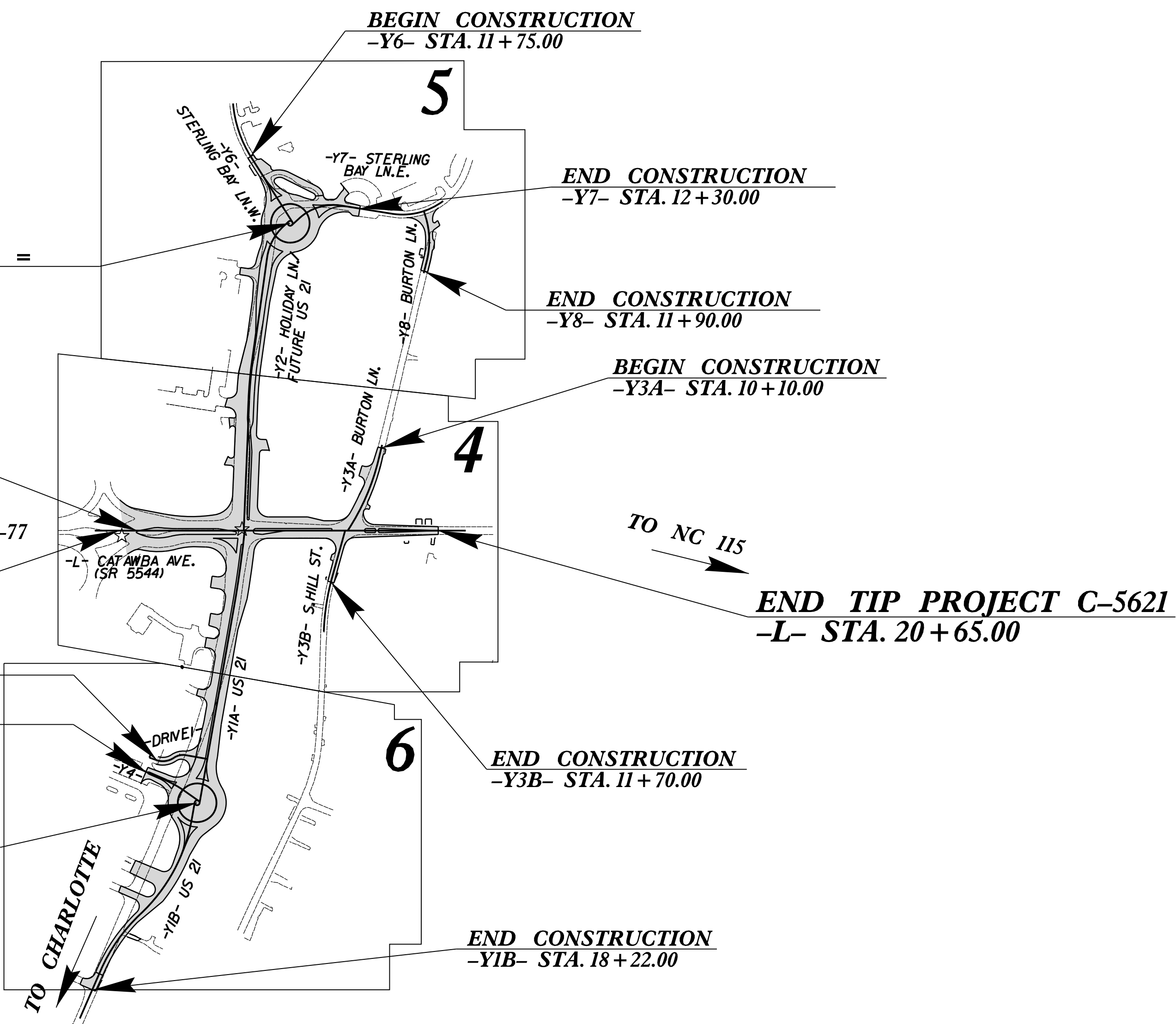

BEGIN CONSTRUCTION
-Y6- STA. 11+75.00

END CONSTRUCTION
-Y7- STA. 12+30.00

END CONSTRUCTION
-Y8- STA. 11+90.00

BEGIN CONSTRUCTION
-Y3A- STA. 10+10.00

END TIP PROJECT C-5621
-L- STA. 20+65.00

END CONSTRUCTION
-Y3B- STA. 11+70.00

END CONSTRUCTION
-Y1B- STA. 18+22.00

THERE IS FULL CONTROL OF ACCESS ON THIS PROJECT.

★ EXISTING SIGNAL DOCUMENT NOT CONSIDERED FINAL UNLESS ALL SIGNATURES COMPLETED

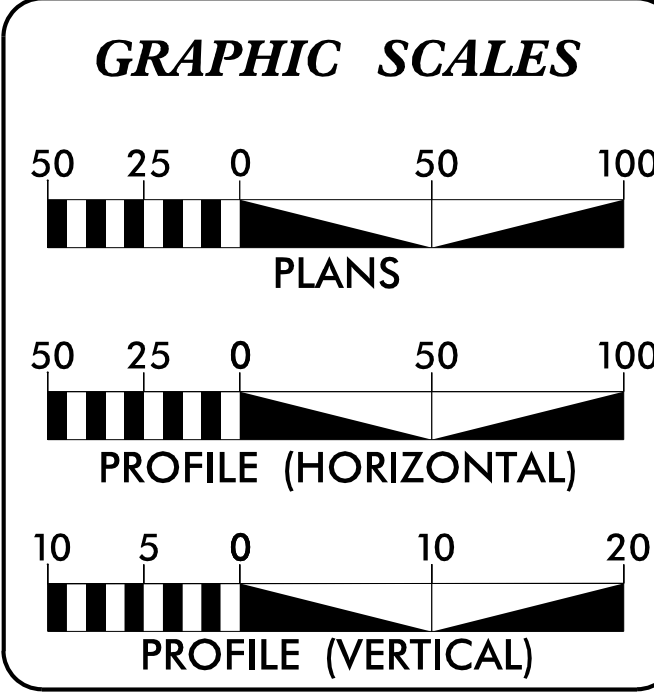

DESIGN DATA

ADT 2023 =	26,000
ADT 2040 =	45,517
K =	10 %
D =	60 %
T =	4 % *
V =	40 MPH
* TTST =	1 DUAL 3
FUNC CLASS =	LOCAL
REGIONAL TIER	

PROJECT LENGTH

LENGTH ROADWAY TIP PROJECT C-5621 =	0.187 MILES
TOTAL LENGTH TIP PROJECT C-5621 =	0.187 MILES
-L- USED TO CALCULATE PROJECT LENGTH.	

PREPARED IN THE OFFICE OF:

RS&H 1520 SOUTH BOULEVARD, SUITE 200
CHARLOTTE, NC 28203
NC FIRM LICENSE No: F-0493

FOR THE NORTH CAROLINA DEPARTMENT OF TRANSPORTATION

2018 STANDARD SPECIFICATIONS

RIGHT OF WAY DATE:
JUNE 26, 2019

LETTING DATE:
OCTOBER 17, 2023

JENNIFER FARINO, PE PROJECT ENGINEER
SEAN KORTOVICH, PE PROJECT DESIGN ENGINEER
SEAN EPPERSON, PE NCDOT CONTACT

HYDRAULICS ENGINEER

DocuSigned by:
Alexander R. Vinson
E790C5A478942E
SIGNATURE: P.E. 7/18/2023

ROADWAY DESIGN ENGINEER

DocuSigned by:
SEAN EPPERSON
E79011E857D08415
SIGNATURE: P.E. 7/18/2023

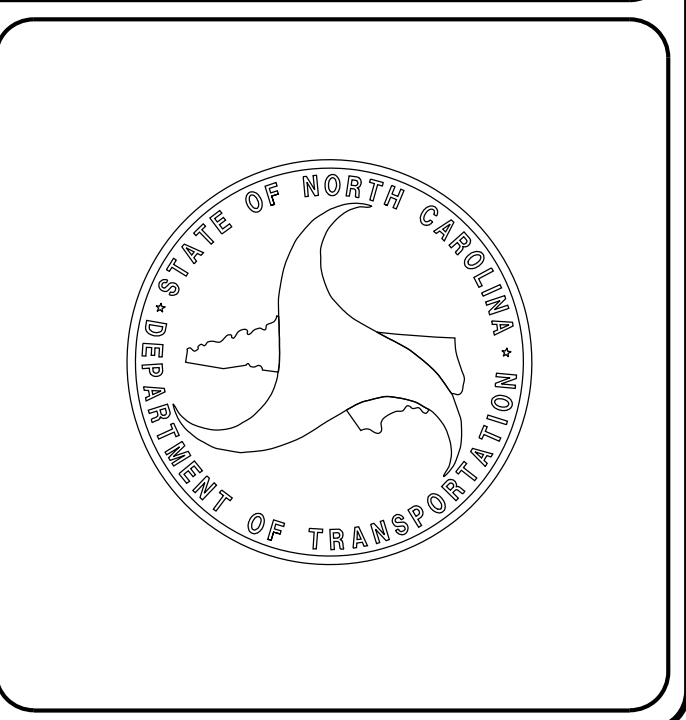

18-JUL-2023 08:41 R:\Roadway\Proj\N_C5621_Rdy_1.sh.dgn \$\$\$USERNAME\$\$\$