

| | |
|-------------------------|---------------------|
| PROJECT REFERENCE NO. | SHEET NO. |
| HE-0011 | EC1V/CONST.7 |
| RW SHEET NO. | HYDRAULICS ENGINEER |
| ROADWAY DESIGN ENGINEER | |

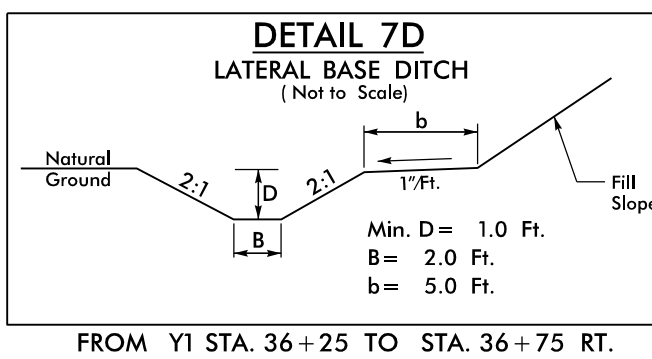

-Y1-
 PI Sta 32+60.23
 $\Delta = 20^{\circ}09'51.7"$ (LT)
 $D = 2^{\circ}29'28.0"$
 $L = 809.45'$
 $T = 408.95'$
 $R = 2,300.00'$
 $SE = 04$
 $RO = 144$

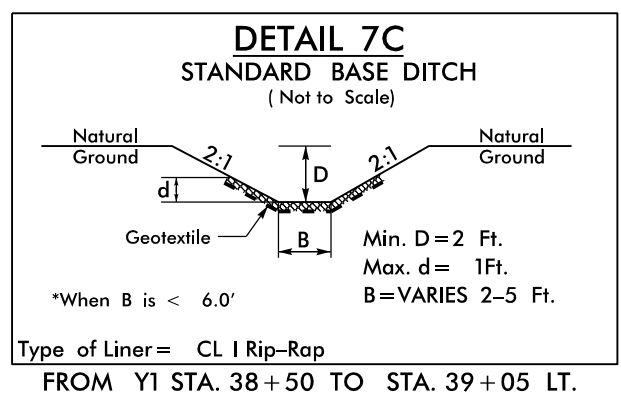
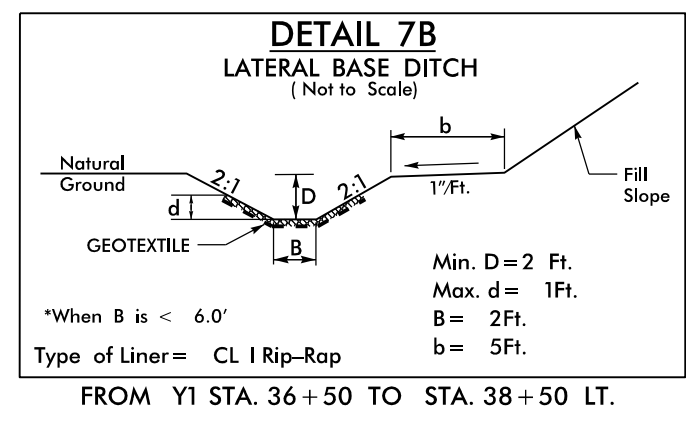
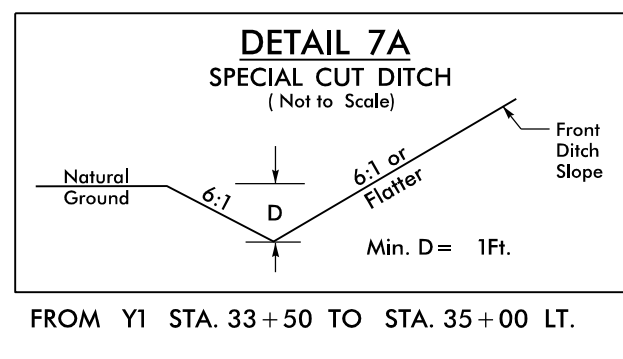

**FINAL PHASE
 EROSION CONTROL FOR
 CONSTRUCTION SHEET 7**

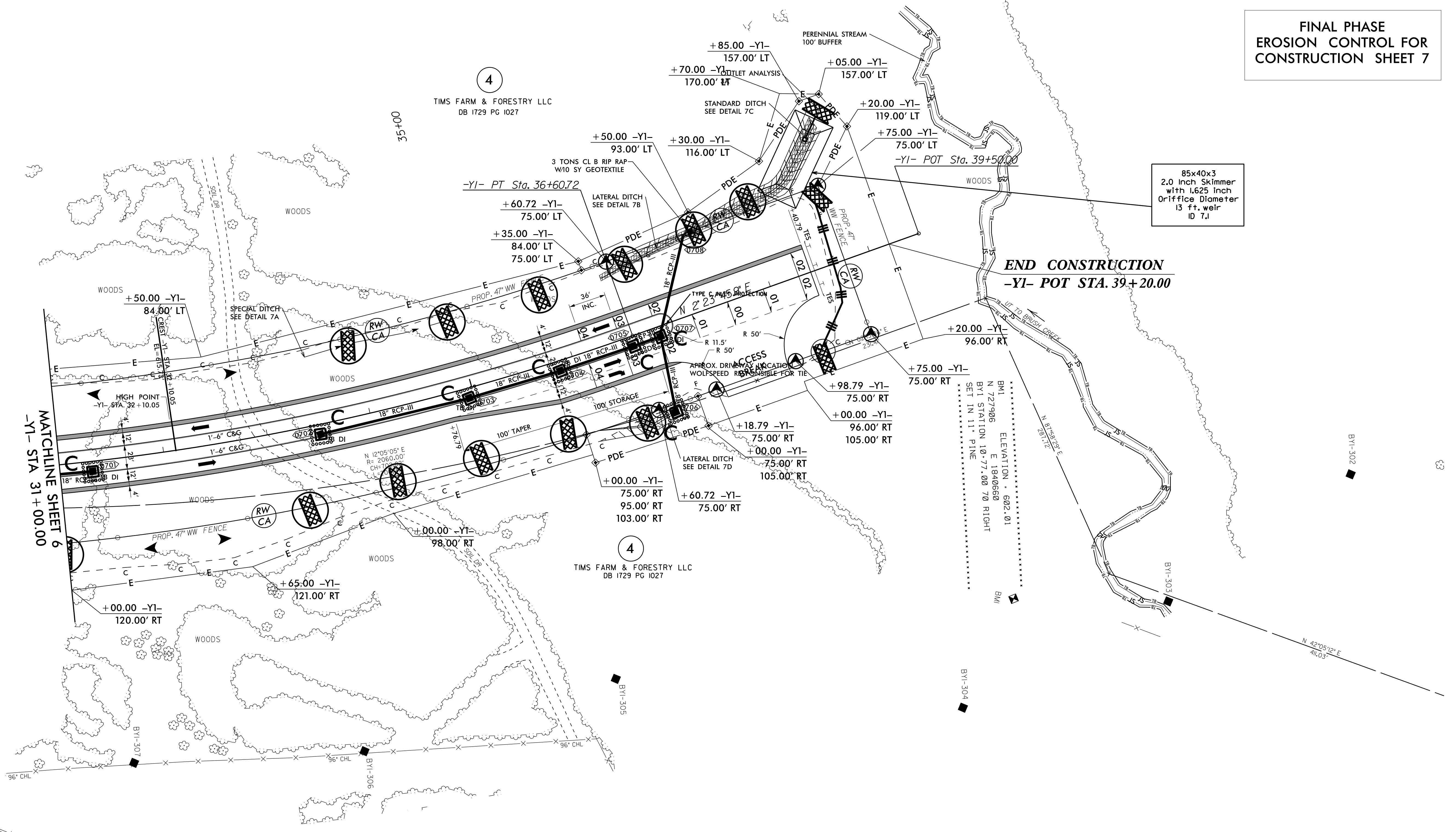

85x40x3
 2.0 inch Skimmer
 with 1/2 inch
 Orifice Diameter
 13 ft. weir
 ID 7.1

END CONSTRUCTION
 -Y1- POT STA. 39+20.00

FOR -Y1- PROFILE, SEE SHEET 9

8/17/99
 SSSJULSERNAMESS\$
 17 JUL 2023 15:24
 pw/gfnet-pw.bentley.com/gfnet-pw-01/Documents/Projects/691725-WorkingTask_017 - Chatham County SiteErosion Control/CADD/PSHE-0011_rdy_psh07_EC11.dgn