

STATE OF NORTH CAROLINA
DIVISION OF HIGHWAYS

TRANSPORTATION MANAGEMENT PLAN

CHEROKEE COUNTY

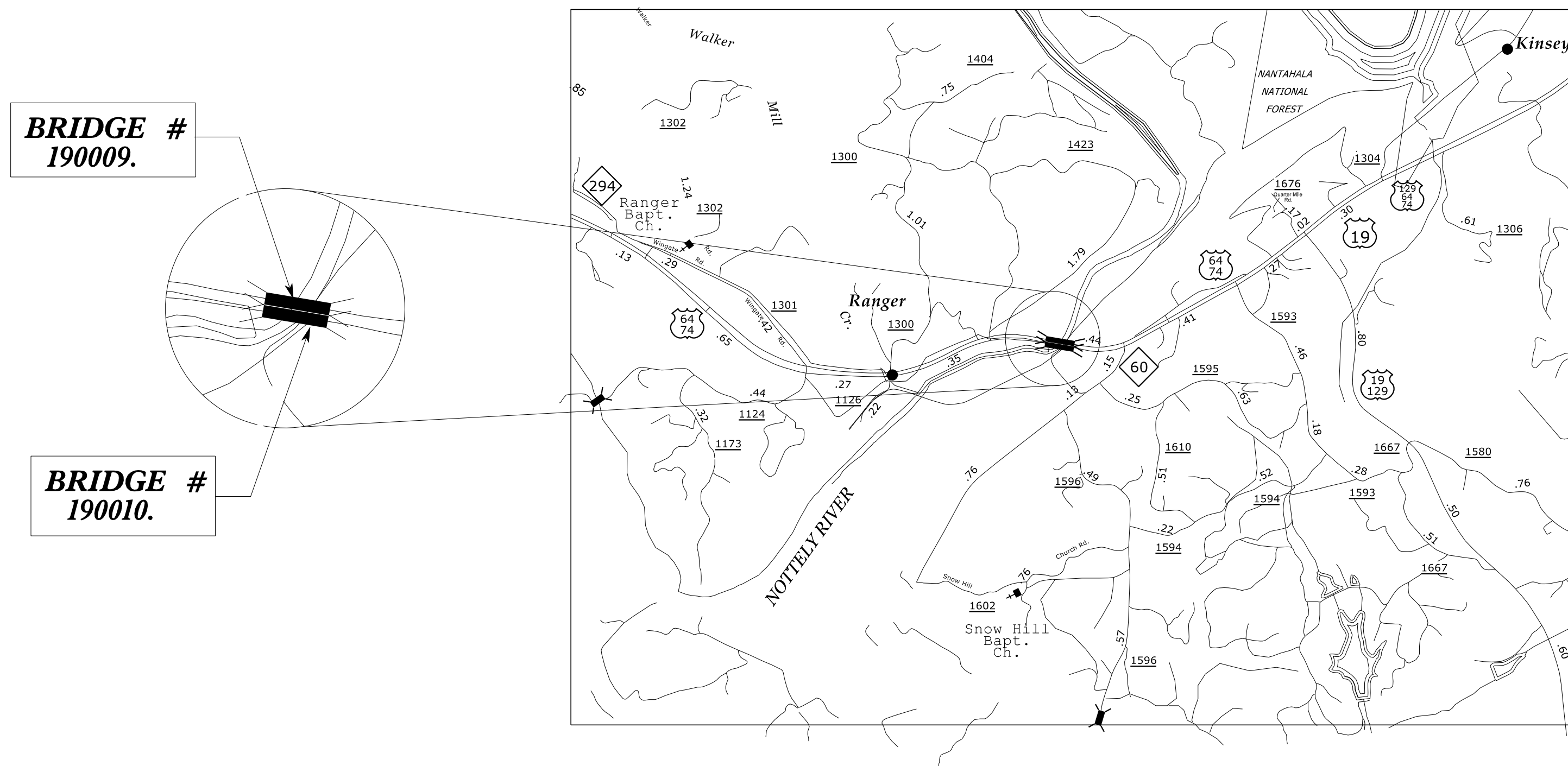
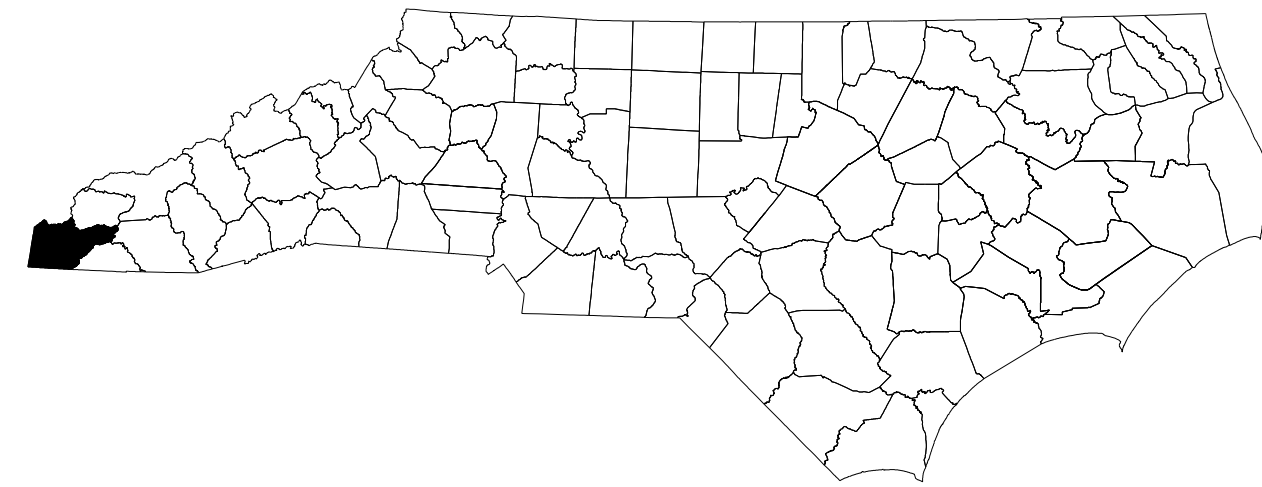

**LOCATION: BRIDGE NO. 190009 ON US 64 & US 74 EBL OVER NOTTELEY RIVER AND GRAVEL RD.
BRIDGE NO. 190010 ON US 64 & US 74 WBL OVER NOTTELEY RIVER AND GRAVEL RD.**

TYPE OF WORK: BRIDGE PRESERVATION - DECK REPAIR, LATEX MODIFIED CONCRETE (LMC) OVERLAY, FOAM JOINT SEALS FOR PRESERVATION, LINK SLAB FOR PRESERVATION, REPAIRS TO PRESTRESSED CONCRETE GIRDERS, PAINTING EXISTING WEATHERING STEEL BEAM ENDS, PAINTING EXISTING NON WEATHERING STEEL BEAMS, CLEANING AND PAINTING EXISTING BEARING WITH HRCSA, EPOXY COATING CONCRETE GIRDER ENDS, EPOXY COATING AND DEBRIS REMOVAL FROM TOP OF END BENT AND BENT CAPS, SUBSTRUCTURE REPAIR.

SHEET NO.	TITLE
TMP-1	TITLE SHEET, VICINITY MAP, AND INDEX OF SHEETS
TMP-1A	LIST OF APPLICABLE ROADWAY STANDARD DRAWINGS, AND LEGEND
TMP-1B	TRANSPORTATION OPERATIONS PLAN: GENERAL NOTES AND PHASING
TMP-2	TYPICAL SECTIONS
TMP-3	PLAN VIEW - TRAFFIC SHIFT

SHEET NO.
TMP-1

15BPR.125.3

TIP PROJECT:

6/8/2023
N:\Special\15BPR\TrafficControl\15BPR.61.TC.TMP.L.dgn
User:kdalis

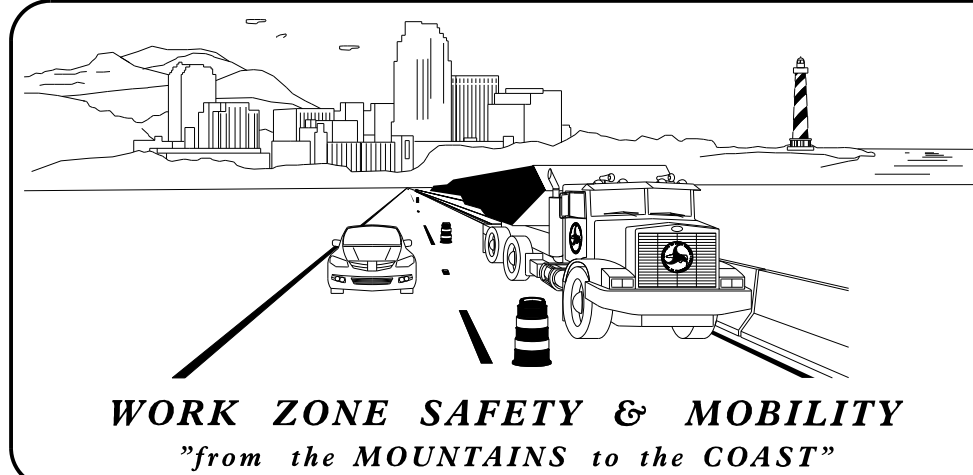

PLANS PREPARED BY:
HABIB A. LAWANDOS

NCDOT CONTACTS:
ZACHARY T. CLARK, P.E.
PROJECT ENGINEER
KARMEN E. DAIS, P.E.
PROJECT DESIGN ENGINEER

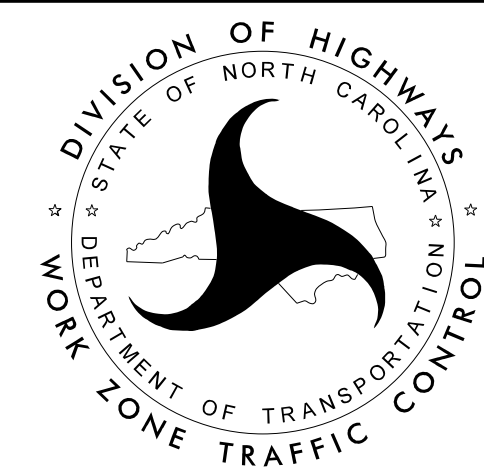

DOCUMENT NOT CONSIDERED FINAL
UNLESS ALL SIGNATURES COMPLETED

APPROVED: *Zachary T. Clark*
DATE: 06/09/2023

SEAL
NORTH CAROLINA
PROFESSIONAL
SEAL
045090
ENGINEER
ZACHARY T. CLARK

ROADWAY STANDARD DRAWINGS

THE FOLLOWING ROADWAY STANDARDS AS SHOWN IN "ROADWAY STANDARD DRAWINGS" - N.C. DEPARTMENT OF TRANSPORTATION - RALEIGH, N.C., DATED JANUARY 2018 ARE APPLICABLE TO THIS PROJECT AND BY REFERENCE HEREBY ARE CONSIDERED A PART OF THESE PLANS:

STD. NO.	TITLE
1101.01	WORK ZONE WARNING SIGNS
1101.02	TEMPORARY LANE CLOSURES
1101.03	TEMPORARY ROAD CLOSURES
1101.04	TEMPORARY SHOULDER CLOSURES
1101.05	WORK ZONE VEHICLE ACCESSES
1101.11	TRAFFIC CONTROL DESIGN TABLES
1110.01	STATIONARY WORK ZONE SIGNS
1110.02	PORTABLE WORK ZONE SIGNS
1115.01	FLASHING ARROW BOARDS
1130.01	DRUMS
1135.01	CONES
1145.01	BARRICADES
1165.01	TRUCK MOUNTED ATTENUATOR
1180.01	SKINNY - DRUMS
1205.01	PAVEMENT MARKINGS - LINE TYPES AND OFFSETS
1205.02	PAVEMENT MARKINGS - TWO LANE AND MULTILANE ROADWAYS
1205.12	PAVEMENT MARKINGS - BRIDGES
1250.01	RAISED PAVEMENT MARKERS - INSTALLATION SPACING
1251.01	RAISED PAVEMENT MARKERS - (PERMANENT AND TEMPORARY)

LEGEND

GENERAL

- DIRECTION OF TRAFFIC FLOW
- DIRECTION OF PEDESTRIAN TRAFFIC FLOW
- EXIST. PVMT.
- NORTH ARROW
- PROPOSED PVMT.
- TEMP. SHORING (LOCATION PURPOSES ONLY)
- WORK AREA
- REMOVAL

SIGNALS

- EXISTING
- PROPOSED
- TEMPORARY
- PORTABLE

PAVEMENT MARKINGS

- EXISTING LINES
- TEMPORARY LINES

TRAFFIC CONTROL DEVICES

- BARRICADE (TYPE III)
- CONE
- DRUM
- SKINNY DRUM
- TUBULAR MARKER
- TEMPORARY CRASH CUSHION
- FLASHING ARROW BOARD
- FLAGGER
- LAW ENFORCEMENT
- TRUCK MOUNTED ATTENUATOR (TMA)
- CHANGEABLE MESSAGE SIGN

TEMPORARY SIGNING

- PORTABLE SIGN
- STATIONARY SIGN
- STATIONARY OR PORTABLE SIGN

PAVEMENT MARKERS

- CRYSTAL/CRYSTAL
- CRYSTAL/RED
- YELLOW/YELLOW

PAVEMENT MARKING SYMBOLS

- PAVEMENT MARKING SYMBOLS

TEMPORARY PAVEMENT MARKING

- COLD APPLIED PLASTIC TYPE IV - REMOVABLE TAPE
- C1- WHITE EDGELINE (4")

APPROVED: DATE: 06/09/2023			ROADWAY STANDARD DRAWINGS & LEGEND
DOCUMENT NOT CONSIDERED FINAL UNLESS ALL SIGNATURES COMPLETED			

GENERAL NOTES

CHANGES MAY BE REQUIRED WHEN PHYSICAL DIMENSIONS IN THE DETAIL DRAWINGS, STANDARD DETAILS, AND ROADWAY DETAILS ARE NOT ATTAINABLE TO MEET FIELD CONDITIONS OR RESULT IN DUPLICATE OR UNDESIRABLE OVERLAPPING OF DEVICES. MODIFICATION MAY INCLUDE: MOVING, SUPPLEMENTING, COVERING, OR REMOVAL OF DEVICES AS DIRECTED BY THE ENGINEER.

THE FOLLOWING GENERAL NOTES APPLY AT ALL TIMES FOR THE DURATION OF THE CONSTRUCTION PROJECT EXCEPT WHEN OTHERWISE NOTED IN THE PLAN OR DIRECTED BY THE ENGINEER.

TIME RESTRICTIONS

A) DO NOT CLOSE OR NARROW TRAVEL LANES DURING HOLIDAYS AND SPECIAL EVENTS AS FOLLOWS:

ROAD NAME

US 64 / US 74

HOLIDAY

1. FOR ANY UNEXPECTED OCCURRENCE THAT CREATES UNUSUALLY HIGH TRAFFIC VOLUMES, AS DIRECTED BY THE ENGINEER.
2. FOR NEW YEAR'S, BETWEEN THE HOURS OF 6:00 A.M. DECEMBER 31st TO 7:00 P.M. JANUARY 2ND. IF NEW YEAR'S DAY IS ON A FRIDAY, SATURDAY, SUNDAY, OR MONDAY THEN UNTIL 7:00 P.M. THE FOLLOWING TUESDAY.
3. FOR EASTER, BETWEEN THE HOURS OF 6:00 A.M. THURSDAY AND 7:00 P.M. MONDAY.
4. FOR MEMORIAL DAY, BETWEEN THE HOURS OF 6:00 A.M. FRIDAY TO 7:00 P.M. TUESDAY.
5. FOR INDEPENDENCE DAY, BETWEEN THE HOURS OF 6:00 A.M. THE DAY BEFORE INDEPENDENCE DAY AND 7:00 P.M. THE DAY AFTER INDEPENDENCE DAY.

IF INDEPENDENCE DAY IS ON A FRIDAY, SATURDAY, SUNDAY OR MONDAY THEN BETWEEN THE HOURS OF 6:00 A.M. THE THURSDAY BEFORE INDEPENDENCE DAY AND 7:00 P.M. THE TUESDAY AFTER INDEPENDENCE DAY.
6. FOR LABOR DAY, BETWEEN THE HOURS OF 6:00 A.M. FRIDAY AND 7:00 P.M. TUESDAY.
7. FOR THANKSGIVING DAY, BETWEEN THE HOURS OF 6:00 A.M. TUESDAY TO 7:00 P.M. MONDAY.
8. FOR CHRISTMAS, BETWEEN THE HOURS OF 6:00 A.M. THE FRIDAY BEFORE THE WEEK OF CHRISTMAS DAY AND 7:00 P.M. THE FOLLOWING TUESDAY AFTER THE WEEK OF CHRISTMAS.
9. FOR LEAF SEASON, ALL WEEKENDS BETWEEN OCTOBER 12TH AND OCTOBER 31ST, BETWEEN THE HOURS OF 6:00 A.M. THE FRIDAY AND 7:00 P.M. THE FOLLOWING MONDAY.

C) DO NOT STOP TRAFFIC AS FOLLOWS:

ROAD NAME

US 64 / US 74

DAY AND TIME RESTRICTIONS DURATION & OPERATION

MONDAY THRU SUNDAY
6:00 A.M. - 7:00 P.M.
20 MINUTES FOR ANY TRAFFIC OPERATION
REQUIRING TRAFFIC TO BE STOPPED

LANE AND SHOULDER CLOSURE REQUIREMENTS

- B) REMOVE LANE CLOSURE DEVICES FROM THE LANE WHEN WORK IS NOT BEING PERFORMED BEHIND THE LANE CLOSURE OR WHEN A LANE CLOSURE IS NO LONGER NEEDED OR AS DIRECTED BY THE ENGINEER.
- C) WHEN PERSONNEL AND/OR EQUIPMENT ARE WORKING WITHIN 15 FT OF AN OPEN TRAVEL LANE, CLOSE THE NEAREST OPEN SHOULDER USING ROADWAY STANDARD DRAWING NO. 1101.04 UNLESS THE WORK AREA IS PROTECTED BY BARRIER OR GUARDRAIL OR A LANE CLOSURE IS INSTALLED.
- D) WHEN PERSONNEL AND/OR EQUIPMENT ARE WORKING ON THE SHOULDER ADJACENT TO AN UNDIVIDED FACILITY AND WITHIN 5 FT OF AN OPEN TRAVEL LANE, CLOSE THE NEAREST OPEN TRAVEL LANE USING ROADWAY STANDARD DRAWING NO. 1101.02 UNLESS THE WORK AREA IS PROTECTED BY BARRIER OR GUARDRAIL.
- E) WHEN PERSONNEL AND/OR EQUIPMENT ARE WORKING WITHIN A LANE OF TRAVEL OF AN UNDIVIDED OR DIVIDED FACILITY, CLOSE THE LANE ACCORDING TO THE TRAFFIC CONTROL PLANS, ROADWAY STANDARD DRAWINGS, OR AS DIRECTED BY THE ENGINEER. CONDUCT THE WORK SO THAT ALL PERSONNEL AND/OR EQUIPMENT REMAIN WITHIN THE CLOSED TRAVEL LANE.

- F) DO NOT WORK SIMULTANEOUSLY WITHIN 15 FT ON BOTH SIDES OF AN OPEN TRAVELWAY, RAMP, OR LOOP WITHIN THE SAME LOCATION UNLESS PROTECTED WITH GUARDRAIL OR BARRIER.

PAVEMENT EDGE DROP OFF REQUIREMENTS

- G) DO NOT EXCEED A DIFFERENCE OF 2 INCHES IN ELEVATION BETWEEN OPEN LANES OF TRAFFIC FOR NOMINAL LIFTS OF 1.5 INCHES. INSTALL ADVANCE WARNING "UNEVEN LANES" SIGNS (W8-11) IN ADVANCE AND A MINIMUM OF EVERY HALF MILE THROUGHOUT THE UNEVEN AREA.

TRAFFIC PATTERN ALTERATIONS

- H) NOTIFY THE ENGINEER THIRTY (30) CALENDAR DAYS PRIOR TO ANY TRAFFIC PATTERN ALTERATION.

SIGNING

- I) INSTALL ADVANCE WORK ZONE WARNING SIGNS WHEN WORK IS WITHIN 40 FT FROM THE EDGE OF TRAVEL LANE AND NO MORE THAN THREE (3) DAYS PRIOR TO THE BEGINNING OF CONSTRUCTION.
- J) ENSURE ALL NECESSARY SIGNING IS IN PLACE PRIOR TO ALTERING ANY TRAFFIC PATTERN.
- K) INSTALL BLACK ON ORANGE "DIP" SIGNS (W8-2) AND/OR "BUMP" SIGNS (W8-1) IN ADVANCE OF THE UNEVEN AREA, OR AS DIRECTED BY THE ENGINEER.

TRAFFIC CONTROL DEVICES

- L) WHEN LANE CLOSURES ARE NOT IN EFFECT SPACE CHANNELIZING DEVICES IN WORK AREAS NO GREATER IN FEET THAN TWICE THE POSTED SPEED LIMIT (MPH) EXCEPT, 10 FT ON-CENTER IN RADII, AND 3 FT OFF THE EDGE OF AN OPEN TRAVELWAY. REFER TO STANDARD SPECIFICATIONS FOR ROADS AND STRUCTURES SECTIONS 1130 (DRUMS), 1135 (CONES) AND 1180 (SKINNY DRUMS) FOR ADDITIONAL REQUIREMENTS.

PAVEMENT MARKINGS AND MARKERS

- M) INSTALL TEMPORARY PAVEMENT MARKINGS AND TEMPORARY PAVEMENT MARKERS ON INTERIM LAYERS OF PAVEMENT AS FOLLOWS:

ROAD NAME

US 64 / US 74

MARKING

COLD APPLIED PLASTIC
TYPE IV (REMOVABLE TAPE)

- N) TIE PROPOSED PAVEMENT MARKING LINES TO EXISTING PAVEMENT MARKING LINES.
- O) REMOVE/REPLACE ANY CONFLICTING/DAMAGED PAVEMENT MARKINGS AND MARKERS BY THE END OF EACH DAY'S OPERATION.

PHASING

PHASE I

STEP 1:
USING RSD 1101.01, SHEET 1 OF 3, INSTALL ADVANCE WORK ZONE WARNING SIGNS ON US 64 / US 74.

COMPLETE THE WORK REQUIRED OF PHASE I STEP 2 WITHIN FIFTEEN (15) CONSECUTIVE CALENDAR DAYS. SEE INTERMEDIATE CONTRACT TIMES AND LIQUIDATED DAMAGES.

NOTE: THE CONTRACTOR SHALL COORDINATE WITH THE ENGINEER WHICH LANE / DIRECTION TO START WITH, AND SHALL NOT CLOSE MORE THAN ONE LANE AT A TIME.

STEP 2:
USING RSD 1101.02, SHEET 4 OF 14 (WITH STATIONARY SIGNS IN LIEU OF PORTABLE SIGNS) AND SHEETS TMP-2 & TMP-3, PERFORM THE FOLLOWING:



- COMPLETE SCARIFICATION, HYDRODEMOLITION, AND LMC OVERLAY IN THE CLOSED LANE ACCORDING TO THE CONSTRUCTION PLANS.

- PLACE TEMPORARY PAVEMENT MARKING (COLD APPLIED PLASTIC) ON THE CONSTRUCTED LANE, COVER ALL SIGNS FOR LANE CLOSURE, AND OPEN THIS LANE TO TRAFFIC.

STEP 3:
REPEAT STEP 1 AND STEP 2 FOR EACH LANE ON BOTH DIRECTIONS OF US 64 / US 74.

STEP 4:
AFTER COMPLETION OF PROPOSED CONSTRUCTION ON BOTH BRIDGES USE SHORT TERM LANE CLOSURE, RSD 1101.02, SHEET 4 OF 14, PLACE FINAL MARKINGS AND MARKERS IN THE ORIGINAL PATTERN.

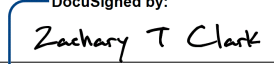
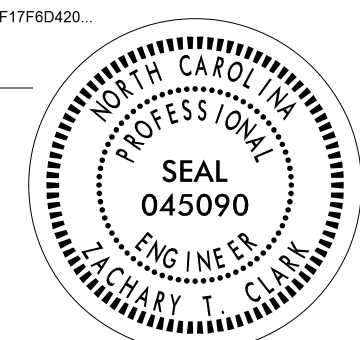
STEP 5:
REMOVE ALL REMAINING TRAFFIC CONTROL DEVICES AND OPEN THE TWO BRIDGES TO FINAL TRAFFIC PATTERN.

APPROVED:  DATE: 06/09/2023 		TRANSPORTATION OPERATIONS PLAN: GENERAL NOTES AND PHASING
DOCUMENT NOT CONSIDERED FINAL UNLESS ALL SIGNATURES COMPLETED		

BRIDGE #: 190009
US 64 / US 74 EB

THE DURATION OF ANY LANE CLOSURE IS
FIFTEEN (15) CONS. CALENDAR DAYS ONLY

BRIDGE #: 190010
US 64 / US 74 WB

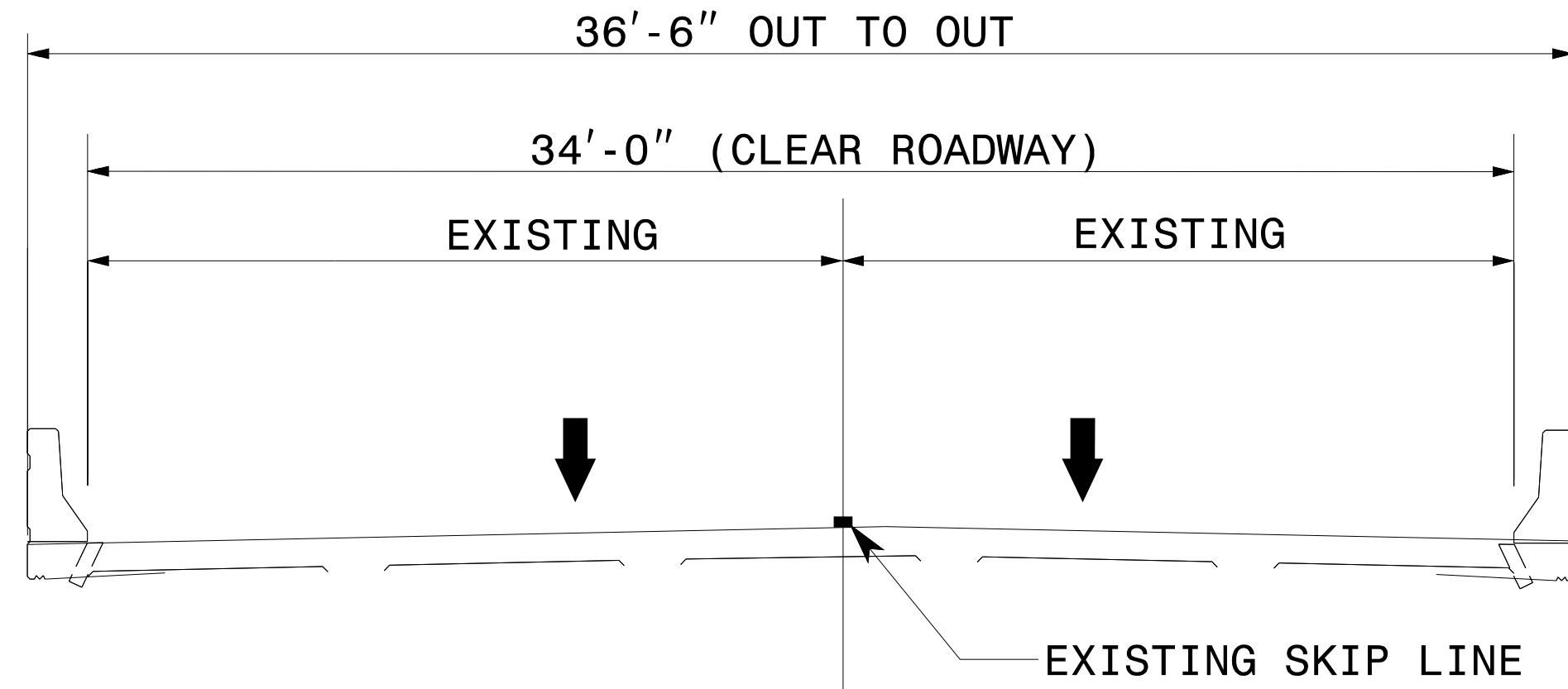

EXISTING

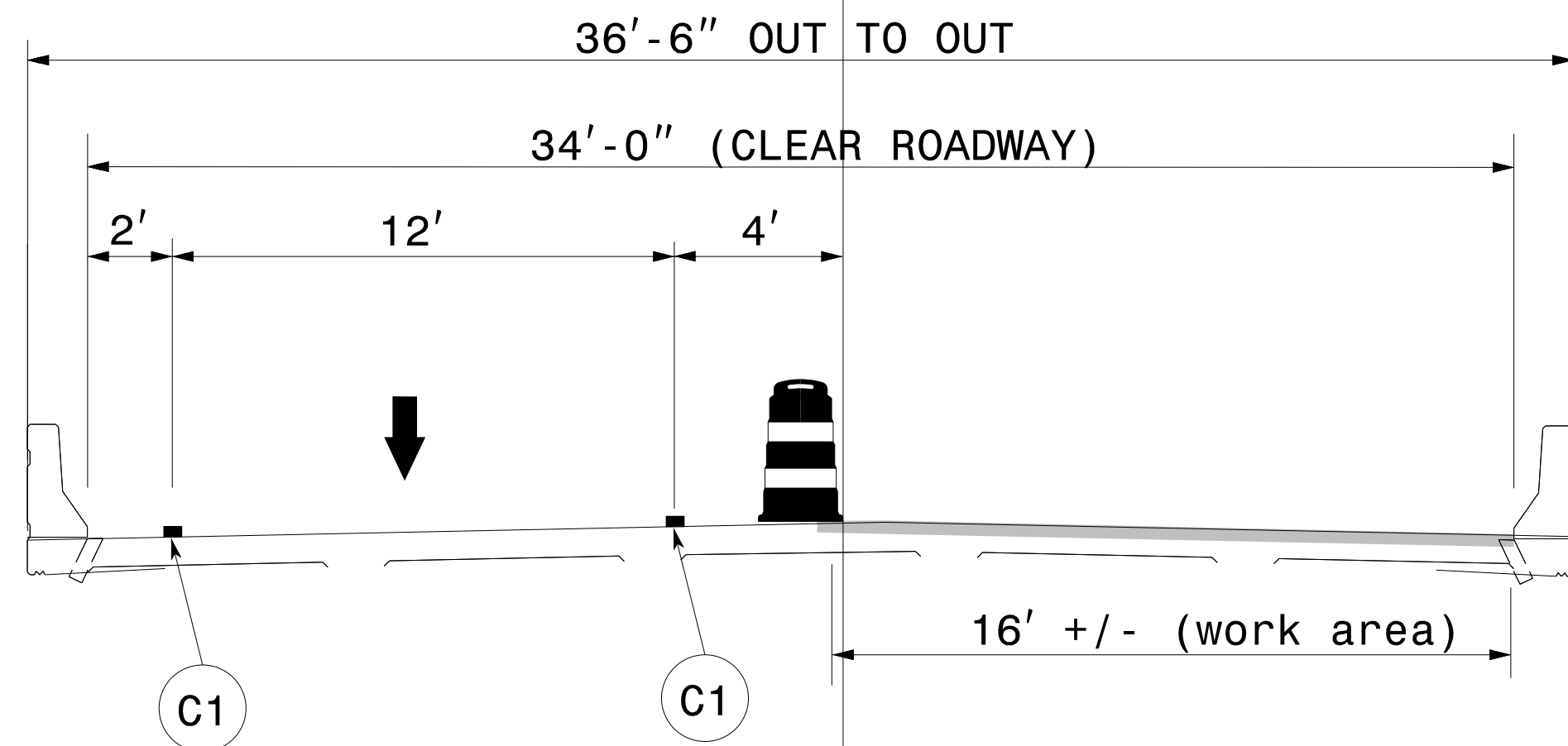
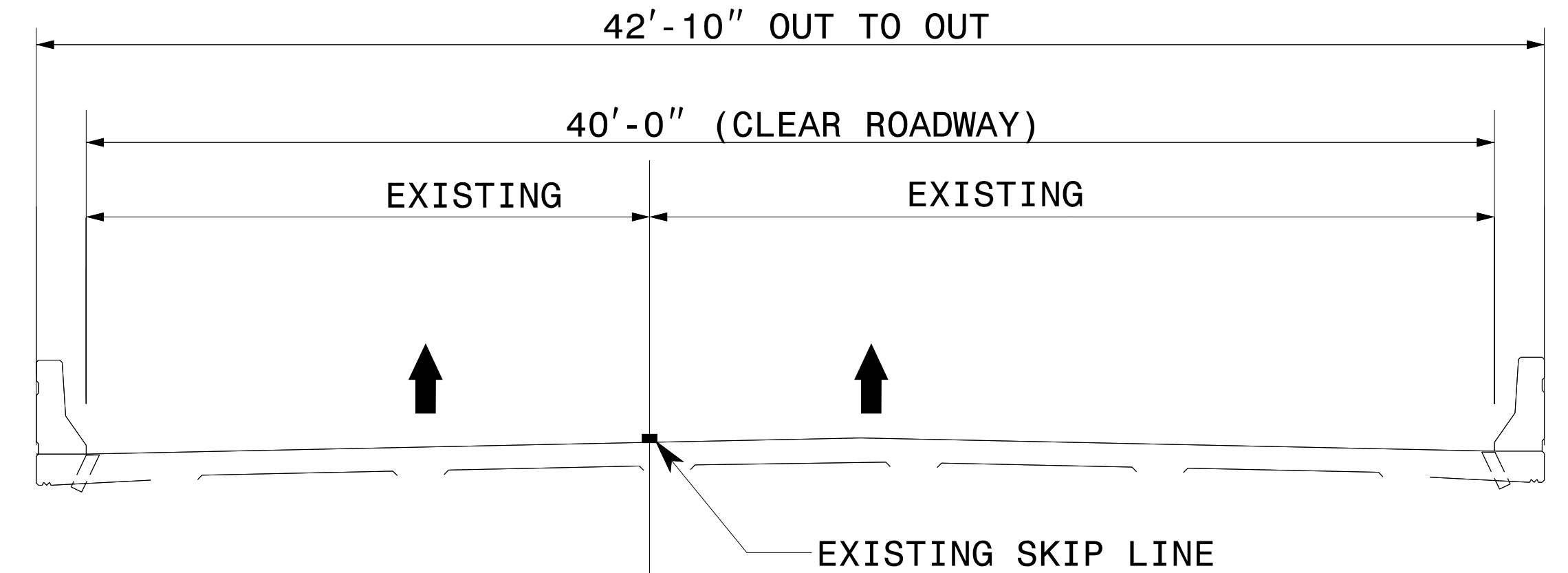

LEFT LANE LMC WORK

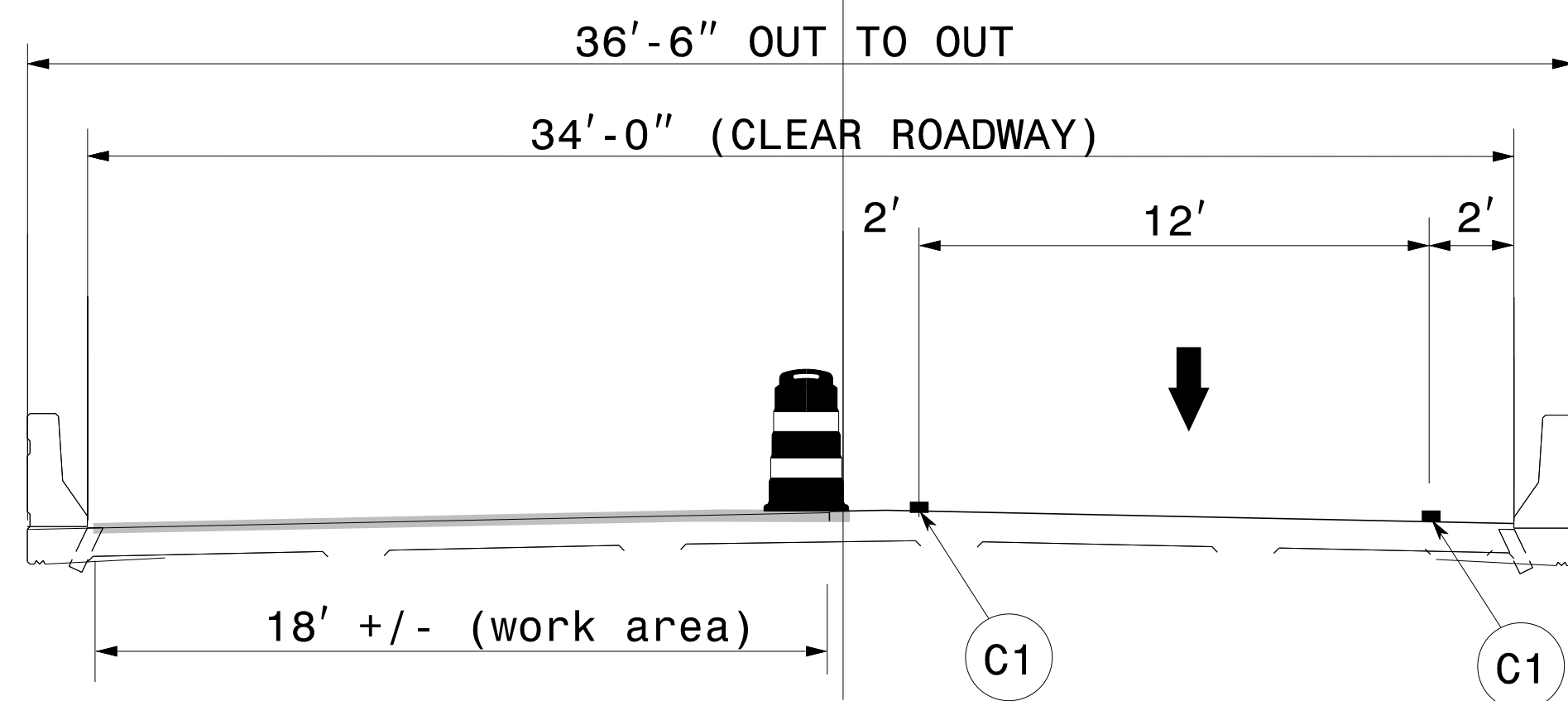
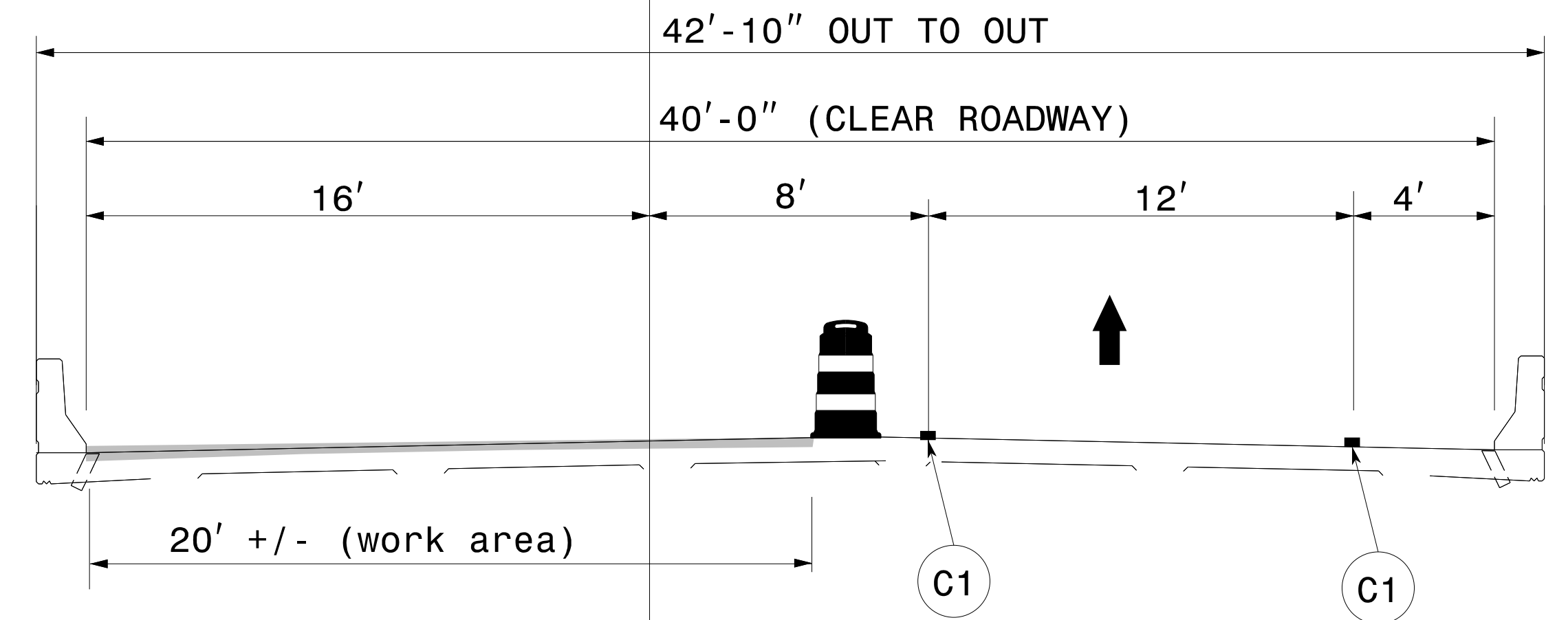

RIGHT LANE LMC WORK

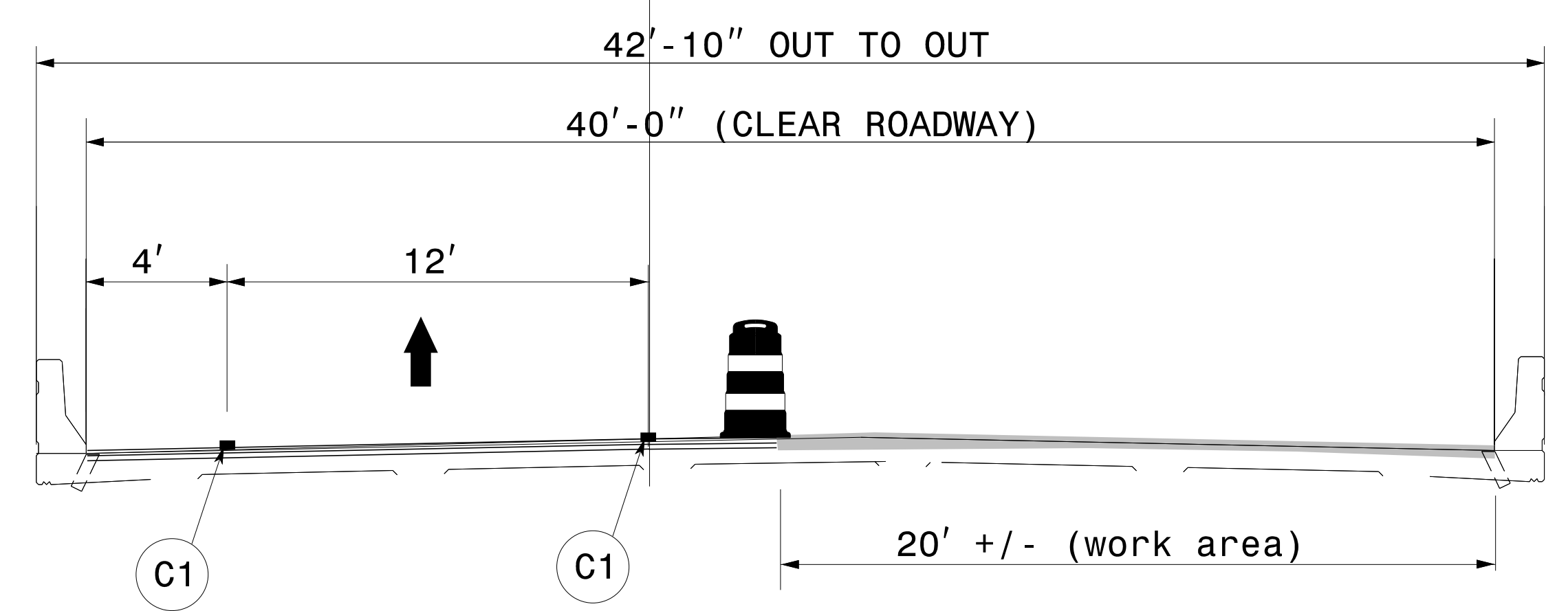

6/8/2023
N:\Special\15BPR\15BPR\TrafficControl\TCP\15BPR.61.TC.TMP.2.dgn
User:kedals

APPROVED: *Zachary T. Clark*
DATE: 06/09/2023

DESIGNED BY: *Zachary T. Clark*
SC4DA7F17FD420...

SEAL 045090
ENGINEER
ZACHARY T. CLARK

**DOCUMENT NOT CONSIDERED FINAL
UNLESS ALL SIGNATURES COMPLETED**

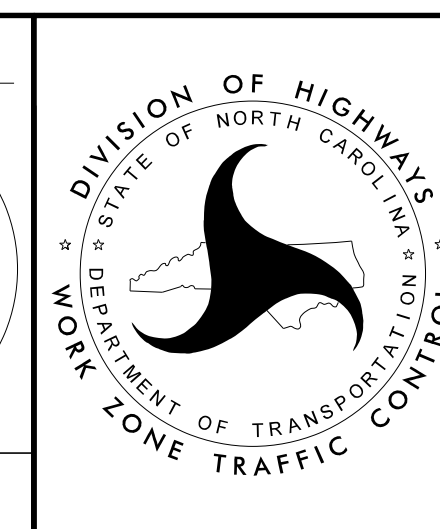

TYPICAL SECTIONS

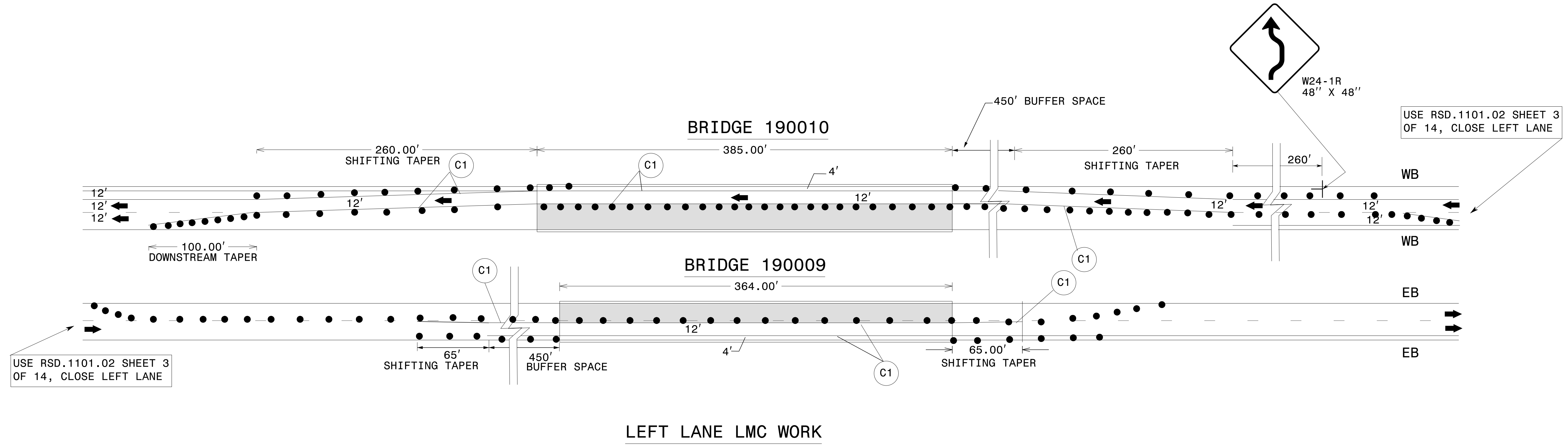
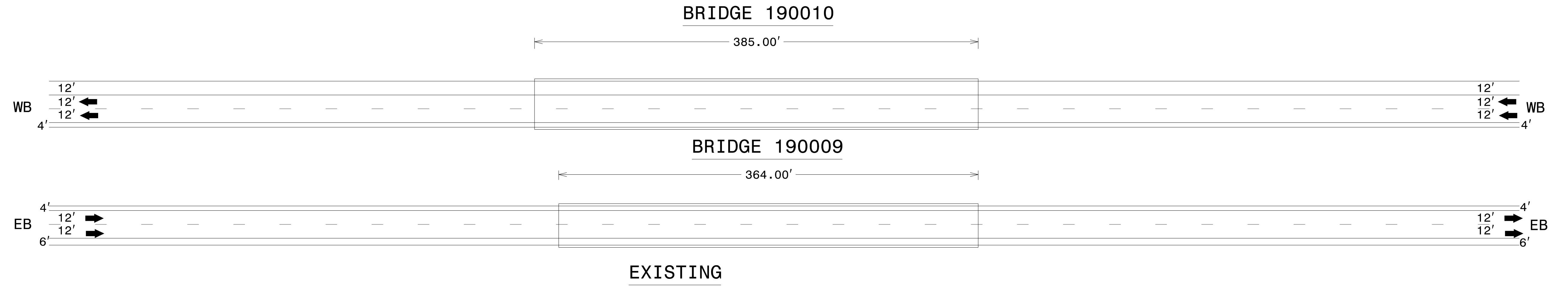

USE RSD.1101.02 SHEET 3 OF 14, CLOSE LEFT LANE

USE RSD.1101.02 SHEET 3 OF 14, CLOSE LEFT LANE

COLD APPLIED PLASTIC TYPE IV
C1 : WHITE EDGE LINE 4"

FOR RIGHT LANE LMC WORK SEE TYPICAL SECTIONS VIEW, SHEET TMP-2.

APPROVED: *Zachary T. Clark*
DATE: 06/09/2023

DESIGNED BY: *Zachary T. Clark*
9C4DA7F17FD0420...

**DOCUMENT NOT CONSIDERED FINAL
UNLESS ALL SIGNATURES COMPLETED**



**PLAN VIEW
TRAFFIC SHIFT**

6/8/2023 N:\Special\15BPR61\TrafficControl\TCP\15BPR.61.TC.TMP.3.dgn User:kedals