

5/14/99

Kimley Horn
 P.O. BOX 33068 • RALEIGH, N.C. 27636-3068

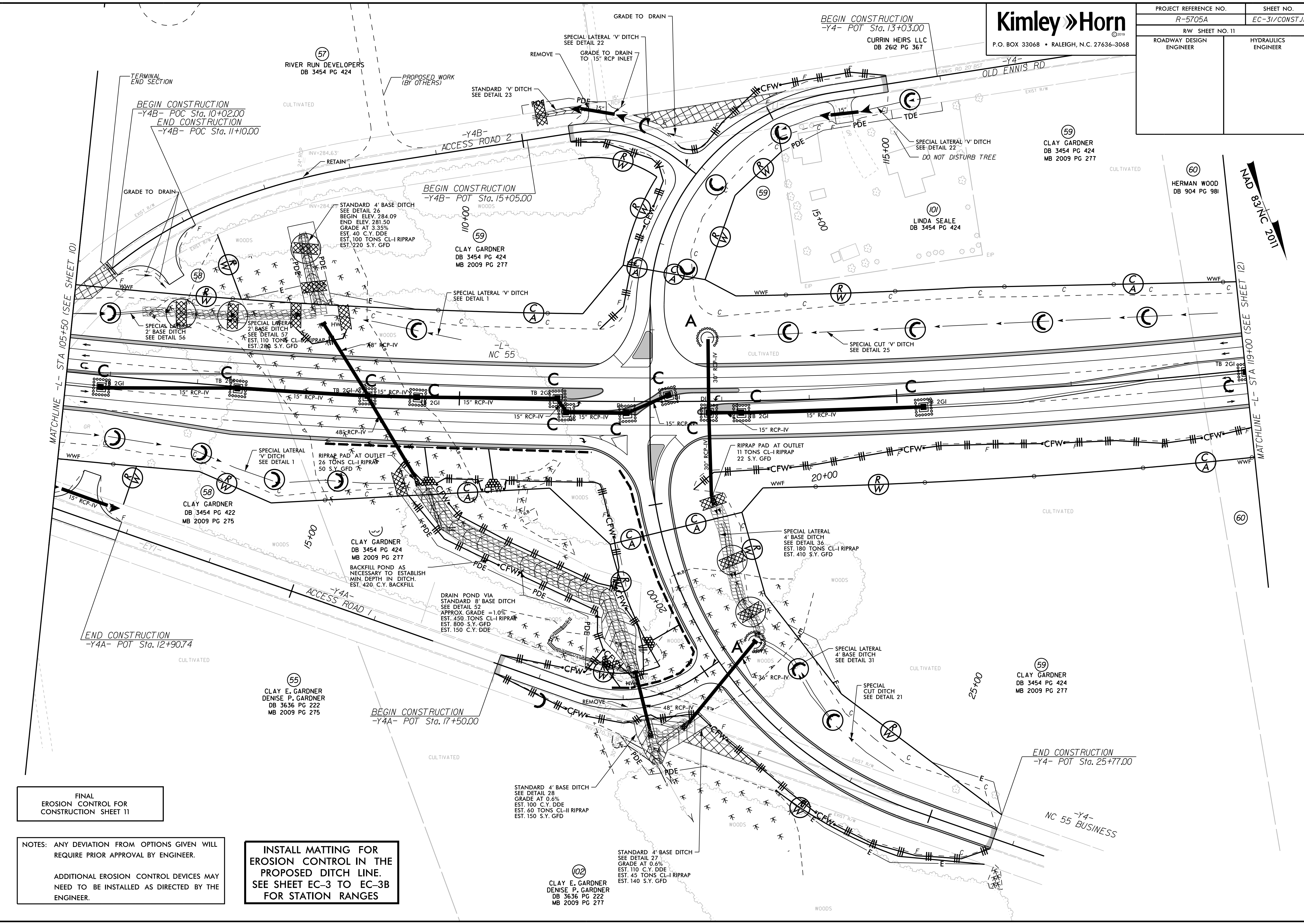

REVISIONS

FINAL
EROSION CONTROL FOR
CONSTRUCTION SHEET 11

NOTES: ANY DEVIATION FROM OPTIONS GIVEN WILL
REQUIRE PRIOR APPROVAL BY ENGINEER.

ADDITIONAL EROSION CONTROL DEVICES MAY
NEED TO BE INSTALLED AS DIRECTED BY THE
ENGINEER.

INSTALL MATTING FOR
EROSION CONTROL IN THE
PROPOSED DITCH LINE.
SEE SHEET EC-3 TO EC-3B
FOR STATION RANGES

NAD 83/CNT 2011

MATCHLINE -L- STA 119+00 (SEE SHEET 12)

MATCHLINE -L- STA 105+50 (SEE SHEET 10)

BEGIN CONSTRUCTION
-Y4B- POC Sta. 10+02.00
END CONSTRUCTION
-Y4B- POC Sta. 11+10.00

BEGIN CONSTRUCTION
-Y4B- POT Sta. 15+05.00

END CONSTRUCTION
-Y4A- POT Sta. 12+90.74

BEGIN CONSTRUCTION
-Y4A- POT Sta. 17+50.00

END CONSTRUCTION
-Y4- POT Sta. 25+77.00

57
RIVER RUN DEVELOPERS
DB 3454 PG 424

59
CLAY GARDNER
DB 3454 PG 424
MB 2009 PG 277

59
CLAY GARDNER
DB 3454 PG 424
MB 2009 PG 277

60
HERMAN WOOD
DB 904 PG 981

01
LINDA SEALE
DB 3454 PG 424

58
CLAY GARDNER
DB 3454 PG 422
MB 2009 PG 275

CLAY GARDNER
DB 3454 PG 424
MB 2009 PG 277

55
CLAY E. GARDNER
DENISE P. GARDNER
DB 3636 PG 222
MB 2009 PG 275

59
CLAY GARDNER
DB 3454 PG 424
MB 2009 PG 277

02
CLAY E. GARDNER
DENISE P. GARDNER
DB 3636 PG 222
MB 2009 PG 277

STANDARD 4' BASE DITCH
SEE DETAIL 28
GRADE AT 0.6%
EST. 100 C.Y. DDE
EST. 60 TONS CL-II RIPRAP
EST. 150 S.Y. GFD

STANDARD 4' BASE DITCH
SEE DETAIL 27
GRADE AT 0.6%
EST. 110 C.Y. DDE
EST. 45 TONS CL-I RIPRAP
EST. 140 S.Y. GFD

DRAIN POND VIA
STANDARD 8' BASE DITCH
SEE DETAIL 52
APPROX. GRADE = 1.0%
EST. 450 TONS CL-I RIPRAP
EST. 800 S.Y. GFD
EST. 150 C.Y. DDE

SPECIAL LATERAL
4' BASE DITCH
SEE DETAIL 36
EST. 180 TONS CL-I RIPRAP
EST. 410 S.Y. GFD

SPECIAL LATERAL
4' BASE DITCH
SEE DETAIL 31

SPECIAL
CUT DITCH
SEE DETAIL 21

STANDARD 4' BASE DITCH
SEE DETAIL 26
BEGIN ELEV. 284.09
END ELEV. 281.50
GRADE AT 3.35%
EST. 40 C.Y. DDE
EST. 100 TONS CL-I RIPRAP
EST. 220 S.Y. GFD

SPECIAL LATERAL
2' BASE DITCH
SEE DETAIL 57
EST. 110 TONS CL-I RIPRAP
EST. 280 S.Y. GFD

SPECIAL LATERAL 'V' DITCH
SEE DETAIL 1

SPECIAL CUT 'V' DITCH
SEE DETAIL 25

SPECIAL LATERAL 'V' DITCH
SEE DETAIL 22
DO NOT DISTURB TREE

REMOVE
GRADE TO DRAIN
TO 15" RCP INLET

STANDARD 'V' DITCH
SEE DETAIL 23

BEGIN CONSTRUCTION
-Y4- POT Sta. 13+03.00
CURRIN HEIRS LLC
DB 2612 PG 367

TERMINAL
END SECTION

GRADE TO DRAIN

PROPOSED WORK
(BY OTHERS)

ACCESS ROAD 2

RETAIN

BEGIN CONSTRUCTION
-Y4B- POT Sta. 15+05.00

59
CLAY GARDNER
DB 3454 PG 424
MB 2009 PG 277

-L-
NC 55

WWF

WWF

WWF

15" RCP-IV

15" RCP-IV

15" RCP-IV

15" RCP-IV

15" RCP-IV

15" RCP-IV

15" RCP-IV

15" RCP-IV

SPECIAL LATERAL
'V' DITCH
SEE DETAIL 1

RIPRAP PAD AT OUTLET
24 TONS CL-I RIPRAP
50 S.Y. GFD

RIPRAP PAD AT OUTLET
11 TONS CL-I RIPRAP
22 S.Y. GFD

SPECIAL LATERAL
4' BASE DITCH
SEE DETAIL 36
EST. 180 TONS CL-I RIPRAP
EST. 410 S.Y. GFD

SPECIAL LATERAL
4' BASE DITCH
SEE DETAIL 31

SPECIAL
CUT DITCH
SEE DETAIL 21

DRAIN POND VIA
STANDARD 8' BASE DITCH
SEE DETAIL 52
APPROX. GRADE = 1.0%
EST. 450 TONS CL-I RIPRAP
EST. 800 S.Y. GFD
EST. 150 C.Y. DDE

SPECIAL LATERAL
4' BASE DITCH
SEE DETAIL 36
EST. 180 TONS CL-I RIPRAP
EST. 410 S.Y. GFD

SPECIAL LATERAL
4' BASE DITCH
SEE DETAIL 31

SPECIAL
CUT DITCH
SEE DETAIL 21

STANDARD 4' BASE DITCH
SEE DETAIL 26
BEGIN ELEV. 284.09
END ELEV. 281.50
GRADE AT 3.35%
EST. 40 C.Y. DDE
EST. 100 TONS CL-I RIPRAP
EST. 220 S.Y. GFD

SPECIAL LATERAL
2' BASE DITCH
SEE DETAIL 57
EST. 110 TONS CL-I RIPRAP
EST. 280 S.Y. GFD

SPECIAL LATERAL 'V' DITCH
SEE DETAIL 1

SPECIAL CUT 'V' DITCH
SEE DETAIL 25

SPECIAL LATERAL 'V' DITCH
SEE DETAIL 22
DO NOT DISTURB TREE

REMOVE
GRADE TO DRAIN
TO 15" RCP INLET

STANDARD 'V' DITCH
SEE DETAIL 23

BEGIN CONSTRUCTION
-Y4- POT Sta. 13+03.00
CURRIN HEIRS LLC
DB 2612 PG 367

TERMINAL
END SECTION

GRADE TO DRAIN

PROPOSED WORK
(BY OTHERS)

ACCESS ROAD 2

RETAIN

BEGIN CONSTRUCTION
-Y4B- POT Sta. 15+05.00

59
CLAY GARDNER
DB 3454 PG 424
MB 2009 PG 277

-L-
NC 55

WWF

WWF

WWF

15" RCP-IV

15" RCP-IV

15" RCP-IV

15" RCP-IV

15" RCP-IV

15" RCP-IV

15" RCP-IV

15" RCP-IV

SPECIAL LATERAL
'V' DITCH
SEE DETAIL 1

RIPRAP PAD AT OUTLET
24 TONS CL-I RIPRAP
50 S.Y. GFD

RIPRAP PAD AT OUTLET
11 TONS CL-I RIPRAP
22 S.Y. GFD

SPECIAL LATERAL
4' BASE DITCH
SEE DETAIL 36
EST. 180 TONS CL-I RIPRAP
EST. 410 S.Y. GFD

SPECIAL LATERAL
4' BASE DITCH
SEE DETAIL 31

SPECIAL
CUT DITCH
SEE DETAIL 21

DRAIN POND VIA
STANDARD 8' BASE DITCH
SEE DETAIL 52
APPROX. GRADE = 1.0%
EST. 450 TONS CL-I RIPRAP
EST. 800 S.Y. GFD
EST. 150 C.Y. DDE

SPECIAL LATERAL
4' BASE DITCH
SEE DETAIL 36
EST. 180 TONS CL-I RIPRAP
EST. 410 S.Y. GFD

SPECIAL LATERAL
4' BASE DITCH
SEE DETAIL 31

SPECIAL
CUT DITCH
SEE DETAIL 21

STANDARD 4' BASE DITCH
SEE DETAIL 26
BEGIN ELEV. 284.09
END ELEV. 281.50
GRADE AT 3.35%
EST. 40 C.Y. DDE
EST. 100 TONS CL-I RIPRAP
EST. 220 S.Y. GFD

SPECIAL LATERAL
2' BASE DITCH
SEE DETAIL 57
EST. 110 TONS CL-I RIPRAP
EST. 280 S.Y. GFD

SPECIAL LATERAL 'V' DITCH
SEE DETAIL 1

SPECIAL CUT 'V' DITCH
SEE DETAIL 25

SPECIAL LATERAL 'V' DITCH
SEE DETAIL 22
DO NOT DISTURB TREE

REMOVE
GRADE TO DRAIN
TO 15" RCP INLET

STANDARD 'V' DITCH
SEE DETAIL 23

BEGIN CONSTRUCTION
-Y4- POT Sta. 13+03.00
CURRIN HEIRS LLC
DB 2612 PG 367

TERMINAL
END SECTION

GRADE TO DRAIN

PROPOSED WORK
(BY OTHERS)

ACCESS ROAD 2

RETAIN

BEGIN CONSTRUCTION
-Y4B- POT Sta. 15+05.00

59
CLAY GARDNER
DB 3454 PG 424
MB 2009 PG 277

-L-
NC 55

WWF

WWF

WWF

15" RCP-IV

15" RCP-IV

15" RCP-IV

15" RCP-IV

15" RCP-IV

15" RCP-IV

15" RCP-IV

15" RCP-IV

SPECIAL LATERAL
'V' DITCH
SEE DETAIL 1

RIPRAP PAD AT OUTLET
24 TONS CL-I RIPRAP
50 S.Y. GFD

RIPRAP PAD AT OUTLET
11 TONS CL-I RIPRAP
22 S.Y. GFD

SPECIAL LATERAL
4' BASE DITCH
SEE DETAIL 36
EST. 180 TONS CL-I RIPRAP
EST. 410 S.Y. GFD

SPECIAL LATERAL
4' BASE DITCH
SEE DETAIL 31

SPECIAL
CUT DITCH
SEE DETAIL 21

DRAIN POND VIA
STANDARD 8' BASE DITCH
SEE DETAIL 52
APPROX. GRADE = 1.0%
EST. 450 TONS CL-I RIPRAP
EST. 800 S.Y. GFD
EST. 150 C.Y. DDE

SPECIAL LATERAL
4' BASE DITCH
SEE DETAIL 36
EST. 180 TONS CL-I RIPRAP
EST. 410 S.Y. GFD

SPECIAL LATERAL
4' BASE DITCH
SEE DETAIL 31

SPECIAL
CUT DITCH
SEE DETAIL 21

STANDARD 4' BASE DITCH
SEE DETAIL 26
BEGIN ELEV. 284.09
END ELEV. 281.50
GRADE AT 3.35%
EST. 40 C.Y. DDE
EST. 100 TONS CL-I RIPRAP
EST. 220 S.Y. GFD

SPECIAL LATERAL
2' BASE DITCH
SEE DETAIL 57
EST. 110 TONS CL-I RIPRAP
EST. 280 S.Y. GFD

SPECIAL LATERAL 'V' DITCH
SEE DETAIL 1

SPECIAL CUT 'V' DITCH
SEE DETAIL 25

SPECIAL LATERAL 'V' DITCH
SEE DETAIL 22
DO NOT DISTURB TREE

REMOVE
GRADE TO DRAIN
TO 15" RCP INLET

STANDARD 'V' DITCH
SEE DETAIL 23

BEGIN CONSTRUCTION
-Y4- POT Sta. 13+03.00
CURRIN HEIRS LLC
DB 2612 PG 367

TERMINAL
END SECTION

GRADE TO DRAIN

PROPOSED WORK
(BY OTHERS)

ACCESS ROAD 2

RETAIN

BEGIN CONSTRUCTION
-Y4B- POT Sta. 15+05.00

59
CLAY GARDNER
DB 3454 PG 424
MB 2009 PG 277

-L-
NC 55

WWF

WWF

WWF

15" RCP-IV

15" RCP-IV

15" RCP-IV

15" RCP-IV

15" RCP-IV

15" RCP-IV

15" RCP-IV

15" RCP-IV

SPECIAL LATERAL
'V' DITCH
SEE DETAIL 1

RIPRAP PAD AT OUTLET
24 TONS CL-I RIPRAP
50 S.Y. GFD

RIPRAP PAD AT OUTLET
11 TONS CL-I RIPRAP
22 S.Y. GFD

SPECIAL LATERAL
4' BASE DITCH
SEE DETAIL 36
EST. 180 TONS CL-I RIPRAP
EST. 410 S.Y. GFD

SPECIAL LATERAL
4' BASE DITCH
SEE DETAIL 31

SPECIAL
CUT DITCH
SEE DETAIL 21

DRAIN POND VIA
STANDARD 8' BASE DITCH
SEE DETAIL 52
APPROX. GRADE = 1.0%
EST. 450 TONS CL-I RIPRAP
EST. 800 S.Y. GFD
EST. 150 C.Y. DDE

SPECIAL LATERAL
4' BASE DITCH
SEE DETAIL 36
EST. 180 TONS CL-I RIPRAP
EST. 410 S.Y. GFD

SPECIAL LATERAL
4' BASE DITCH
SEE DETAIL 31

SPECIAL
CUT DITCH
SEE DETAIL 21

STANDARD 4' BASE DITCH
SEE DETAIL 26
BEGIN ELEV. 284.09
END ELEV. 281.50
GRADE AT 3.35%
EST. 40 C.Y. DDE
EST. 100 TONS CL-I RIPRAP
EST. 220 S.Y. GFD

SPECIAL LATERAL
2' BASE DITCH
SEE DETAIL 57
EST. 110 TONS CL-I RIPRAP
EST. 280 S.Y. GFD

SPECIAL LATERAL 'V' DITCH
SEE DETAIL 1

SPECIAL CUT 'V' DITCH
SEE DETAIL 25

SPECIAL LATERAL 'V' DITCH
SEE DETAIL 22
DO NOT DISTURB TREE

REMOVE
GRADE TO DRAIN
TO 15" RCP INLET

STANDARD 'V' DITCH
SEE DETAIL 23

BEGIN CONSTRUCTION
-Y4- POT Sta. 13+03.00
CURRIN HEIRS LLC
DB 2612 PG 367

TERMINAL
END SECTION

GRADE TO DRAIN

PROPOSED WORK
(BY OTHERS)

ACCESS ROAD 2

RETAIN

BEGIN CONSTRUCTION
-Y4B- POT Sta. 15+05.00

59
CLAY GARDNER
DB 3454 PG 424
MB 2009 PG 277

-L-
NC 55

WWF

WWF

WWF

15" RCP-IV

15" RCP-IV

15" RCP-IV

15" RCP-IV

15" RCP-IV

15" RCP-IV

15" RCP-IV

15" RCP-IV

SPECIAL LATERAL
'V' DITCH
SEE DETAIL 1

RIPRAP PAD AT OUTLET
24 TONS CL-I RIPRAP
50 S.Y. GFD

RIPRAP PAD AT OUTLET
11 TONS CL-I RIPRAP
22 S.Y. GFD