

TIP PROJECT: R-5705A

STATE	STATE PROJECT REFERENCE NO.	SHEET NO.	TOTAL SHEETS
N.C.	R-5705A	RW01	44

STATE OF NORTH CAROLINA
 DIVISION OF HIGHWAYS
 SURVEY CONTROL, EXISTING CENTERLINES,
 RIGHT OF WAY, EASEMENTS AND PROPERTY TIES
HARNETT COUNTY

LOCATION: NC 55 FROM SOUTH OF SR 1532 (OAK GROVE CHURCH ROAD) TO NORTH OF NC 210

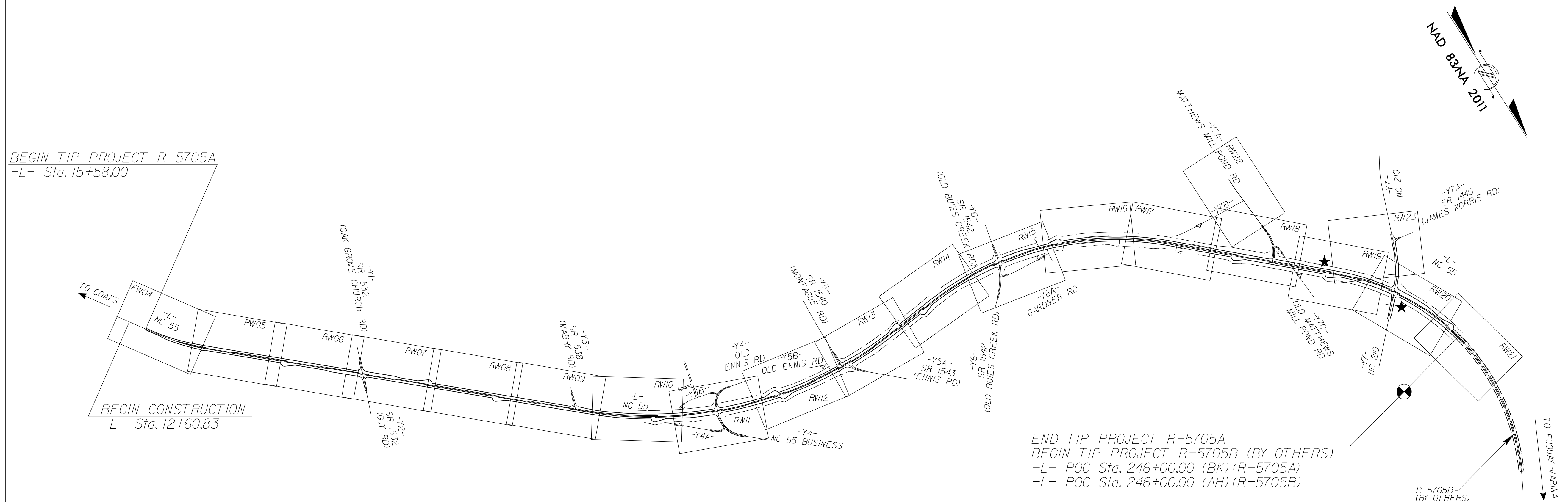

BEGIN TIP PROJECT R-5705A
-L- Sta. 15+58.00

BEGIN CONSTRUCTION
-L- Sta. 12+60.83

END TIP PROJECT R-5705A
BEGIN TIP PROJECT R-5705B (BY OTHERS)
-L- POC Sta. 246+00.00 (BK) (R-5705A)
-L- POC Sta. 246+00.00 (AH) (R-5705B)

24-OCT-2022 10:00 C:\GEL\Projects\2022\R-5705A-R0W\5705-rw_sheets\R5705A-1s.rw01.dgn Jason Prevotte AT DESKTOP-EPRVSVF

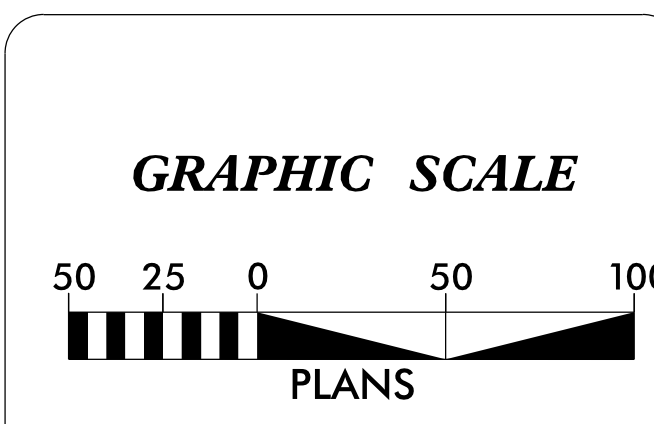

DATUM DESCRIPTION

THE LOCALIZED COORDINATE SYSTEM DEVELOPED FOR THIS PROJECT IS BASED ON THE STATE PLANE COORDINATES ESTABLISHED BY NCDOT FOR MONUMENT "R5705/U5751-AZ1" WITH NAD 83/NSRS NA2011 STATE PLANE GRID COORDINATES OF NORTHING: 644,697.210(ft) EASTING: 2,075,359.162(ft) ELEVATION: 320.901(ft)

THE AVERAGE COMBINED GRID FACTOR USED ON THIS PROJECT (GROUND TO GRID) IS: 0.99987346

THE N.C. LAMBERT GRID BEARING AND LOCALIZED HORIZONTAL GROUND DISTANCE FROM "R5705/U5751-AZ1" TO -L- STATION 10+00.00 IS S 53-05'14.04" E 13,221.89(ft)

ALL LINEAR DIMENSIONS ARE LOCALIZED HORIZONTAL DISTANCES VERTICAL DATUM USED IS NAVD 88

Prepared in the Office of:
 GEL Engineering of NC, Inc. DBA
GEL SOLUTIONS
 an Affiliate of THE GEL GROUP, INC.
 2700 SUMNER BLVD.
 SUITE 106
 RALEIGH, NC 27616
 (919) 544-1100
 WWW.GEL-SOLUTIONS.COM

2018 STANDARD SPECIFICATIONS

RIGHT OF WAY DATE: 03/09/2021

LETTING DATE: 3/21/2023

PROFESSIONAL LAND SURVEYOR

SIGNATURE: _____ Date: _____

