

8/17/99

IS: JUN-2020 08:07
N:\Projects\2019\71195004\195799_Rwal_NCDOT_File_Structure\195799_GEO_Rwal_2\CADD_GEO\TECH\Site&Sub\195799_Rdy_psh_r-retwall_2.dgn
C:\ht\195799\195799.dwg

RETAINING WALL 2 PLAN

ROADWAY DESIGN ENGINEER

GEOTECHNICAL ENGINEER

DOCUMENT NOT CONSIDERED FINAL
UNLESS ALL SIGNATURES COMPLETED

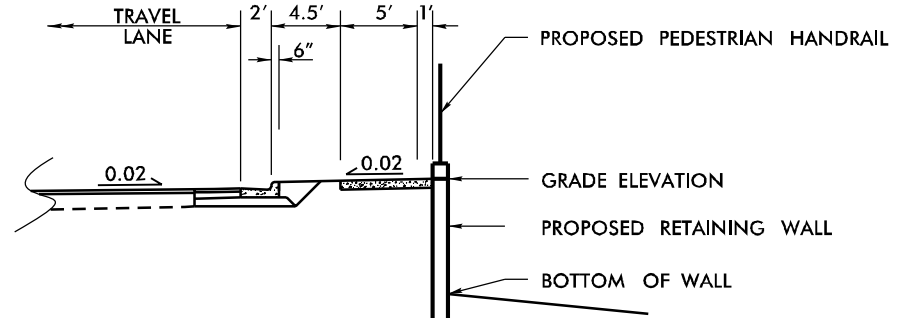
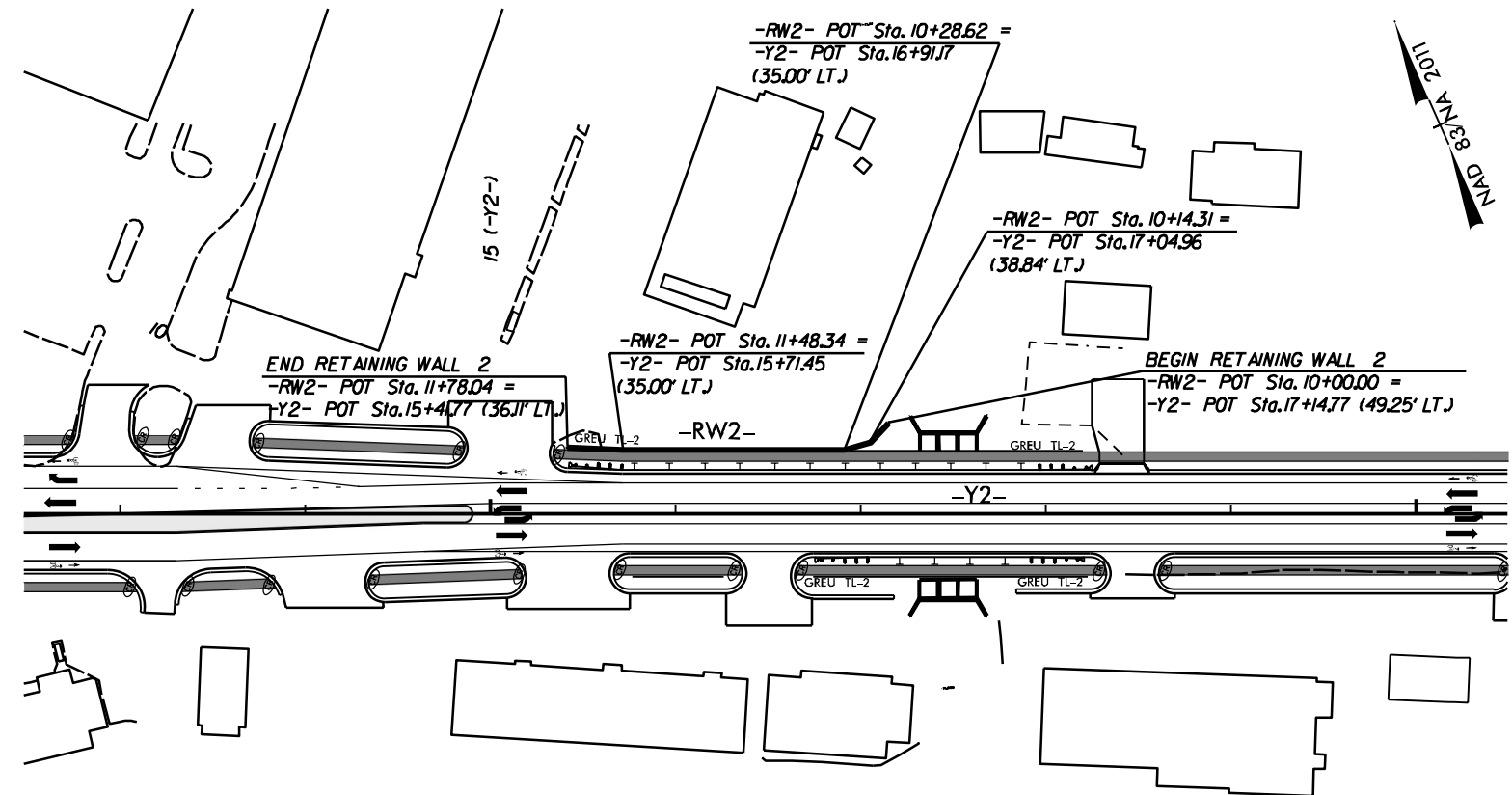

SECTION THROUGH RETAINING WALL
-RW2- STA. 10+00.00 TO -RW2- STA. 11+78.04

NOTE: THE WALL ENVELOPE DOES NOT ACCURATELY DEPICT THE ACTUAL FACE OF WALL.

RETAINING WALL 2 ENVELOPE

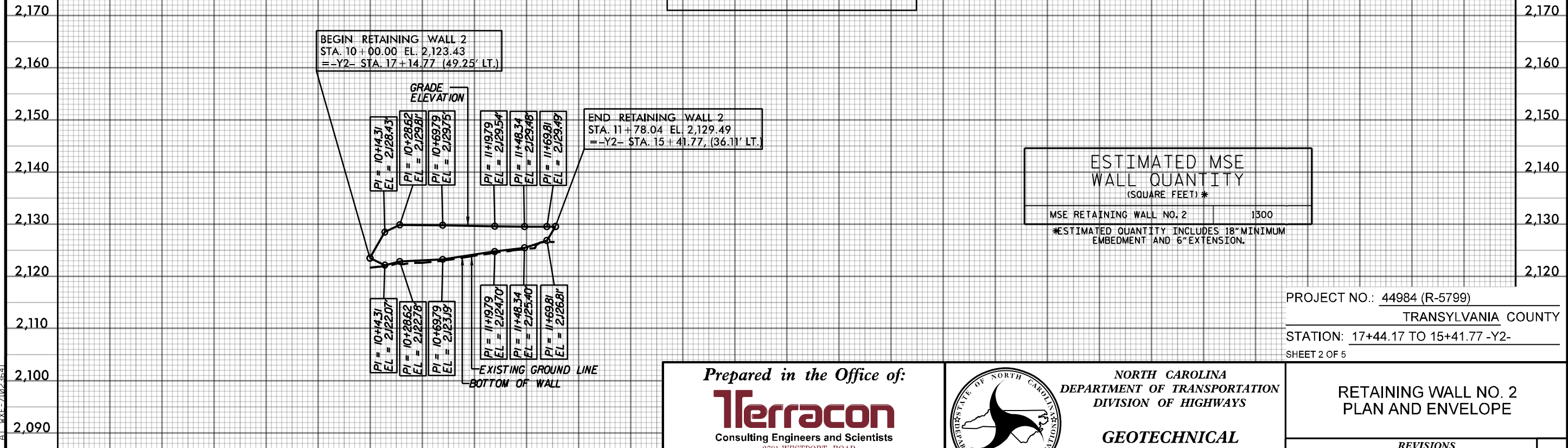

PROJECT NO.: 44984 (R-5799)
 TRANSYLVANIA COUNTY
 STATION: 17+44.17 TO 15+41.77 -Y2-
 SHEET 2 OF 5

Prepared in the Office of:

Consulting Engineers and Scientists
 2701 WESTPORT ROAD
 CHARLOTTE, NORTH CAROLINA 28208
 NC REGISTERED ENGINEERING FIRM: F-0869
 NC REGISTERED GEOLOGIC FIRM: C-367

NORTH CAROLINA
 DEPARTMENT OF TRANSPORTATION
 DIVISION OF HIGHWAYS

GEOTECHNICAL
 ENGINEERING UNIT

REVISIONS						SHEET NO.
NO.	BY	DATE	NO.	BY	DATE	
1	JPM/GFT	6/15/20	3			W-2
2			4			

PREPARED BY: G. F. THILL DATE: 10/28/19
 REVIEWED BY: M. J. ALEXANDER DATE: 10/28/19