

REINFORCING STEEL BAR SCHEDULE											
LEFT EXTENSION											
STAGE I						STAGE II					
BAR	NO.	SIZE	TYPE	LENGTH	WEIGHT	BAR	NO.	SIZE	TYPE	LENGTH	WEIGHT
A1	24	#5	1	6'-2"	154	A1	24	#5	1	6'-2"	154
A2	23	#5	1	6'-2"	148	A2	23	#5	1	6'-2"	148
A3	48	#4	1	5'-2"	166						
A100	23	#5	STR	25'-0"	600	A300	24	#5	STR	32'-2"	805
A200	23	#5	STR	25'-0"	600	A400	24	#5	STR	32'-2"	805
						A500	23	#5	STR	9'-6"	228
						A600	23	#5	STR	9'-6"	228
B1	12	#4	STR	10'-7"	85	B1	12	#4	STR	10'-7"	85
B2	23	#4	STR	8'-4"	128	B2	23	#4	STR	8'-4"	128
B3	48	#4	STR	10'-7"	339	B2	23	#4	STR	8'-4"	128
						C1	62	#4	STR	11'-8"	483
C1	56	#4	STR	11'-8"	436						
D1	22	#6	STR	2'-6"	83	D1	35	#6	STR	2'-6"	131
						G1	4	#5	STR	32'-2"	134
REINFORCING STEEL 2,739 LBS.						REINFORCING STEEL 3,329 LBS.					

REINFORCING STEEL BAR SCHEDULE											
RIGHT EXTENSION											
STAGE I						STAGE II					
BAR	NO.	SIZE	TYPE	LENGTH	WEIGHT	BAR	NO.	SIZE	TYPE	LENGTH	WEIGHT
A1	25	#5	1	6'-2"	161	A1	25	#5	1	6'-2"	161
A2	24	#5	1	6'-2"	154	A2	24	#5	1	6'-2"	154
A3	48	#4	1	5'-2"	166						
A100	24	#5	STR	25'-0"	626	A300	25	#5	STR	32'-2"	839
A200	24	#5	STR	25'-0"	626	A400	25	#5	STR	32'-2"	839
						A500	24	#5	STR	9'-6"	238
						A600	24	#5	STR	9'-6"	238
B1	12	#4	STR	10'-7"	85	B1	12	#4	STR	10'-7"	85
B2	24	#4	STR	8'-4"	134	B2	24	#4	STR	8'-4"	134
B3	48	#4	STR	10'-7"	339	B2	24	#4	STR	8'-4"	134
						C1	62	#4	STR	12'-2"	504
C1	56	#4	STR	12'-2"	455						
D1	22	#6	STR	2'-6"	83	D1	35	#6	STR	2'-6"	131
						G1	4	#5	STR	32'-2"	134
REINFORCING STEEL 2,829 LBS.						REINFORCING STEEL 3,457 LBS.					

TOTAL STRUCTURE QUANTITIES	
CULVERT EXCAVATION	LUMP SUM
FOUNDATION CONDITIONING MATERIAL	
LEFT EXTENSION	
STAGE I	23 TONS
STAGE II	10 TONS
TOTAL	33 TONS
RIGHT EXTENSION	
STAGE I	24 TONS
STAGE II	10 TONS
TOTAL	34 TONS
TOTAL MATERIAL	67 TONS
CLASS A CONCRETE	
BARREL @ 3.253 C.Y./FT.	
LEFT EXTENSION	
CULVERT - STAGE I	17.2 C.Y.
CULVERT - STAGE II	21.8 C.Y.
WINGS, ETC.	18.5 C.Y.
TOTAL	57.5 C.Y.
RIGHT EXTENSION	
CULVERT - STAGE I	17.9 C.Y.
CULVERT - STAGE II	22.7 C.Y.
WINGS, ETC.	17.1 C.Y.
TOTAL	57.7 C.Y.
TOTAL CONCRETE	115.2 C.Y.
REINFORCING STEEL	
BARREL	
LEFT EXTENSION	
CULVERT - STAGE I	2,739 LBS.
CULVERT - STAGE II	3,329 LBS.
WINGS, ETC.	906 LBS.
TOTAL	6,974 LBS.
RIGHT EXTENSION	
CULVERT - STAGE I	2,829 LBS.
CULVERT - STAGE II	3,457 LBS.
WINGS, ETC.	901 LBS.
TOTAL	7,187 LBS.
TOTAL STEEL	14,161 LBS.

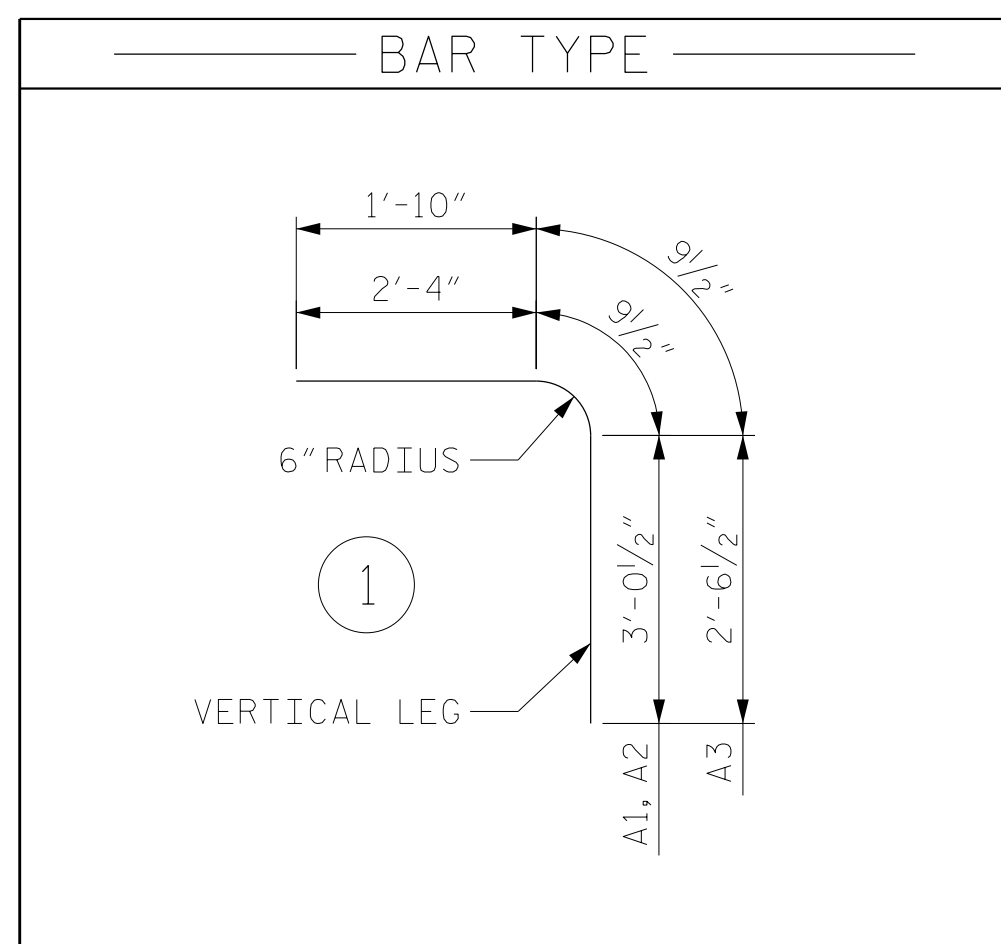

SPlice CHART FOR "A" BARS	
SIZE	SPlice LENGTH
#5	2'-4"

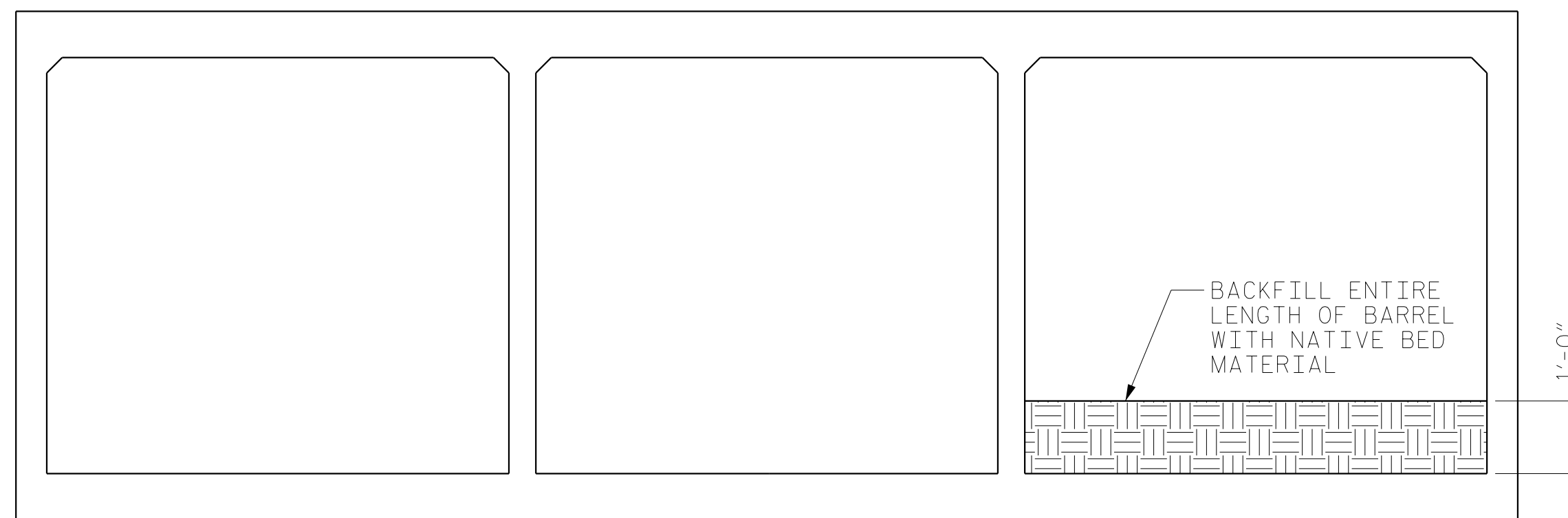

BENCH DETAIL - ELEVATION  
LOOKING UPSTREAM

PROJECT NO. R-5799  
TRANSYLVANIA COUNTY  
 STATION: 17+47.31 -Y2-

SHEET 7 OF 10



STATE OF NORTH CAROLINA  
 DEPARTMENT OF TRANSPORTATION  
 RALEIGH  
 TRIPLE 10'-0" X 9'-0"  
 CONCRETE BOX CULVERT  
 90° SKEW  
 (LEFT AND RIGHT  
 EXTENSIONS)

REVISIONS						SHEET NO.
NO.	BY:	DATE:	NO.	BY:	DATE:	C-7
1			3			TOTAL SHEETS
2			4			10

DRAWN BY : NSC DATE : 06/2020  
 CHECKED BY : MAL DATE : 08/2020  
 DESIGN ENGINEER OF RECORD: MRA DATE : 04/2023

DOCUMENT NOT CONSIDERED  
 FINAL UNLESS ALL  
 SIGNATURES COMPLETED