

CULVERT SECTION NORMAL TO ROADWAY

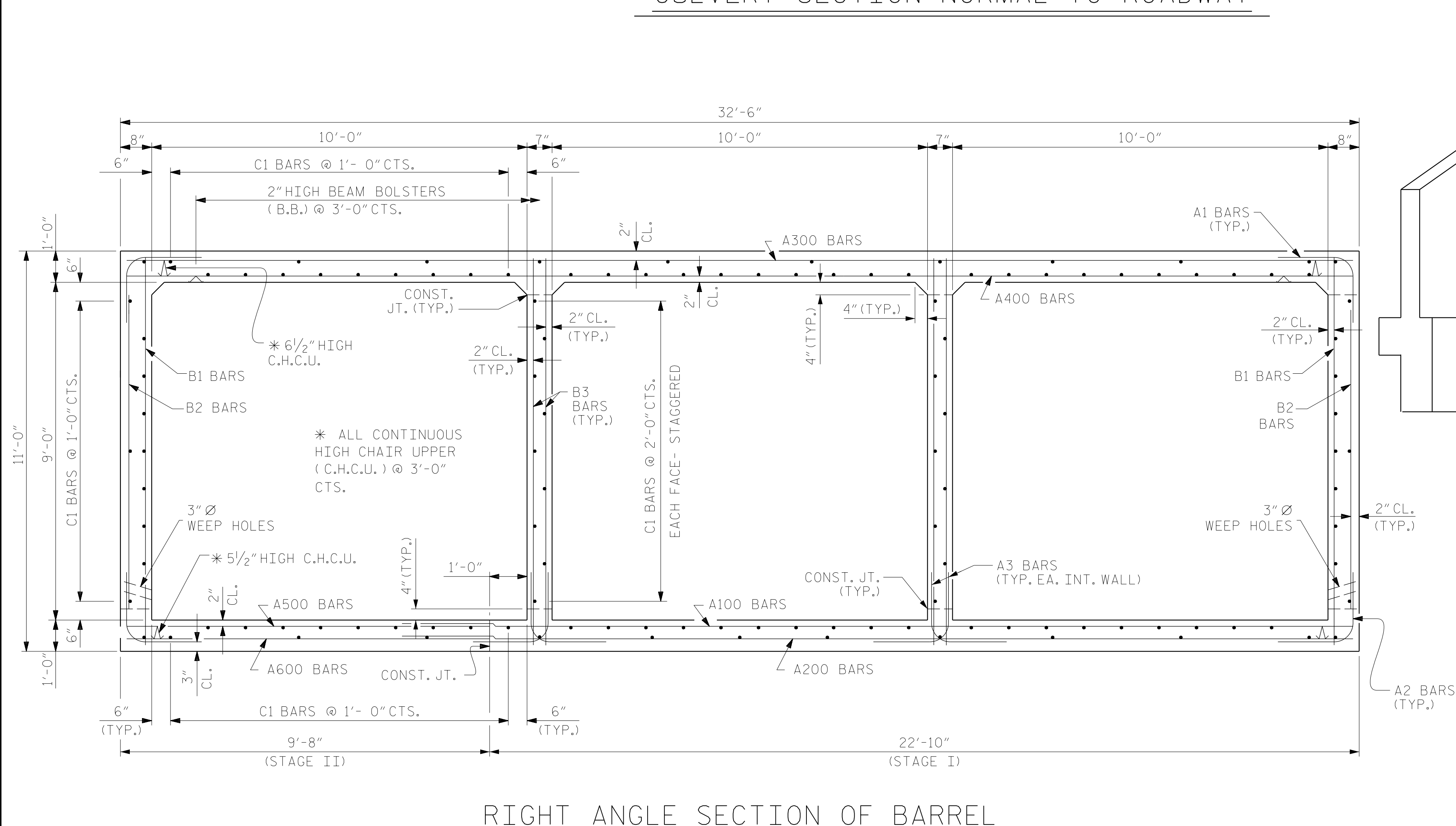

RIGHT ANGLE SECTION OF BARREL

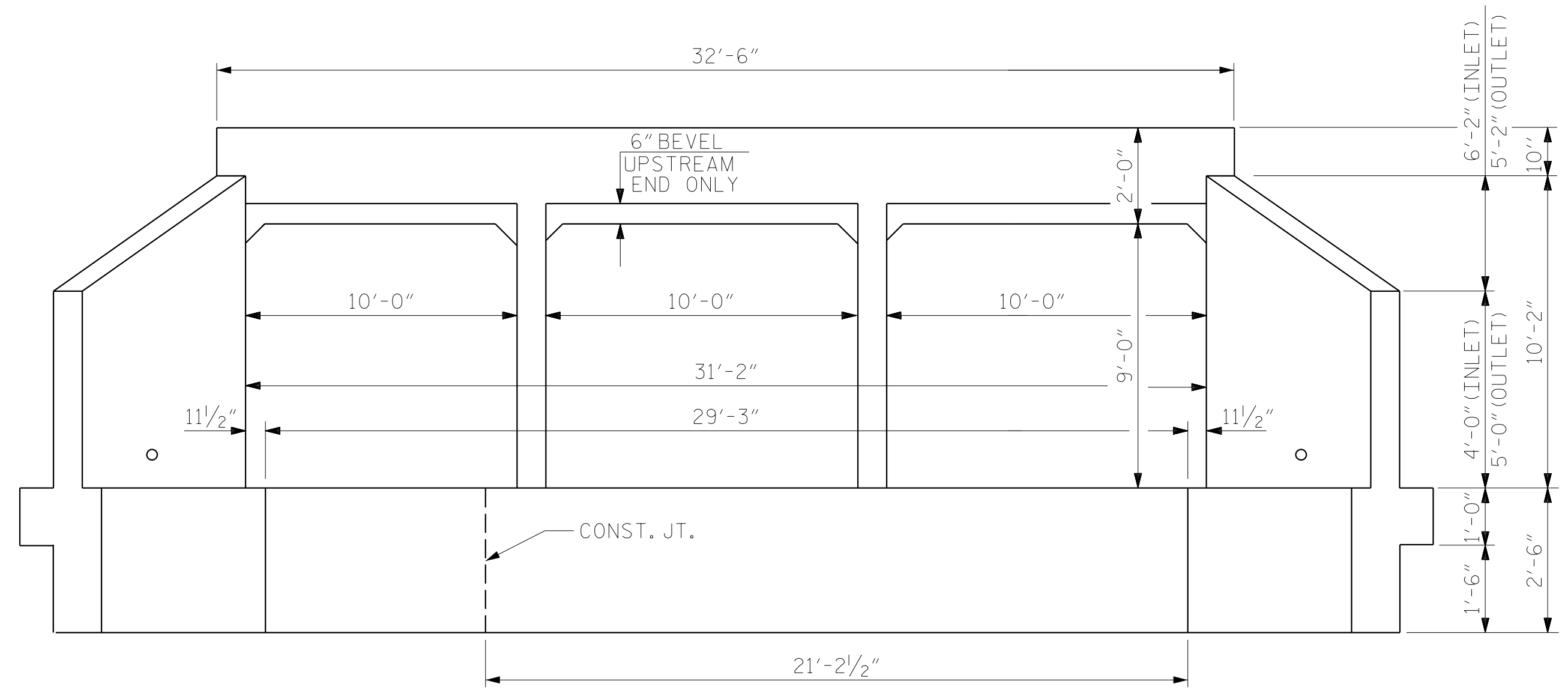

OUTLET END ELEVATION  
(INLET END SIMILAR OPPOSITE ROTATION)

PROJECT NO. R-5799  
TRANSYLVANIA COUNTY  
 STATION: 17+47.31 -Y2-

SHEET 2 OF 10



**RS&H**  
 RS&H Architects-Engineers-Planners, Inc.

STATE OF NORTH CAROLINA  
 DEPARTMENT OF TRANSPORTATION  
 RALEIGH  
**TRIPLE 10 FT. X 9 FT.  
 CONCRETE BOX CULVERT  
 LEFT AND RIGHT  
 EXTENSIONS  
 90° SKEW**

DRAWN BY: TWL DATE: 08/2020  
 CHECKED BY: MAL DATE: 08/2020  
 DESIGN ENGINEER OF RECORD: MRA DATE: 04/2023

LOOKING UPSTREAM  
 THERE ARE 118 "C" BARS IN SECTION OF BARREL.

DOCUMENT NOT CONSIDERED  
 FINAL UNLESS ALL  
 SIGNATURES COMPLETED

REVISIONS						SHEET NO.	
NO.	BY:	DATE:	NO.	BY:	DATE:	C-2	
1			3			TOTAL SHEETS	
2			4			10	