

09/02/2019

See Sheet 1A For Index of Sheets
See Sheet 1B For Conventional Symbols

STATE OF NORTH CAROLINA
DIVISION OF HIGHWAYS

TRANSYLVANIA COUNTY

**LOCATION: INTERSECTIONS OF US 64, US 276 AND NC 280
CONSTRUCT INTERSECTION IMPROVEMENTS**

**TYPE OF WORK: GRADING, PAVING, DRAINAGE, CULVERT, RETAINING
WALLS, SIGNALS, AND SIGNING**

STATE	STATE PROJECT REFERENCE NO.	SHEET NO.	TOTAL SHEETS
N.C.	R-5799	1	
STATE PROJ. NO.	F.A. PROJ. NO.	DESCRIPTION	
44984.1.1	N/A	P.E.	
44984.2.1	N/A	ROW, UTIL	
44984.3.1	N/A	CONST	
44984.3.2	N/A	LANDSCAPE	

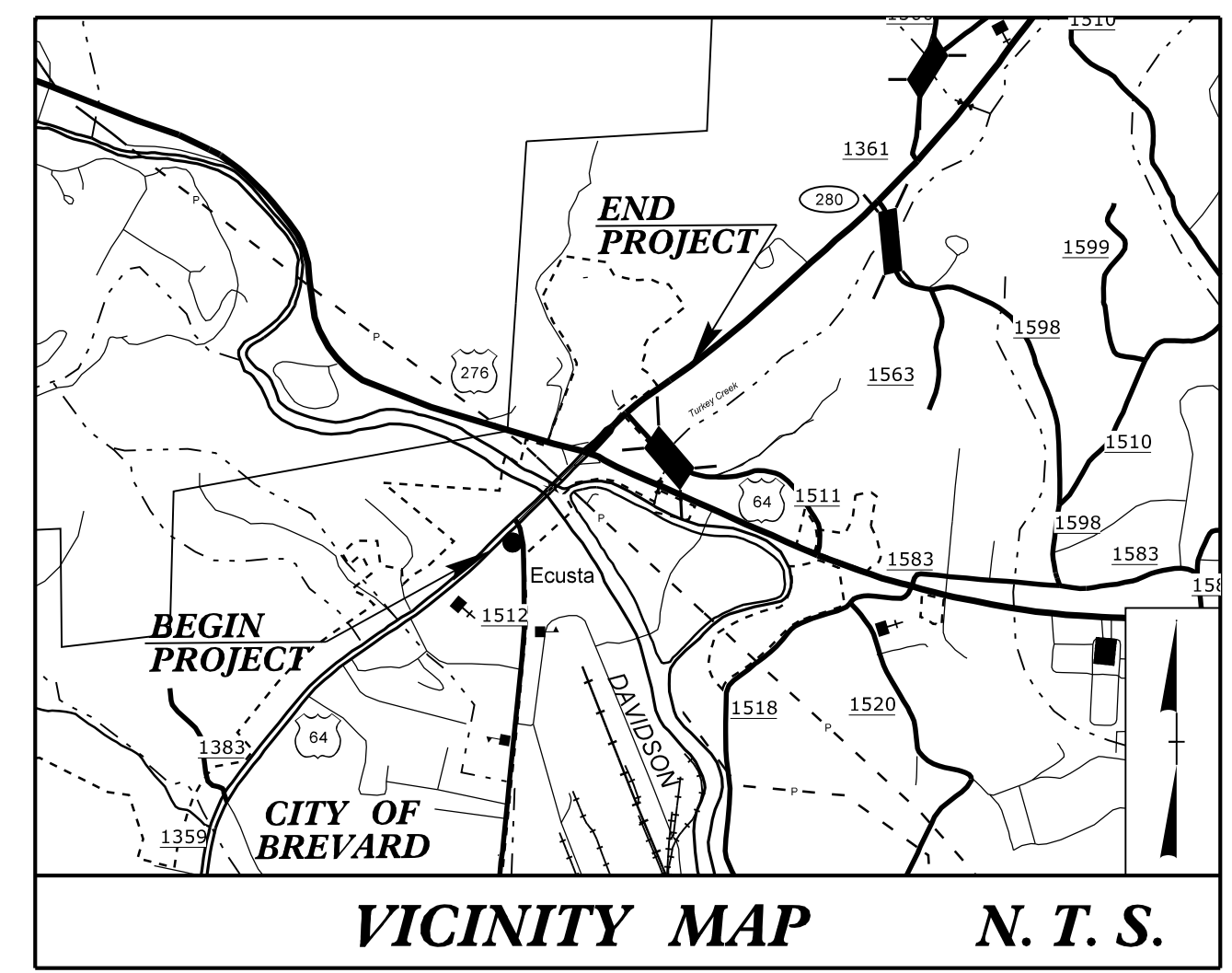

100% PLANS

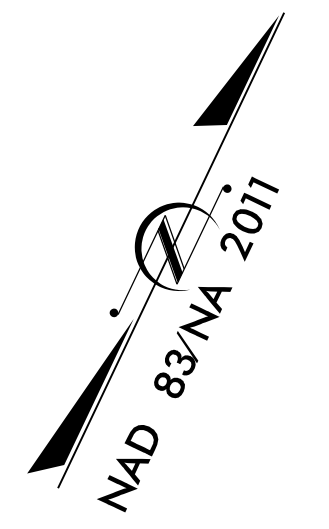
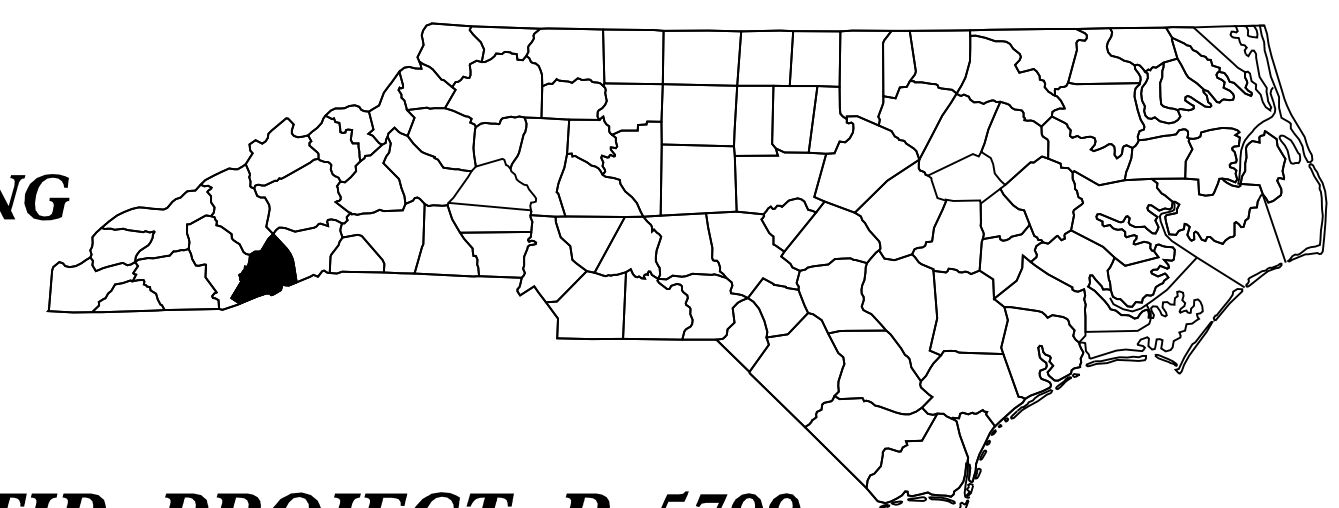

TIP PROJECT: R-5799

CONTRACT: C204856

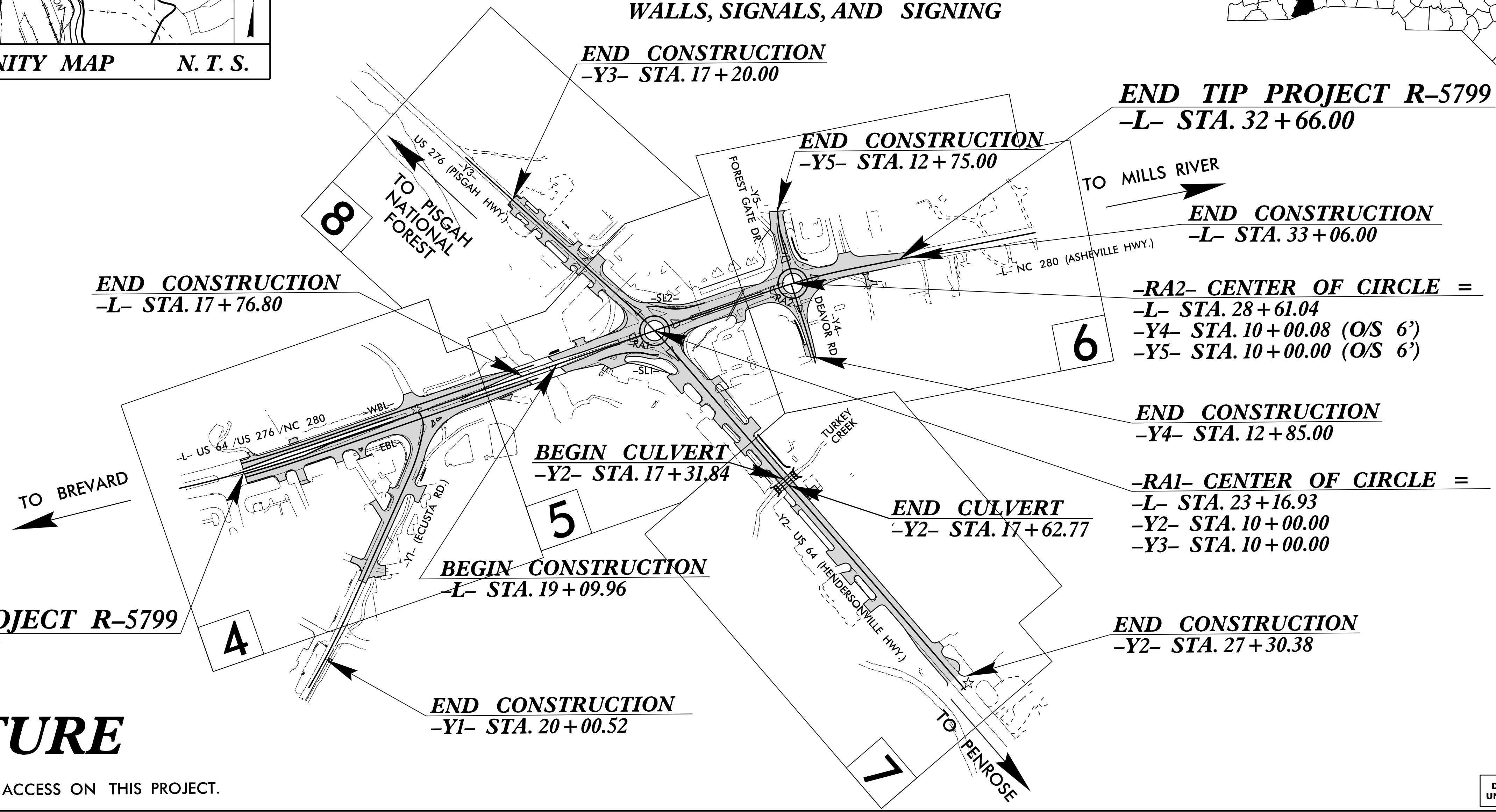

STRUCTURE

THERE IS NO CONTROL OF ACCESS ON THIS PROJECT.

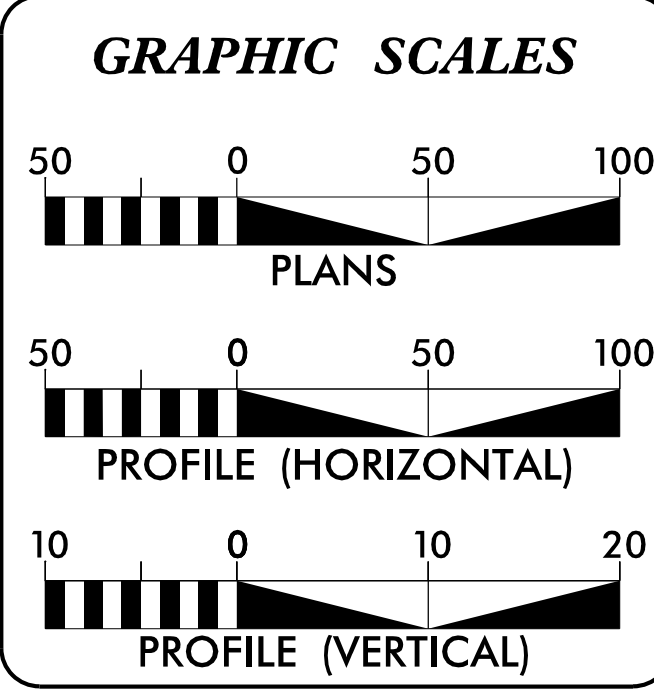

DESIGN DATA

ADT 2021 =	24,900
ADT 2041 =	30,000
K =	9 %
D =	55 %
T =	6 % *
V =	45 MPH
* TTST =	2% + DUAL 4%
FUNC CLASS =	PRINCIPAL ARTERIAL REGIONAL TIER

PROJECT LENGTH

LENGTH ROADWAY TIP PROJECT R-5799 =	0.461 MILES
TOTAL LENGTH TIP PROJECT R-5799 =	0.461 MILES
-L- USED TO CALCULATE PROJECT LENGTH	

PREPARED IN THE OFFICE OF:

RS&H 1520 SOUTH BOULEVARD, SUITE 200
CHARLOTTE, NC 28203
NC FIRM LICENSE No: F-0493

FOR THE NORTH CAROLINA DEPARTMENT OF TRANSPORTATION

2018 STANDARD SPECIFICATIONS

RIGHT OF WAY DATE: JULY 16, 2021

LETTING DATE: AUGUST 15, 2023

ALLISON DRAKE, PE PROJECT ENGINEER
DREW MORROW, PE PROJECT DESIGN ENGINEER
BARRY MOSTELLER NCDOT CONTACT

STRUCTURAL ENGINEER

DocuSigned by:
Matthew R. Acosta
SIGNATURE: _____ P.E.
5/3/2023

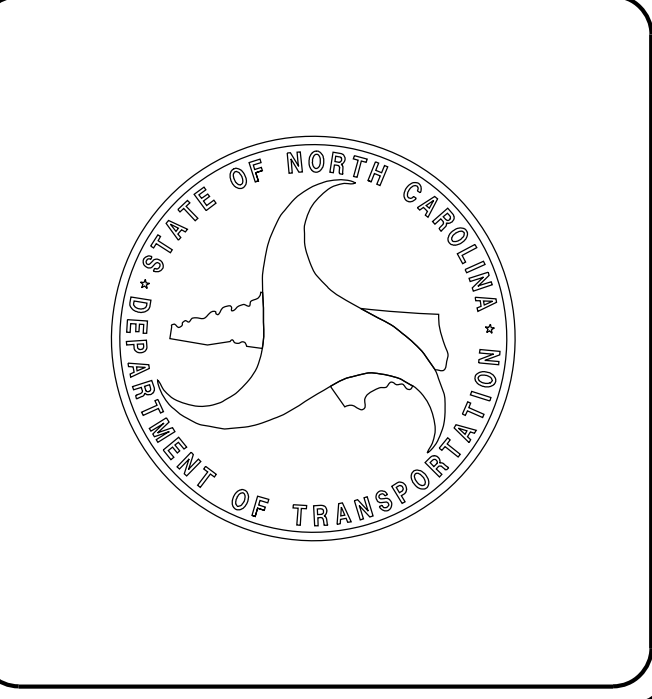

02-MAY-2023 09:41
R:\Roadway\Proj\R5799_Rdy_tsh.dgn
\$\$\$\$\$USERNAME\$\$\$\$\$