

5/14/99

THE ESTIMATED QUANTITY OF DUCTILE IRON WATER PIPE FITTINGS ON THIS PLAN SHEET IS 0 POUNDS. THE ACTUAL QUANTITY AND TYPE OF FITTINGS WILL VARY BASED ON FIELD CONDITIONS.

PROJECT REFERENCE NO.	SHEET NO.
R-5799	UC-5A
DESIGNED BY: MRD	
DRAWN BY: SRW	
CHECKED BY: JDN	
APPROVED BY: JDN	
REVISED:	
NORTH CAROLINA DEPARTMENT OF TRANSPORTATION UTILITIES ENGINEERING SEC. PHONE: (919) 707-6690 FAX: (919) 250-4151	
7/13/2003 11:41:58 PM EDT UTILITY CONSTRUCTION PLANS ONLY	

UTILITY CONSTRUCTION

DOCUMENT NOT CONSIDERED FINAL UNLESS ALL SIGNATURES COMPLETED

2145
2140
2135
2130
2125
2120
2115
2110
2105

2135
2130
2125
2120
2115
2110
2105

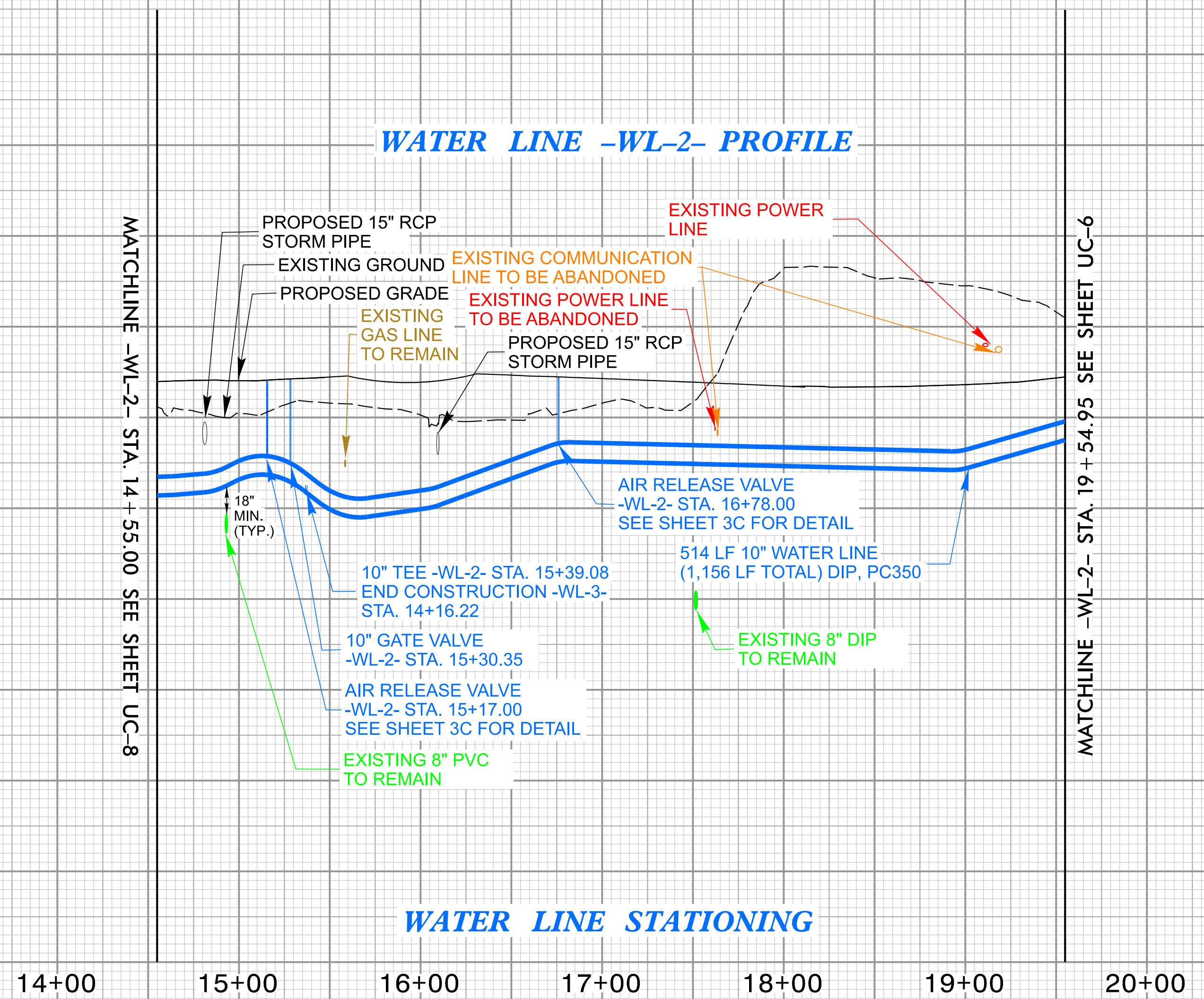

5/14/2003 10:09:45 AM ... Water-Line Sheets_ORD.dgn