

PHASING DIAGRAM

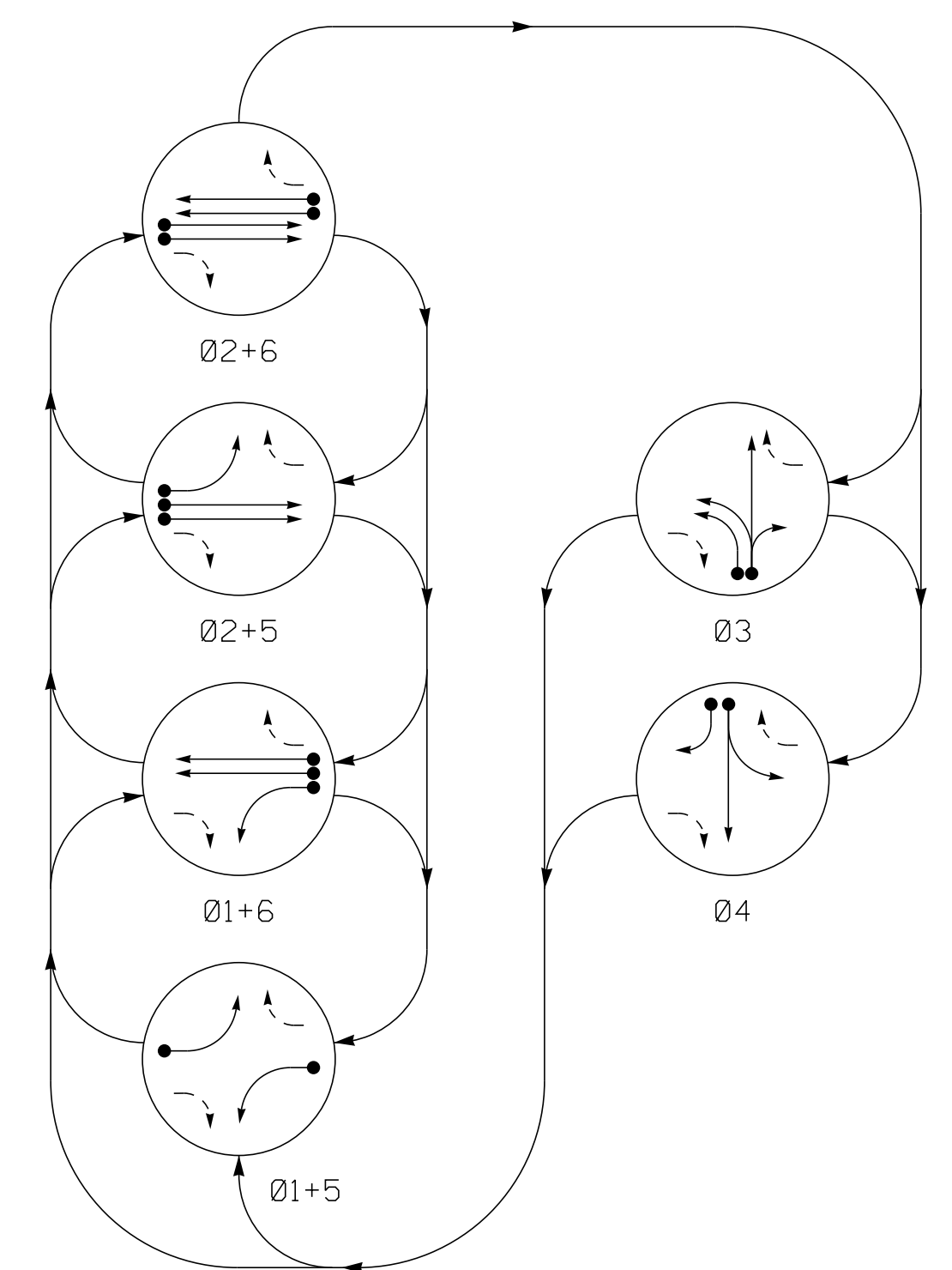

PHASING DIAGRAM DETECTION LEGEND

- DETECTED MOVEMENT
- UNDETECTED MOVEMENT (OVERLAP)
- UNSIGNALIZED MOVEMENT
- PEDESTRIAN MOVEMENT

SIGNAL FACE	PHASE					
	Ø 1+5	Ø 2+5	Ø 2+6	Ø 3	Ø 4	FLASH
11	←	←	←	←	←	←
21, 22	R	R	G	R	R	Y
31	R	R	R	G	R	R
32, 33	R	R	R	G	R	R
41	R	R	R	R	G	R
42	R	R	R	R	G	R
51	←	←	←	←	←	←
61, 62	R	G	R	G	R	Y

SIGNAL FACE I.D.

All Heads L.E.D.

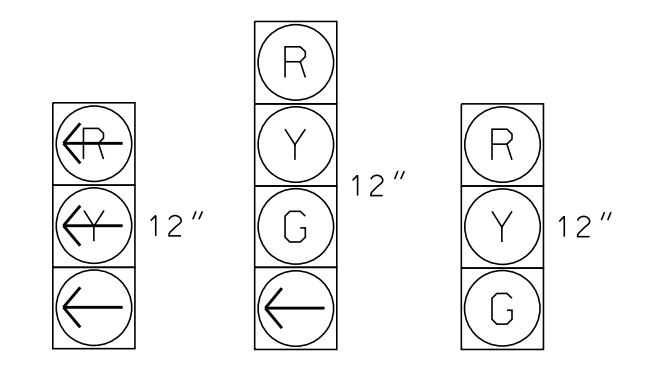

MAXTIME DETECTOR INSTALLATION CHART

LOOP	SIZE (FT)	DISTANCE FROM STOPBAR (FT)	TURNS	NEW LOOP	PROGRAMMING							
					CALL PHASE	DELAY TIME	EXTEND TIME	EXTEND ADDED INITIAL	CALL DELAY DURING GREEN	NEW CARD		
1A	6X40	0	*	*	1	-	-	X	-	X	-	*
2A	6X6	250	*	*	2	-	-	X	-	-	-	*
2B	6X6	250	*	*	2	-	-	X	-	-	-	*
2C	6X40	0	*	*	2	5.0	2.0	X	-	X	X	*
2D	6X40	0	*	*	2	5.0	2.0	X	-	X	X	*
3A	6X40	0	*	*	3	3.0	-	X	-	X	-	*
3B	6X40	0	*	*	3	-	-	X	-	X	-	*
4A	6X40	0	*	*	4	-	-	X	-	X	-	*
4B	6X40	0	*	*	4	10.0	-	X	-	X	-	*
5A	6X40	0	*	*	5	-	-	X	-	X	-	*
6A	6X6	250	*	*	6	-	-	X	-	-	-	*
6B	6X6	250	*	*	6	-	-	X	-	-	-	*
6C	6X40	0	*	*	6	5.0	2.0	X	-	X	X	*
6D	6X40	0	*	*	6	5.0	2.0	X	-	X	X	*

* Multi-zone Microwave Detection

6 Phase Fully Actuated (Time Based Coordination)

NOTES

- Refer to "Roadway Standard Drawings NCDOT" dated January 2018 and "Standard Specifications for Roads and Structures" dated January 2018.
- Do not program signal for late night flashing operation unless otherwise directed by the Engineer.
- Phase 1 and Phase 5 may be lagged.
- The order of Phase 3 and Phase 4 may be reversed.
- Reposition existing signal heads #22, 41, and 42.
- Set all detector units to presence mode.
- See R-5799 TMP Phase V for pavement markings.
- This intersection uses multi-zone microwave detection. Install detectors according to the manufacturer's instructions to achieve the desired detection.
- Maximum times shown in timing chart are for free-run operation only. Coordinated signal system timing values supersede these values.

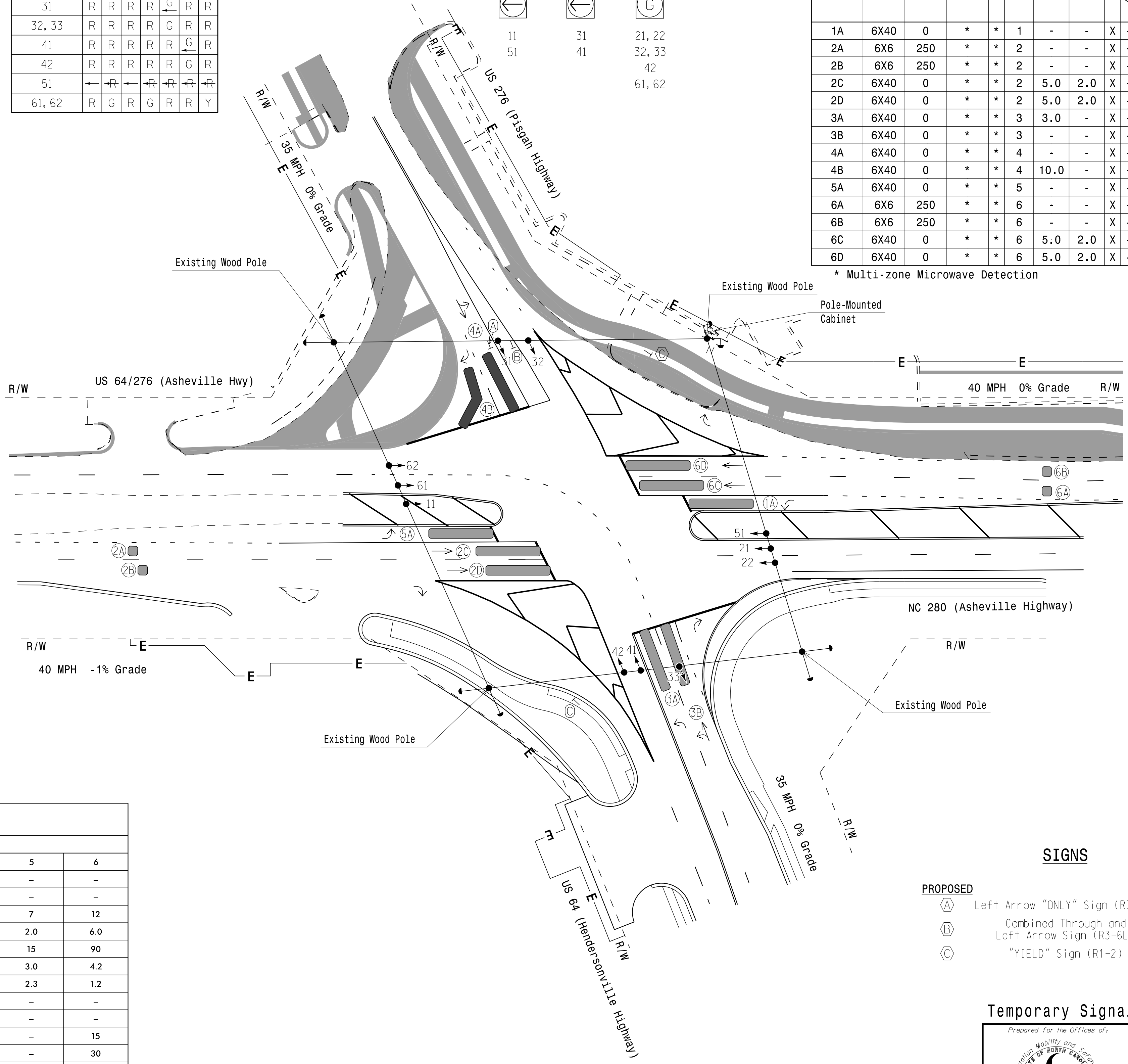

LEGEND

- | | | | |
|--|--|--|--|
| | PROPOSED Traffic Signal Head | | EXISTING Traffic Signal Head |
| | PROPOSED Modified Signal Head | | EXISTING Modified Signal Head |
| | PROPOSED Pedestrian Signal Head | | EXISTING Pedestrian Signal Head |
| | PROPOSED Sign | | EXISTING Sign |
| | PROPOSED Signal Pole with Guy | | EXISTING Signal Pole with Guy |
| | PROPOSED Signal Pole with Sidewalk Guy | | EXISTING Signal Pole with Sidewalk Guy |
| | PROPOSED Inductive Loop Detector | | EXISTING Inductive Loop Detector |
| | PROPOSED Video Detection Zone | | EXISTING Video Detection Zone |
| | PROPOSED Controller & Cabinet | | EXISTING Controller & Cabinet |
| | PROPOSED Junction Box | | EXISTING Junction Box |
| | PROPOSED Oversized Junction Box | | EXISTING Oversized Junction Box |
| | PROPOSED Type I Pushbutton Post | | EXISTING Type I Pushbutton Post |
| | PROPOSED Type II Signal Pedestal | | EXISTING Type II Signal Pedestal |
| | PROPOSED Strain Pole | | EXISTING Strain Pole |
| | PROPOSED Construction Zone | | EXISTING Construction Zone |
| | PROPOSED Curb Ramp | | EXISTING Curb Ramp |
| | PROPOSED 2-in Underground Conduit | | EXISTING 2-in Underground Conduit |
| | PROPOSED Directional Drill | | EXISTING Directional Drill |
| | PROPOSED Directional Arrow | | EXISTING Directional Arrow |
| | PROPOSED Right of Way | | EXISTING Right of Way |
| | PROPOSED Temp. Construction Easement | | EXISTING Temp. Construction Easement |

SIGNS

- | | | | |
|--|---|--|---|
| | PROPOSED Left Arrow "ONLY" Sign (R3-5L) | | EXISTING Left Arrow "ONLY" Sign (R3-5L) |
| | PROPOSED Combined Through and Left Arrow Sign (R3-6L) | | EXISTING Combined Through and Left Arrow Sign (R3-6L) |
| | PROPOSED "YIELD" Sign (R1-2) | | EXISTING "YIELD" Sign (R1-2) |

MAXTIME TIMING CHART

FEATURE	PHASE					
	1	2	3	4	5	6
Walk *	-	-	-	-	-	-
Ped Clear *	-	-	-	-	-	-
Min Green	7	12	7	7	7	12
Passage *	2.0	6.0	2.0	2.0	2.0	6.0
Max I *	15	90	25	35	15	90
Yellow Change	3.0	4.2	3.8	3.8	3.0	4.2
Red Clear	2.4	1.2	3.0	2.8	2.3	1.2
Added Initial *	-	-	-	-	-	-
Maximum Initial *	-	-	-	-	-	-
Time Before Reduction *	-	15	-	-	-	15
Time To Reduce *	-	30	-	-	-	30
Minimum Gap	-	3.0	-	-	-	3.0
Advance Walk	-	-	-	-	-	-
Non Lock Detector	X	-	X	X	X	-
Vehicle Recall	-	MIN. RECALL	-	-	-	MIN. RECALL
Dual Entry	-	-	-	-	-	-

* These values may be field adjusted. Do not adjust Min Green and Extension times for phases 2 and 6 lower than what is shown. Min Green for all other phases should not be lower than 4 seconds.

Temporary Signal 2 - TCP Phase V

 NC FIRM LICENSE No: F-0493 1520 SOUTH BOULEVARD, SUITE 200 CHARLOTTE, NC 28203 (704) 752-0610	Prepared for the Offices of: TRANSPORTATION MOBILITY AND SAFETY DIVISION DEPARTMENT OF TRANSPORTATION SIGNAL DESIGN SECTION 750 N. Greenfield Pkwy, Garner, NC 27529	US 64-276 / NC 280 (Asheville Highway) at US 64 (Hendersonville Highway) / US 276 (Pisgah Highway) Division 14 Transylvania County Brevard	SEAL Steven G. Haynie/28/2023 DATE
	PLAN DATE: April 2023 PREPARED BY: P. Koloski REVISIONS:	REVIEWED BY: S.G. Haynie REVIEWED BY:	REVISIONS:

4/28/2023 4:53:37:01 PM \\rsandh.com\dfs\1es\tr\ospor\101\on\p\4\030049021_R-5799_US_64-276_Intersection_Design\0403\gn\p\on_Sheets\05799_s\g\psh_10-0_14065912.dgn