

CULVERT CONSTRUCTION SEQUENCE 1 STA. 17+50 -Y2-

1. UTILIZE SPECIAL STILLING BASIN(S) DURING CULVERT CONSTRUCTION AS NEEDED.
2. INSTALL IMPERVIOUS DIKES AT INLET AND OUTLET OF EXISTING TRIPLE 9'X10' RCBC, DIVERTING FLOW THROUGH BARREL 1.
3. CONSTRUCT UPSTREAM EXTENSION FOR BARREL 2 & BARREL 3. CONSTRUCT HEADWALL AND STABILIZE SLOPES. INSTALL PROPOSED RIP RAP.
4. CONSTRUCT DOWNSTREAM EXTENSION FOR BARREL 2 & BARREL 3. CONSTRUCT HEADWALL AND STABILIZE SLOPES. INSTALL PROPOSED RIP RAP.
5. EXCAVATE ANY ACCUMULATED SILT AND DEWATER BEFORE REMOVAL AND RELOCATION OF IMPERVIOUS DIKE. STABILIZE DISTURBED AREA AND BACKFILL ACCORDINGLY.

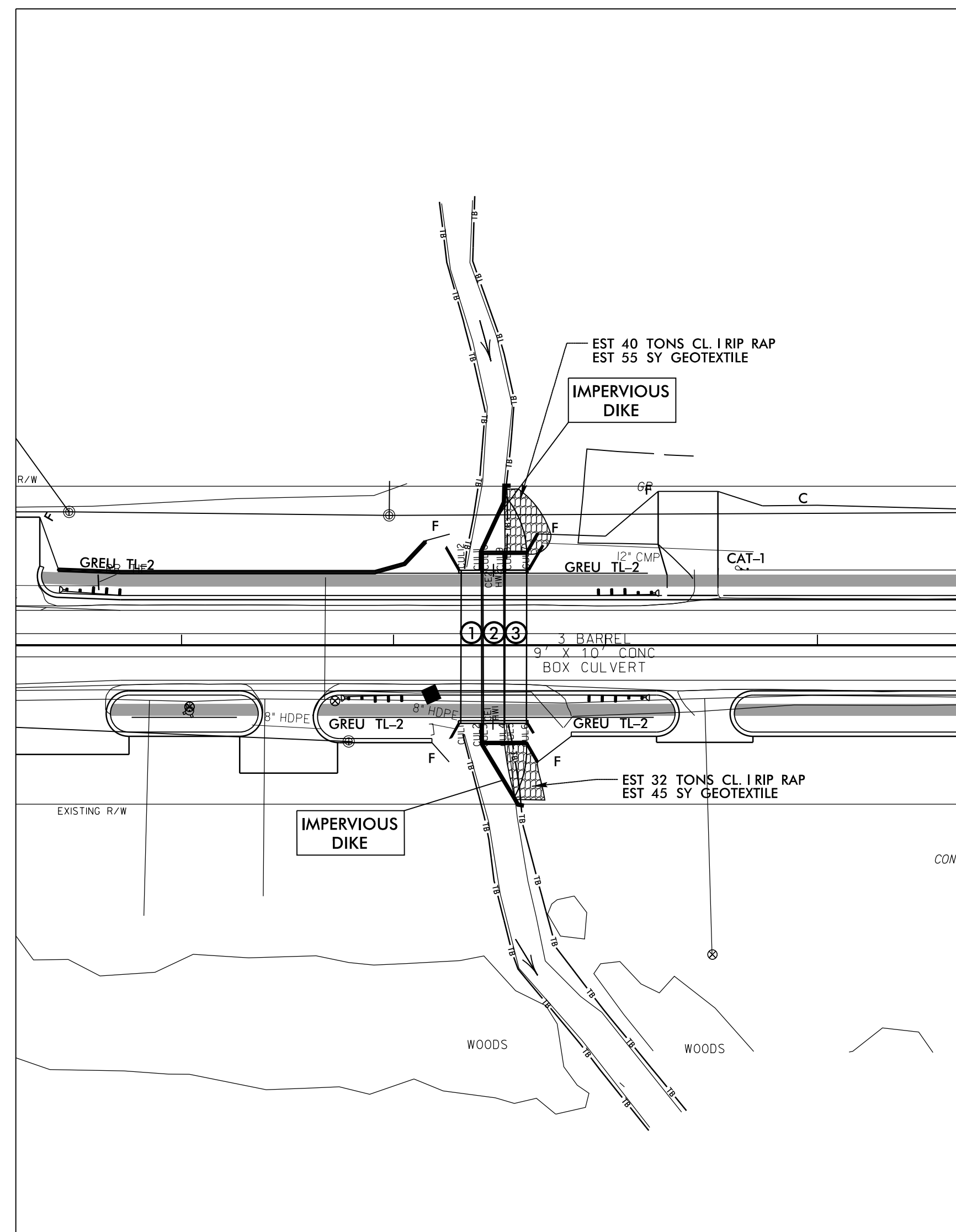

CULVERT CONSTRUCTION SEQUENCE 2 STA. 17+50 -Y2-

1. UTILIZE SPECIAL STILLING BASIN(S) DURING CULVERT CONSTRUCTION AS NEEDED.
2. RELOCATE THE UPSTREAM AND DOWNSTREAM IMPERVIOUS DIKES TO DIVERT FLOW THROUGH BARREL 2 & BARREL 3.
3. CONSTRUCT UPSTREAM EXTENSION FOR BARREL 1. CONSTRUCT HEADWALL AND STABILIZE SLOPES. INSTALL PROPOSED RIP RAP.
4. CONSTRUCT DOWNSTREAM EXTENSION FOR BARREL 1. CONSTRUCT HEADWALL AND STABILIZE SLOPES. INSTALL PROPOSED RIP RAP.
5. EXCAVATE ANY ACCUMULATED SILT AND DEWATER BEFORE REMOVAL OF IMPERVIOUS DIKES. STABILIZE DISTURBED AREA AND BACKFILL ACCORDINGLY.

