

3/21/2023 8:16:32 AM P:\Raleigh\Projects\2019\Division 9 (Davenport)\B-5783\Structures\Drawings\NEW\280168_SB\B-5783_SMU_E2_280168.dgn

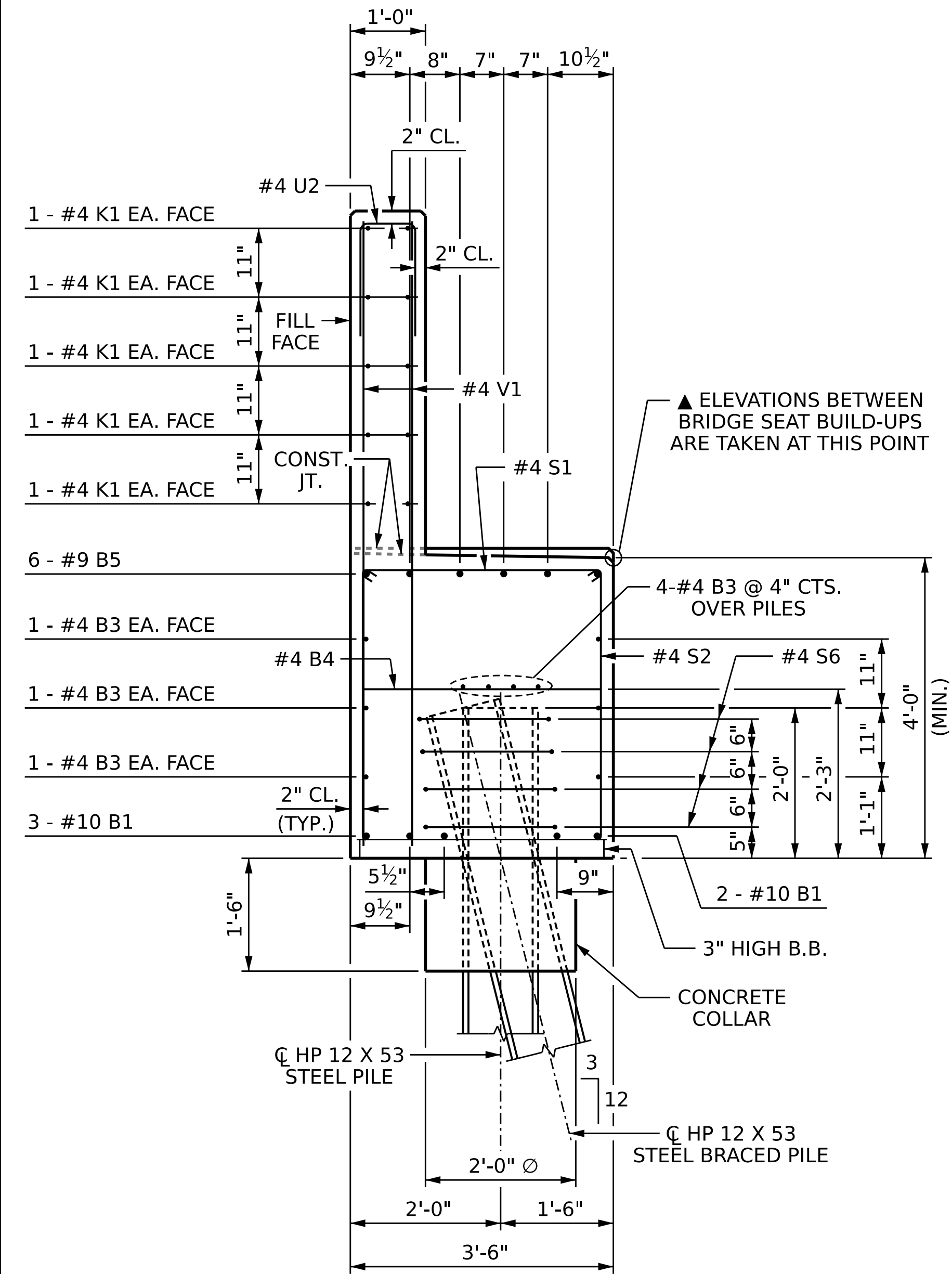

SECTION A-A

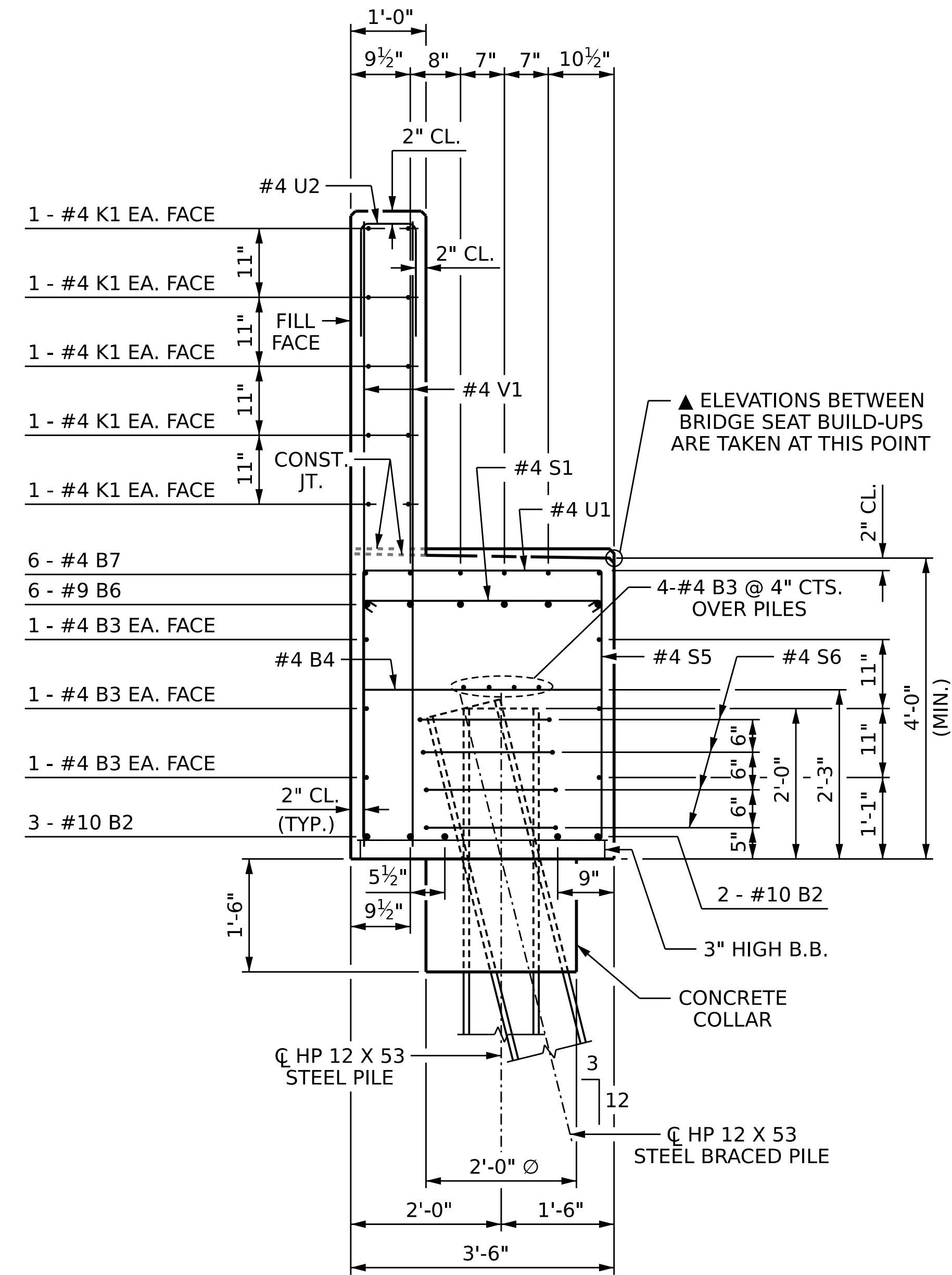

SECTION B-B

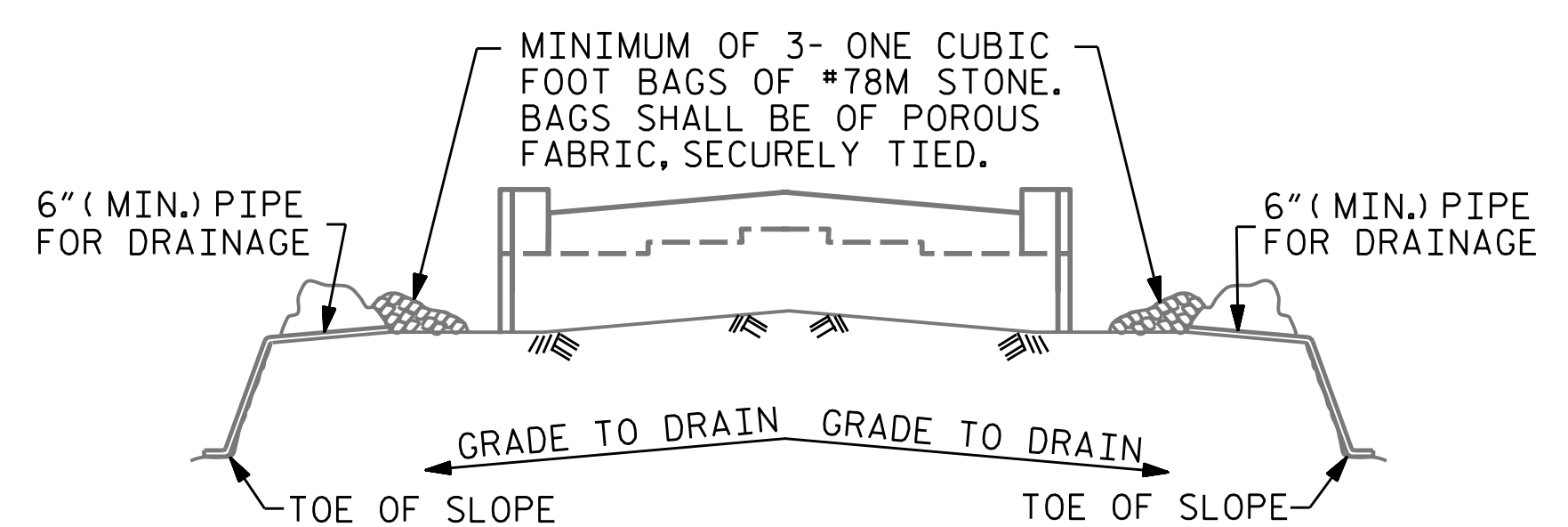

MINIMUM OF 3- ONE CUBIC FOOT BAGS OF #78M STONE. BAGS SHALL BE OF POROUS FABRIC, SECURELY TIED.

BAGGED STONE AND PIPE SHALL BE PLACED IMMEDIATELY AFTER COMPLETION OF END BENT EXCAVATION. PIPE MAY BE EITHER CONCRETE, CORRUGATED STEEL, CORRUGATED ALUMINUM ALLOY, OR CORRUGATED PLASTIC. PERFORATED PIPE WILL NOT BE ALLOWED.

BAGGED STONE SHALL REMAIN IN PLACE UNTIL THE ENGINEER DIRECTS THAT IT BE REMOVED. THE CONTRACTOR SHALL REMOVE AND DISPOSE OF SILT ACCUMULATIONS AT BAGGED STONE WHEN SO DIRECTED BY THE ENGINEER. BAGS SHALL BE REMOVED AND REPLACED WHENEVER THE ENGINEER DETERMINES THAT THEY HAVE DETERIORATED AND LOST THEIR EFFECTIVENESS.

NO SEPARATE PAYMENT WILL BE MADE FOR THIS WORK AND THE ENTIRE COST OF THIS WORK SHALL BE INCLUDED IN THE UNIT CONTRACT PRICE BID FOR THE SEVERAL PAY ITEMS.

TEMPORARY DRAINAGE AT END BENT

DRAWN BY : S.D. COOPER DATE : 12-22
 CHECKED BY : J.A. BATTS DATE : 12-22
 DESIGN ENGINEER OF RECORD : J.A. BATTS DATE : 12-22

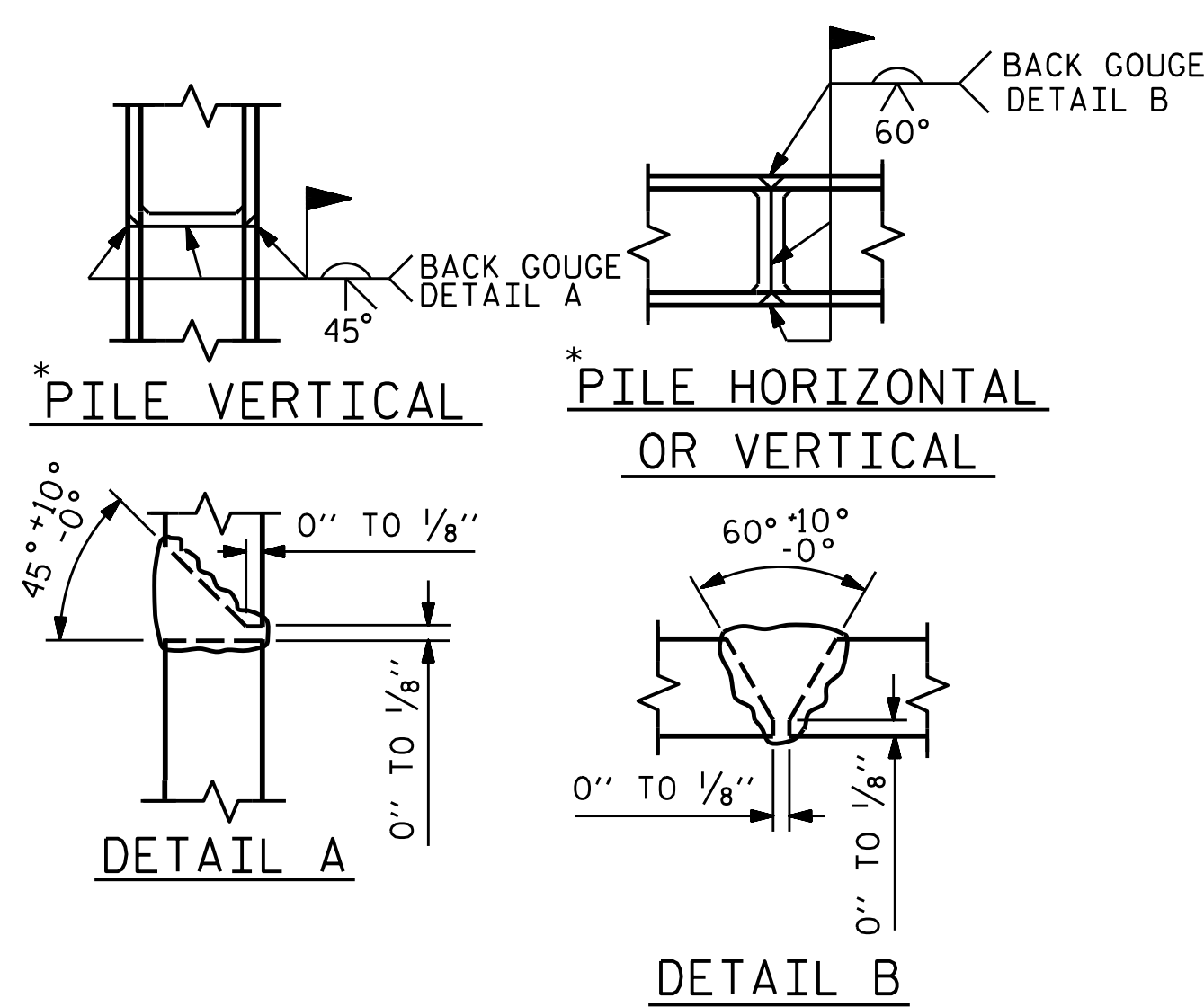
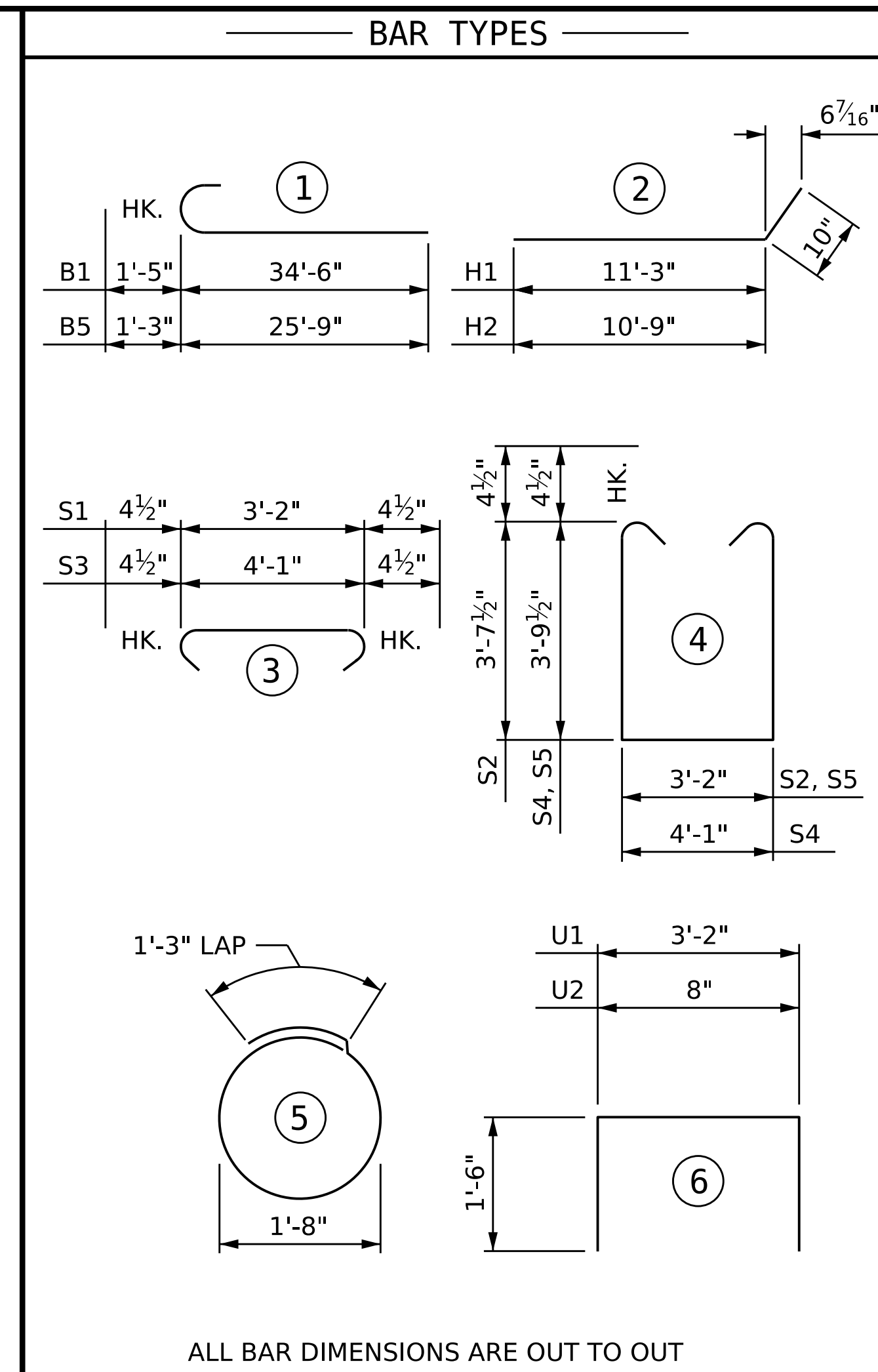

PILE SPLICE DETAILS

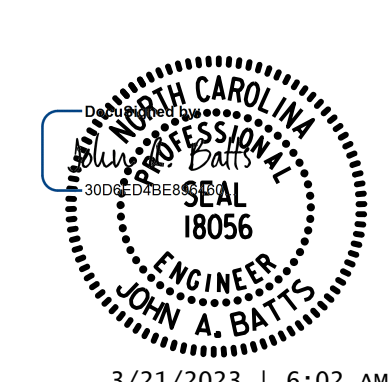

BILL OF MATERIAL					
END BENT 2					
BAR	NO.	SIZE	TYPE	LENGTH	WEIGHT
B1	5	#10	1	35'-11"	773
B2	5	#10	STR	34'-2"	735
B3	20	#4	STR	33'-9"	451
B4	18	#4	STR	3'-2"	38
B5	6	#9	1	27'-0"	551
B6	6	#9	STR	44'-0"	898
B7	12	#4	STR	2'-1"	17
H1	19	#5	2	12'-1"	239
H2	19	#5	2	11'-7"	230
K1	20	#4	STR	33'-9"	451
K2	4	#4	STR	3'-4"	9
K3	4	#4	STR	8'-3"	22
S1	66	#4	3	3'-11"	173
S2	18	#4	4	11'-2"	134
S3	2	#4	3	4'-10"	6
S4	2	#4	4	12'-5"	17
S5	48	#4	4	11'-6"	369
S6	28	#4	5	6'-6"	122
U1	6	#4	6	6'-2"	25
U2	54	#4	6	3'-8"	132
V1	108	#4	STR	7'-8"	553
V2	9	#4	STR	9'-2"	55
V3	33	#4	STR	9'-1"	200
TOTAL REINFORCING STEEL					6200 LB
CLASS A CONCRETE BREAKDOWN					
POUR 1 (CAP & LOWER WING)					37.1 CY
POUR 2 (BACKWALL & UPPER WING)					11.5 CY
TOTAL CLASS A CONCRETE					48.6 CY

PROJECT NO. B-5783
 DAVIDSON COUNTY
 STATION: 21+53.61 -SBL-

SHEET 3 OF 3

STATE OF NORTH CAROLINA
 DEPARTMENT OF TRANSPORTATION
 RALEIGH
 SUBSTRUCTURE

END BENT 2

REVISIONS				SHEET NO.	
NO.	BY:	DATE:	NO.	BY:	DATE:
1			3		
2			4		

TOTAL SHEETS: 40

DOCUMENT NOT CONSIDERED FINAL
 UNLESS ALL SIGNATURES COMPLETED