

3/21/2023 8:05:57 AM P:\Raleigh\Projects\2019\Division 9 (Davenport)\B-5783\Structures\Drawings\NEW\280164\_NB\B-5783\_SMU\_E2\_280164.dgn

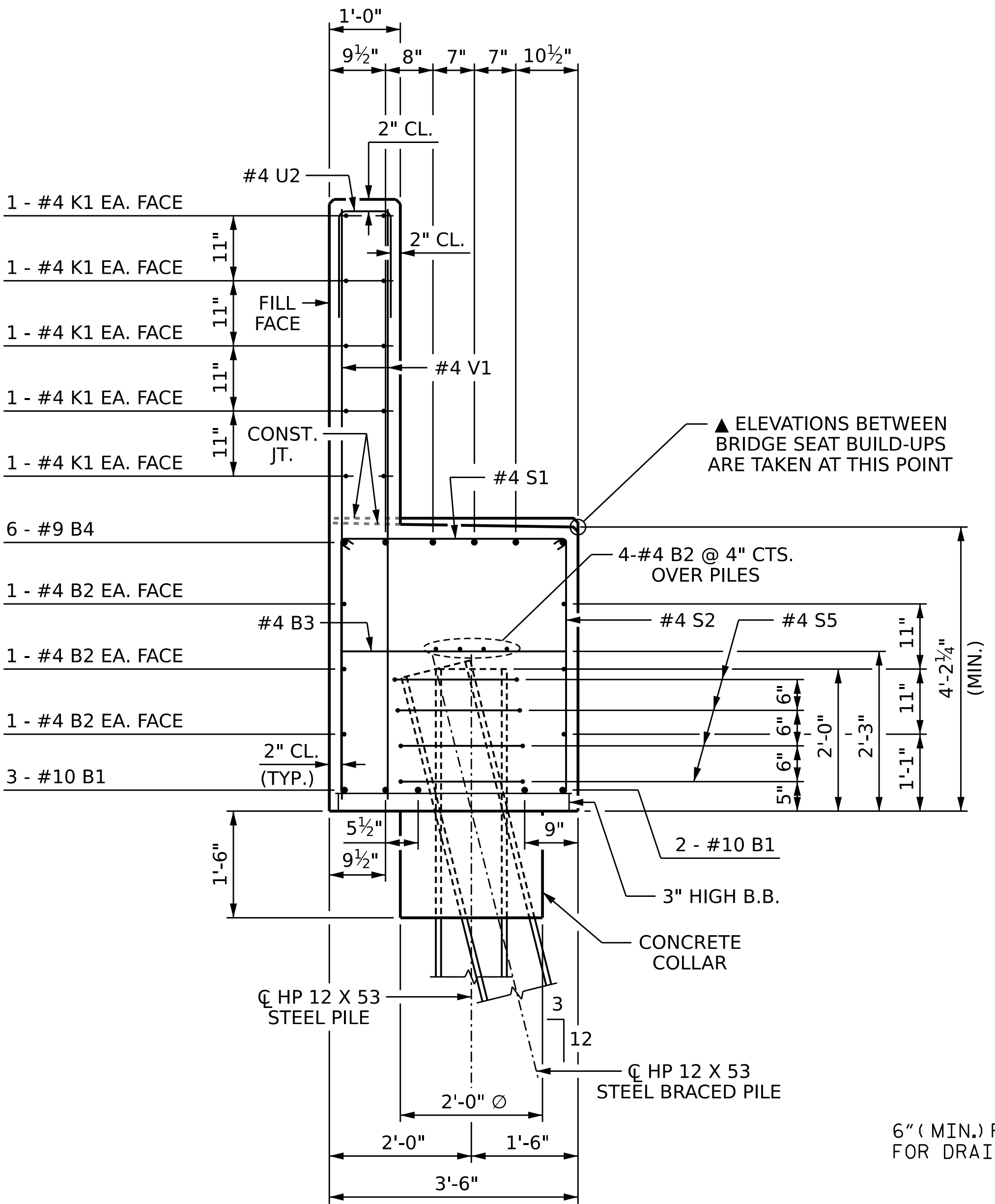

**SECTION A-A**

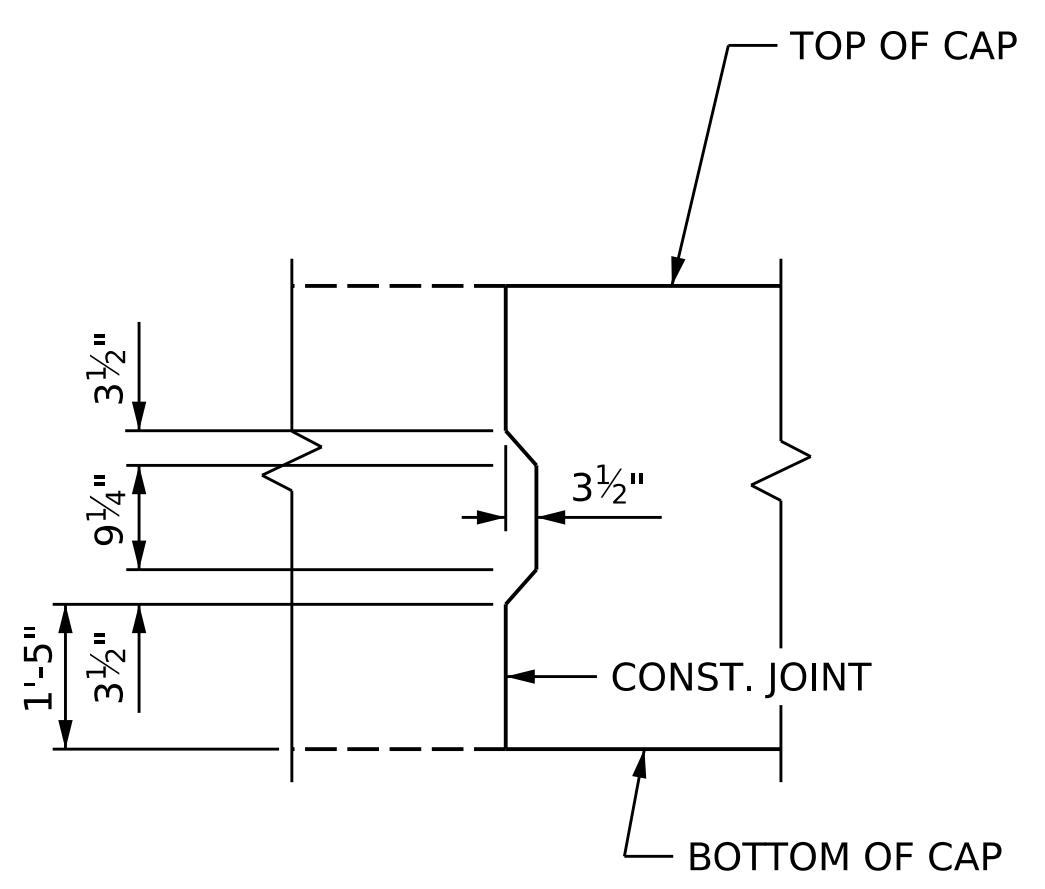

**SHEAR KEY DETAIL**

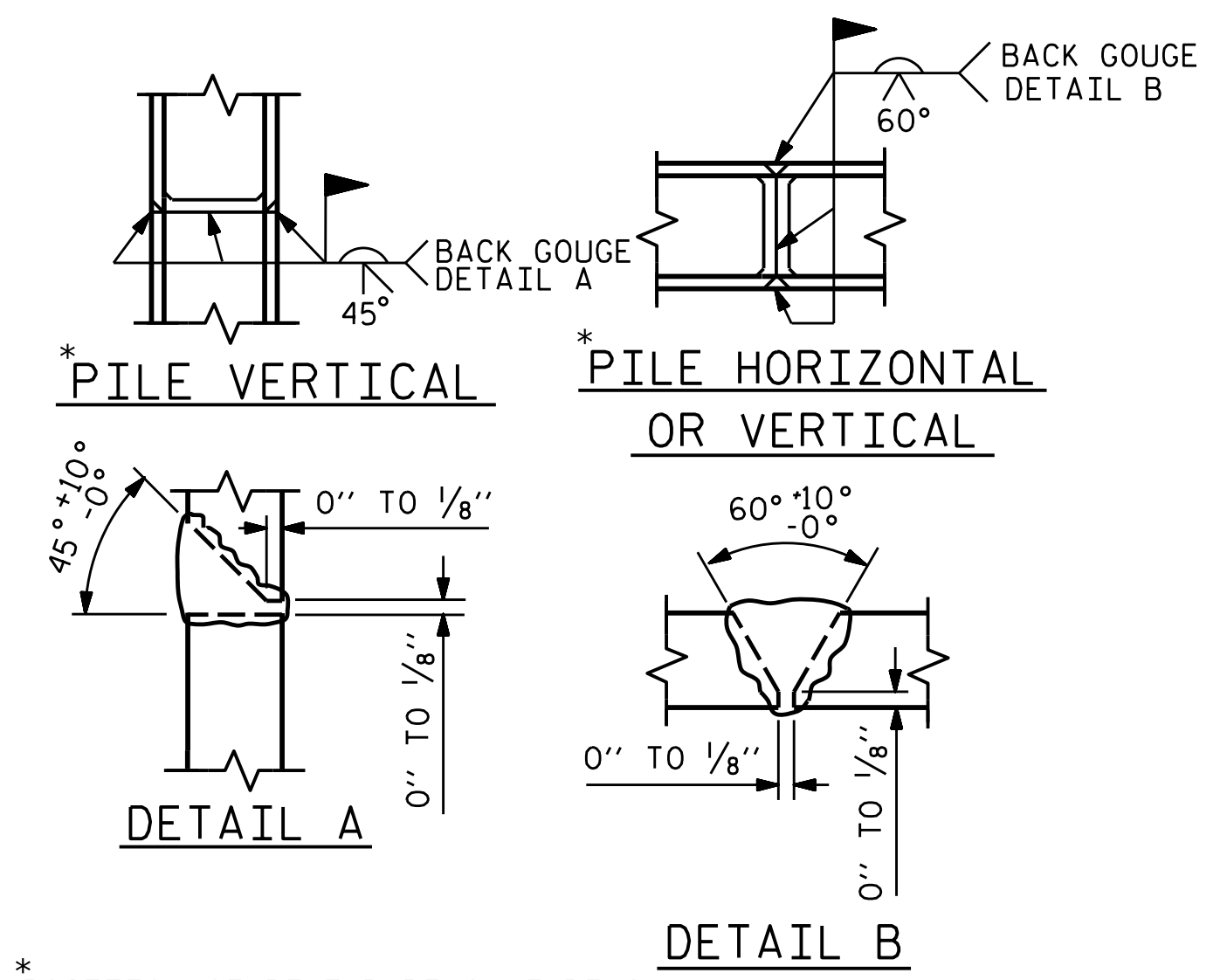

**PILE SPLICE DETAILS**

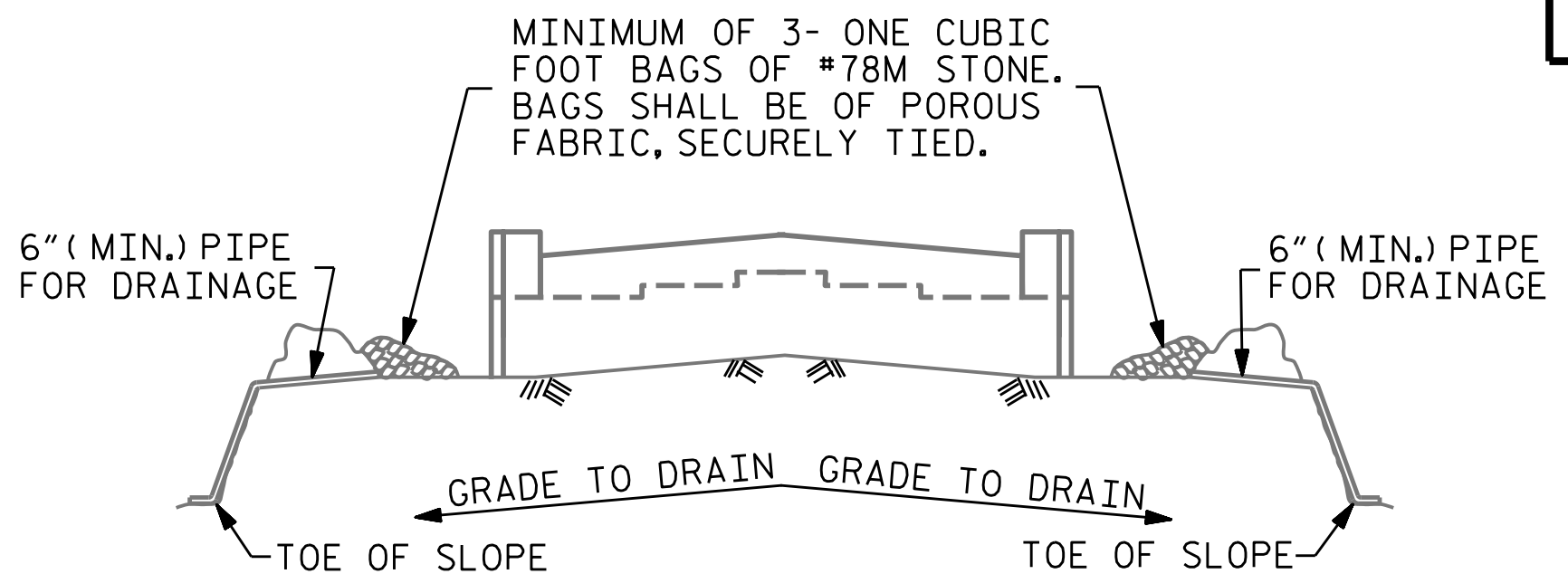

BAGGED STONE AND PIPE SHALL BE PLACED IMMEDIATELY AFTER COMPLETION OF END BENT EXCAVATION. PIPE MAY BE EITHER CONCRETE, CORRUGATED STEEL, CORRUGATED ALUMINUM ALLOY, OR CORRUGATED PLASTIC. PERFORATED PIPE WILL NOT BE ALLOWED.

BAGGED STONE SHALL REMAIN IN PLACE UNTIL THE ENGINEER DIRECTS THAT IT BE REMOVED. THE CONTRACTOR SHALL REMOVE AND DISPOSE OF SILT ACCUMULATIONS AT BAGGED STONE WHEN SO DIRECTED BY THE ENGINEER. BAGS SHALL BE REMOVED AND REPLACED WHENEVER THE ENGINEER DETERMINES THAT THEY HAVE DETERIORATED AND LOST THEIR EFFECTIVENESS.

NO SEPARATE PAYMENT WILL BE MADE FOR THIS WORK AND THE ENTIRE COST OF THIS WORK SHALL BE INCLUDED IN THE UNIT CONTRACT PRICE BID FOR THE SEVERAL PAY ITEMS.

**TEMPORARY DRAINAGE AT END BENT**

**BAR TYPES**

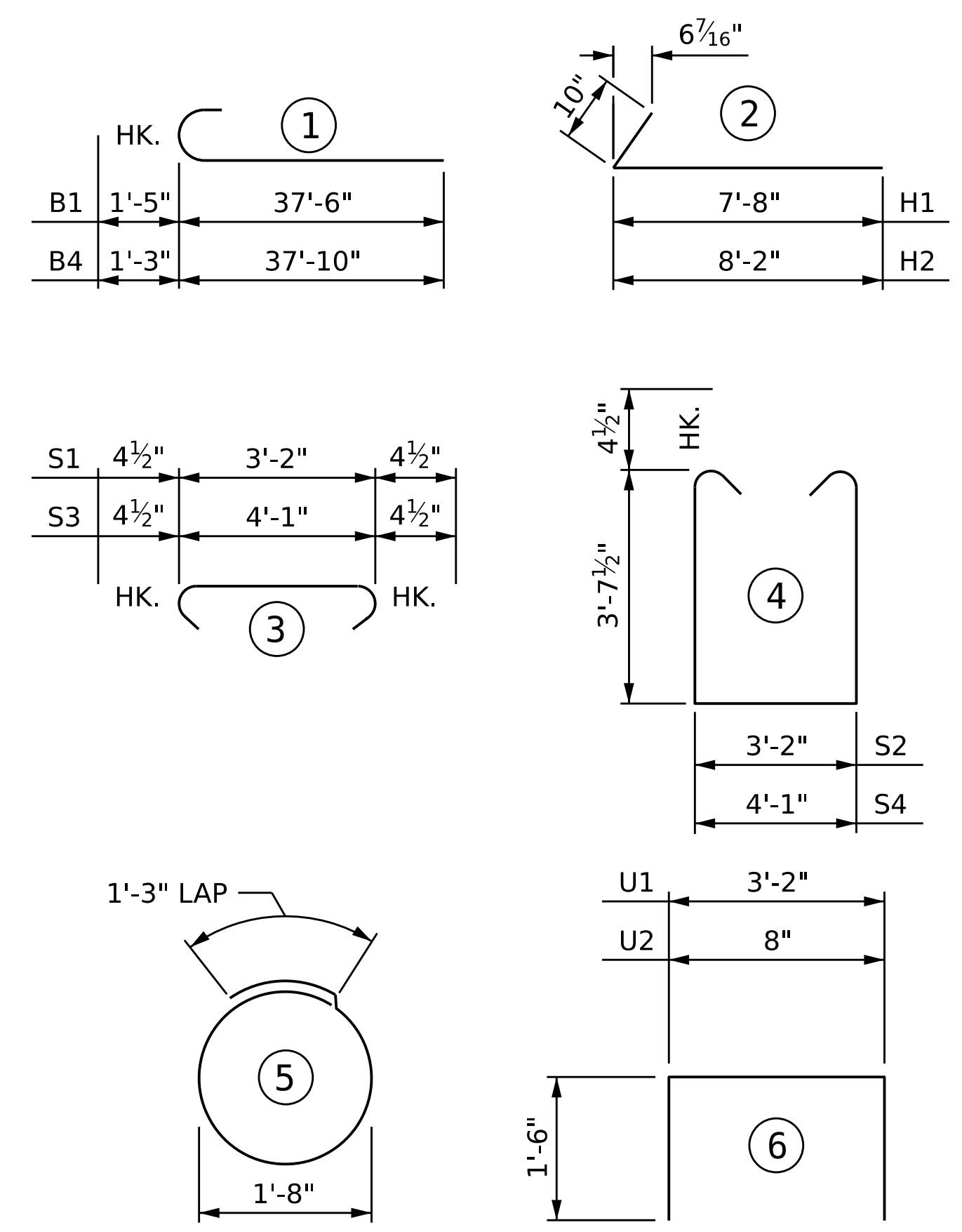

ALL BAR DIMENSIONS ARE OUT TO OUT

**BILL OF MATERIAL**

END BENT 2					
BAR	NO.	SIZE	TYPE	LENGTH	WEIGHT
B1	5	#10	1	38'-11"	837
B2	20	#4	STR	35'-1"	469
B3	16	#4	STR	3'-2"	34
B4	6	#9	1	39'-1"	797
B5	18	#4	STR	2'-1"	25
B6	5	#10	STR	34'-2"	735
B7	6	#9	STR	34'-7"	705
H1	14	#5	2	8'-6"	124
H2	14	#5	2	9'-0"	131
K1	20	#4	STR	35'-1"	469
K2	4	#4	STR	3'-6"	9
K3	4	#4	STR	9'-7"	26
S1	67	#4	3	3'-11"	175
S2	67	#4	4	11'-2"	500
S3	2	#4	3	4'-10"	6
S4	2	#4	4	12'-1"	16
S5	28	#4	5	6'-6"	122
U1	9	#4	6	6'-2"	37
U2	52	#4	6	3'-8"	127
V1	104	#4	STR	7'-9"	538
V2	39	#4	STR	9'-1"	237

TOTAL REINFORCING STEEL 6119 LB

CLASS A CONCRETE BREAKDOWN	
POUR 1 (CAP & LOWER WING)	37.9 CY
POUR 2 (BACKWALL & UPPER WING)	10.5 CY
<b>TOTAL CLASS A CONCRETE</b>	<b>48.4 CY</b>

PROJECT NO. B-5783  
DAVIDSON COUNTY  
 STATION: 21+13.32 -NBL-

SHEET 3 OF 3

STATE OF NORTH CAROLINA  
 DEPARTMENT OF TRANSPORTATION  
 RALEIGH  
 SUBSTRUCTURE  
**END BENT 2**

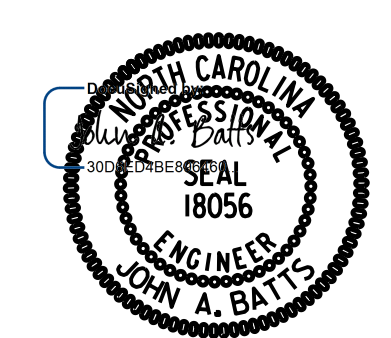

REVISIONS				SHEET NO.	
NO.	BY:	DATE:	NO.	BY:	DATE:
1			3		
2			4		

TOTAL SHEETS 40

DRAWN BY : S.D. COOPER DATE : 12-22  
 CHECKED BY : J.A. BATTS DATE : 12-22  
 DESIGN ENGINEER OF RECORD: J.A. BATTS DATE : 12-22

**DOCUMENT NOT CONSIDERED FINAL  
 UNLESS ALL SIGNATURES COMPLETED**