

5/14/1999

K:\PAL_Roadway\01036532 - R-5930 North CPW Roadway\Pro\A\R-5930A_roy_psh_2B-1.dgn

6/9/2023

PROJECT REFERENCE NO. R-5930A	SHEET NO. 2B-1
RW SHEET NO.	
ROADWAY DESIGN ENGINEER	HYDRAULICS ENGINEER
DOCUMENT NOT CONSIDERED FINAL UNLESS ALL SIGNATURES COMPLETED	

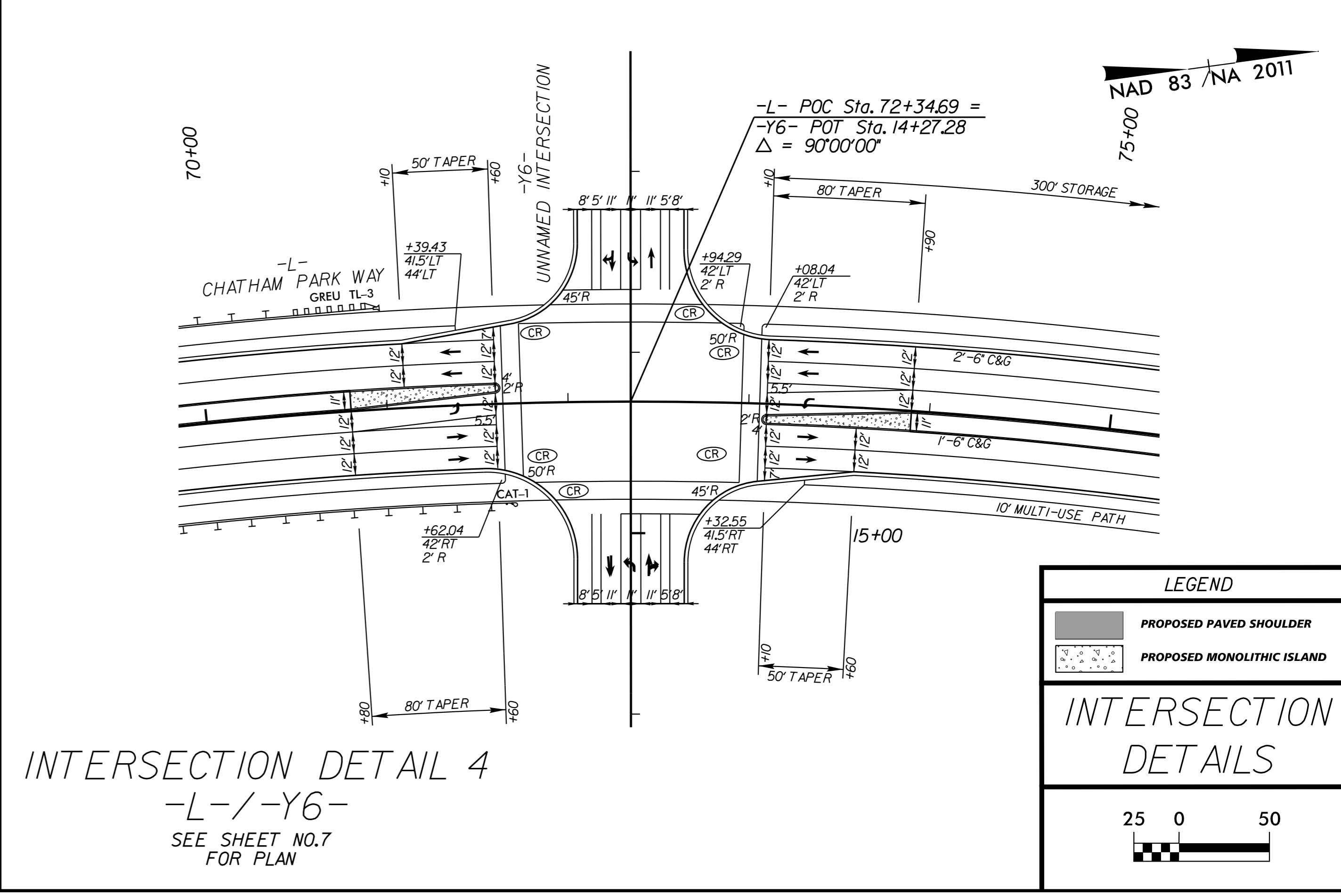
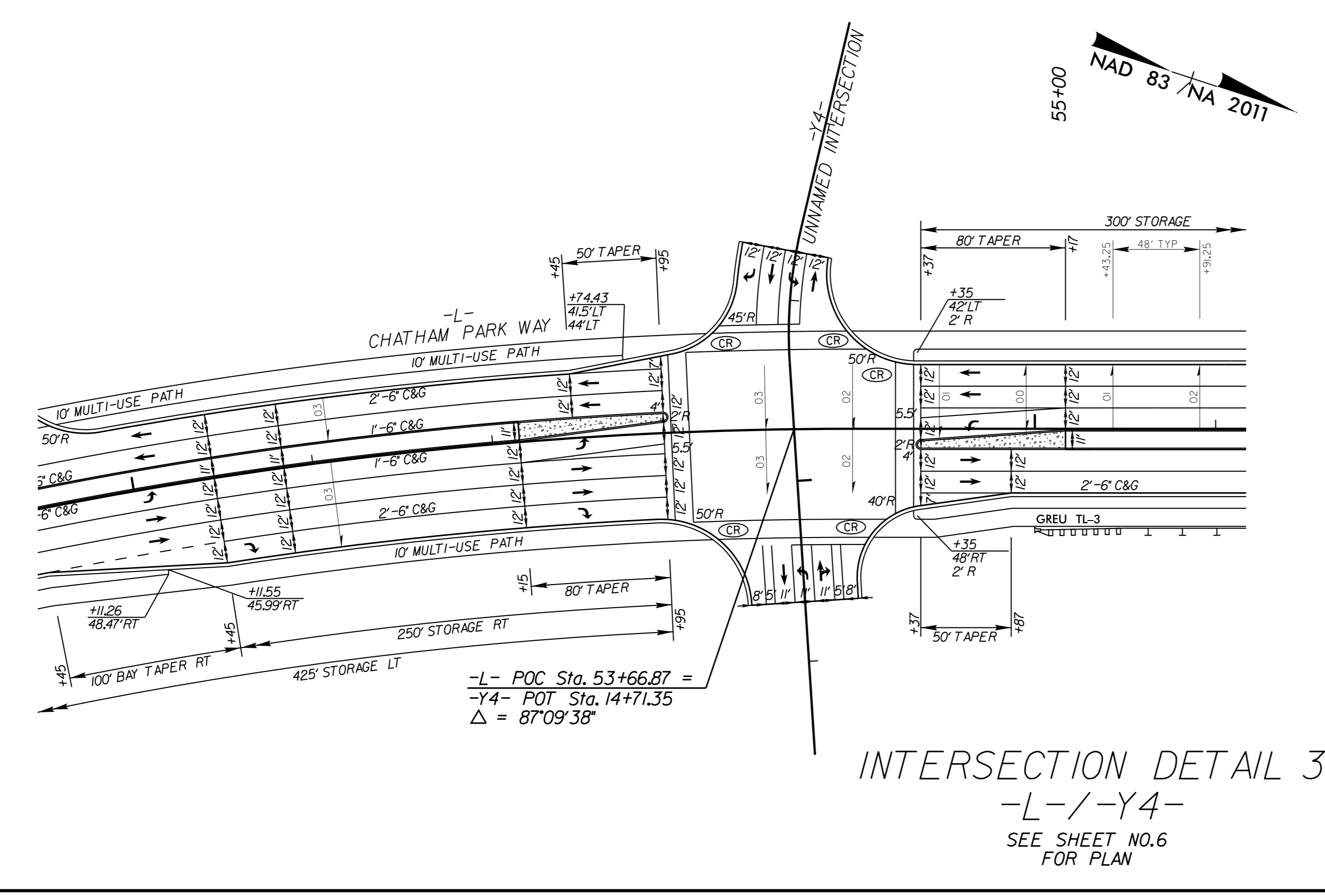
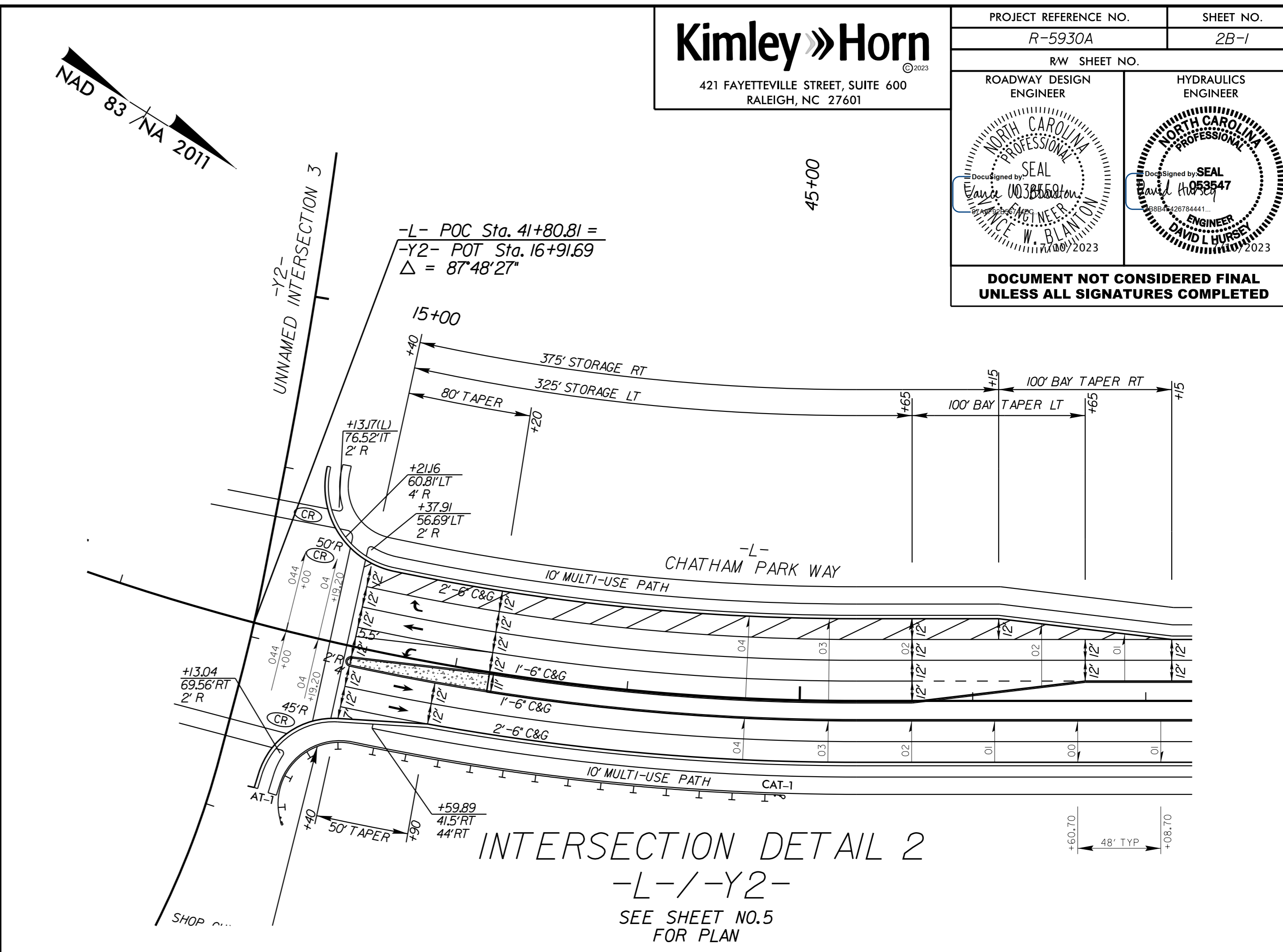
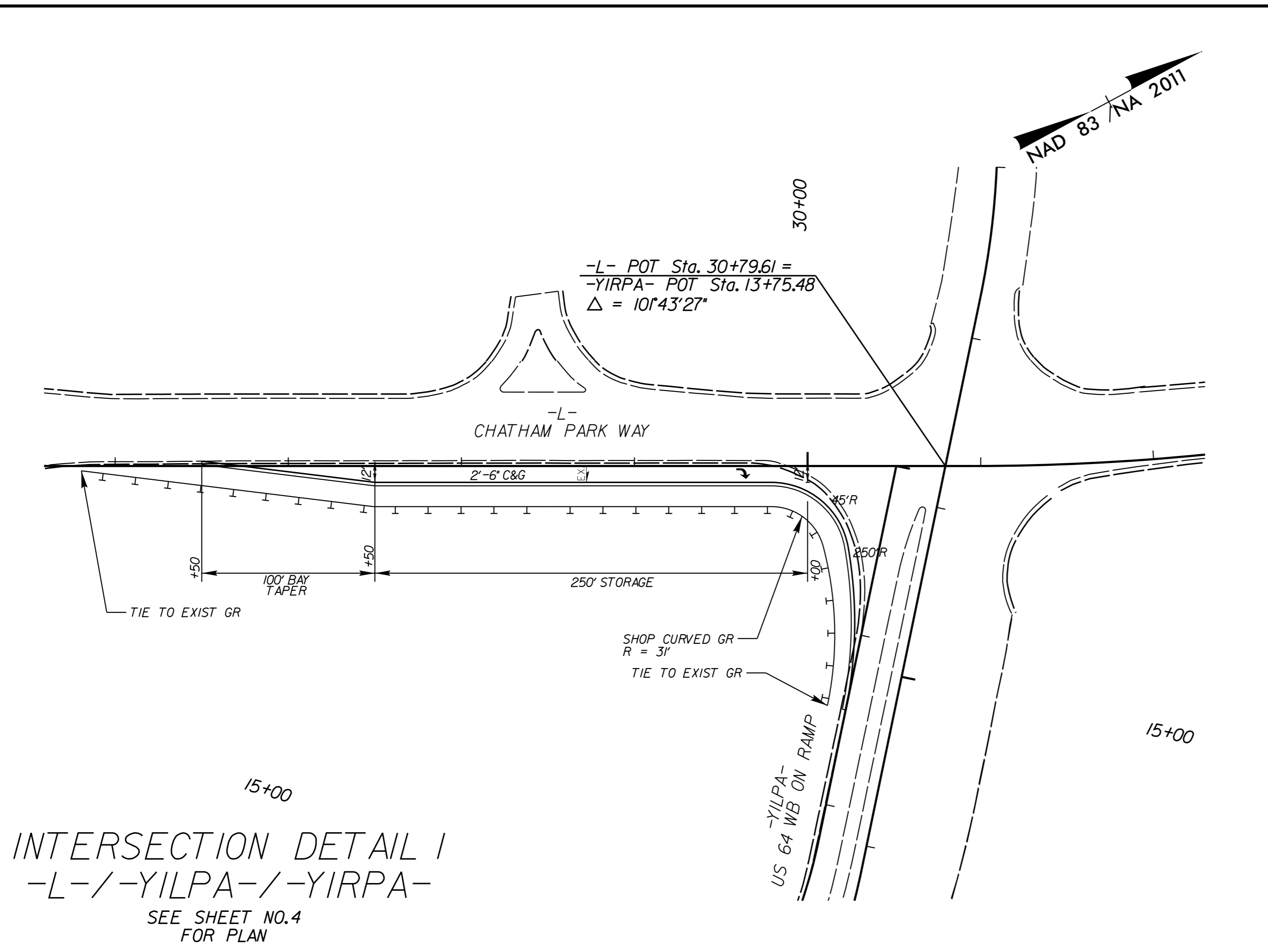

LEGEND

- PROPOSED PAVED SHOULDER
- PROPOSED MONOLITHIC ISLAND

INTERSECTION DETAILS

25 0 50