

**CONTRACT: C204715 STATE PROJECT: 17BP.14.R.212**

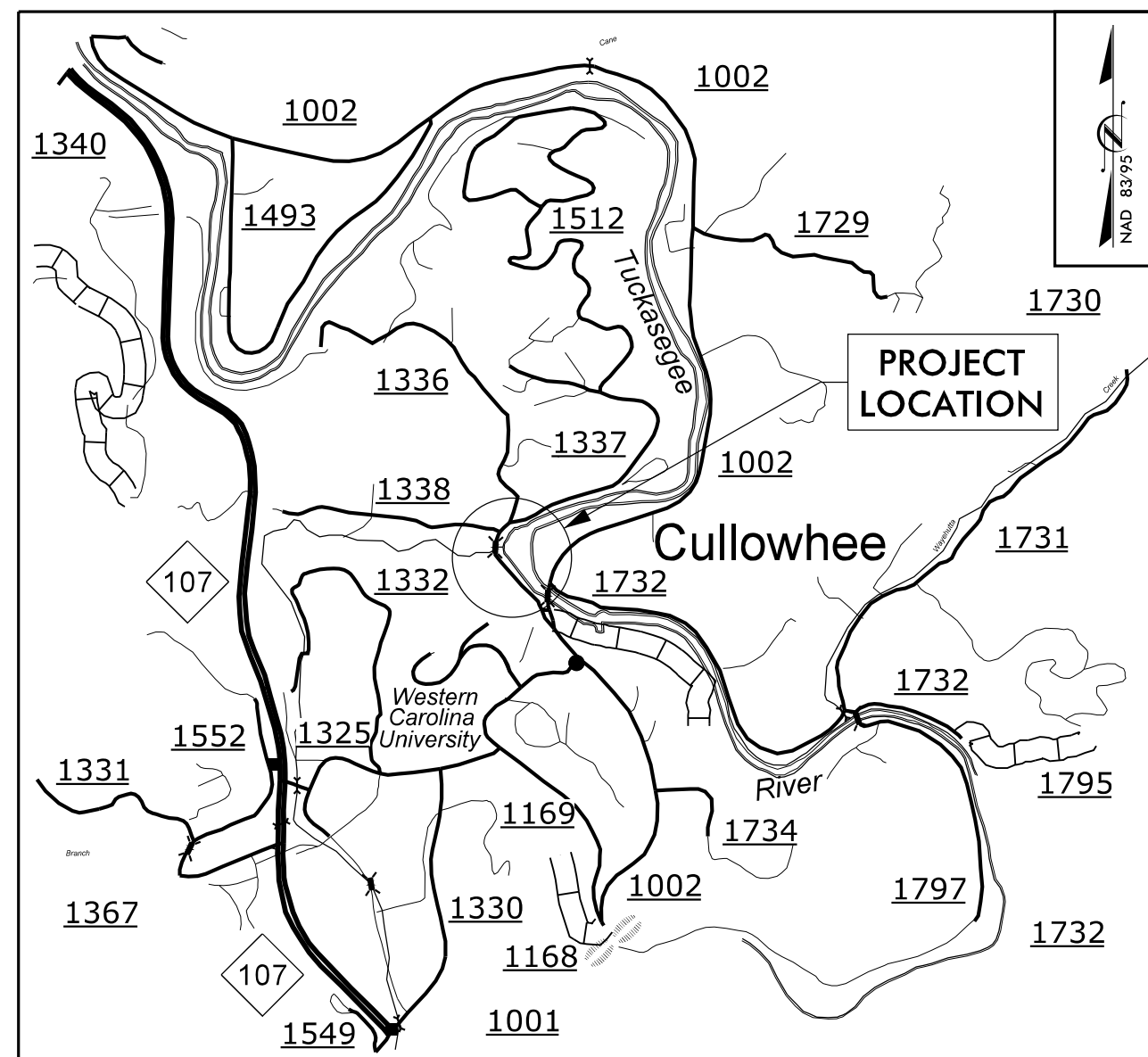

VICINITY MAP (NOT TO SCALE)

STATE OF NORTH CAROLINA  
DIVISION OF HIGHWAYS

PLAN FOR PROPOSED  
HIGHWAY EROSION CONTROL

**JACKSON COUNTY**

**LOCATION: SR 1336 (MONTEITH GAP ROAD) FROM NORTH OF SR 1002 (OLD CULLOWHEE ROAD) TO NORTH OF SR 1337 (LEDBETTER ROAD)**

**TYPE OF WORK: ROADWAY WIDENING, BIKE LANE/SIDEWALK CONSTRUCTION, GRADING, PAVING, DRAINAGE, AND STRUCTURES**

BEGIN STATE PROJECT 17BP.14.R.212  
-L- PCC Sta. 11+14.45  
TIE TO TIP PROJECT  
B-4159 -Y1- POC Sta. 11+20.00

BEGIN CONSTRUCTION  
-L- STA. POT 9+97.97  
26.82' RT

END CONSTRUCTION  
-Y2- POC Sta. 12+00.00

END STATE PROJECT 17BP.14.R.212  
-L- POC Sta. 28+00.00

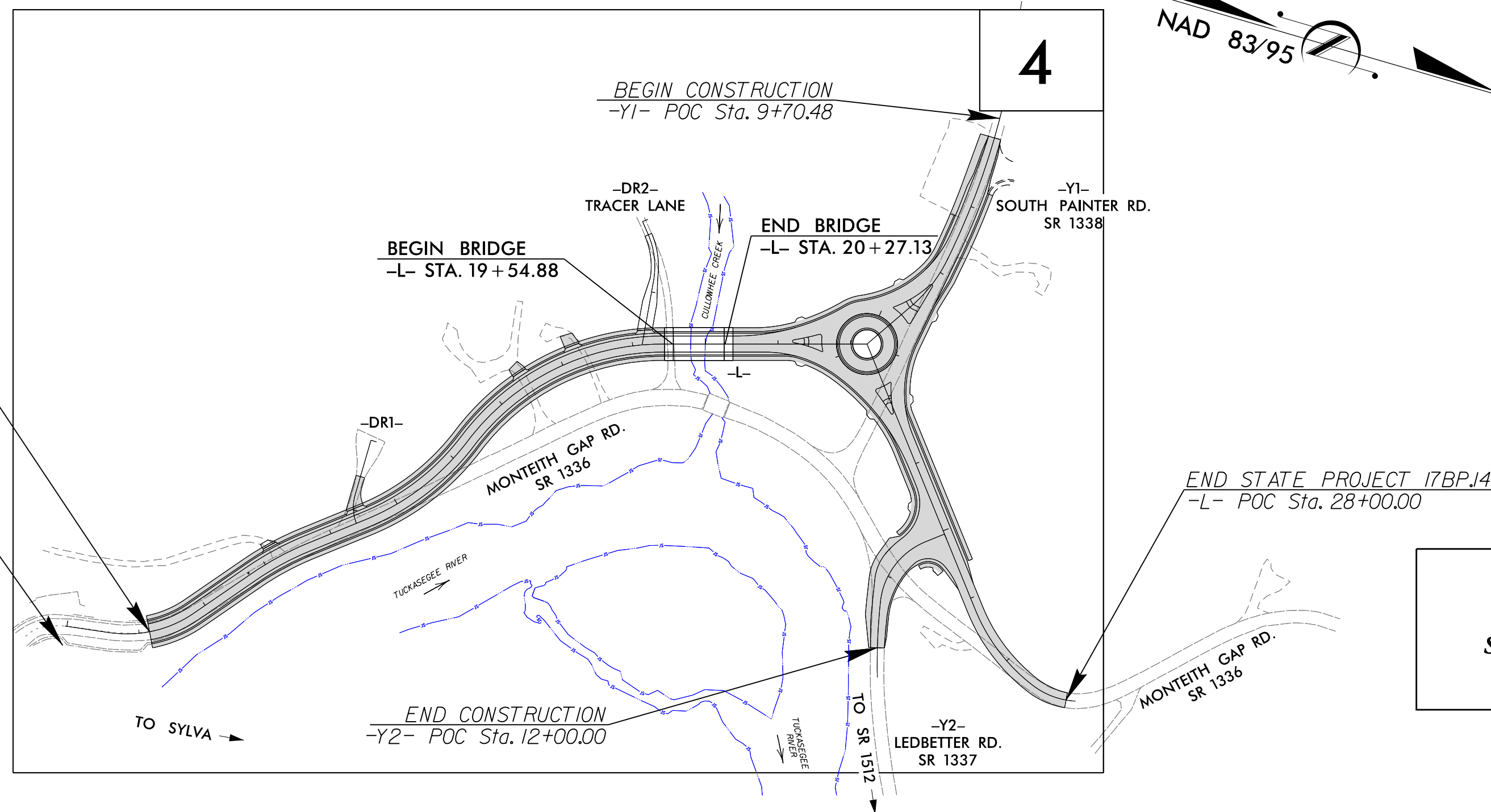

STATE	STATE PROJECT REFERENCE NO.	SHEET NO.	TOTAL SHEETS
N.C.	17BP.14.R.212	EC-1	9
STATE PROJ. NO.	F.A. PROJ. NO.	DESCRIPTION	
17BP.14.PE.212	N/A	P.E.	
17BP.14.ROW.212	N/A	ROW	
17BP.14.R.212	N/A	BRIDGE CONST.	
44983	N/A	BIKE LANES SIDEWALK ROADWAY	

EROSION AND SEDIMENT CONTROL MEASURES

Std. #	Description	Symbol
1630.03	Temporary Silt Ditch	---
1630.05	Temporary Diversion	---
1605.01	Temporary Silt Fence	
1606.01	Special Sediment Control Fence	---X---
1622.01	Temporary Berms and Slope Drains	---
1630.02	Silt Basin Type B	---
1633.01	Temporary Rock Silt Check Type-A	---
	Temporary Rock Silt Check Type-A with Matting and Polyacrylamide (PAM)	---
1633.02	Temporary Rock Silt Check Type-B	---
	Wattle / Coir Fiber Wattle	---
	Wattle / Coir Fiber Wattle with Polyacrylamide (PAM)	---
1634.01	Temporary Rock Sediment Dam Type-A	---
1634.02	Temporary Rock Sediment Dam Type-B	---
1635.01	Rock Pipe Inlet Sediment Trap Type-A	---
1635.02	Rock Pipe Inlet Sediment Trap Type-B	---
1630.04	Stilling Basin	---
1630.06	Special Stilling Basin	---
	Rock Inlet Sediment Trap:	
1632.01	Type A	A
1632.02	Type B	B
1632.03	Type C	C
	Skimmer Basin	---
	Tiered Skimmer Basin	---
	Infiltration Basin	---

THIS PROJECT CONTAINS EROSION CONTROL PLANS FOR CLEARING AND GRUBBING PHASE OF CONSTRUCTION.

THIS PROJECT HAS BEEN DESIGNED TO SENSITIVE WATERSHED STANDARDS.

ENVIRONMENTALLY SENSITIVE AREA(S) EXIST ON THIS PROJECT  
Refer To E. C. Special Provisions for Special Considerations.

CLEARING ON THIS PROJECT SHALL BE PERFORMED TO THE LIMITS ESTABLISHED BY METHOD III

GRAPHIC SCALE

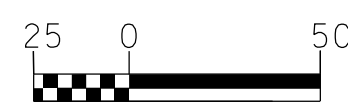

PLANS

THESE EROSION AND SEDIMENT CONTROL PLANS COMPLY WITH THE APPLICABLE REGULATIONS SET FORTH BY THE NCG-010000 GENERAL CONSTRUCTION PERMIT EFFECTIVE APRIL 1, 2019 AND ISSUED BY THE NORTH CAROLINA DEPARTMENT OF ENVIRONMENTAL QUALITY DIVISION OF WATER RESOURCES.



Prepared in the Office of:

HDR Engineering, Inc. of the Carolinas  
555 Fayetteville St, Suite 900 Raleigh, N.C. 27601  
N.C.B.E.L.S. License Number: F-0116

Designed by:

David R. Wagner II, PE 4286

NAME

LEVEL III CERTIFICATION NO.

Roadway Standard Drawings

The following roadway english standards as appear in "Roadway Standard Drawings"- Roadway Design Unit - N. C. Department of Transportation - Raleigh, N. C., dated January 2018 and the latest revision thereto are applicable to this project and by reference hereby are considered a part of these plans.

1604.01 Railroad Erosion Control Detail	1632.01 Rock Inlet Sediment Trap Type A
1605.01 Temporary Silt Fence	1632.02 Rock Inlet Sediment Trap Type B
1606.01 Special Sediment Control Fence	1632.03 Rock Inlet Sediment Trap Type C
1607.01 Gravel Construction Entrance	1633.01 Temporary Rock Silt Check Type A
1622.01 Temporary Berms and Slope Drains	1633.02 Temporary Rock Silt Check Type B
1630.01 Riser Basin	1634.01 Temporary Rock Sediment Dam Type A
1630.02 Silt Basin Type B	1634.02 Temporary Rock Sediment Dam Type B
1630.03 Temporary Silt Ditch	1635.01 Rock Pipe Inlet Sediment Trap Type A
1630.04 Stilling Basin	1635.02 Rock Pipe Inlet Sediment Trap Type B
1630.05 Temporary Diversion	1640.01 Coir Fiber Wattle
1630.06 Special Stilling Basin	1645.01 Temporary Stream Crossing
1631.01 Matting Installation	