

PROJECT REFERENCE NO. 17BP.14.R.212	SHEET NO. 6
ROADWAY DESIGN ENGINEER NORTH CAROLINA PROFESSIONAL SEAL 1044438 MATTHEW BEDEENBA 1/21/2022	HYDRAULICS ENGINEER NORTH CAROLINA PROFESSIONAL SEAL 042084 DANIEL J. MASHLEY 1/21/2022

**DOCUMENT NOT CONSIDERED FINAL
UNLESS ALL SIGNATURES COMPLETED**

-Y1-

-Y2-

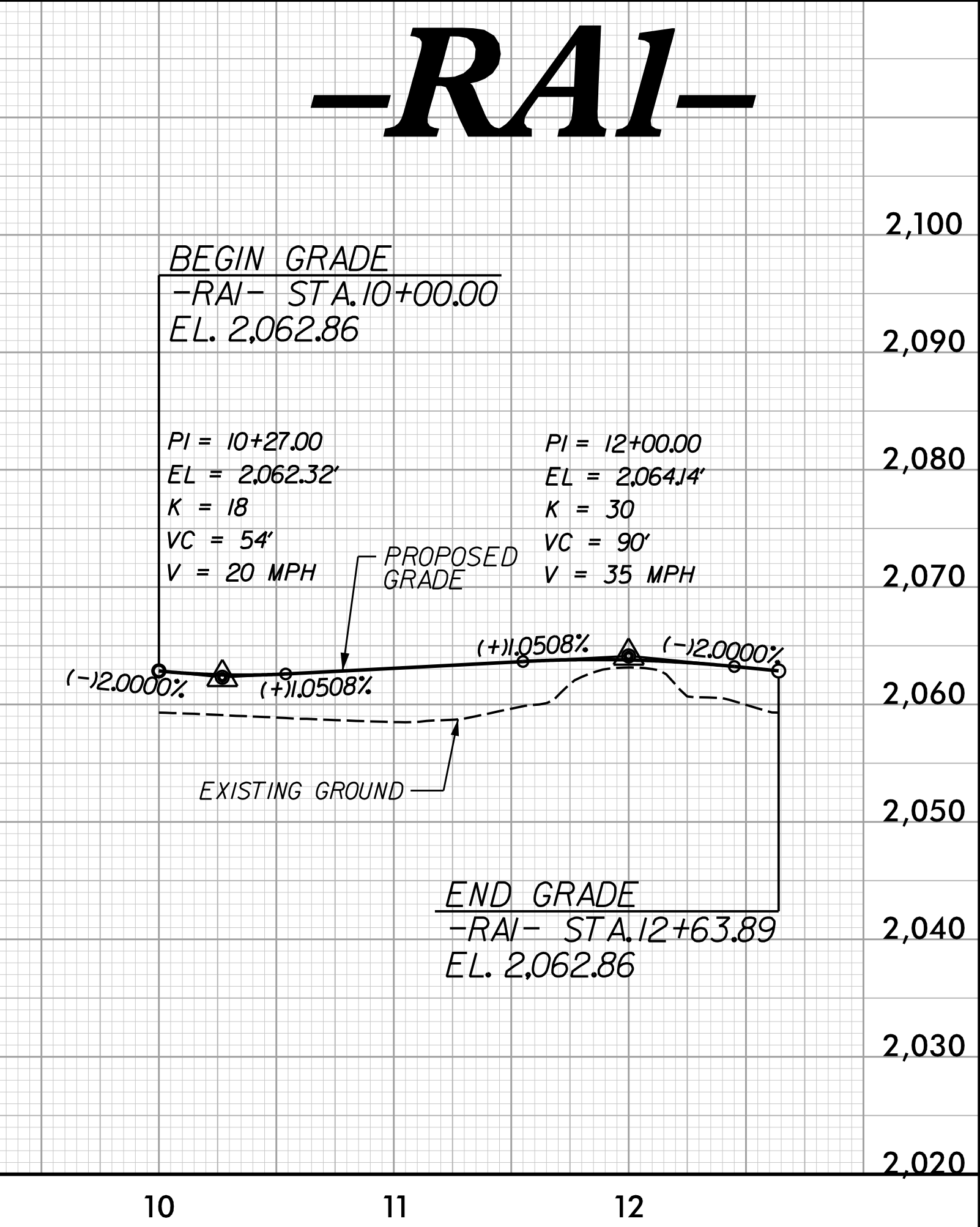
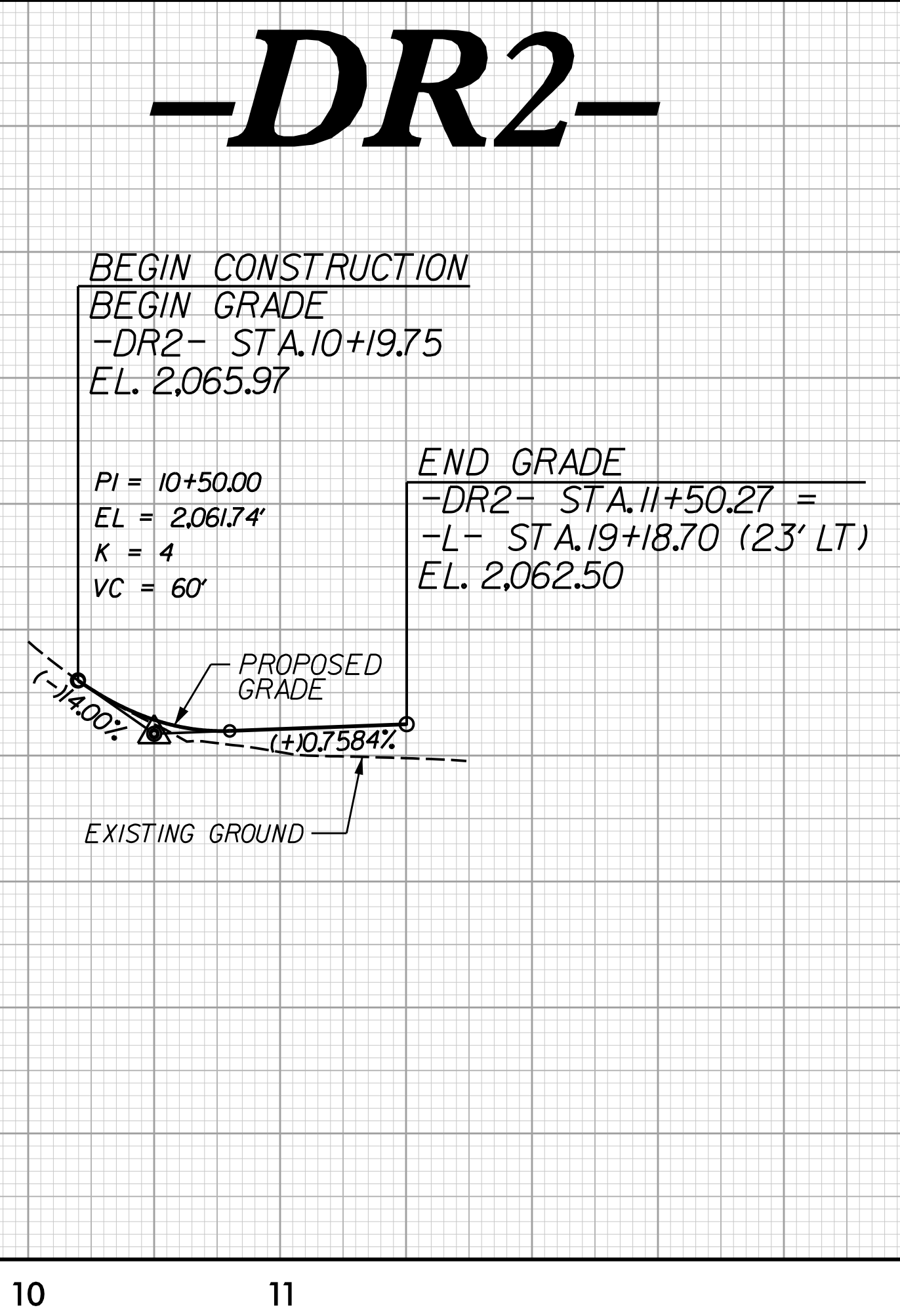
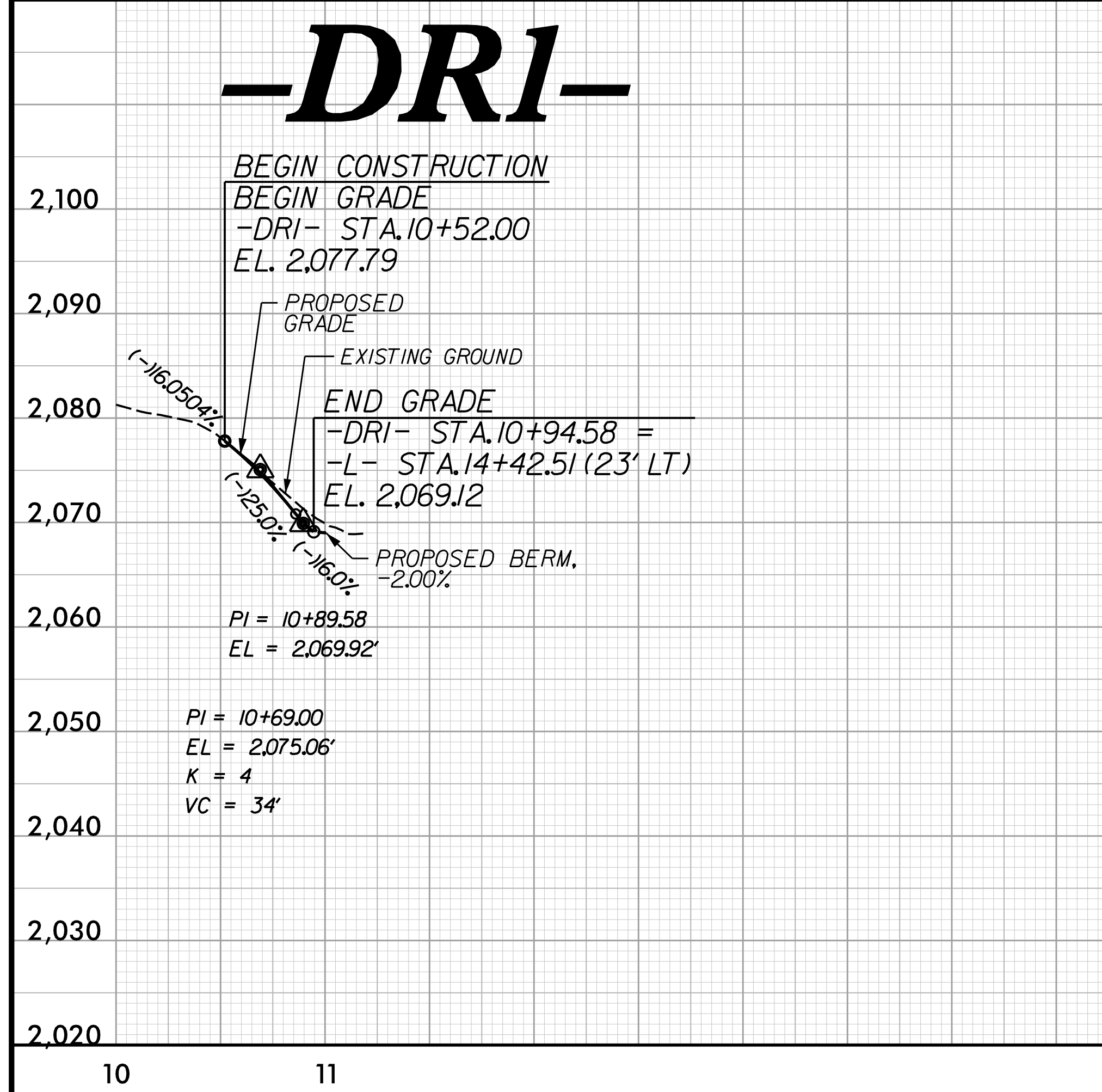
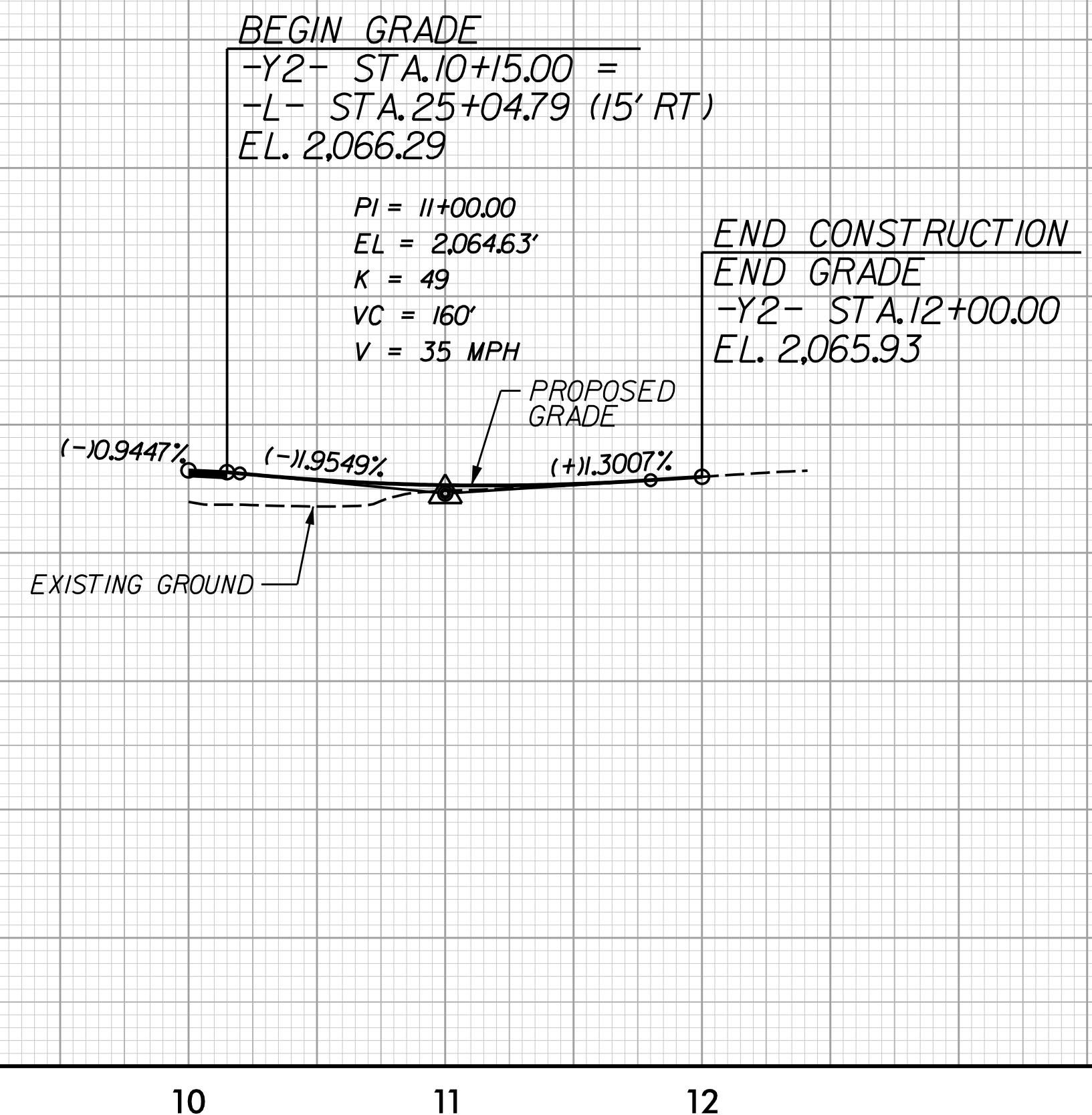
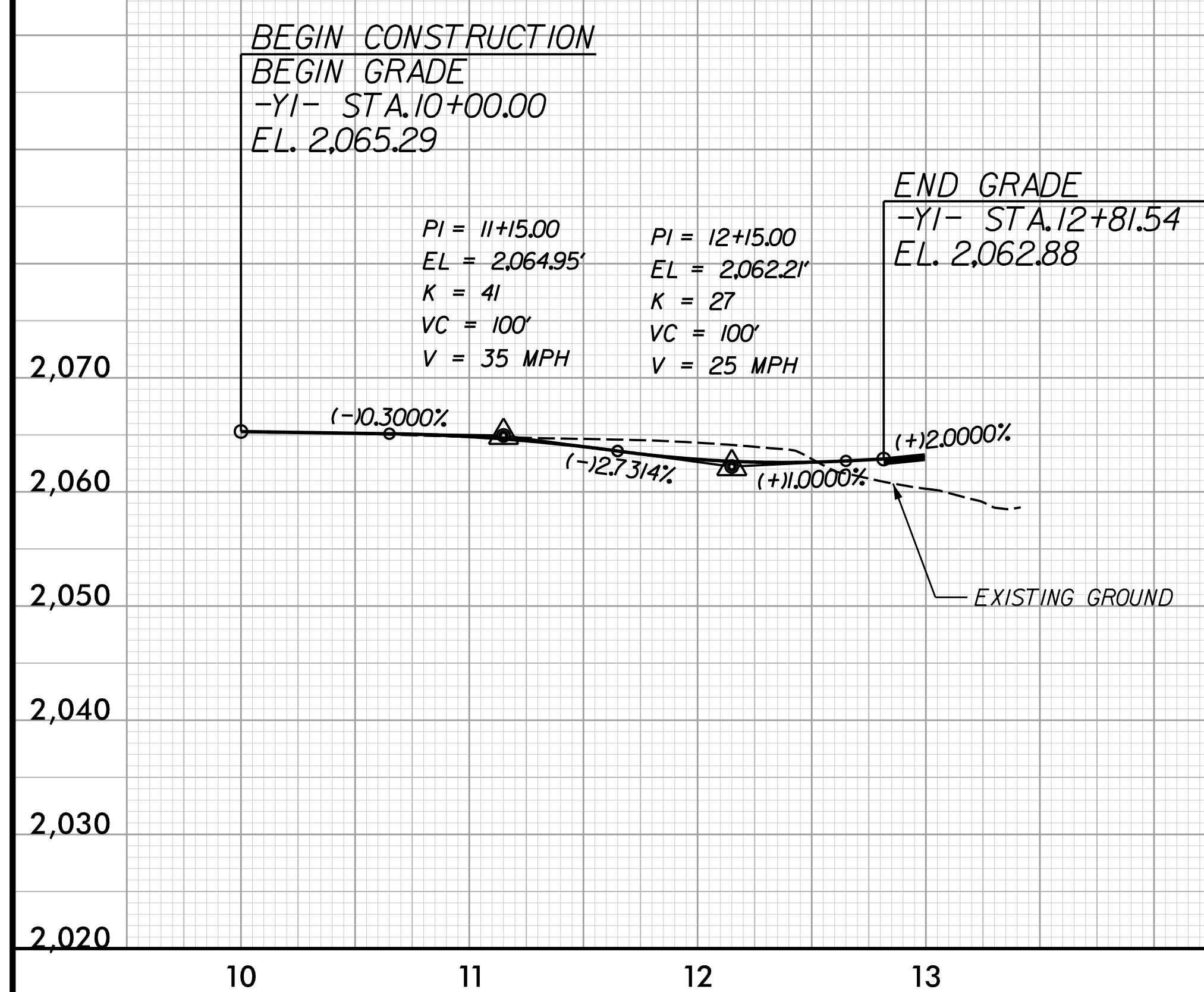

PLOT DRIVER: NCDOT_color_eng_50.plt
 USER: TBEDEENBA
 FILE: NCDOT\NCDOT_Western_Div_0n-Cell_M_NCDOT-17BP.14.R.212_Culwhsee6.0_CAD_BIM\6.2_Work_In_Progress\17BP.14.R.212_Roadway\Proj\490159.RDY_PSH04.dgn
 PENTABLE: NCDOT_pshp.plt.tdi
 TIME: 2:17:58 PM
 DATE: 10/17/2021

REVISIONS