

PROJECT REFERENCE NO.	SHEET NO.
U-2729	EC-12/CONST.-6
RW SHEET NO.	
ROADWAY DESIGN ENGINEER	HYDRAULICS ENGINEER

SEE SHEET 2B-4 FOR INTERSECTION DETAILS

-L- SEE PROFILE SHEET 11
 -Y6A- SEE PROFILE SHEET 15
 -Y6B- SEE PROFILE SHEET 15

MATCHLINE SEE SHEET 7
 -Y6A- STA. 16+00.00

MATCHLINE SEE SHEET 5
 -L- STA. 38+50.00

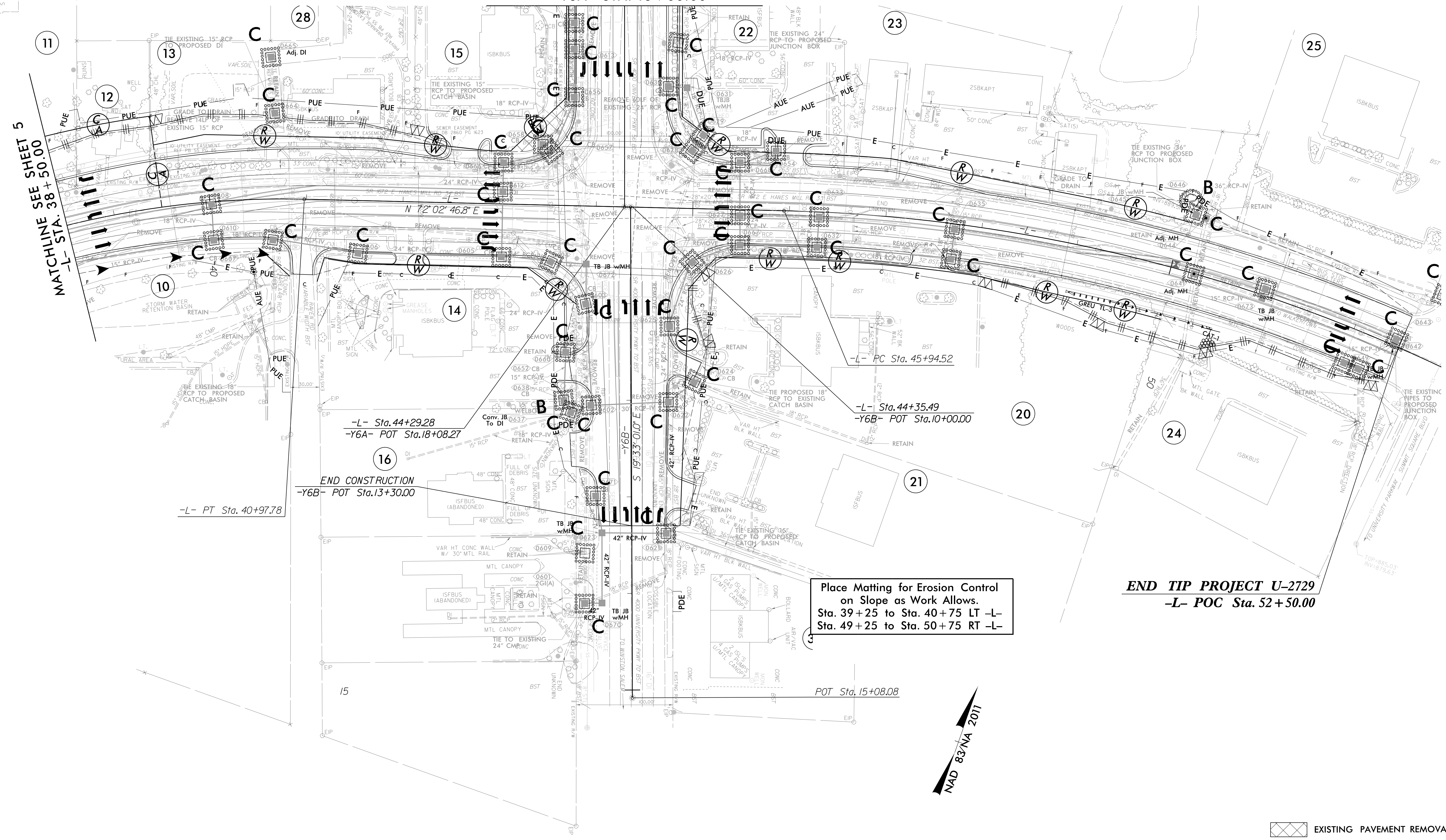

-L- Sta. 44+29.28
 -Y6A- POT Sta. 18+08.27

-L- PT Sta. 40+97.78

END CONSTRUCTION
 -Y6B- POT Sta. 13+30.00

-L- PC Sta. 45+94.52

-L- Sta. 44+35.49
 -Y6B- POT Sta. 10+00.00

Place Matting for Erosion Control
 on Slope as Work Allows.
 Sta. 39+25 to Sta. 40+75 LT -L-
 Sta. 49+25 to Sta. 50+75 RT -L-

END TIP PROJECT U-2729
 -L- POC Sta. 52+50.00

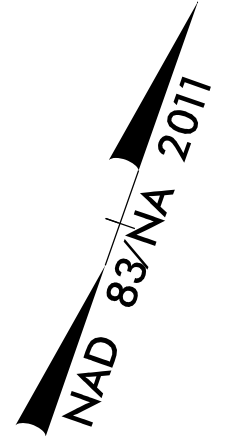

EXISTING PAVEMENT REMOVAL