

PROJECT REFERENCE NO.	SHEET NO.
U-2729	EC-10/CONST.-4
RW SHEET NO.	
ROADWAY DESIGN ENGINEER	HYDRAULICS ENGINEER

SEE SHEET 2B-1 FOR INTERSECTION DETAILS
SEE SHEET 2B-5 THRU 2B-8 FOR ISLAND DETAILS

-L- SEE PROFILE SHEET 10
-YIA- SEE PROFILE SHEET 11
-YIB- SEE PROFILE SHEET 11
-RDBT- SEE PROFILE SHEET 15

Place Matting for Erosion Control on Slope as Work Allows.
Sta. 17+75 to Sta. 19+50 LT -L-
Sta. 24+50 to Sta. 25+50 LT -L-
Sta. 11+75 to Sta. 12+25 RT -YIA-
Sta. 12+75 to Sta. 13+25 RT -RDBT-

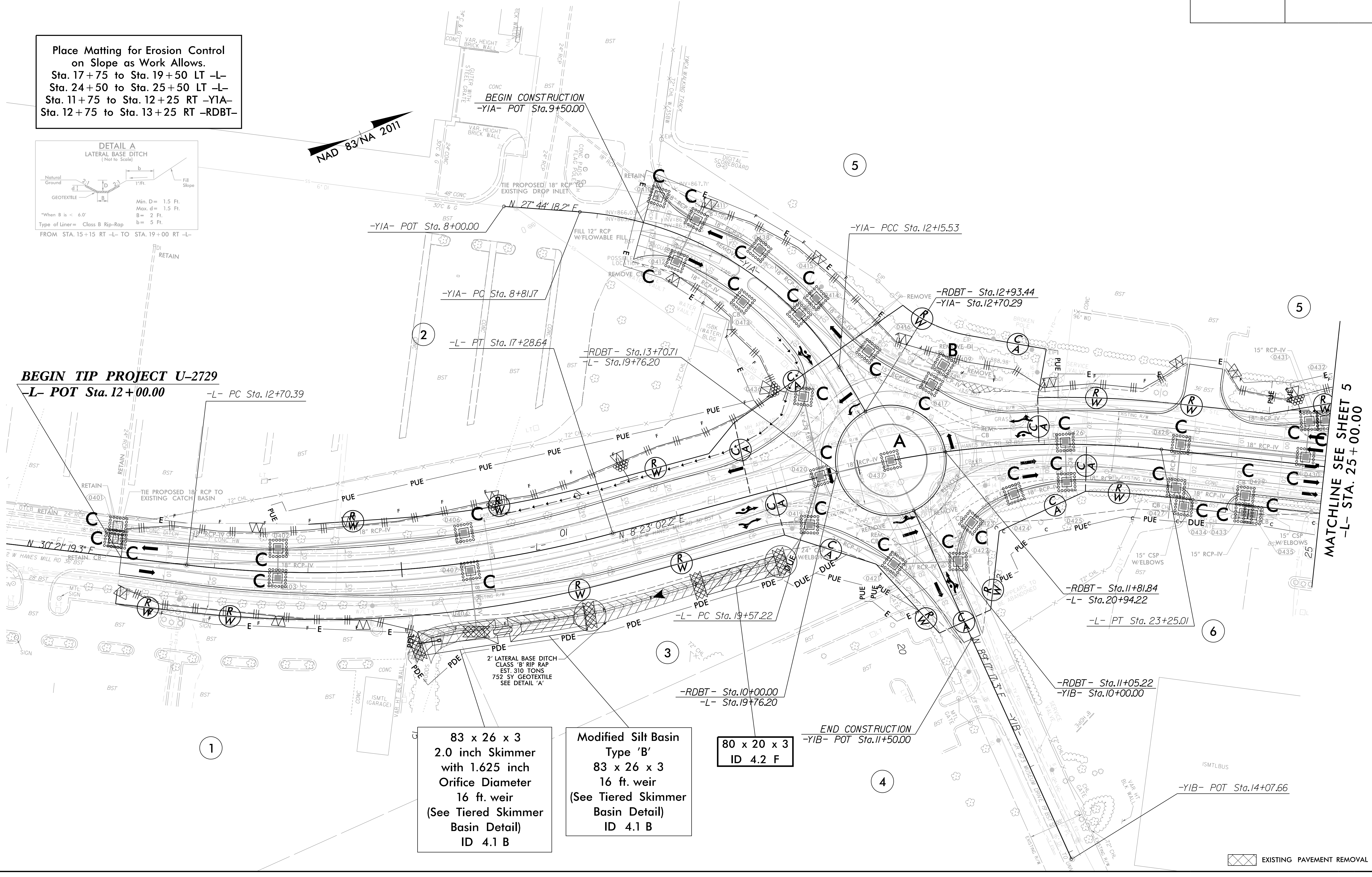
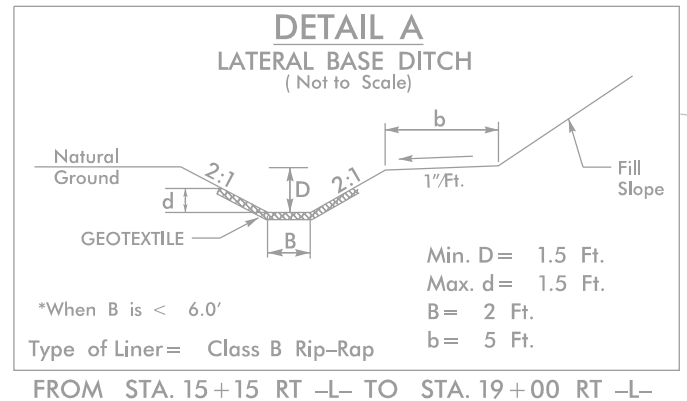

83 x 26 x 3
2.0 inch Skimmer
with 1.625 inch
Orifice Diameter
16 ft. weir
(See Tiered Skimmer
Basin Detail)
ID 4.1 B

Modified Silt Basin
Type 'B'
83 x 26 x 3
16 ft. weir
(See Tiered Skimmer
Basin Detail)
ID 4.1 B

80 x 20 x 3
ID 4.2 F

8/17/99

3/20/2023 - C_PSH-F.dgn
4/1/2023 - PNT

EXISTING PAVEMENT REMOVAL