

PROJECT REFERENCE NO.	SHEET NO.
U-2729	EC-7/CONST.-7
RW SHEET NO.	
ROADWAY DESIGN ENGINEER	HYDRAULICS ENGINEER

-Y6A- SEE PROFILE SHEET 15

CLEARING AND GRUBBING
EROSION CONTROL FOR
CONSTRUCTION SHEET 7

NOTE:
PERIMETER EROSION CONTROL MEASURES SHALL BE
INSTALLED DURING CLEARING AND GRUBBING PHASE.

NOTE:
USE FABRIC INSERT INLET PROTECTION DEVICES AS DIRECTED
IN LIEU OF ROCK INLET SEDIMENT TRAP TYPE C TO AVOID
IMPOUNDING RUNOFF ON ROADWAYS OPEN TO THE PUBLIC.

NAD 83/NA 2011

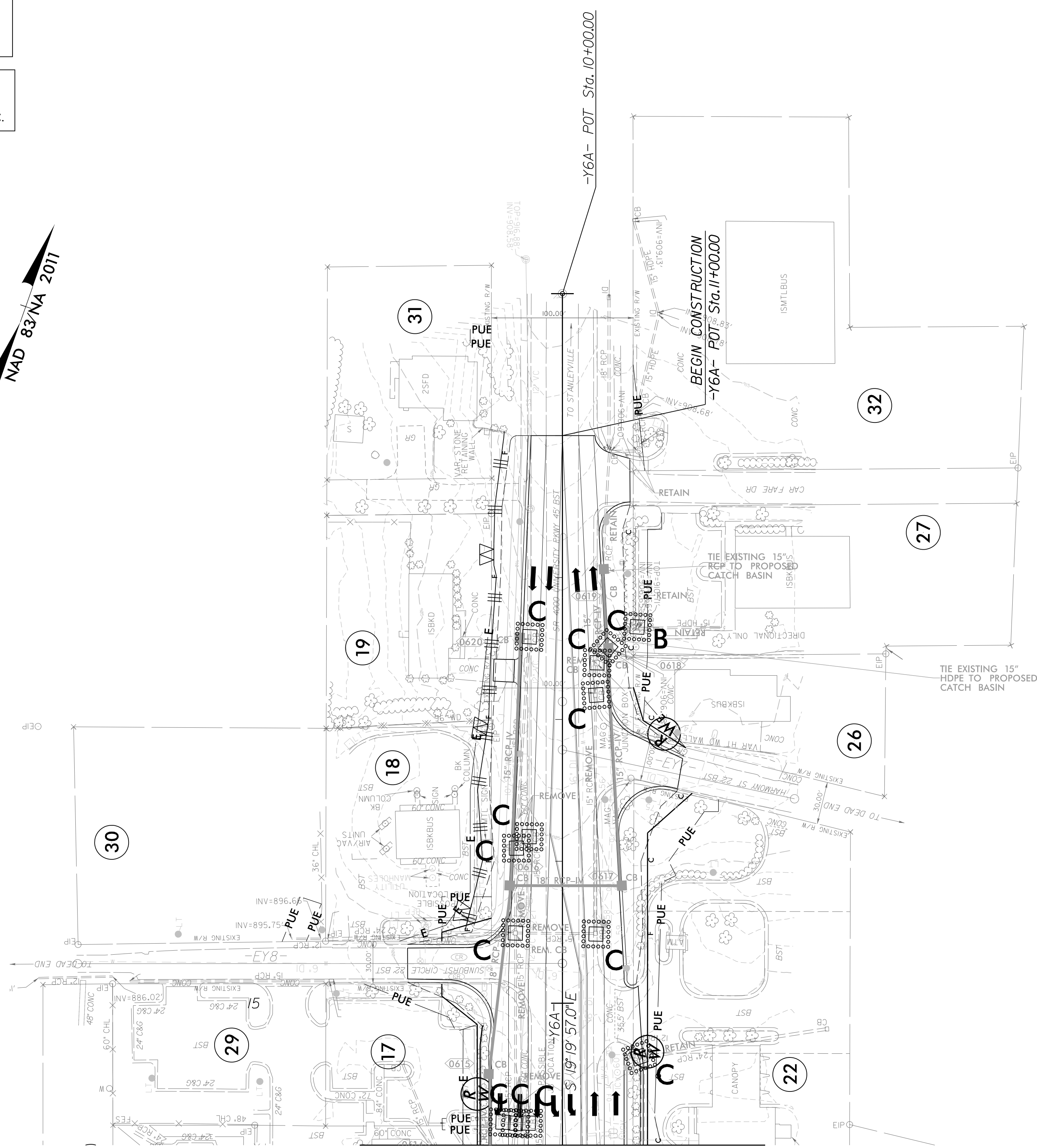

MATCHLINE SEE SHEET 6
-Y6A- STA. 16 + 00.00

EXISTING PAVEMENT REMOVAL

8/17/99

3/15/2023 EC_PSH.CG.dgn
3:08:26 PM