

PLANS PREPARED FOR THE NCDOT BY:  
**M** MOTT MACDONALD I & E, LLC  
 1101 HAYNES STREET, SUITE 101  
 RALEIGH, NC 27604  
**M** MOTT MACDONALD  
 NC LICENSE NO. F-0669

MESSAGES AND LOCATIONS OF CMS's AS DIRECTED BY ENGINEER

A	MESSAGE NO. 1	MESSAGE NO. 2	BEGINNING 7 DAYS PRIOR TO ROAD CLOSURE
	RAMP TO US 52 N	CLOSED STARTING (MONTH) (DAY)	
CHANGEABLE MESSAGE SIGN			
	MESSAGE NO. 1	MESSAGE NO. 2	DURING ROAD CLOSURE
	RAMP TO US 52 N	DETOUR NEXT LEFT	
CHANGEABLE MESSAGE SIGN			
B	MESSAGE NO. 1	MESSAGE NO. 2	DURING ROAD CLOSURE
	RAMP TO US 52 N	DETOUR KEEP STRAIGHT	
CHANGEABLE MESSAGE SIGN			
C	MESSAGE NO. 1	MESSAGE NO. 2	BEGINNING 7 DAYS PRIOR TO ROAD CLOSURE
	EXIT 116 TO HANES MILL RD	CLOSED STARTING (MONTH) (DAY)	
CHANGEABLE MESSAGE SIGN			
	MESSAGE NO. 1	MESSAGE NO. 2	DURING ROAD CLOSURE
	EXIT 116 CLOSED		
CHANGEABLE MESSAGE SIGN			
D	MESSAGE NO. 1	MESSAGE NO. 2	DURING ROAD CLOSURE
	EXIT 116 CLOSED AHEAD	DETOUR EXIT 115A	
CHANGEABLE MESSAGE SIGN			

- 1 R11-2 48" x 30"  
ROAD CLOSED  
W1-6L 48" x 24"  
TYPE III BARRICADE
- 2 R11-2 48" x 30"  
ROAD CLOSED  
M4-10R 48" x 18"  
TYPE III BARRICADE
- 3 END DETOUR M4-8A 24" X 18"
- 4 DETOUR M4-8 24" X 12"  
NORTH M3-1 24" X 12"  
52 M1-4 36" X 36"  
← M6-1 L 21" X 15"
- 5 HANES MILL RD SP-1 30" X 24"  
DETOUR M4-8 24" X 12"  
→ M6-1 21" X 15"
- 6 HANES MILL RD SP-1 30" X 24"  
DETOUR M4-8 24" X 12"  
↗ M6-2 21" X 15"
- 7 DETOUR M4-8 24" X 12"  
NORTH M3-1 24" X 12"  
52 M1-4 36" X 36"  
→ M6-1 21" X 15"

SEE TMP-2E FOR SPECIAL SIGN DESIGN SP-1

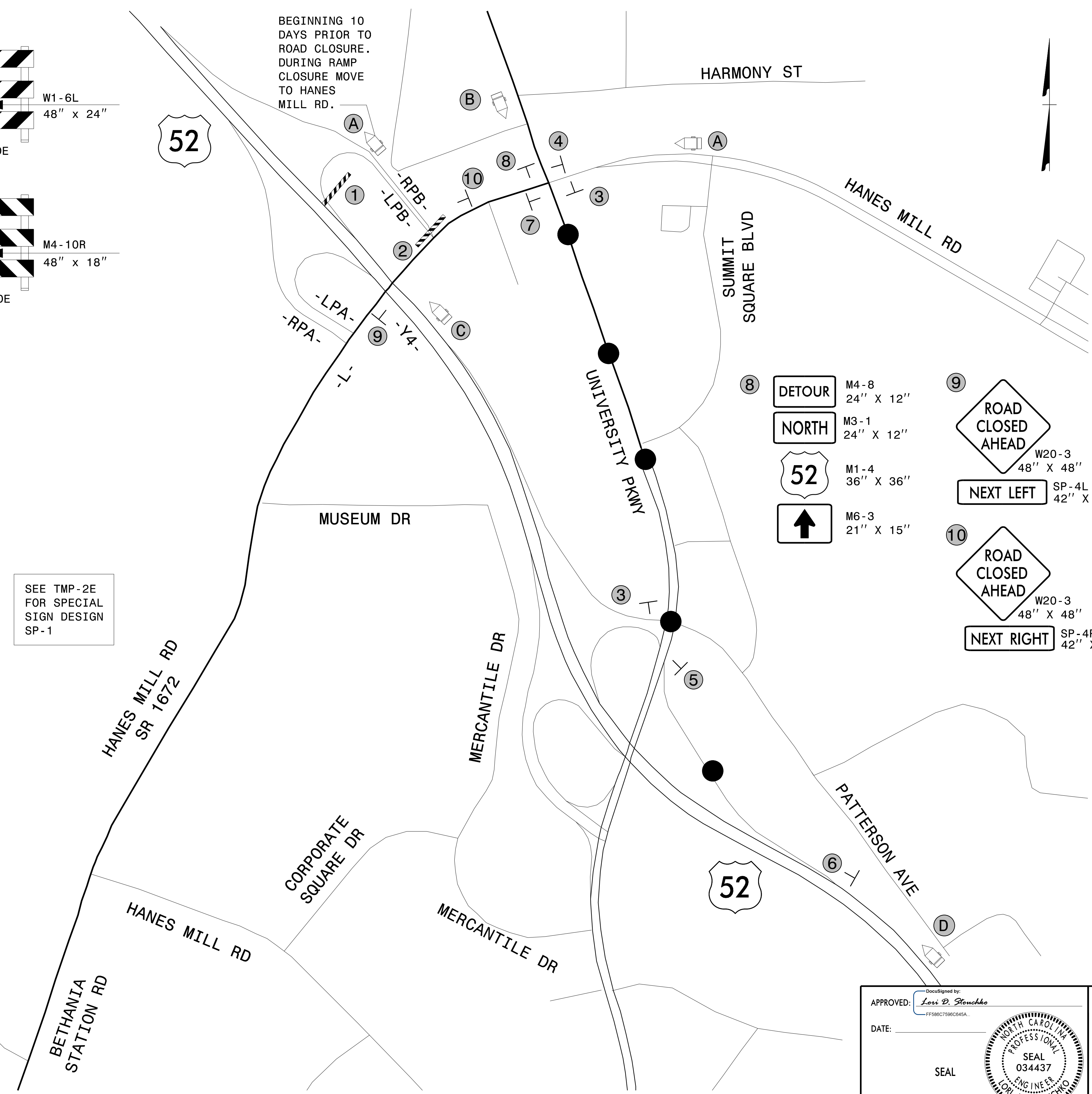

BEGINNING 10 DAYS PRIOR TO ROAD CLOSURE. DURING RAMP CLOSURE MOVE TO HANES MILL RD.

3/14/2023 G:\308350\_DDC\2\ARC-U-2729\TrafficControl\Top\200\_040\_U-2729\_TC\_TMP\_02C\_US\_52\_NB\_Ramp\_Closure.dgn User:ST086227

APPROVED: <i>Lori D. Stouchko</i> DATE: _____ SEAL			<b>TEMPORARY TRAFFIC CONTROL          DETOUR          US 52 NB RAMP CLOSURE</b>
<b>DOCUMENT NOT CONSIDERED FINAL          UNLESS ALL SIGNATURES COMPLETED</b>			