

8/17/99  
 8:40:39 AM  
 R:\Roadway\Proj\U2729\_rdy\_dsn\_mt\_det.dgn  
 C:\Users\rdy\Documents\U2729\_rdy\_dsn\_mt\_det.dgn

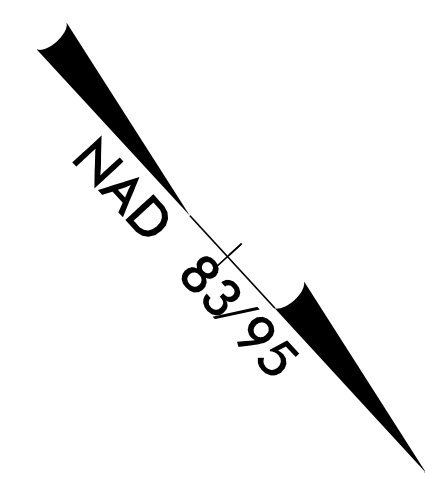

PROJECT REFERENCE NO. U-2729	SHEET NO. 2B-2
RW SHEET NO.	
ROADWAY DESIGN ENGINEER	
<p><b>DOCUMENT NOT CONSIDERED FINAL UNLESS ALL SIGNATURES COMPLETED</b></p>	
Prepared in the Office of:	<p><b>M</b> Mott MacDonald I &amp; E, LLC          7621 Purfoy Road, Suite 115          Fuquay-Varina, NC 27526          www.mottmac.com</p> <p><b>M</b> MOTT MACDONALD          NC License No. F-0669</p>

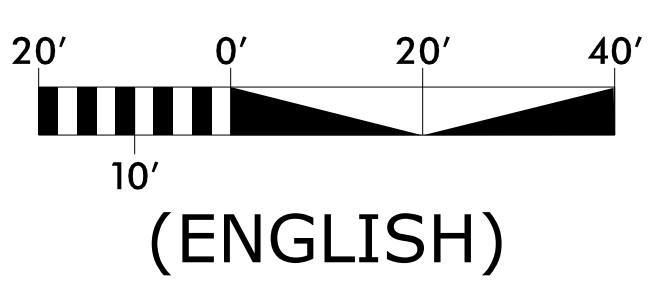
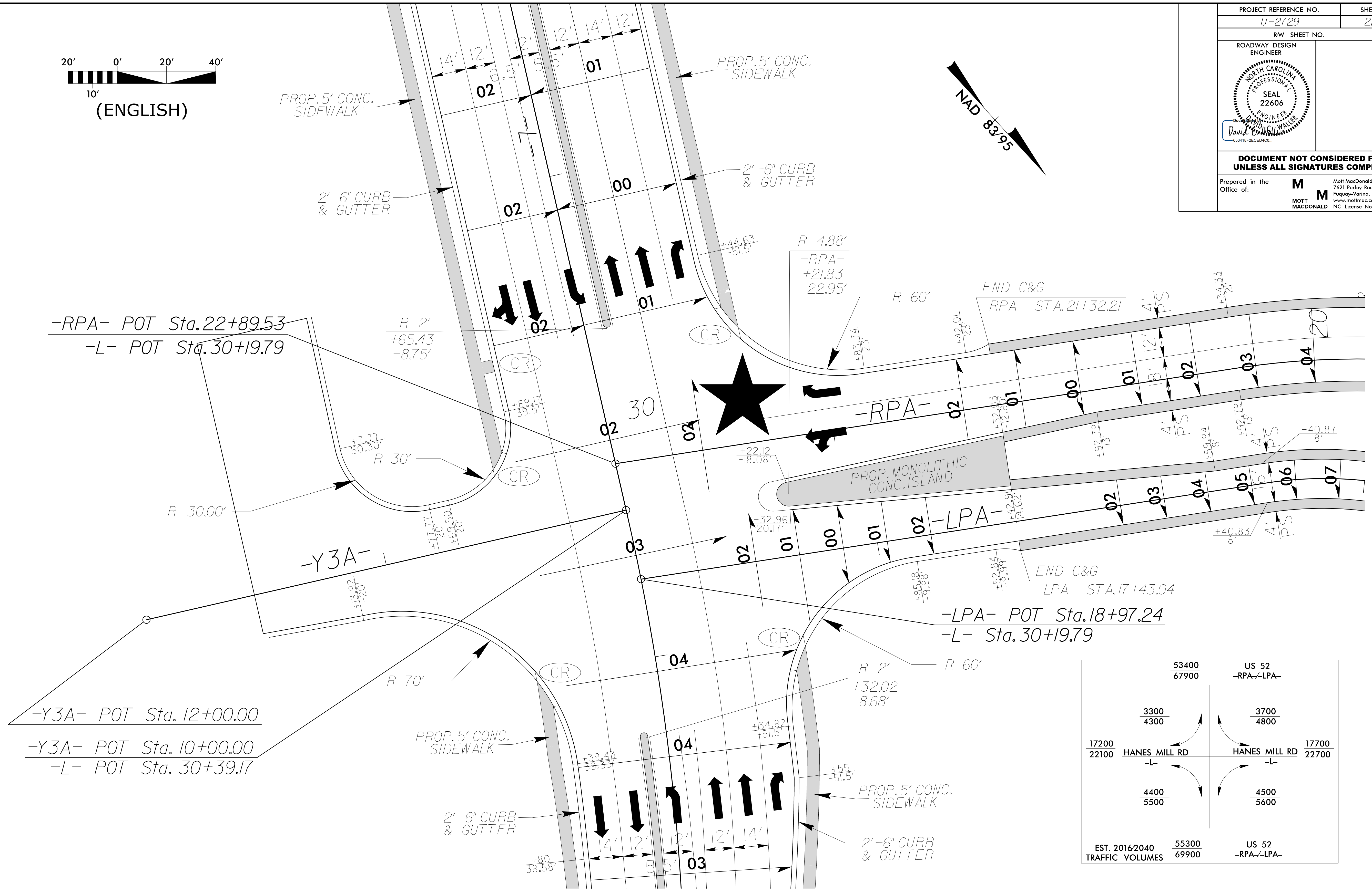

	53400 67900	US 52 -RPA-/LPA-	
	3300 4300	3700 4800	
17200 22100	HANES MILL RD -L-	HANES MILL RD -L-	17700 22700
	4400 5500	4500 5600	
EST. 20162040 TRAFFIC VOLUMES	55300 69900	US 52 -RPA-/LPA-	

# -RPA/LPA- INTERSECTION DETAIL

FOR PLAN, SEE SHEET NO. 5