

PHASING DIAGRAM

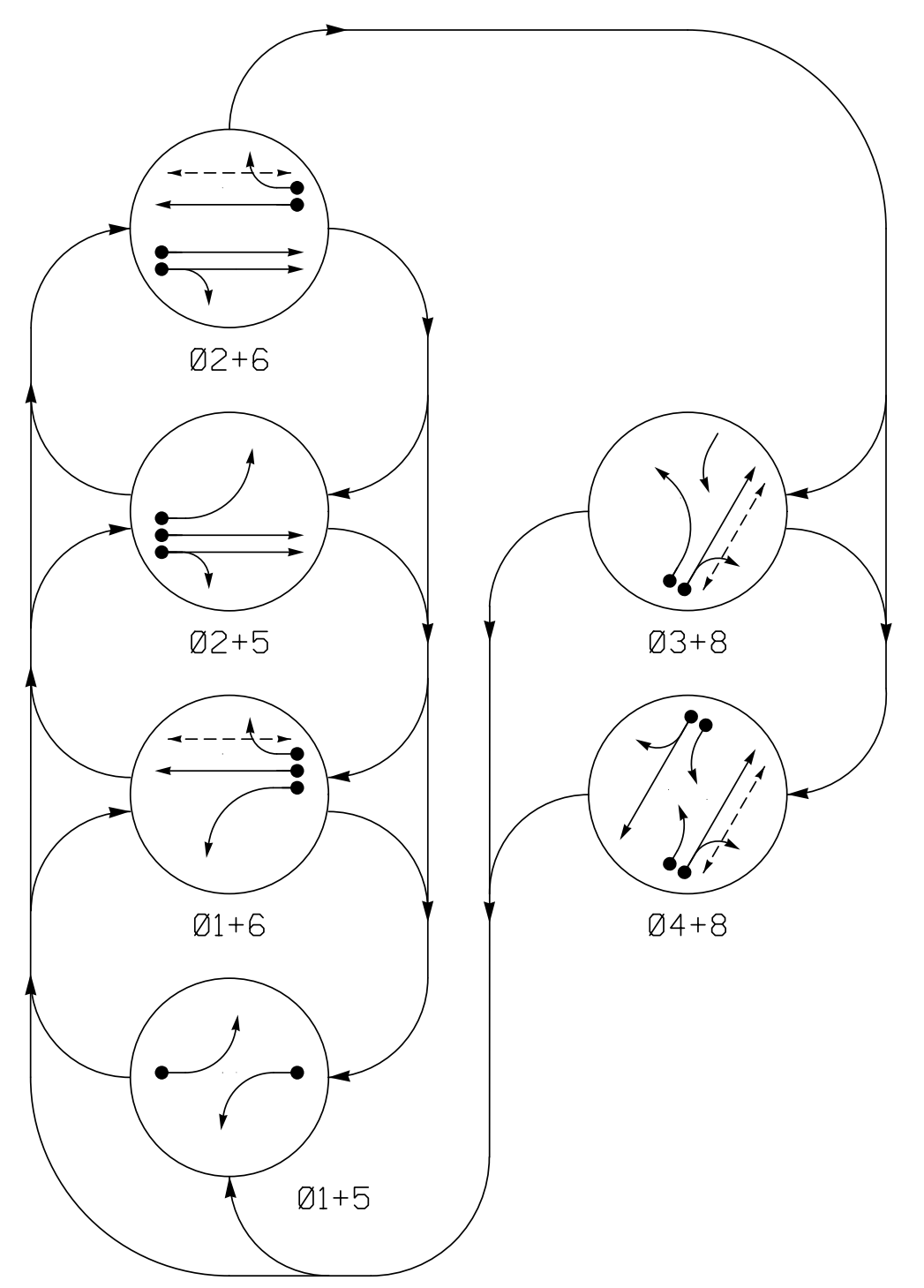

PHASING DIAGRAM DETECTION LEGEND

- DETECTED MOVEMENT
- ← UNDETECTED MOVEMENT (OVERLAP)
- UNSIGNALIZED MOVEMENT
- ⚡ PEDESTRIAN MOVEMENT

TABLE OF OPERATION

SIGNAL FACE	PHASE							
	Ø 1+5	Ø 1+6	Ø 2+5	Ø 2+6	Ø 3+8	Ø 4+8	FLASHERS	DRK
11	←	←	←	←	←	←	←	←
21,22	R	R	G	G	R	R	Y	
31	←	←	←	←	←	←	←	←
41	←	←	←	←	←	←	←	←
42,43	R	R	R	R	R	G	R	
51	←	←	←	←	←	←	←	←
61,62	R	G	R	G	R	R	Y	
81,82	R	R	R	R	G	G	R	
P61, P62	DW	W	DW	W	DW	DRK		
P81, P82	DW	DW	DW	DW	W	W	DRK	

SIGNAL FACE I.D.

All Heads L.E.D.

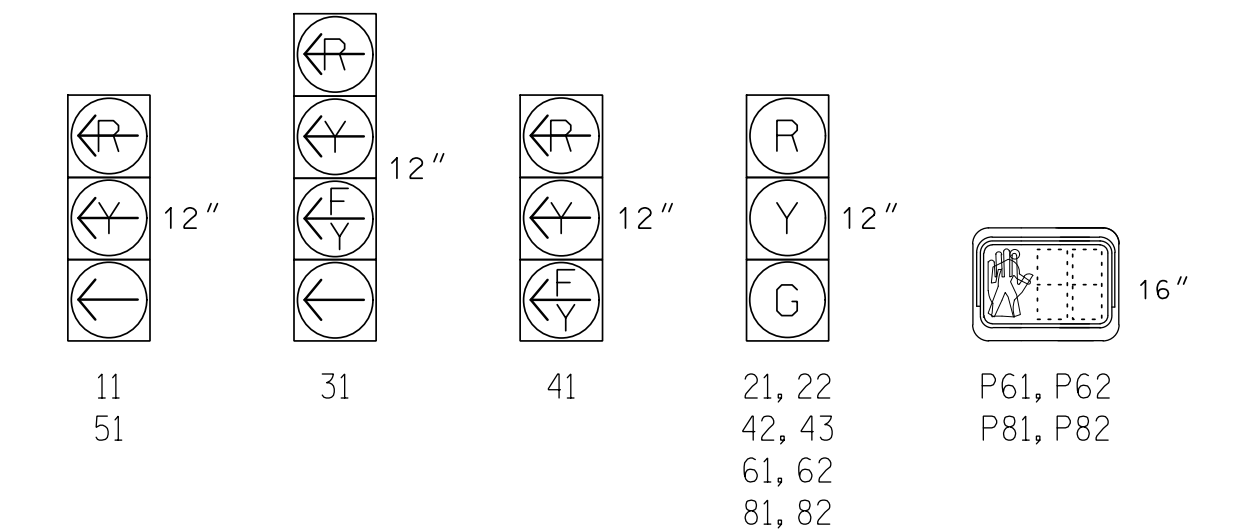

OASIS 2070 LOOP & DETECTOR INSTALLATION CHART

LOOP	SIZE (FT)	DISTANCE FROM STOPBAR (FT)	TURNS	NEW LOOP	DETECTOR PROGRAMMING					SYSTEM LOOP	NEW CARD
					PHASE	CALLING	EXTENSION	FULL TIME DELAY	STRETCH TIME		
1A	6X40	0	2-4-2	-	1	Y	Y	-	-	-	-
2A	6X6	275	EXIST	-	2	Y	Y	-	-	-	-
3A	6X40	0	2-4-2	Y	3	Y	Y	-	-	15	-
4A	6X40	0	2-4-2	Y	4	Y	Y	-	-	3	-
4B	6X40	0	2-4-2	Y	4	Y	Y	-	-	10	-
4C	6X15	+5	EXIST	-	DISCONNECT & ABANDON						
5A	6X40	0	2-4-2	Y	5	Y	Y	-	-	-	-
6A	6X6	300	EXIST	-	6	Y	Y	-	-	-	-
8A	6X6	300	4	Y	8	-	Y	-	-	-	-
8B	6X40	0	2-4-2	Y	8	Y	Y	Y	2.0	5	-
8C	6X15	+5	3	Y	8	Y	Y	-	-	10	-

6 Phase Fully Actuated Isolated

NOTES

1. Refer to "Roadway Standard Drawings NCDOT" dated January 2018 and "Standard Specifications for Roads and Structures" dated January 2018.
2. Do not program signal for late night flashing operation unless otherwise directed by the Engineer.
3. Disconnect and abandon existing loop 4C.
4. Phase 1 and/or phase 5 may be lagged.
5. Phase 3 may be lagged.
6. Reposition existing signal heads numbered 31, 81 and 82.
7. Set all detector units to presence mode.
8. Omit "WALK" and flashing "DON'T WALK" with no pedestrian calls.
9. Program pedestrian heads to countdown the flashing "Don't Walk" time only.
10. Refer to the Pavement Marking and Signing Plans for details on striping, stop bars, crosswalks and any other proposed pavement markings.

OASIS 2070 TIMING CHART

FEATURE	PHASE							
	1	2	3	4	5	6	8	
Min Green 1 *	7	12	7	7	7	12	7	
Extension 1 *	2.0	6.0	2.0	3.0	2.0	6.0	6.0	
Max Green 1 *	20	80	20	30	15	80	30	
Yellow Clearance	3.0	4.6	3.0	4.7	3.0	4.5	4.7	
Red Clearance	3.3	1.9	2.8	2.1	3.7	1.3	2.1	
Red Revert	2.0	2.0	2.0	2.0	2.0	2.0	2.0	
Walk 1 *	-	-	-	-	-	7	7	
Don't Walk 1	-	-	-	-	-	17	22	
Seconds Per Actuation *	-	1.8	-	-	-	2.5	-	
Max Variable Initial *	-	34	-	-	-	34	-	
Time Before Reduction *	-	15	-	-	-	15	10	
Time To Reduce *	-	30	-	-	-	30	30	
Minimum Gap	-	3.0	-	-	-	3.0	3.0	
Recall Mode	-	MIN RECALL	-	-	-	MIN RECALL	-	
Vehicle Call Memory	-	YELLOW	-	-	-	YELLOW	-	
Dual Entry	-	-	-	-	-	-	-	
Simultaneous Gap	ON	ON	ON	ON	ON	ON	ON	

* These values may be field adjusted. Do not adjust Min Green and Extension times for phases 2 and 6 lower than what is shown. Min Green for all other phases should not be lower than 4 seconds.

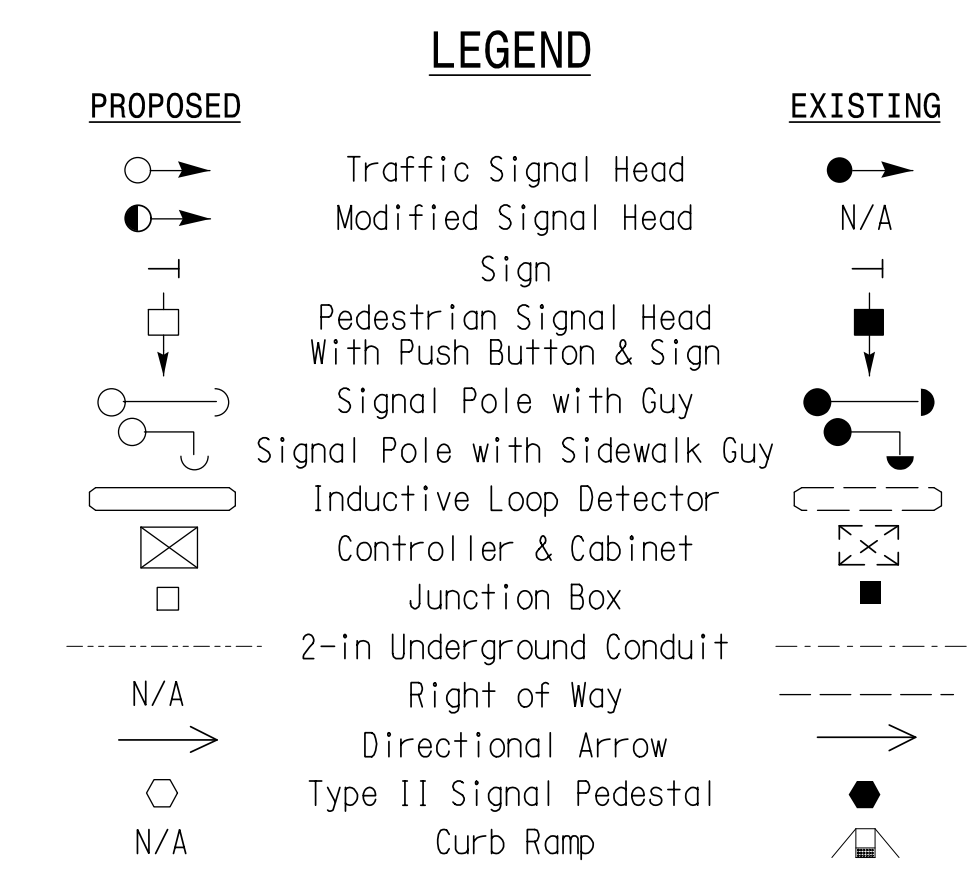
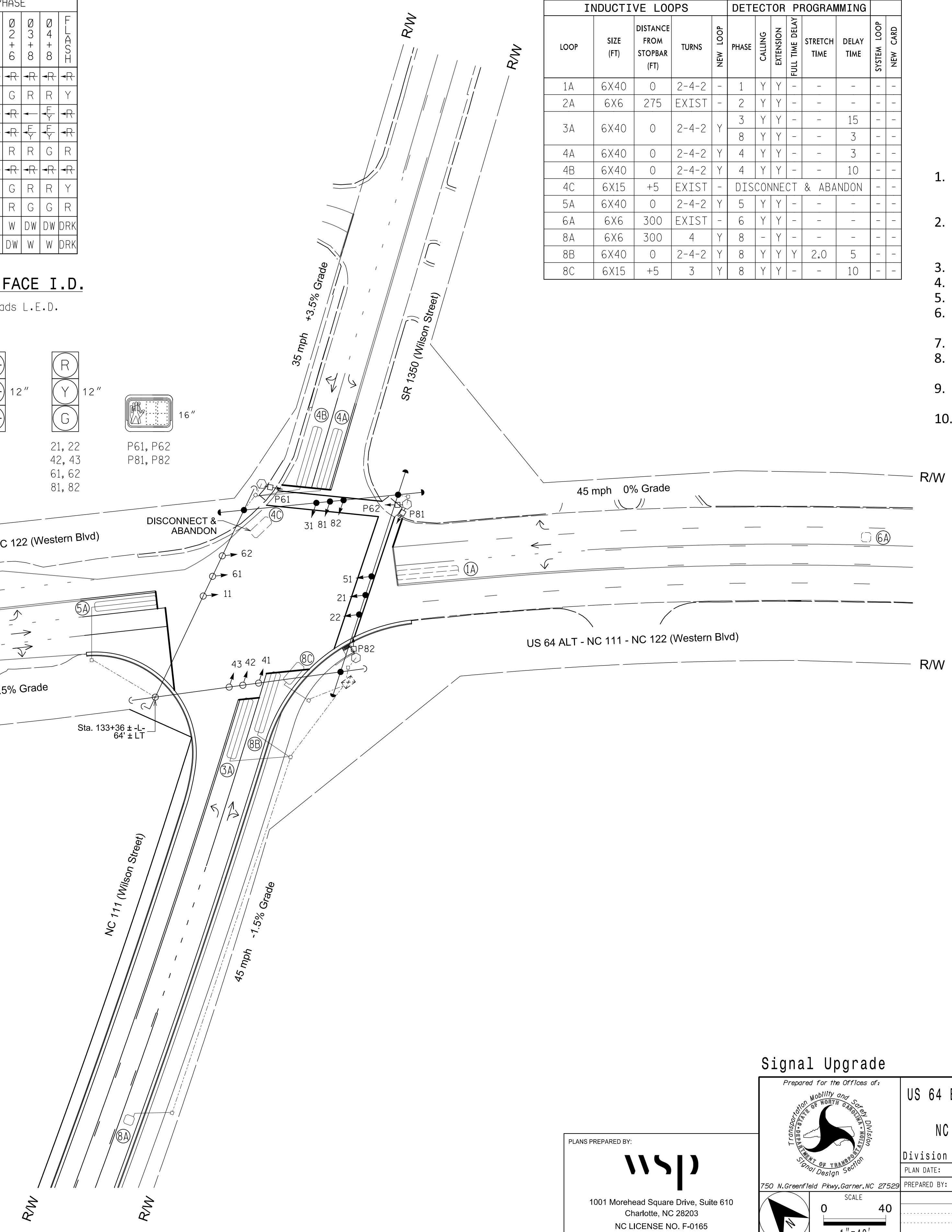

Signal Upgrade

PLANS PREPARED BY:

1001 Morehead Square Drive, Suite 610
Charlotte, NC 28203
NC LICENSE NO. F-0165

Prepared For the Offices of:

750 N. Greenfield Pkwy, Garner, NC 27529

US 64 Bypass-NC 111-122 (Western Blvd)
at
NC 111/SR 1350 (Wilson Street)

Division 4 Edgemcombe County Tarboro

PLAN DATE: June 2022 REVIEWED BY: D. Moss

PREPARED BY: K. Dixon REVIEWED BY:

REVISIONS	INIT.	DATE

DOCUMENT NOT CONSIDERED FINAL UNLESS ALL SIGNATURES COMPLETED

SEAL

Katelyn P. Dixon 03/29/23

SIG. INVENTORY NO. 04-0087

2/29/2023
 #WSP001000:FB01:Job#188771-06_NCDOT_NC_111W-424WTT:off:ic:KSI:gnal:K0asi:gn:Sheet#040087...:sig:dsn:dat:6-dgn
 Purmel,IK