

PROJECT REFERENCE NO.		SHEET NO.	
U-6229		EC-14/CONST.06	
RW SHEET NO.			
ROADWAY DESIGN ENGINEER		HYDRAULICS ENGINEER	

INSTALL FABRIC INSERT INLET PROTECTION DEVICE IN LIEU OF ROCK INLET SEDIMENT TRAP TYPE 'C' AS DIRECTED TO AVOID PONDING OF RUNOFF IN ROADWAY OPEN TO PUBLIC TRAFFIC

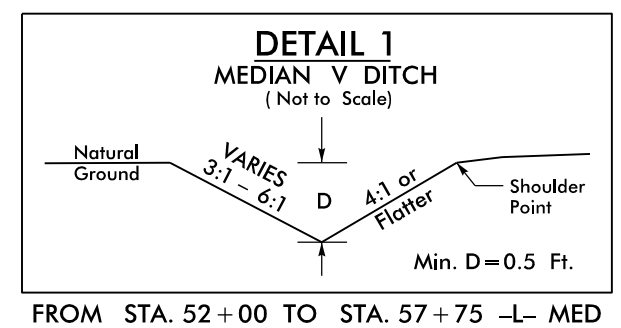
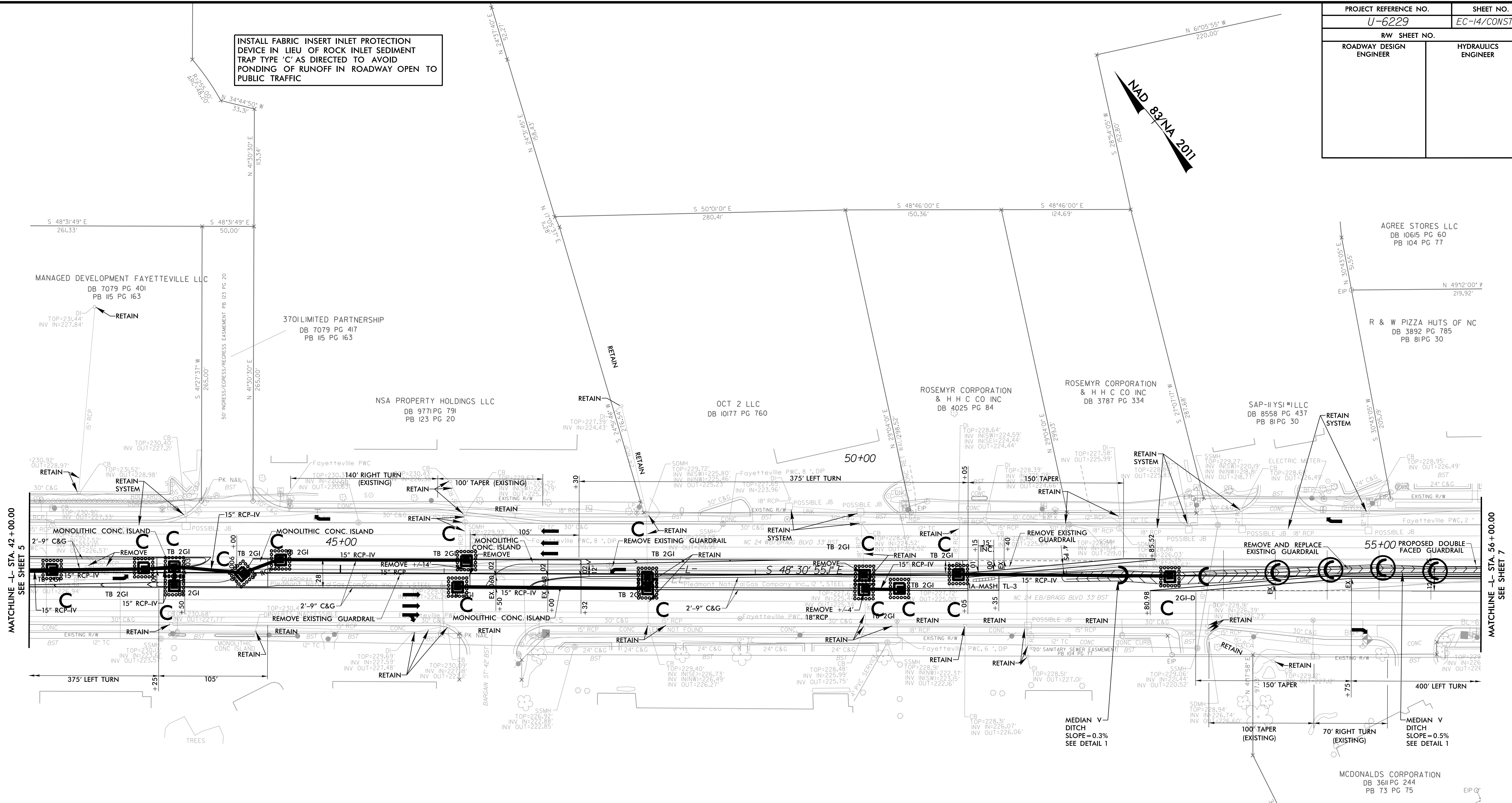

.....  
 BM3 ELEVATION - 229.93  
 N 483623 E 201773  
 BL STATION 61+68.00 4 RIGHT  
 PK NAIL IN CONC CURB  
 .....

**■** MILLING AND RESURFACING LIMITS

FOR CONCRETE ISLAND DETAIL SEE SHEET 2B-1

8.17.17/99  
 11:29:33 AM  
 C:\Users\jacob.finnell\OneDrive\Documents\Environmental\Design\PSH\U6229\_REU\_EC\_PSH06.F.ina1.dgn  
 COB:DEFINER