

PROJECT REFERENCE NO.	SHEET NO.
U-6229	EC-13/CONST.05
RW SHEET NO.	
ROADWAY DESIGN ENGINEER	HYDRAULICS ENGINEER

INSTALL FABRIC INSERT INLET PROTECTION DEVICE IN LIEU OF ROCK INLET SEDIMENT TRAP TYPE 'C' AS DIRECTED TO AVOID PONDING OF RUNOFF IN ROADWAY OPEN TO PUBLIC TRAFFIC

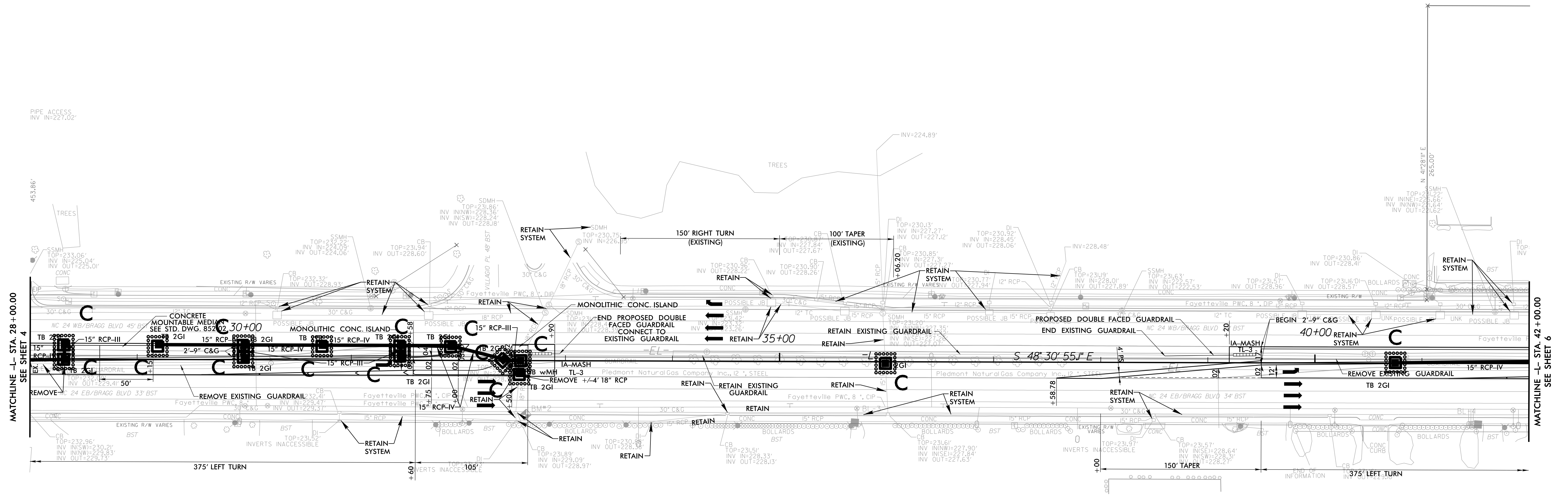
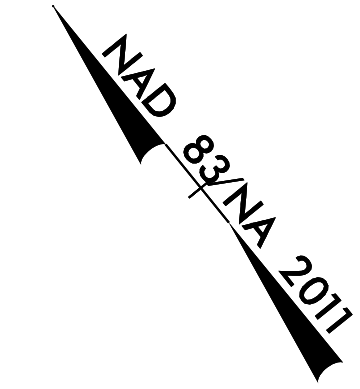

.....
 BM2 ELEVATION = 232.50
 N 485106 E 2016111
 BL STATION 39+41.00 7 LEFT
 PK NAIL IN CONC CURB

MILLING AND RESURFACING LIMITS

FOR CONCRETE ISLAND DETAIL SEE SHEET 2B-1