

PROJECT REFERENCE NO.	SHEET NO.
U-6229	EC-07/CONST.07
RW SHEET NO.	
ROADWAY DESIGN ENGINEER	HYDRAULICS ENGINEER

CLEARING AND GRUBBING  
EROSION CONTROL FOR  
CONSTRUCTION SHEET 7

INSTALL FABRIC INSERT INLET PROTECTION  
DEVICE IN LIEU OF ROCK INLET SEDIMENT  
TRAP TYPE 'C' AS DIRECTED TO AVOID  
PONDING OF RUNOFF IN ROADWAY OPEN TO  
PUBLIC TRAFFIC

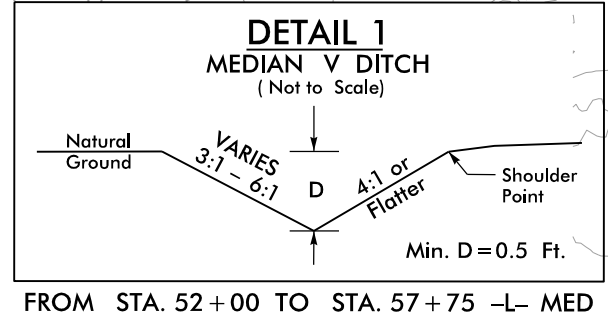

NAD 83 NSRS 2007

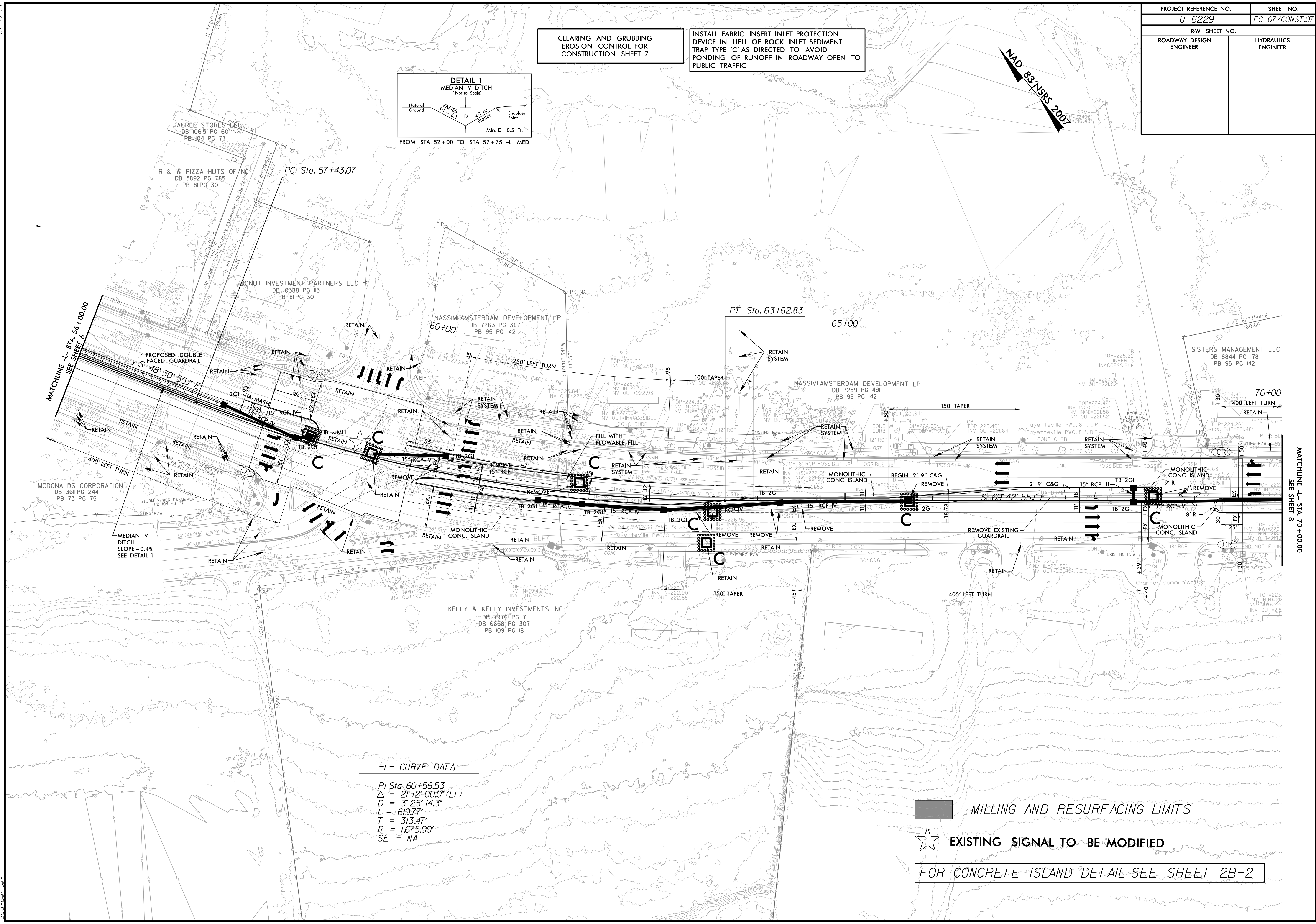

MATCHLINE -L- STA. 56+00.00  
SEE SHEET 6

MATCHLINE -L- STA. 70+00.00  
SEE SHEET 8

-L- CURVE DATA

PI Sta 60+56.53  
 $\Delta = 21^\circ 12' 00.0\"$  (LT)  
 $D = 3' 25' 14.3\"$   
 $L = 619.77'$   
 $T = 313.47'$   
 $R = 1675.00'$   
 $SE = NA$

■ MILLING AND RESURFACING LIMITS  
 ☆ EXISTING SIGNAL TO BE MODIFIED  
 FOR CONCRETE ISLAND DETAIL SEE SHEET 2B-2

8/17/99  
 I:\Projects\Environmental\Design\PSH\U6229\_REU\_EC\_PSH07.CG.dgn  
 11:29:17 AM  
 C:\Users\jg\Documents