

**TOP OF RAIL ELEVATIONS**

STATION -EY1-	ELEVATION
24+00	1082.37
24+20	1082.21
24+40	1082.00
24+60	1081.75
24+80	1081.50
25+00	1081.26
25+20	1080.98
25+40	1080.71
25+60	1080.50
25+80	1080.29
26+00	1080.09
26+20	1079.88
26+40	1079.67
26+60	1079.44
26+80	1079.22
27+00	1079.01

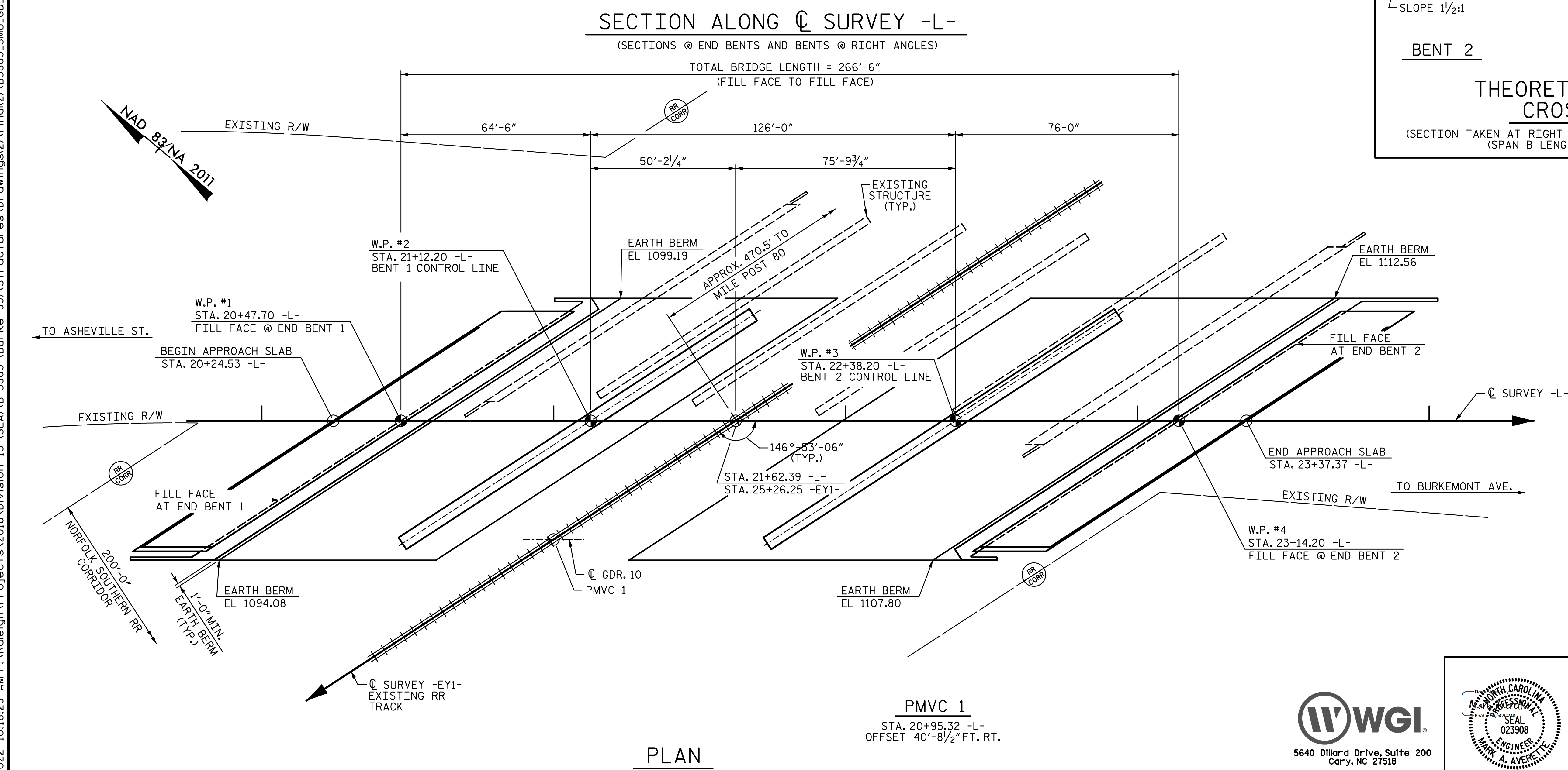

PROJECT NO. B-5869  
BURKE COUNTY  
STATION: 21+62.39 -L-

SHEET 1 OF 4      REPLACES BRIDGE #110099  
MILE POST 80.1

STATE OF NORTH CAROLINA  
DEPARTMENT OF TRANSPORTATION  
RALEIGH

**GENERAL DRAWING**  
FOR BRIDGE ON US64/US 70  
(W. FLEMING DR.) OVER  
NORFOLK SOUTHERN RR  
BETWEEN ASHEVILLE ST.  
AND BURKEMONT AVE.

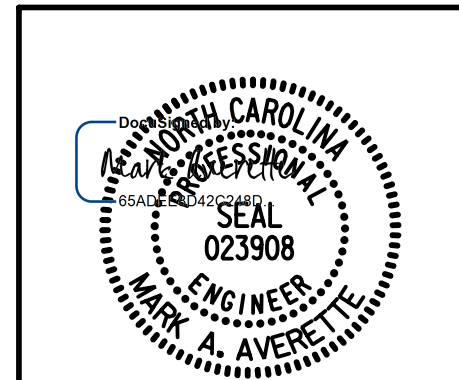

LICENSURE NO. C-4434

DRAWN BY: S.D. COOPER      DATE: 3-2022  
CHECKED BY: M. AVERETTE      DATE: 3-2022  
DESIGN ENGINEER OF RECORD: M. AVERETTE      DATE: 3-2022

REVISIONS				SHEET NO.	
NO.	BY:	DATE:	NO.	BY:	DATE:
1			3		
2			4		

TOTAL SHEETS: 72

DOCUMENT NOT CONSIDERED FINAL  
UNLESS ALL SIGNATURES COMPLETED

11/21/2022 10:18:29 AM P:\Raleigh\Projects\2018\Division 13 (SEA)\B-5869 (Burke 99)\Structures\Drawings\2\Final\2\B5869\_SMU\_CD\_110099(2).dgn