

PROJECT REFERENCE NO.	SHEET NO.
B-5869	EC-08/CONST.04
RW SHEET NO.	
ROADWAY DESIGN ENGINEER	HYDRAULICS ENGINEER

NOTE:
UTILIZE FABRIC INSERT INLET PROTECTION DEVICES IN LIEU OF ROCK INLET SEDIMENT TRAPS, TYPE-C AS DIRECTED TO AVOID IMPOUNDMENT OF RUNOFF IN ROADWAY OPEN TO TRAFFIC.

Place Matting for Erosion Control on Slope as Work Allows.
Sta. 19+55 to Sta. 20+38 -L- RT

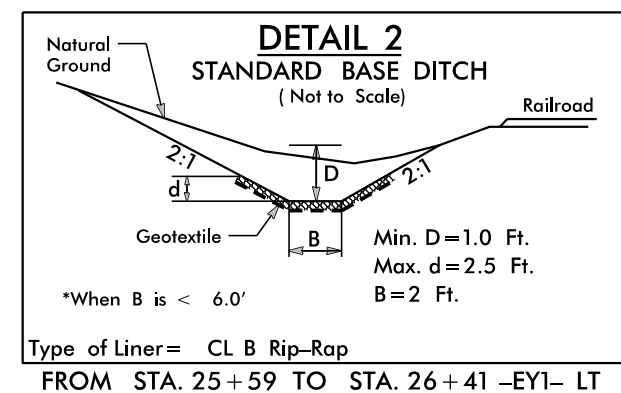
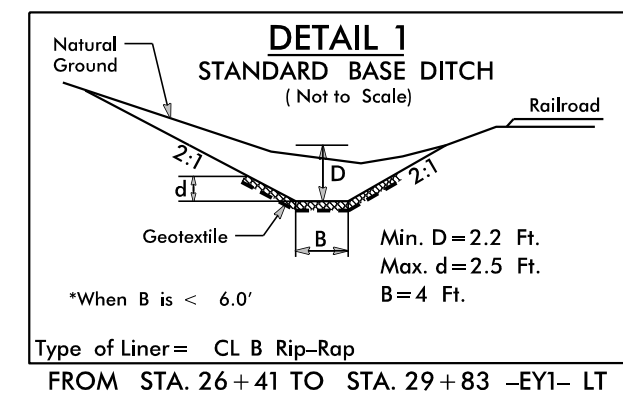

FINAL GRADING
EROSION CONTROL FOR
CONSTRUCTION SHEET 04

REVISIONS: [12/16/2021:MDP]-DR- CONVERTED TO RIGHT IN ONLY. PARCELS 7.9 & 10. EASEMENTS ADDED FOR PROPOSED MARKING AND SIGNING REVISIONS.

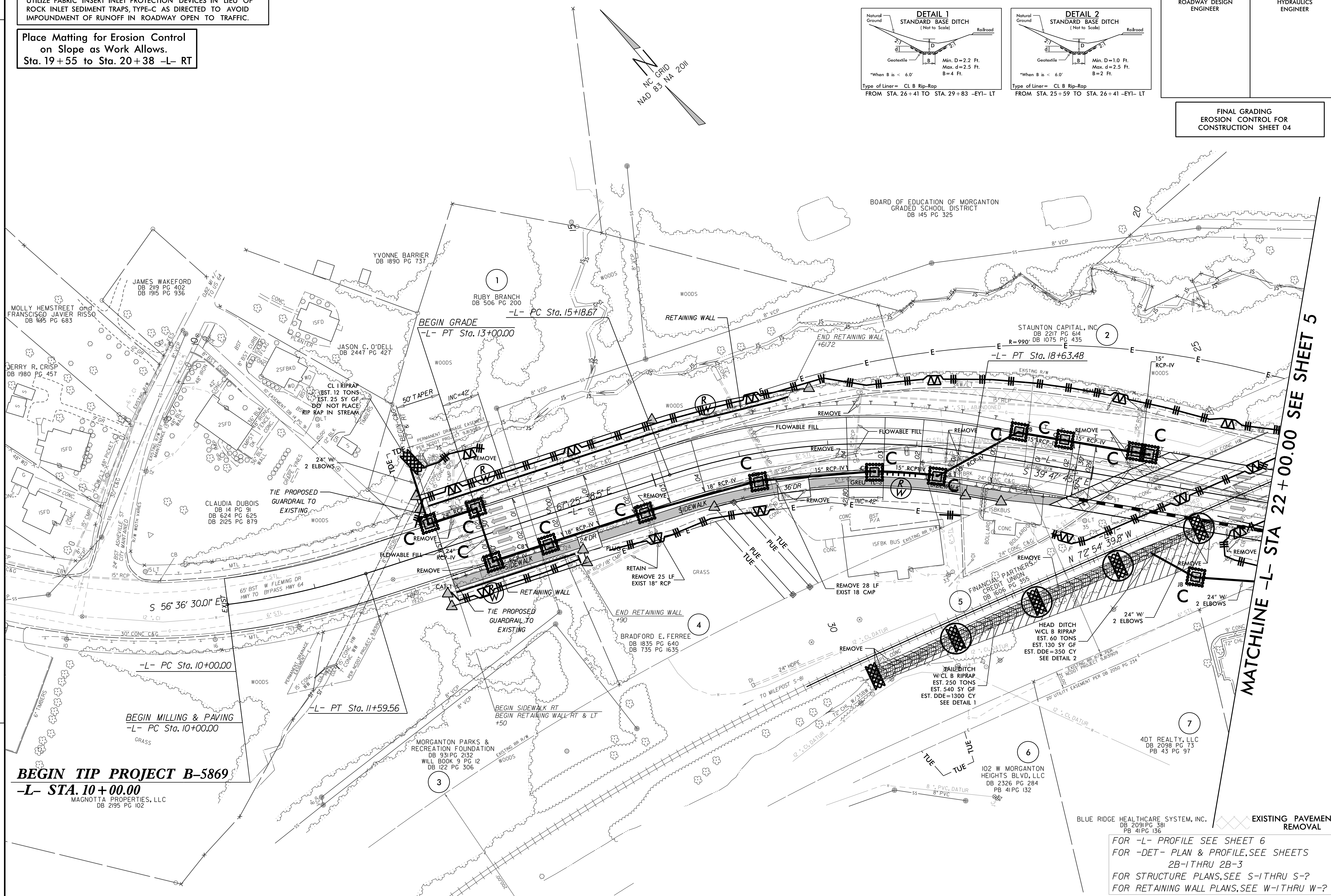

BEGIN TIP PROJECT B-5869
-L- STA. 10+00.00
MAGNOTTA PROPERTIES, LLC
DB 2195 PG 102

FOR -L- PROFILE SEE SHEET 6
FOR -DET- PLAN & PROFILE, SEE SHEETS 2B-1 THRU 2B-3
FOR STRUCTURE PLANS, SEE S-1 THRU S-9
FOR RETAINING WALL PLANS, SEE W-1 THRU W-9