

STATE OF NORTH CAROLINA
DIVISION OF HIGHWAYS

TRANSPORTATION MANAGEMENT PLAN

BRUNSWICK COUNTY

LOCATION: REPLACE BRIDGE 15 OVER CALABASH RIVER ON NC 179B (BEACH DR. SW)

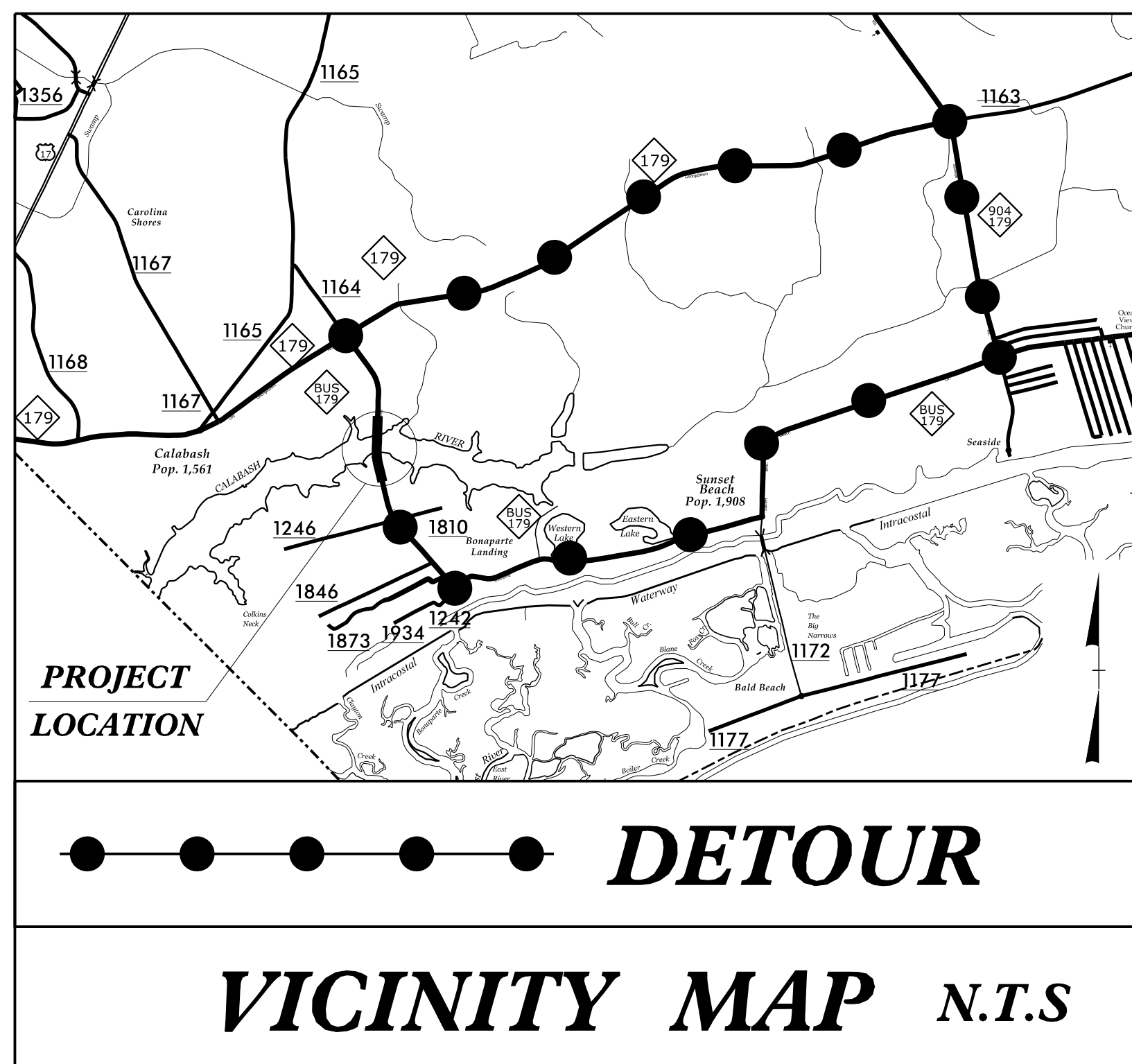
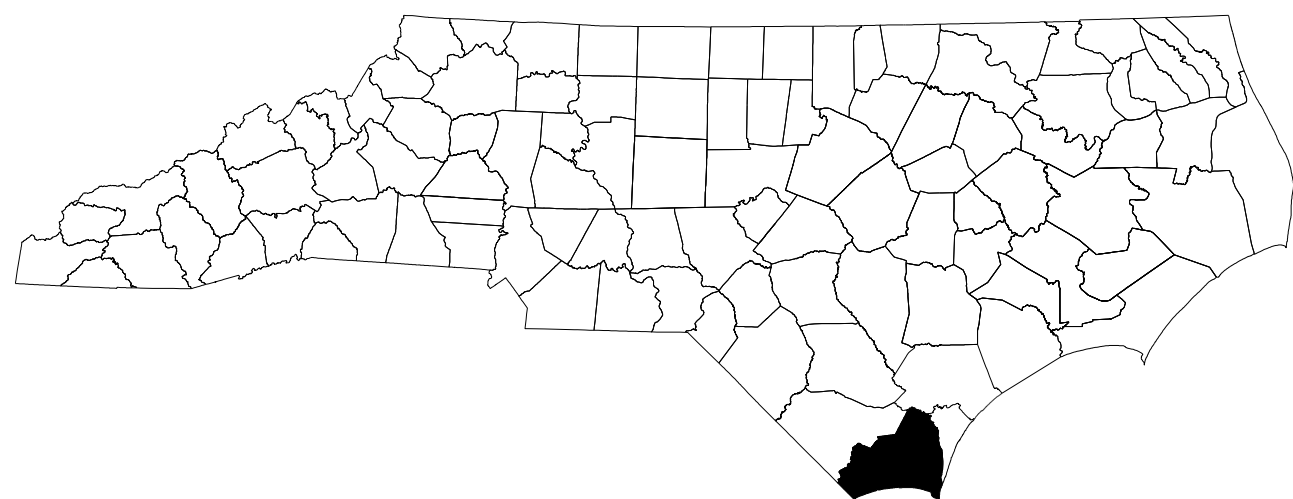

INDEX OF SHEETS

SHEET NO.	TITLE
TMP-1	TITLE SHEET, VICINITY MAP, AND INDEX OF SHEETS
TMP-1A	LIST OF APPLICABLE ROADWAY STANDARD DRAWINGS, AND LEGEND
TMP-1B	TRANSPORTATION OPERATIONS PLANS: (MANAGEMENT STRATEGY, GENERAL NOTES, AND LOCAL NOTES)
TMP-2 THRU 2A	DETOUR SIGN DESIGNS
TMP-3	OFF-SITE DETOUR ROUTE

SHEET NO.
TMP-1

**DOCUMENT NOT CONSIDERED FINAL
UNLESS ALL SIGNATURES COMPLETED**

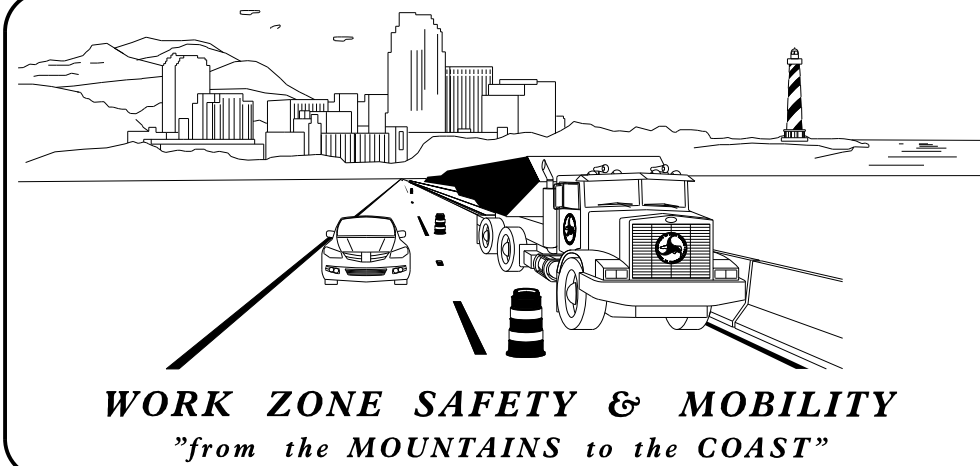

PLANS PREPARED BY:
JARED BOND, P.E.
PROJECT ENGINEER
NIKI AVGERINOS, E.I.
PROJECT DESIGN ENGINEER

NCDOT CONTACTS:
DEREK PIELECH, P.E.
NCDOT PROJECT CONTACT

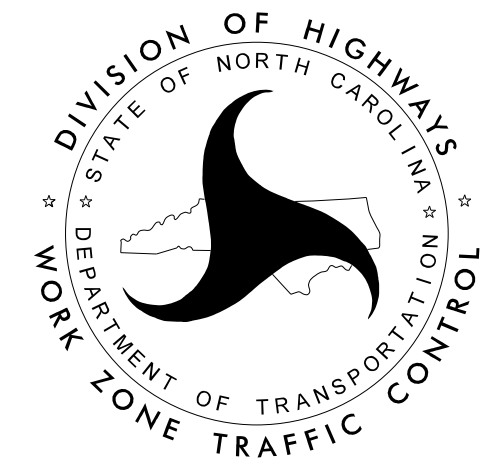

RS&H
NC FIRM LICENSE No: F-0493
8521 SIX FORKS ROAD, SUITE 400
RALEIGH, NC 27615

APPROVED: *Jared M. Bond*
DATE: 3/14/2023
Professional Engineer Seal: JARED M. BOND, No. 040418

TIP PROJECT: BR-0160

2/21/2023
R:\Traffic\TrafficControl\BR0160_tmp_tsh.dgn
User:McLaughr

ROADWAY STANDARD DRAWINGS

THE FOLLOWING ROADWAY STANDARDS AS SHOWN IN "ROADWAY STANDARD DRAWINGS" - N.C. DEPARTMENT OF TRANSPORTATION - RALEIGH, N.C., DATED JANUARY 2018 ARE APPLICABLE TO THIS PROJECT AND BY REFERENCE HEREBY ARE CONSIDERED A PART OF THESE PLANS:

STD. NO.	TITLE
1101.03	TEMPORARY ROAD CLOSURES
1101.11	TRAFFIC CONTROL DESIGN TABLES
1110.01	STATIONARY WORK ZONE SIGNS
1145.01	BARRICADES

LEGEND

GENERAL

- DIRECTION OF TRAFFIC FLOW
- DIRECTION OF PEDESTRIAN TRAFFIC FLOW
- EXIST. PVMT.
- NORTH ARROW
- PROPOSED PVMT.
- TEMP. SHORING (LOCATION PURPOSES ONLY)

SIGNALS

- EXISTING
- PROPOSED
- TEMPORARY

PAVEMENT MARKINGS

- EXISTING LINES
- TEMPORARY LINES

TRAFFIC CONTROL DEVICES

- BARRICADE (TYPE III)
- CONE
- DRUM
- SKINNY DRUM
- TUBULAR MARKER
- TEMPORARY CRASH CUSHION
- FLASHING ARROW BOARD
- FLAGGER
- LAW ENFORCEMENT
- TRUCK MOUNTED ATTENUATOR (TMA)
- CHANGEABLE MESSAGE SIGN

TEMPORARY SIGNING

- PORTABLE SIGN
- STATIONARY SIGN
- STATIONARY OR PORTABLE SIGN

PAVEMENT MARKERS

- CRYSTAL/CRYSTAL
- CRYSTAL/RED
- YELLOW/YELLOW

PAVEMENT MARKING SYMBOLS

- PAVEMENT MARKING SYMBOLS

2/21/2023
R:\Traffic\TrafficControl\BR0160_tmp_la.dgn
User:McLaughlin



APPROVED: DATE: 3/14/2023 		ROADWAY STANDARD DRAWINGS & LEGEND
DOCUMENT NOT CONSIDERED FINAL UNLESS ALL SIGNATURES COMPLETED		

MANAGEMENT STRATEGIES

1. CLOSE NC BUS 179 (BEACH DR) TO TRAFFIC AND DETOUR TRAFFIC OFF-SITE
2. LOCAL ACCESS TO ALL RESIDENCES AND BUISNESSES WILL BE MAINTAINED BETWEEN CLOSURE POINTS AT ALL TIMES DURING CONSTRUCTION

GENERAL NOTES

CHANGES MAY BE REQUIRED WHEN PHYSICAL DIMENSIONS IN THE DETAIL DRAWINGS, STANDARD DETAILS, AND ROADWAY DETAILS ARE NOT ATTAINABLE TO MEET FIELD CONDITIONS OR RESULT IN DUPLICATE OR UNDESIRED OVERLAPPING OF DEVICES. MODIFICATION MAY INCLUDE: MOVING, SUPPLEMENTING, COVERING, OR REMOVAL OF DEVICES AS DIRECTED BY THE ENGINEER.

THE FOLLOWING GENERAL NOTES APPLY AT ALL TIMES FOR THE DURATION OF THE CONSTRUCTION PROJECT EXCEPT WHEN OTHERWISE NOTED IN THE PLAN OR DIRECTED BY THE ENGINEER.

TRAFFIC PATTERN ALTERATIONS

- A) NOTIFY THE ENGINEER THIRTY (30) CALENDAR DAYS PRIOR TO ANY TRAFFIC PATTERN ALTERATIONS.

SIGNNG

- B) INSTALL ADVANCE WORK ZONE WARNING SIGNS WHEN WORK IS WITHIN 40 FT FROM THE EDGE OF TRAVEL LANE AND NO MORE THAN THREE (3) DAYS PRIOR TO THE BEGINNING OF CONSTRUCTION
- C) PROVIDE SIGNING AND DEVICES REQUIRED TO CLOSE THE ROAD ACCORDING TO THE ROADWAY STANDARD DRAWINGS AND TRAFFIC CONTROL PLANS

PROVIDE SIGNING REQUIRED FOR THE OFF-SITE DETOUR ROUTE AS SHOWN IN THE TRAFFIC CONTROL PLANS

- D) COVER OR REMOVE ALL SIGNS AND DEVICES REQUIRED TO CLOSE THE ROAD WHEN ROAD CLOSURE IS NOT IN OPERATION

COVER OR REMOVE ALL SIGNS REQUIRED FOR THE OFF-SITE DETOUR WHEN THE DETOUR IS NOT IN OPERATION

- E) ENSURE ALL NECESSARY SIGNING IS IN PLACE PRIOR TO ALTERING ANY TRAFFIC PATTERN

TRAFFIC CONTROL DEVICES

- F) PLACE TYPE III BARRICADES, WITH "ROAD CLOSED" SIGN R11-2 ATTACHED, OF SUFFICIENT LENGTH TO CLOSE ENTIRE ROADWAY

PHASING

PHASE I STEP 1

USING TMP-3 AND RSD 1101.03 (SHEET 1 OF 9), INSTALL DETOUR ROUTE SIGNING TO CLOSE NC BUS 179 (BEACH DR)

PHASE I STEP 2

AWAY FROM TRAFFIC, COMPLETE PROPOSED BRIDGE AND ROADWAY CONSTRUCTION ALONG -L- (NC BUS 179) FROM -L- STA 13+00± TO -L- STA 29+50±, INCLUDING DRAINAGE, GUARDRAIL, MULTI-USE PATH, AND FINAL PAVEMENT MARKINGS AND MARKERS

PHASE I STEP 3

REMOVE TEMPORARY TRAFFIC CONTROL DEVICES AND OPEN -L- (NC BUS 179) TO PROPOSED TRAFFIC PATTERN

LOCAL NOTES

1. NOTIFY BRUNSWICK COUNTY EMERGENCY SERVICES AND PUBLIC SCHOOLS AT LEAST ONE MONTH PRIOR TO ROAD CLOSURE

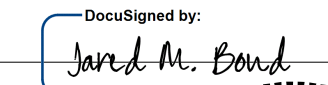
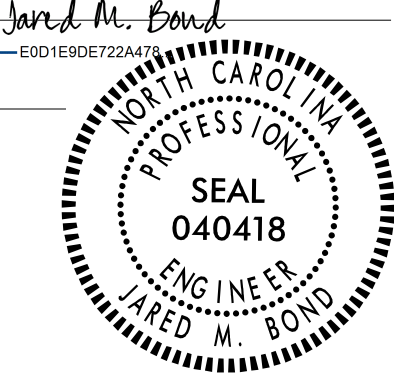
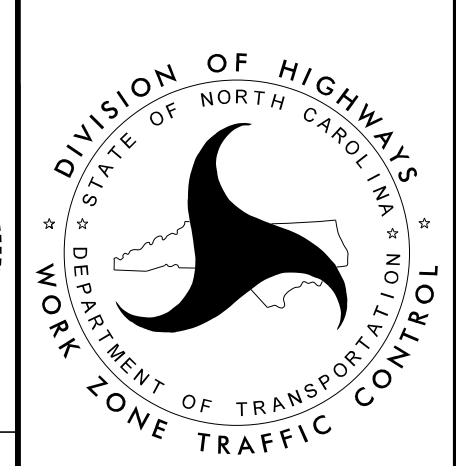

2/21/2023
R:\Traffic\TrafficControl\BR0160_tmp_generalnotes.dgn
User:McLaughl

APPROVED:  DATE: 3/14/2023			TRANSPORATION OPERATIONS PLAN
DOCUMENT NOT CONSIDERED FINAL UNLESS ALL SIGNATURES COMPLETED			



PROJ. REFERENCE NO.	SHEET NO.
BR-0160	TMP-2

SIGN NUMBER: DETOUR TYPE: D QUANTITY: 2 SIGN WIDTH: 5'-0" HEIGHT: 1'-6" TOTAL AREA: 7.5 Sq.Ft. BORDER TYPE: FLUSH RECESS: 0" WIDTH: 0.75" RADII: 2.25" NO. Z BARS: LENGTH:	BACKG COLOR: Orange COPY COLOR: Black <table border="1"> <tr> <th>SYMBOL</th> <th>X</th> <th>Y</th> <th>WID</th> <th>HT</th> </tr> <tr> <td>AR_Type D</td> <td>6.8</td> <td>6</td> <td>6</td> <td>9</td> </tr> </table> MAT'L: 0.063" (1.6 mm) ALUMINUM 0.080" (2.0 mm) ALUMINUM 0.125" (3.2 mm) ALUMINUM	SYMBOL	X	Y	WID	HT	AR_Type D	6.8	6	6	9	DESIGN BY: REM PROJECT ID: BR-0160 CHECKED BY: LOCATION: BRUNSWICK Nov 06, 2022 DIV: 3	<p>BORDER R=2.25" TH=0.75"</p> <p style="text-align: right; font-size: small;">Spacing Factor is 1 unless specified otherwise</p>
SYMBOL	X	Y	WID	HT									
AR_Type D	6.8	6	6	9									

Letter positions											Series/Size Text Length
Letter spacings are to start of next letter											D 2000
	C	a	l	a	b	a	s	h			31.6
	21.6	5	4.6	1.9	4.6	4.3	4.2	3.6	3.5	6.8	

FILENAME: BR0160_tmp_sign designs NORTH CAROLINA D.O.T. SIGN DETAIL

SIGN NUMBER: DETOUR TYPE: D QUANTITY: 1 SIGN WIDTH: 5'-0" HEIGHT: 1'-6" TOTAL AREA: 7.5 Sq.Ft. BORDER TYPE: FLUSH RECESS: 0" WIDTH: 0.75" RADII: 2.25" NO. Z BARS: LENGTH:	BACKG COLOR: Orange COPY COLOR: Black <table border="1"> <tr> <th>SYMBOL</th> <th>X</th> <th>Y</th> <th>WID</th> <th>HT</th> </tr> <tr> <td>AR_FISHOOK</td> <td>6.3</td> <td>3.6</td> <td>9.9</td> <td>10.8</td> </tr> </table> MAT'L: 0.063" (1.6 mm) ALUMINUM 0.080" (2.0 mm) ALUMINUM 0.125" (3.2 mm) ALUMINUM	SYMBOL	X	Y	WID	HT	AR_FISHOOK	6.3	3.6	9.9	10.8	DESIGN BY: REM PROJECT ID: BR-0160 CHECKED BY: LOCATION: BRUNSWICK Nov 06, 2022 DIV: 3	<p>BORDER R=2.25" TH=0.75"</p> <p style="text-align: right; font-size: small;">Spacing Factor is 1 unless specified otherwise</p>
SYMBOL	X	Y	WID	HT									
AR_FISHOOK	6.3	3.6	9.9	10.8									

Letter positions											Series/Size Text Length
Letter spacings are to start of next letter											D 2000
	C	a	l	a	b	a	s	h			31.6
	22.2	5	4.6	1.9	4.6	4.3	4.2	3.6	3.5	6.3	

FILENAME: BR0160_tmp_sign designs NORTH CAROLINA D.O.T. SIGN DETAIL

SIGN NUMBER: DETOUR TYPE: D QUANTITY: 1 SIGN WIDTH: 5'-0" HEIGHT: 1'-6" TOTAL AREA: 7.5 Sq.Ft. BORDER TYPE: FLUSH RECESS: 0" WIDTH: 0.75" RADII: 2.25" NO. Z BARS: LENGTH:	BACKG COLOR: Orange COPY COLOR: Black <table border="1"> <tr> <th>SYMBOL</th> <th>X</th> <th>Y</th> <th>WID</th> <th>HT</th> </tr> <tr> <td>AR_Type D</td> <td>44.2</td> <td>6</td> <td>6</td> <td>9</td> </tr> </table> MAT'L: 0.063" (1.6 mm) ALUMINUM 0.080" (2.0 mm) ALUMINUM 0.125" (3.2 mm) ALUMINUM	SYMBOL	X	Y	WID	HT	AR_Type D	44.2	6	6	9	DESIGN BY: REM PROJECT ID: BR-0160 CHECKED BY: LOCATION: BRUNSWICK Nov 06, 2022 DIV: 3	<p>BORDER R=2.25" TH=0.75"</p> <p style="text-align: right; font-size: small;">Spacing Factor is 1 unless specified otherwise</p>
SYMBOL	X	Y	WID	HT									
AR_Type D	44.2	6	6	9									

Letter positions											Series/Size Text Length
Letter spacings are to start of next letter											D 2000
	C	a	l	a	b	a	s	h			31.6
	6.8	5	4.6	1.9	4.6	4.3	4.2	3.6	3.5	21.6	

FILENAME: BR0160_tmp_sign designs NORTH CAROLINA D.O.T. SIGN DETAIL

2/21/2023
 R:\Traffic\TrafficControl\BR0160_tmp_sign_design_sheets_2.dgn
 User:McLaughR



APPROVED: *Jared M. Bond*
 DATE: 3/14/2023

DocuSigned by:
Jared M. Bond
E0D1E9D67224415

NORTH CAROLINA
 PROFESSIONAL
 SEAL
 040418
 ENGINEER
 JARED M. BOND

DOCUMENT NOT CONSIDERED FINAL
UNLESS ALL SIGNATURES COMPLETED

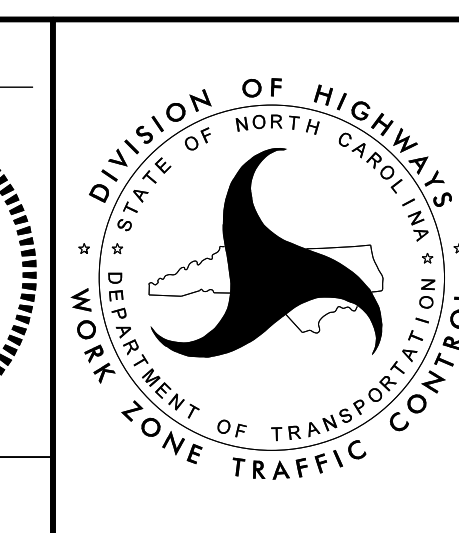

DETOUR
SIGN DESIGNS

SIGN NUMBER: DETOUR TYPE: D QUANTITY: 1 SIGN WIDTH: 8'-0" HEIGHT: 2'-6" TOTAL AREA: 20.0 Sq.Ft. BORDER TYPE: FLUSH RECESS: 0" WIDTH: 0.75" RADII: 2.25" NO. Z BARS: LENGTH:	BACKG COLOR: Orange COPY COLOR: Black <table border="1"> <tr> <th>SYMBOL</th> <th>X</th> <th>Y</th> <th>WID</th> <th>HT</th> </tr> <tr> <td>AR_Type D</td> <td>7.7</td> <td>19.5</td> <td>6</td> <td>9</td> </tr> <tr> <td>AR_Type D</td> <td>71.8</td> <td>4.7</td> <td>6</td> <td>9</td> </tr> </table> MAT'L: 0.063" (1.6 mm) ALUMINUM 0.080" (2.0 mm) ALUMINUM 0.125" (3.2 mm) ALUMINUM	SYMBOL	X	Y	WID	HT	AR_Type D	7.7	19.5	6	9	AR_Type D	71.8	4.7	6	9	DESIGN BY: REM CHECKED BY: PROJECT ID: BR-0160 LOCATION: BRUNSWICK Nov 06, 2022 DIV: 3
SYMBOL	X	Y	WID	HT													
AR_Type D	7.7	19.5	6	9													
AR_Type D	71.8	4.7	6	9													

Spacing Factor is 1 unless specified otherwise

Letter spacings are to start of next letter													Series/Size						
	O	c	e	a	n		i	s	l	e		B	e	a	c	h		Text Length	
	22.8	5.2	4.1	4.1	4.6	3.5	6	1.9	3.6	1.9	3.5	6	4.7	4.1	4.3	4.3	3.5	7.8	D 2000
																			65.5
																			D 2000
	15.2	4.9	4.7	4.3	3.4	3.8	2.4	6	4.7	4.1	4.3	4.3	3.5	30.2					50.6

FILENAME: BR0160_tmp_sign designs NORTH CAROLINA D.O.T. SIGN DETAIL

SIGN NUMBER: DETOUR TYPE: D QUANTITY: 1 SIGN WIDTH: 8'-0" HEIGHT: 2'-6" TOTAL AREA: 20.0 Sq.Ft. BORDER TYPE: FLUSH RECESS: 0" WIDTH: 0.75" RADII: 2.25" NO. Z BARS: LENGTH:	BACKG COLOR: Orange COPY COLOR: Black <table border="1"> <tr> <th>SYMBOL</th> <th>X</th> <th>Y</th> <th>WID</th> <th>HT</th> </tr> <tr> <td>AR_Type D</td> <td>79.2</td> <td>19.4</td> <td>6</td> <td>9</td> </tr> <tr> <td>AR_Type D</td> <td>71.8</td> <td>4.7</td> <td>6</td> <td>9</td> </tr> </table> MAT'L: 0.063" (1.6 mm) ALUMINUM 0.080" (2.0 mm) ALUMINUM 0.125" (3.2 mm) ALUMINUM	SYMBOL	X	Y	WID	HT	AR_Type D	79.2	19.4	6	9	AR_Type D	71.8	4.7	6	9	DESIGN BY: REM CHECKED BY: PROJECT ID: BR-0160 LOCATION: BRUNSWICK Nov 06, 2022 DIV: 3
SYMBOL	X	Y	WID	HT													
AR_Type D	79.2	19.4	6	9													
AR_Type D	71.8	4.7	6	9													

Spacing Factor is 1 unless specified otherwise

Letter spacings are to start of next letter													Series/Size						
	O	c	e	a	n		i	s	l	e		B	e	a	c	h		Text Length	
	7.8	5.2	4.1	4.1	4.6	3.5	6	1.9	3.6	1.9	3.5	6	4.7	4.1	4.3	4.3	3.5	22.8	D 2000
																			65.5
																			D 2000
	15.2	4.9	4.7	4.3	3.4	3.8	2.4	6	4.7	4.1	4.3	4.3	3.5	30.2					50.6

FILENAME: BR0160_tmp_sign designs NORTH CAROLINA D.O.T. SIGN DETAIL

SIGN NUMBER: DETOUR TYPE: D QUANTITY: 1 SIGN WIDTH: 7'-6" HEIGHT: 2'-6" TOTAL AREA: 18.75 Sq.Ft. BORDER TYPE: FLUSH RECESS: 0" WIDTH: 0.75" RADII: 2.25" NO. Z BARS: LENGTH:	BACKG COLOR: Orange COPY COLOR: Black <table border="1"> <tr> <th>SYMBOL</th> <th>X</th> <th>Y</th> <th>WID</th> <th>HT</th> </tr> <tr> <td>AR_Type D</td> <td>6.3</td> <td>17.8</td> <td>6</td> <td>9</td> </tr> <tr> <td>AR_Type D</td> <td>13.7</td> <td>3.2</td> <td>6</td> <td>9</td> </tr> </table> MAT'L: 0.063" (1.6 mm) ALUMINUM 0.080" (2.0 mm) ALUMINUM 0.125" (3.2 mm) ALUMINUM	SYMBOL	X	Y	WID	HT	AR_Type D	6.3	17.8	6	9	AR_Type D	13.7	3.2	6	9	DESIGN BY: REM CHECKED BY: PROJECT ID: BR-0160 LOCATION: BRUNSWICK Nov 06, 2022 DIV: 3
SYMBOL	X	Y	WID	HT													
AR_Type D	6.3	17.8	6	9													
AR_Type D	13.7	3.2	6	9													

Spacing Factor is 1 unless specified otherwise

Letter spacings are to start of next letter													Series/Size						
	O	c	e	a	n		i	s	l	e		B	e	a	c	h		Text Length	
	18.3	5.2	4.1	4.1	4.6	3.5	6	1.9	3.6	1.9	3.5	6	4.7	4.1	4.3	4.3	3.5	6.3	D 2000
																			65.5
																			D 2000
	25.7	4.9	4.7	4.3	3.4	3.8	2.4	6	4.7	4.1	4.3	4.3	3.5	13.7					50.6

FILENAME: BR0160_tmp_sign designs NORTH CAROLINA D.O.T. SIGN DETAIL

2/21/2023
 R:\Traffic\TrafficControl\BR0160_tmp_sign_design_sheets_2A.dgn
 User:McLaughr



APPROVED: *Jared M. Bond*
 DATE: 3/14/2023

DocuSigned by:
 Jared M. Bond
 E001E90E7294184X

**DOCUMENT NOT CONSIDERED FINAL
 UNLESS ALL SIGNATURES COMPLETED**

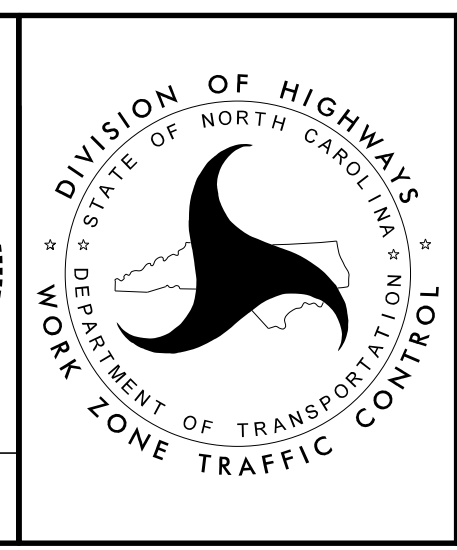

**DETOUR
 SIGN DESIGNS**

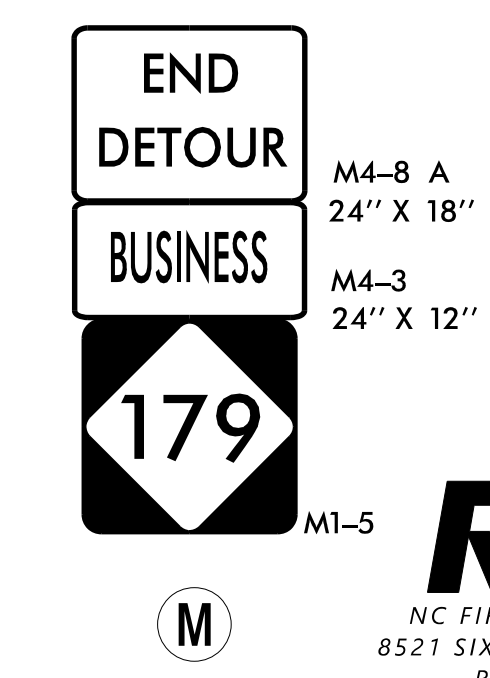
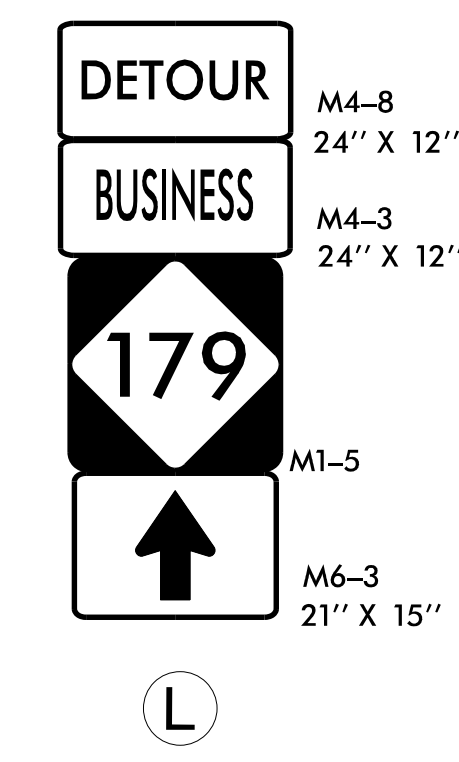
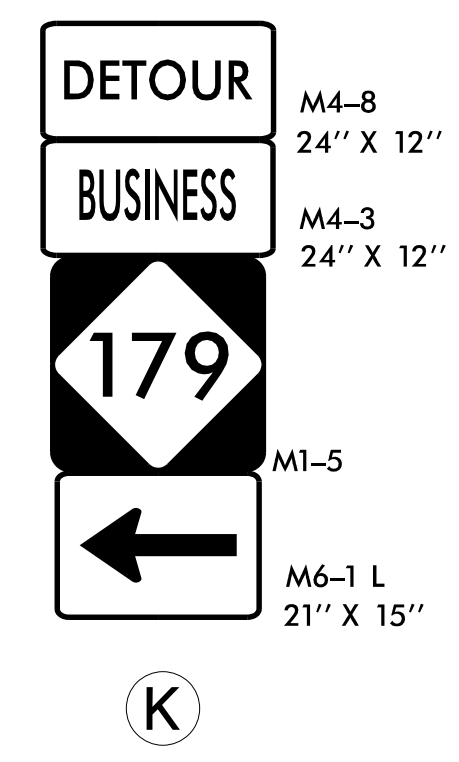
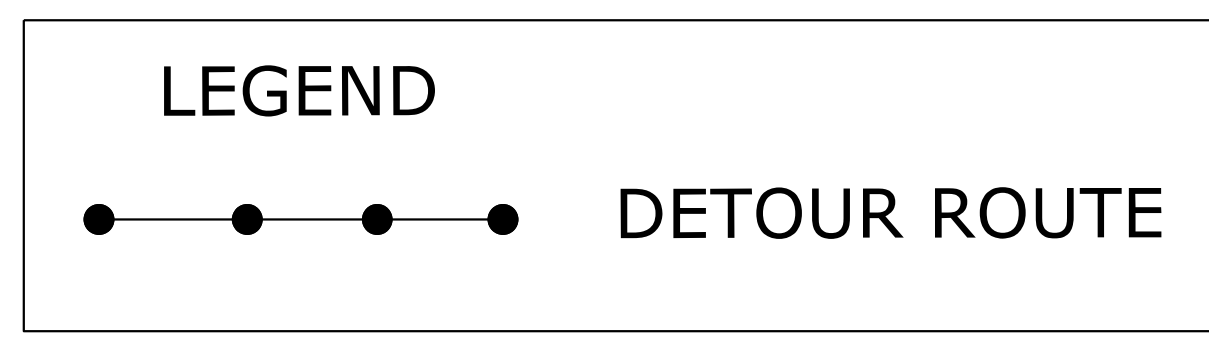
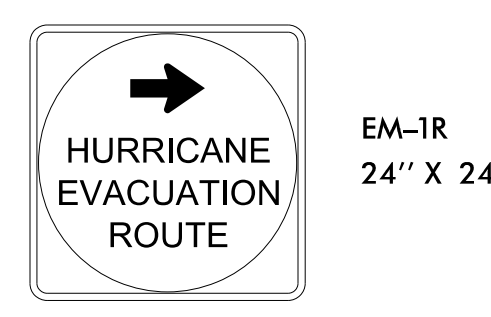
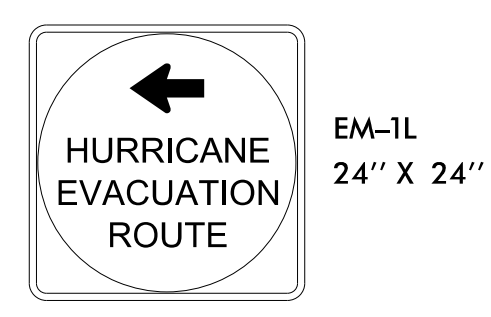
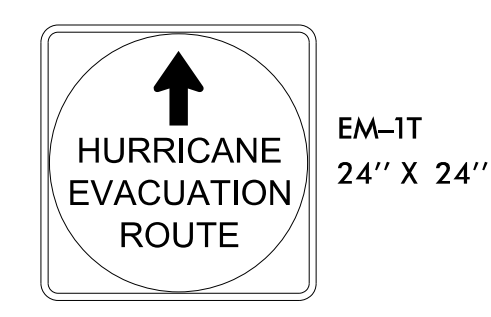
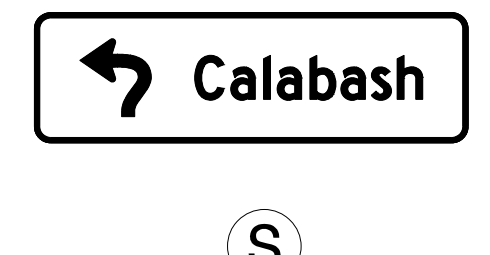
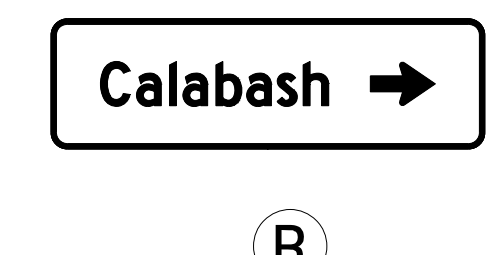
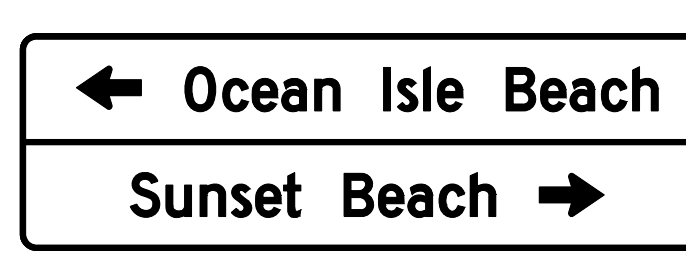
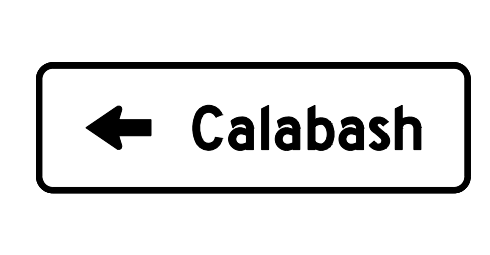
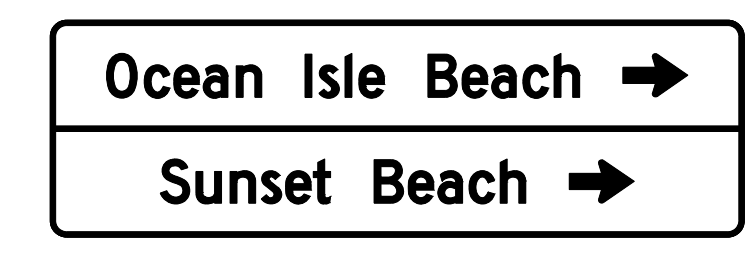
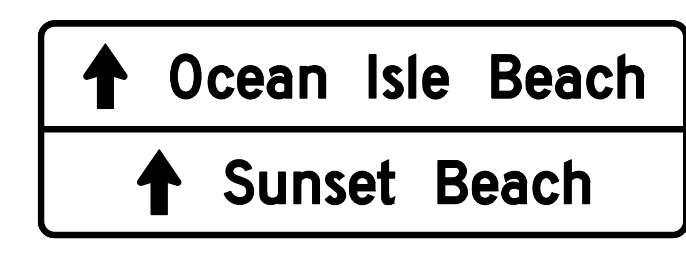
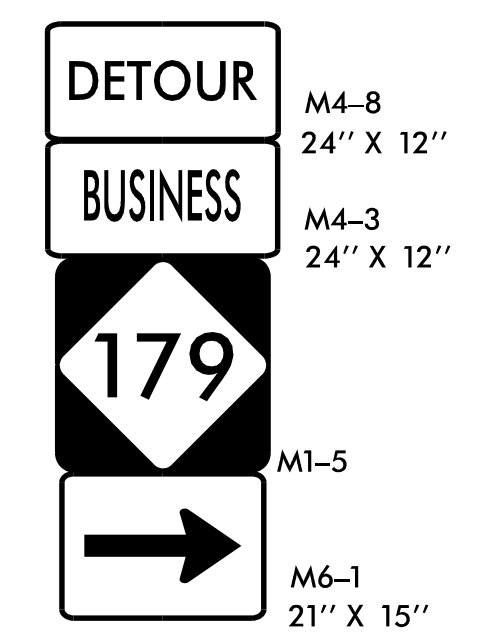
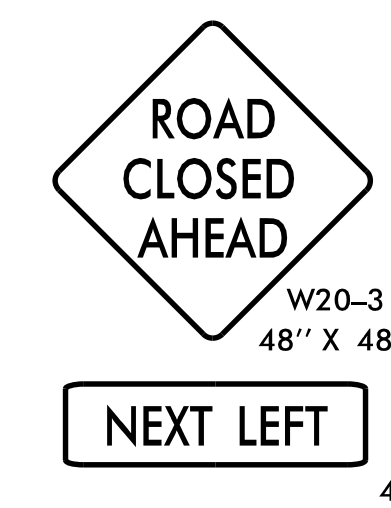
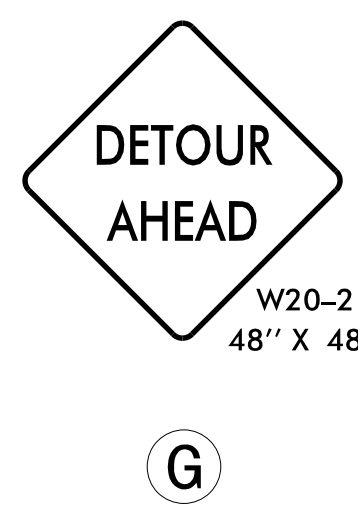
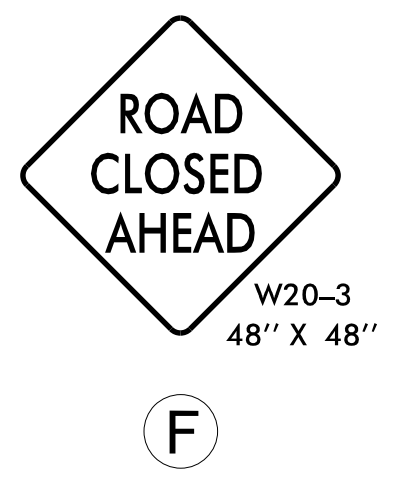
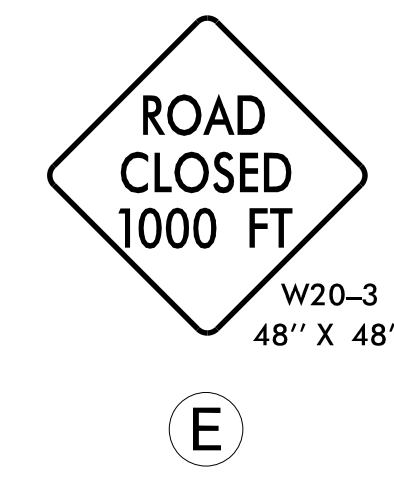
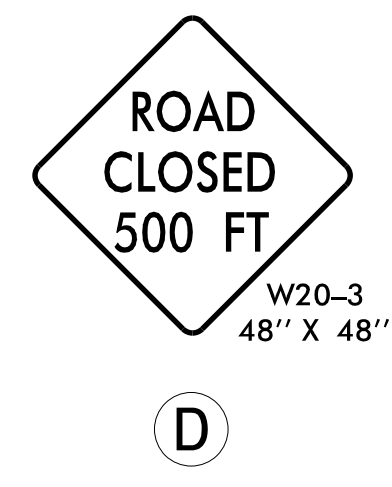
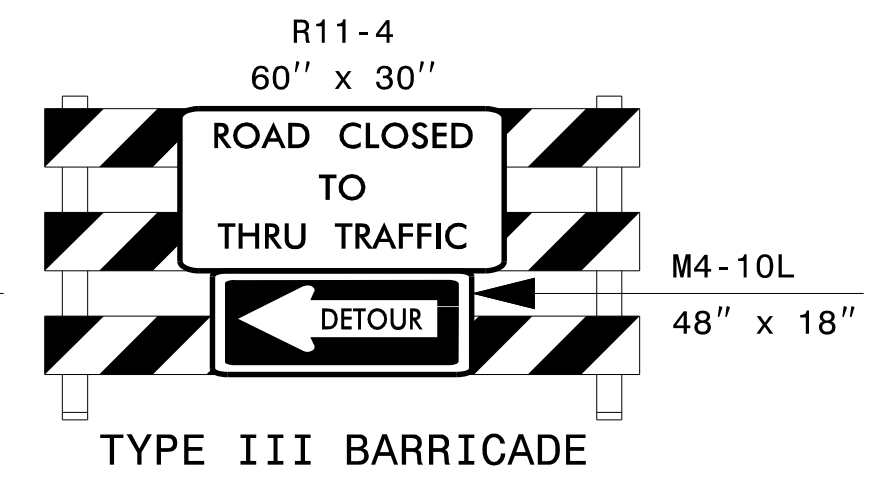
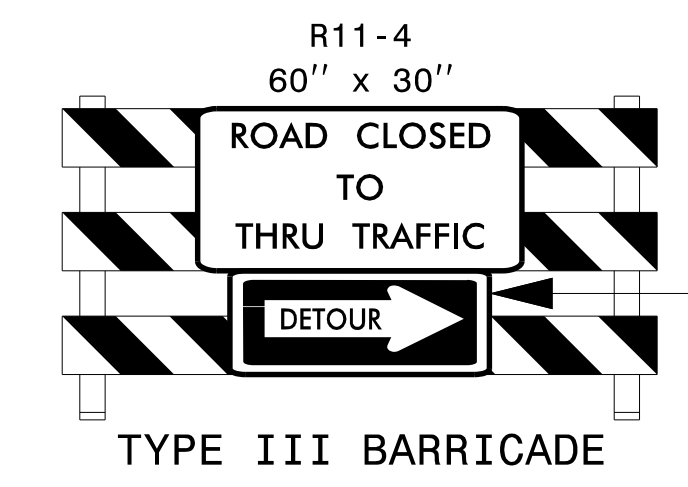
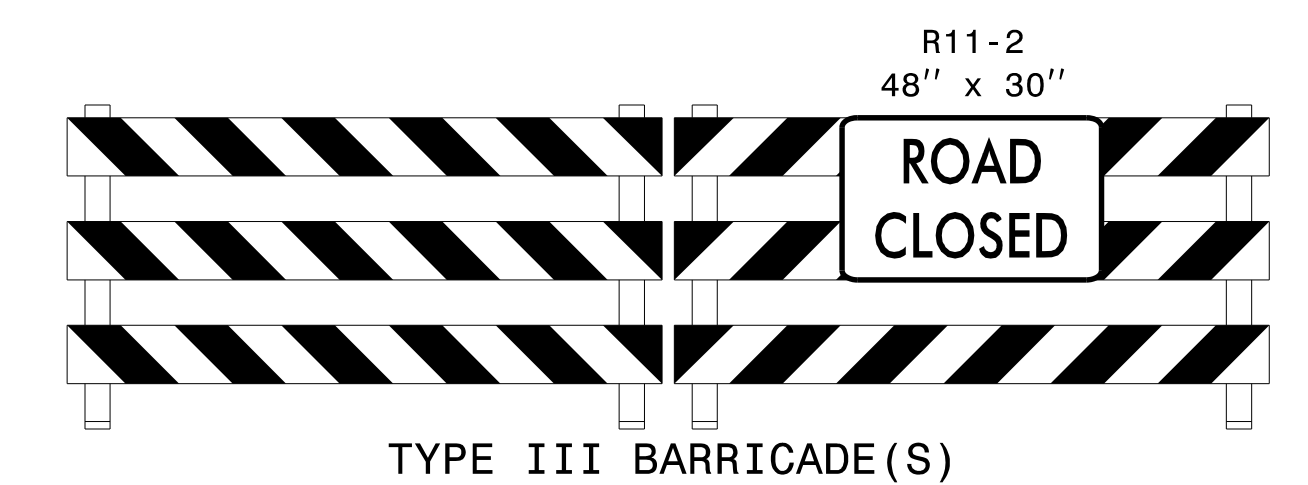
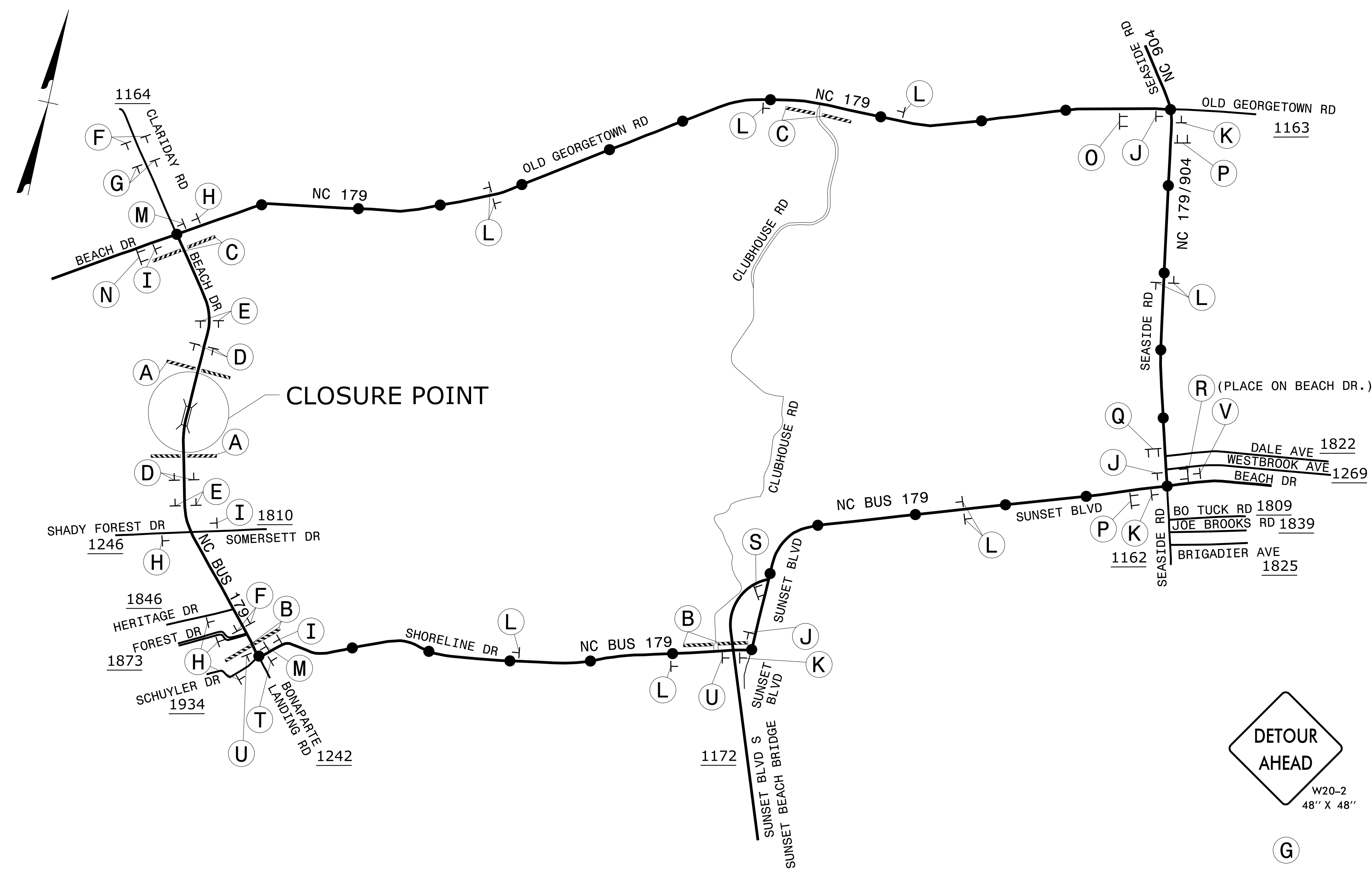

APPROVED: *Jared M. Bond*
 DATE: 3/14/2023
 NORTH CAROLINA PROFESSIONAL SEAL 040418
 JARED M. BOND
 ENGINEER

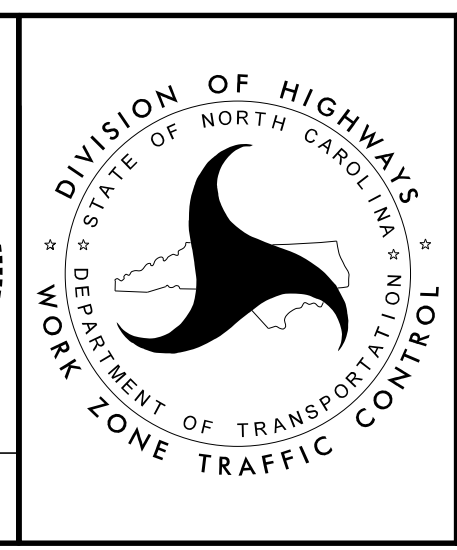

DETOUR ROUTE

2/21/2023
 R:\Traffic\TrafficControl\BR0160_tmp_detour.dgn
 User:McLaughlin

DOCUMENT NOT CONSIDERED FINAL
 UNLESS ALL SIGNATURES COMPLETED