

**SECTION A-A**

(SHOWING 0.6" Ø LOW RELAXATION STRAND LAYOUT)  
(18 STRANDS REQUIRED)

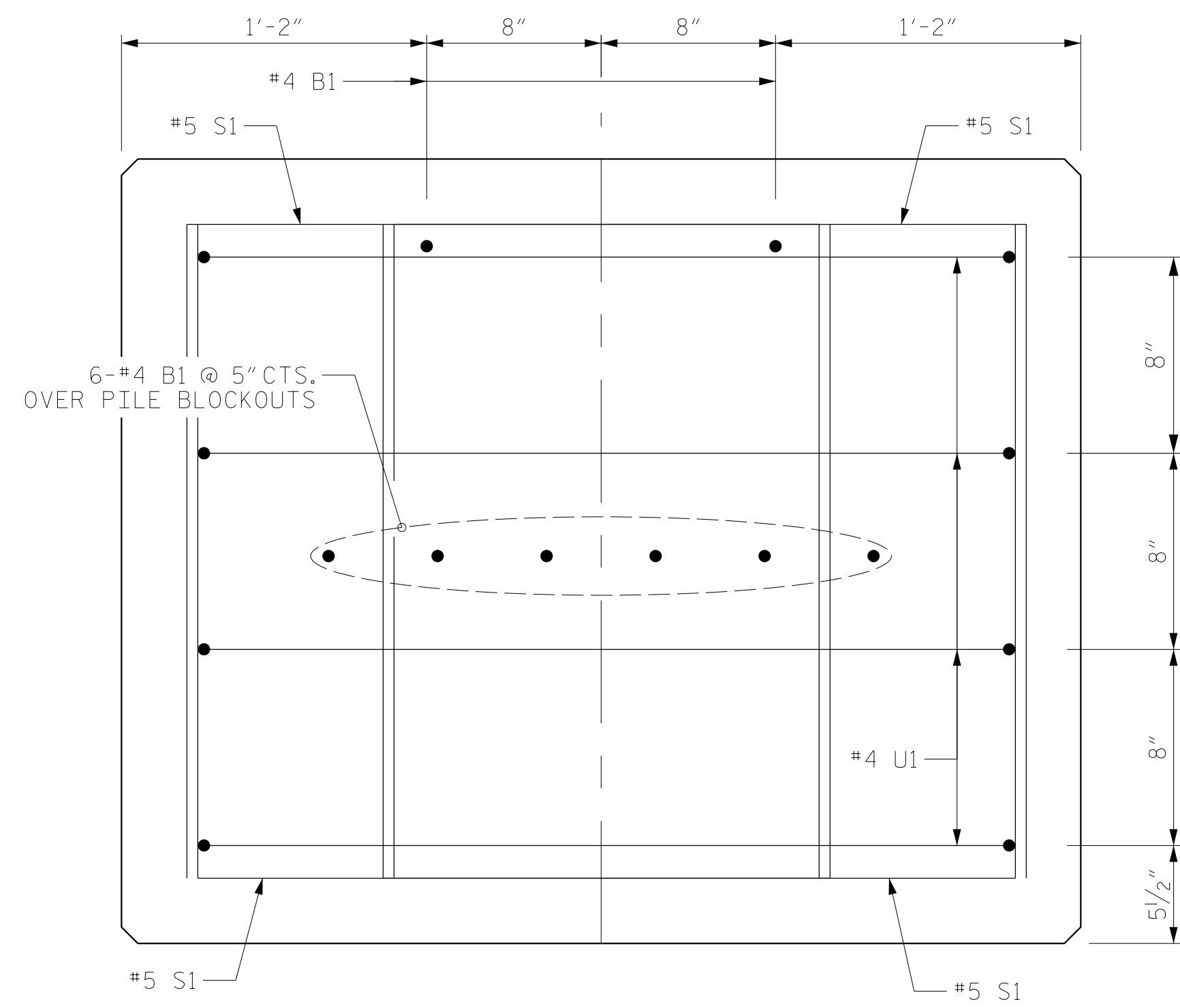

**END OF CAP VIEW**

(TYPICAL BOTH ENDS)

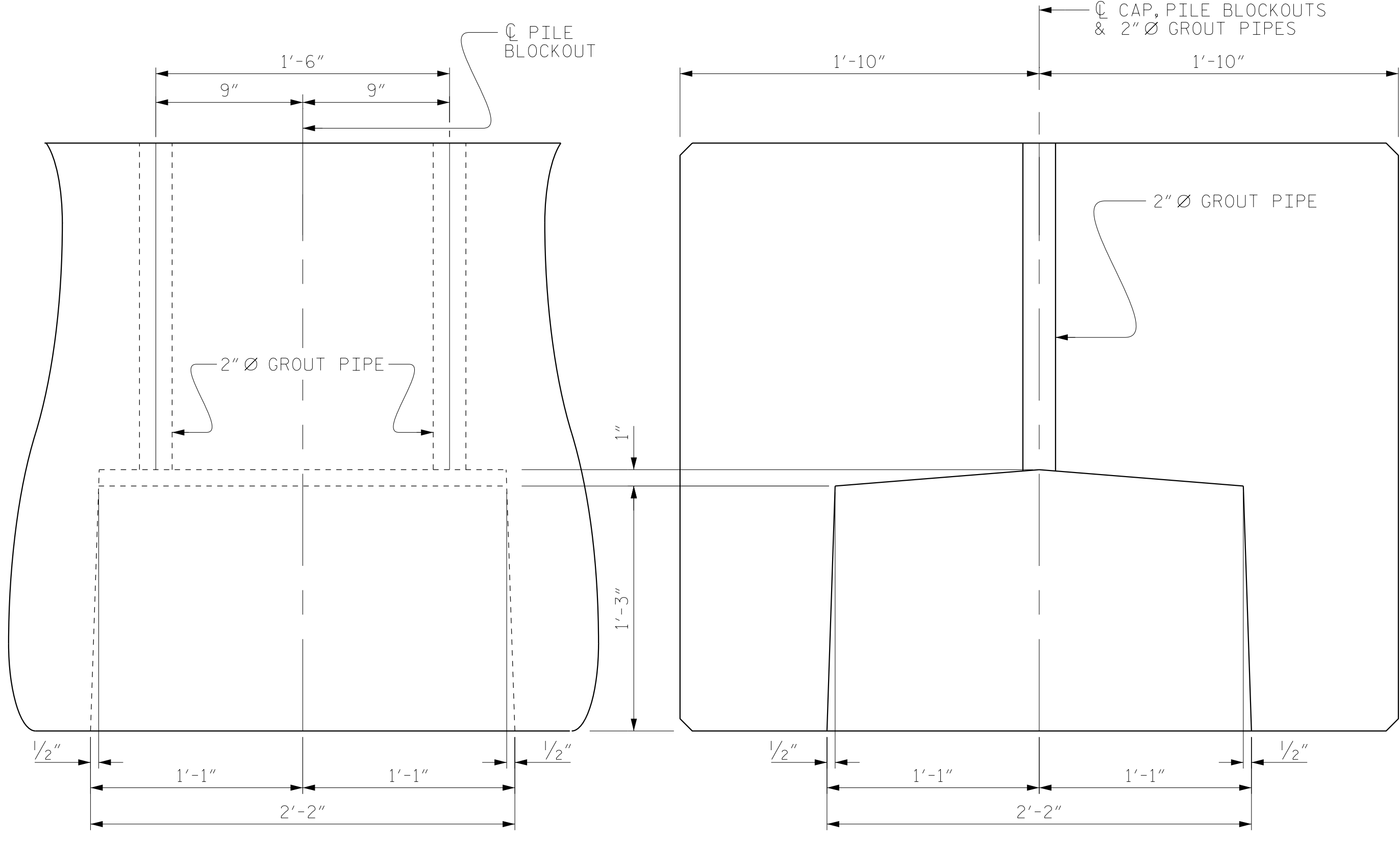

**ELEVATION**

**SECTION**

**PILE BLOCKOUT DETAILS**

(DIMENSIONS ARE TYPICAL EACH BLOCKOUT)

PRESTRESSED CONCRETE BENT CAPS (FOR ONE BENT)			
PIECE	LENGTH	NUMBER	TOTAL LENGTH
B-01	15'-8"	2	31'-4"
B-02	15'-8"	1	15'-8"
TOTAL		3	47.00'

**NOTES:**

STIRRUPS IN PRECAST PIECES MAY BE SHIFTED AS NECESSARY TO CLEAR ANCHOR BOLTS AND GROUT PIPES.

ALL PRESTRESSING STRANDS SHALL BE 7-WIRE LOW RELAXATION GRADE 270 STRANDS AND SHALL CONFORM TO AASHTO M203 EXCEPT FOR SAMPLING REQUIREMENTS WHICH SHALL BE IN ACCORDANCE WITH THE STANDARD SPECIFICATIONS.

ALL REINFORCING STEEL CAST WITH THE BENT CAP SHALL BE GRADE 60 AND SHALL BE INCLUDED IN THE UNIT PRICE BID FOR PRECAST BENT CAPS.

WHEN BENT CAPS ARE CAST, A HOLD-DOWN SYSTEM SHALL BE EMPLOYED TO PREVENT VOIDS FROM RISING OR MOVING SIDEWAYS. AT LEAST SIX WEEKS PRIOR TO CASTING BENT CAPS, THE CONTRACTOR SHALL SUBMIT TO THE ENGINEER FOR REVIEW AND COMMENT, DETAILED DRAWINGS OF THE PROPOSED HOLD-DOWN SYSTEM, IN ADDITION TO STRUCTURAL DETAILS, LOCATION AND SPACING OF THE HOLD-DOWNS SHALL BE INDICATED.

PRESTRESSING STRANDS SHALL BE CUT FLUSH WITH THE ENDS OF THE BENT CAP SEGMENTS.

APPLY EPOXY PROTECTIVE COATING TO THE ENDS OF THE BENT CAP SEGMENTS.

THE TRANSFER OF LOAD FROM THE ANCHORAGES TO THE BENT CAPS SHALL BE DONE WHEN THE CONCRETE HAS REACHED A COMPRESSIVE STRENGTH OF NOT LESS THAN 3000 PSI.

THE CONTRACTOR SHALL SUBMIT TO THE ENGINEER FOR APPROVAL A METHOD TO LIFT AND SUPPORT THE PRECAST CAP PIECES IN THE PROPER LOCATION AND ELEVATION AS SHOWN ON THE PLANS PRIOR TO PLACEMENT AND CURING OF THE GROUT IN THE PILE BLOCKOUTS. THE METHOD CHOSEN SHALL PROVIDE FOR A WATERTIGHT SEAL AT THE BOTTOM OF THE CAP UNTIL THE GROUT HAS HARDENED SO NO GROUT COMES IN CONTACT WITH THE STREAM.

PRECAST CAPS SHALL CONTAIN CALCIUM NITRATE CORROSION INHIBITOR IN ACCORDANCE WITH THE STANDARD SPECIFICATIONS.

THE TOP SURFACE OF THE BENT CAPS SHALL BE CURED IN ACCORDANCE WITH THE STANDARD SPECIFICATIONS, EXCEPT THE MEMBRANE CURING COMPOUND METHOD SHALL NOT BE USED.

EPOXY COAT THE TOP SURFACE OF THE BENT CAP, SECTION 420-18(b) LINES 13 AND 14 OF THE STANDARD SPECIFICATIONS SHALL BE DISREGARDED. NO SEPARATE PAYMENT SHALL BE MADE FOR THE EPOXY PROTECTIVE COATING AS THIS IS CONSIDERED INCIDENTAL TO THE VARIOUS PAY ITEMS.

THE CONCRETE IN THE PRECAST BENT CAPS, IF UTILIZED, SHALL CONTAIN SILICA FUME. SILICA FUME SHALL BE SUBSTITUTED FOR 5% OF THE PORTLAND CEMENT BY WEIGHT. IF THE OPTION OF ARTICLE 1024-1 OF THE STANDARD SPECIFICATIONS TO PARTIALLY SUBSTITUTE CLASS F FLY ASH FOR PORTLAND CEMENT IS EXERCISED, THEN THE RATE OF FLY ASH SUBSTITUTION SHALL BE REDUCED TO 1.0 LB OF FLY ASH PER 1.0 LB OF CEMENT. NO PAYMENT WILL BE MADE FOR THIS SUBSTITUTION AS IT IS CONSIDERED INCIDENTAL TO THE VARIOUS PAY ITEMS.

PROJECT NO. BR-0160  
BRUNSWICK COUNTY  
 STATION: 21+77.50 -L-

SHEET 4 OF 4



RS&H Architects-Engineers-Planners, Inc.  
 8521 Six Forks Road, Suite 400  
 Raleigh, NC 27615  
 919-926-4100 FAX 919-846-9080  
 www.rsandh.com  
 North Carolina License Nos. 50737-54043-1-C&E

STATE OF NORTH CAROLINA  
 DEPARTMENT OF TRANSPORTATION  
 RALEIGH  
 SUBSTRUCTURE  
**ALTERNATE BENT OPTION  
 PRECAST CONCRETE  
 BENT NO. 1-9 DETAILS**

REVISIONS						SHEET NO.
NO.	BY:	DATE:	NO.	BY:	DATE:	S-38
1			3			TOTAL SHEETS
2			4			42

DRAWN BY : MRA DATE : 01/2023  
 CHECKED BY : MKO DATE : 01/2023  
 DESIGN ENGINEER OF RECORD: RLB DATE : 03/2023

DOCUMENT NOT CONSIDERED FINAL UNLESS ALL SIGNATURES COMPLETED