

BILL OF MATERIAL					
FOR ONE PIECE B-02					
BAR	NO.	SIZE	TYPE	LENGTH	WEIGHT
B1	8	#4	STR	15'-2"	81
B2	4	#4	STR	3'-2"	8
S1	72	#5	1	7'-5"	557
S2	9	#5	1	8'-2"	77
S3	9	#4	2	10'-5"	63
U1	8	#4	1	6'-0"	32
REINFORCING STEEL					818 LBS
4000 PSI PRESTRESS CONCRETE					5.8 C.Y.
PILE BLOCKOUT GROUT ▲					0.4 C.Y.
0.6" Ø L.R. STRANDS					No. 18
BAR TYPES					

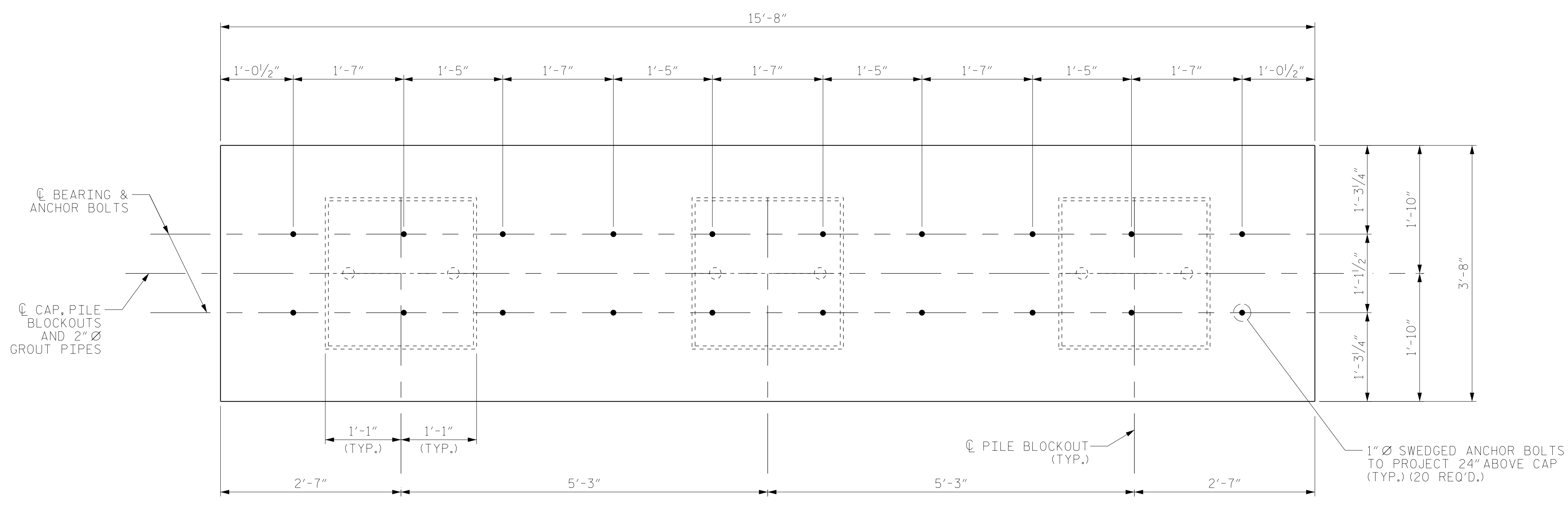

PLAN

(FOR PILE BLOCKOUT DETAILS, SEE SHEET 4 OF 4)

▲ GROUT DISPLACED BY THE 20" PRESTRESSED CONCRETE PILES HAS BEEN DEDUCTED FROM THE GROUT QUANTITY.

GRADE 270 STRANDS	
AREA (SQUARE INCHES)	0.217
ULTIMATE STRENGTH (LBS. PER STRAND)	58,600
APPLIED PRESTRESS (LBS. PER STRAND)	43,950

NOTES

ANCHOR BOLTS SHALL MEET THE REQUIREMENTS OF ASTM F1554 GR.105. ANCHOR PLATES, WASHERS, AND NUTS SHALL MEET THE REQUIREMENTS OF THE STANDARD SPECIFICATIONS. ANCHOR BOLTS, ANCHOR PLATES, WASHERS, AND NUTS SHALL BE GALVANIZED IN ACCORDANCE WITH THE STANDARD SPECIFICATIONS.

NO SEPARATE PAYMENT SHALL BE MADE FOR THE ANCHOR BOLTS, ANCHOR PLATES, WASHERS, AND NUTS. THE COST OF THE MATERIAL AND INSTALLATION SHALL BE CONSIDERED INCIDENTAL TO VARIOUS PAY ITEMS.

PROJECT NO. BR-0160
BRUNSWICK COUNTY
 STATION: 21+77.50 -L-

SHEET 3 OF 4

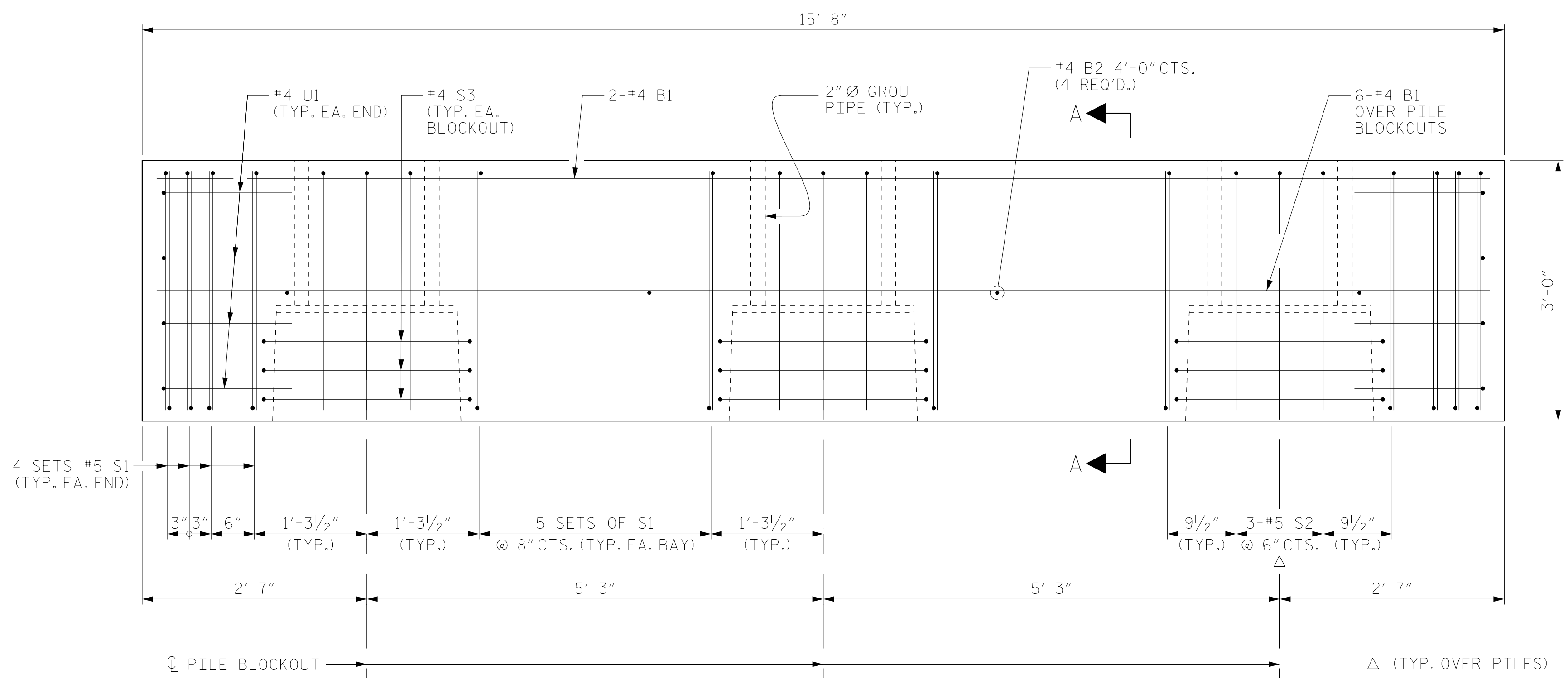

ELEVATION

(ANCHOR BOLTS NOT SHOWN FOR CLARITY) FOR SECTION A-A, SEE SHEET 4 OF 4.

DRAWN BY : MRA DATE : 01/2023
 CHECKED BY : MKO DATE : 01/2023
 DESIGN ENGINEER OF RECORD: RLB DATE : 03/2023

DOCUMENT NOT CONSIDERED FINAL UNLESS ALL SIGNATURES COMPLETED

STATE OF NORTH CAROLINA					
DEPARTMENT OF TRANSPORTATION					
RALEIGH					
SUBSTRUCTURE					
ALTERNATE BENT OPTION					
PRECAST					
PIECE B-02					
REVISIONS					SHEET NO.
NO.	BY:	DATE:	NO.	BY:	DATE:
1			3		
2			4		
					S-37
					TOTAL SHEETS 42