

8/17/99

REVISIONS

1/11/2023
5:18:23 PM
BR-0160_Rdy_psh_5.dgn

NOTE:
FOCUS TO PLACE (2) 4" CONDUITS FOR BORE
LOCATIONS UNDER RIVER AND ROAD

NOTE:
BEMC TO PLACE (3) 4" CONDUITS FOR OPEN
CUT LOCATIONS FOR A TOTAL OF 1,460
LINEAR FEET

NAD 83/NA 2011

PROJECT REFERENCE NO.	SHEET NO.
BR-0160	UO-03
THIS SHEET CORRESPONDS TO R0Y- 5	

UTILITIES BY OTHERS

ALL PROPOSED UTILITY WORK SHOWN ON THIS SHEET WILL BE DONE BY OTHERS. NO PAYMENT WILL BE MADE TO THE CONTRACTOR FOR PROPOSED UTILITY WORK SHOWN ON THIS SHEET.

NOTE:
FOCUS TO PLACE (2) 4" CONDUITS AND (1)
2" CONDUIT FOR OPEN CUT

NOTE:
BEMC TO PLACE (4) 4" CONDUITS FOR BORE
LOCATIONS UNDER RIVER AND ROAD

MATCHLINE SHEET UO-02 -L- STA. 21+00.00

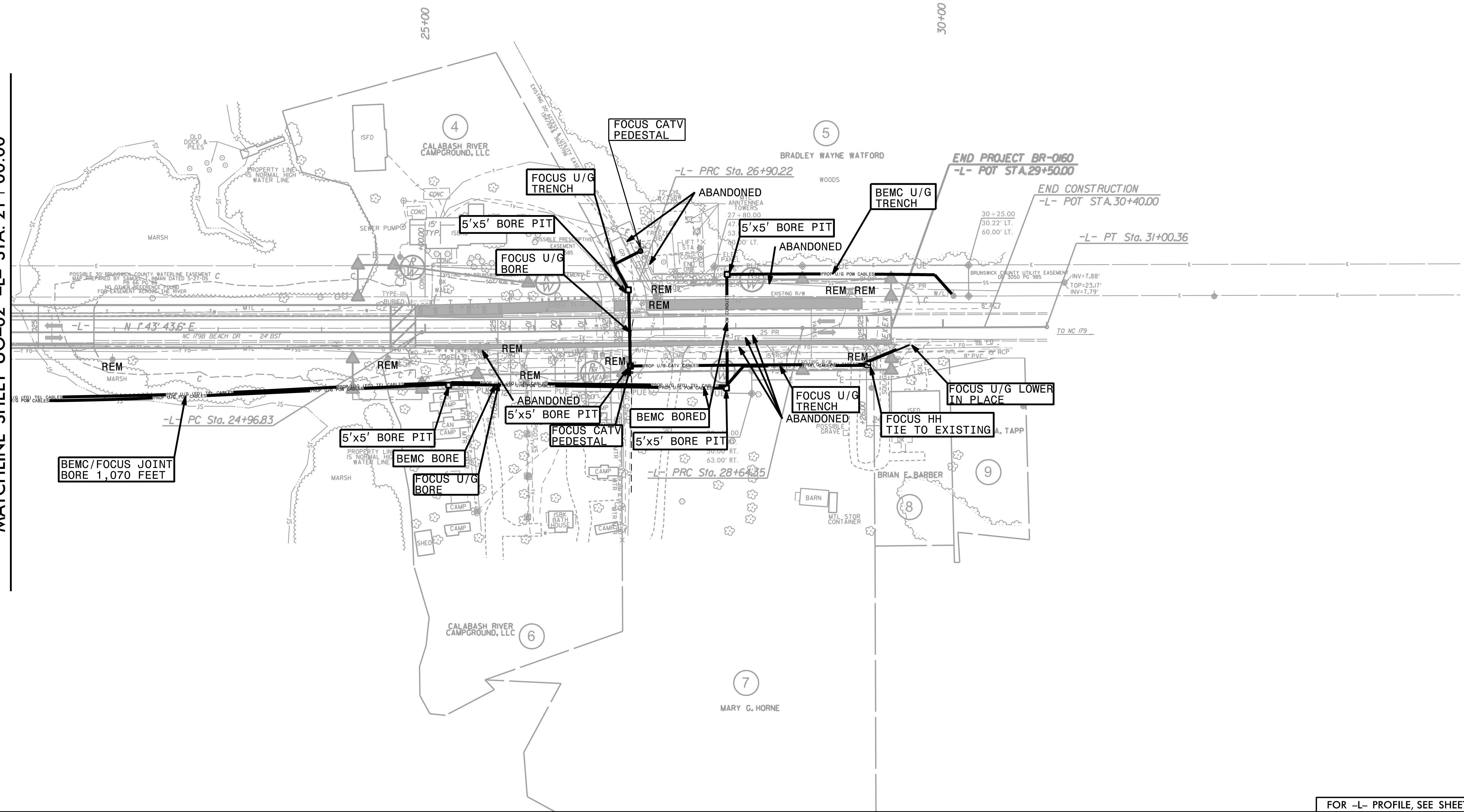

FOR -L- PROFILE, SEE SHEET NO. 6