

NOTE:  
THE UPSTREAM AND DOWNSTREAM CHANNEL CHARACTERISTICS AT STRUCTURE 0401 CONSISTS PRIMARILY OF FLAT WETLAND AREA. THERE IS NOT A DISCERNIBLE CHANNEL AT THIS LOCATION. THE EXISTING 18" RCP WAS FOUND IN GOOD CONDITION AT THE TIME OF THE FIELD INVESTIGATION (05062021).

\*\*\*\*\*  
BM1 ELEVATION = 11.88'  
N 50829 E 2136618  
BL STATION 30.25  
OFFSET 137' LEFT  
RRSPIKE IN 21' OAK  
\*\*\*\*\*

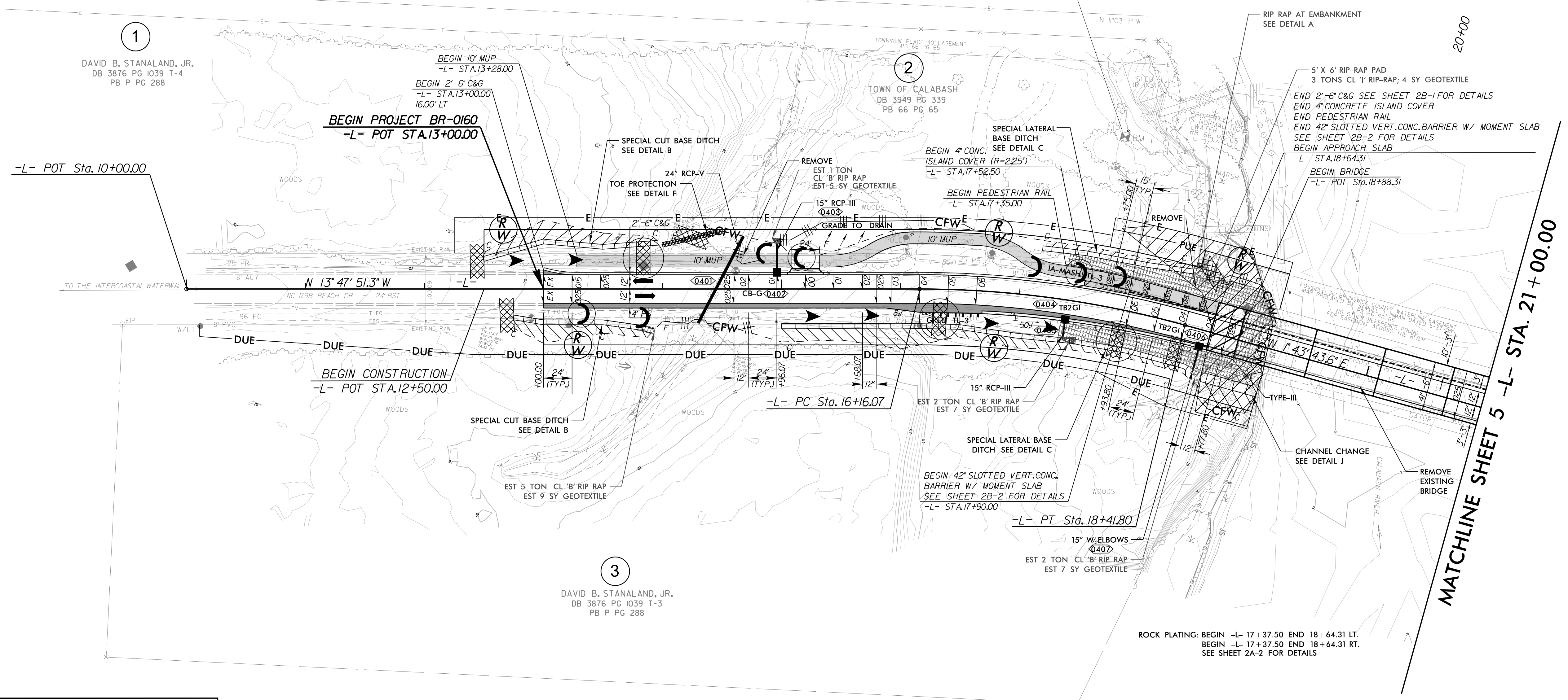

NOTE: UTILIZE FLOATING TURBIDITY CURTAIN WHERE APPLICABLE.

NOTE: UTILIZE TEMPORARY SEDIMENT BASIN OR SPECIAL STILLING BASIN(S) AS STILLING BASIN WHERE APPLICABLE.

NOTES: ANY DEVIATION FROM OPTIONS GIVEN WILL REQUIRE PRIOR APPROVAL BY ENGINEER.

ADDITIONAL EROSION CONTROL DEVICES MAY NEED TO BE INSTALLED AS DIRECTED BY THE ENGINEER.

CLEARING AND GRUBBING EROSION CONTROL FOR CONSTRUCTION SHEET 4

NOTE: PLACE TEMPORARY ROCK SEDIMENT DAMS TYPE - B AND TEMPORARY ROCK SILT CHECKS TYPE - A AT DRAINAGE OUTLETS.



-L- CURVE DATA  
PI Sta 17+29.63  
Δ = 15° 31' 34.9" (RT)  
D = 6' 52" 41.7"  
L = 225.73'  
T = 113.56'  
R = 833.00'  
SE = 06  
RO = 144'

22-FEB-2023 14:23 P:\Projects\2023\1423\Design\Plan\_Sheets\BR0160\_psh\_EC-4.dgn