

STATE	STATE PROJECT REFERENCE NO.	SHEET NO.	TOTAL SHEETS
N.C.	BR-0160	RW01	07

STATE OF NORTH CAROLINA
DIVISION OF HIGHWAYS

SURVEY CONTROL, EXISTING CENTERLINES,
RIGHT OF WAY, EASEMENTS AND PROPERTY TIES

BRUNSWICK COUNTY

LOCATION: REPLACE BRIDGE 15 OVER CALABASH RIVER ON NC 179B (BEACH DR. SW)

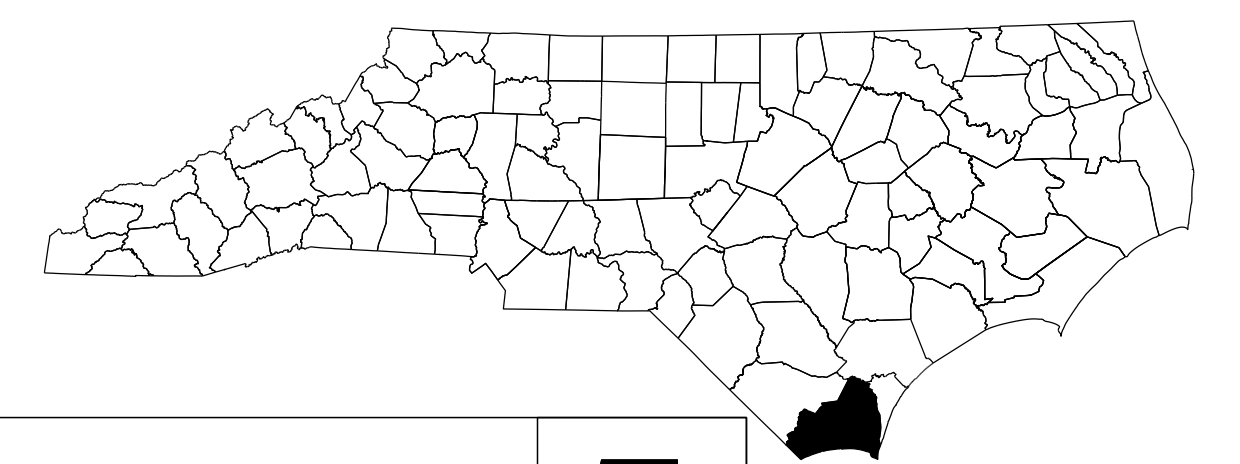

TIP PROJECT: BR-0160

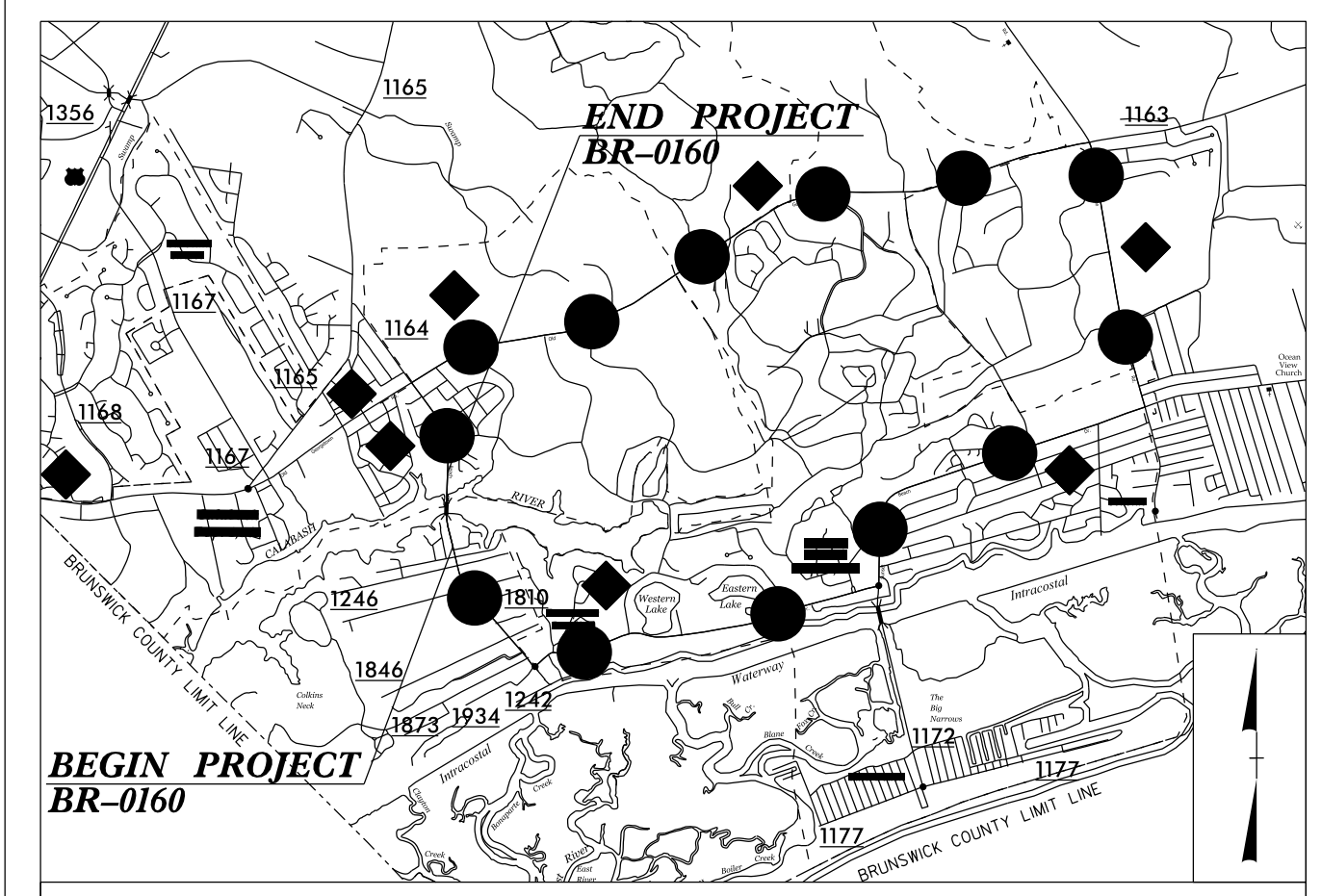

● ● ● **DETOUR**
VICINITY MAP N.T.S

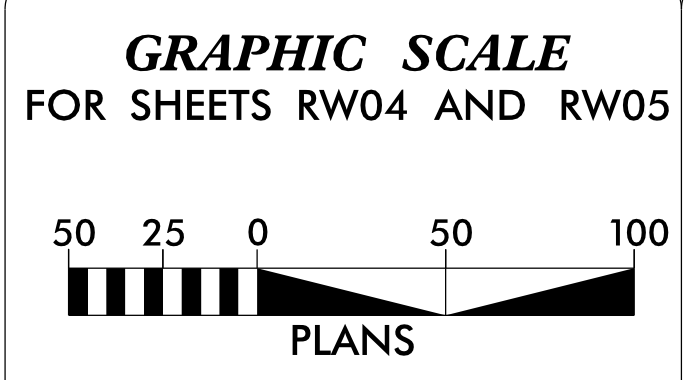
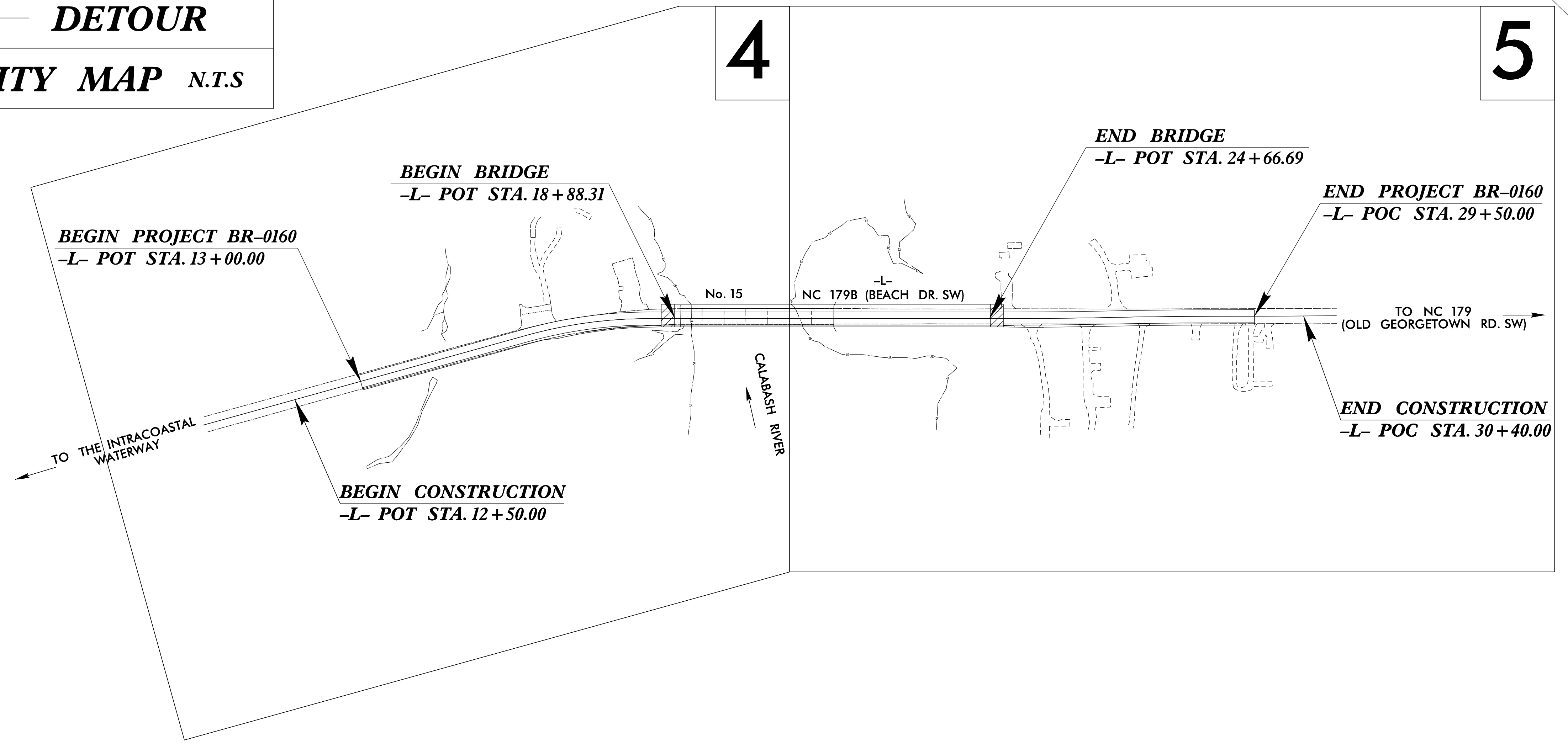

DATUM DESCRIPTION
THE LOCALIZED COORDINATE SYSTEM DEVELOPED FOR THIS PROJECT IS BASED ON THE STATE PLANE COORDINATES ESTABLISHED BY NCGS FOR MONUMENT "BR01602" WITH NAD 83/NSRS 2011 STATE PLANE GRID COORDINATES OF NORTHING: 49,564,6362(ft) EASTING: 2,137,080.5314(ft) ELEVATION: 24.235(ft)
THE AVERAGE COMBINED GRID FACTOR USED ON THIS PROJECT (GROUND TO GRID) IS: 1.0001574709
THE N.C. LAMBERT GRID BEARING AND LOCALIZED HORIZONTAL GROUND DISTANCE FROM "BR01602" TO -L- STATION 10+00.00 IS S 15-51°00.76" E 550.21(ft)
ALL LINEAR DIMENSIONS ARE LOCALIZED HORIZONTAL DISTANCES
VERTICAL DATUM USED IS NAVD 88

Prepared in the Office of:
LOCATION AND SURVEYS UNIT
DIVISION 3
5310 BARBADOS BLVD., SUITE 102
CASTLE HAYNE, N.C. 28429

2018 STANDARD SPECIFICATIONS

RIGHT OF WAY DATE:
FEBRUARY 17, 2022

LETTING DATE:
MAY 16, 2023

PROFESSIONAL LAND SURVEYOR

DocuSigned by:
Christopher J. Sumner 02/22/2023
SIGNATURE: _____ Date: _____

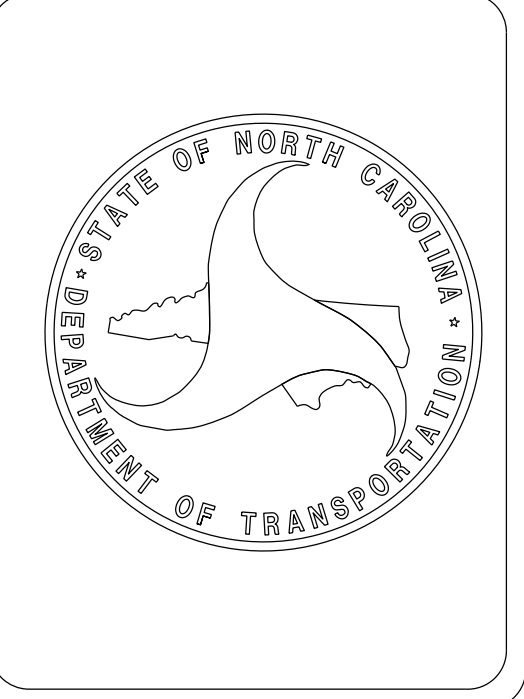

09/08/99
21-FEB-2023 16:09
S:\Units\Div03\Projects\BRIDG\Brunswick\BR-0160_0015\Working\Control Sheets\BR0160_Is_r_w01.dgn
midval AT LS-328725L