

**STATE OF NORTH CAROLINA  
DIVISION OF HIGHWAYS**

PROJ. REFERENCE NO.

SHEET NO.

BR-0073

X1-A

NOTE: EMBANKMENT COLUMN DOES NOT INCLUDE BACKFILL FOR UNDERCUT

**CROSS-SECTION SUMMARY**

APPROXIMATE QUANTITIES ONLY. CLEARING AND GRUBBING, UNCLASSIFIED EXCAVATION, FINE GRADING, REMOVAL OF EXISTING PAVEMENT, AND BREAKING OF EXISTING PAVEMENT WILL BE PAID FOR AT THE LUMP SUM PRICE FOR "GRADING".

Station	Uncl. Exc.	Embt
L	(cu. yd.)	(cu. yd.)
12+30.00	0	0
12+50.00	25	1
13+00.00	20	3
13+50.00	8	49
14+00.00	3	135
14+50.00	10	218
15+00.00	12	245
15+50.00	8	287
16+00.00	10	325
16+50.00	16	351
17+00.00	20	379
17+42.00	6	139

Station	Uncl. Exc.	Embt
L	(cu. yd.)	(cu. yd.)
19+07.00	0	0
19+50.00	10	618
20+00.00	21	559
20+50.00	10	533
21+00.00	1	477
21+50.00	0	355
22+00.00	4	269
22+50.00	64	166
23+00.00	58	36
23+17.00	0	0

Station	Uncl. Exc.	Embt
DR1	(cu. yd.)	(cu. yd.)
10+14.00	0	0
10+50.00	0	25
11+00.00	3	42
11+50.00	5	160
12+00.00	1	229
12+50.00	3	202
12+55.17	1	17

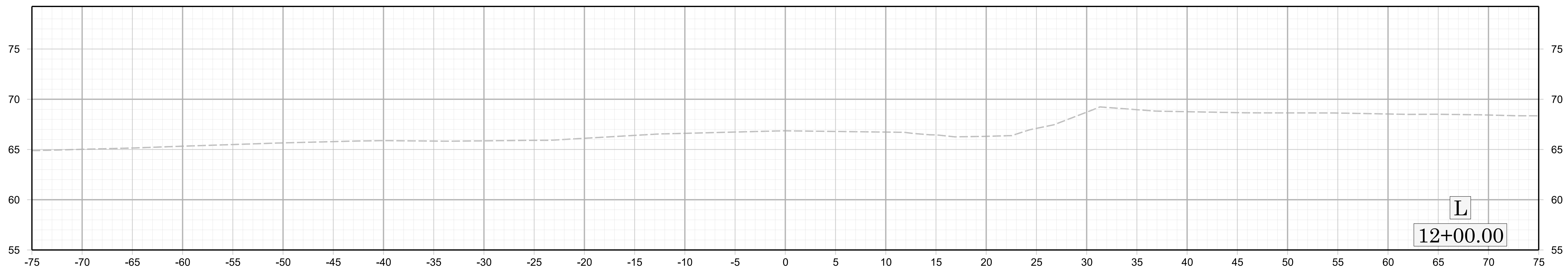
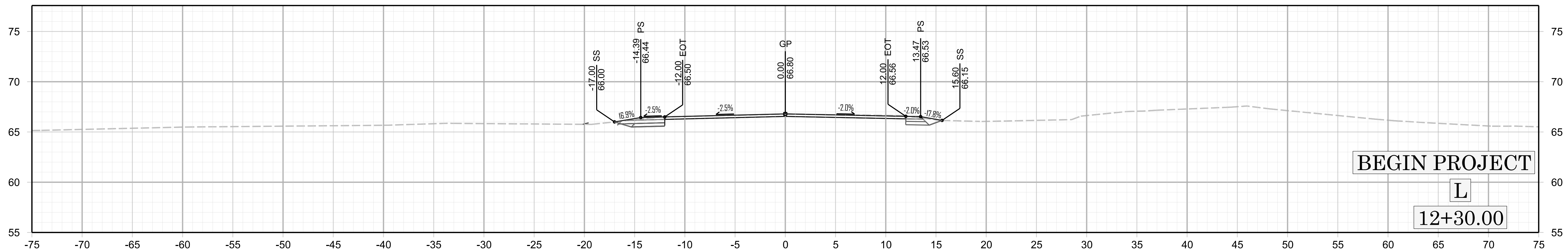
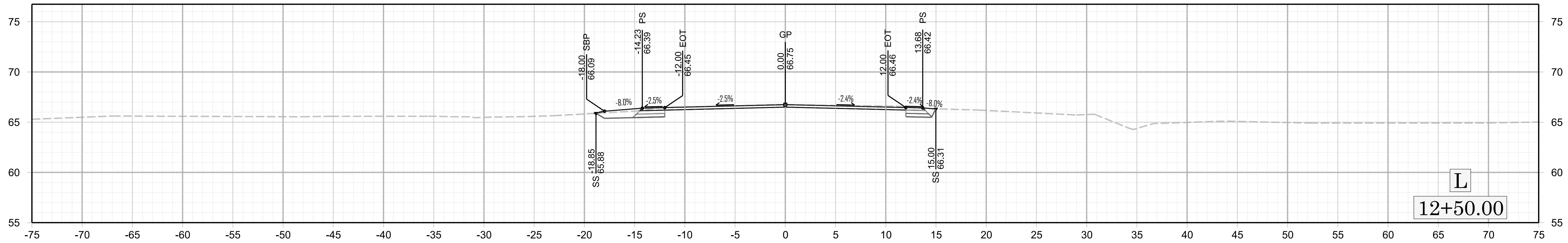
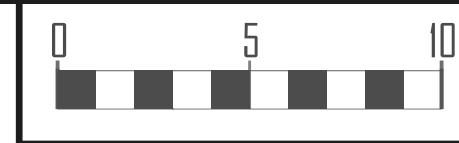

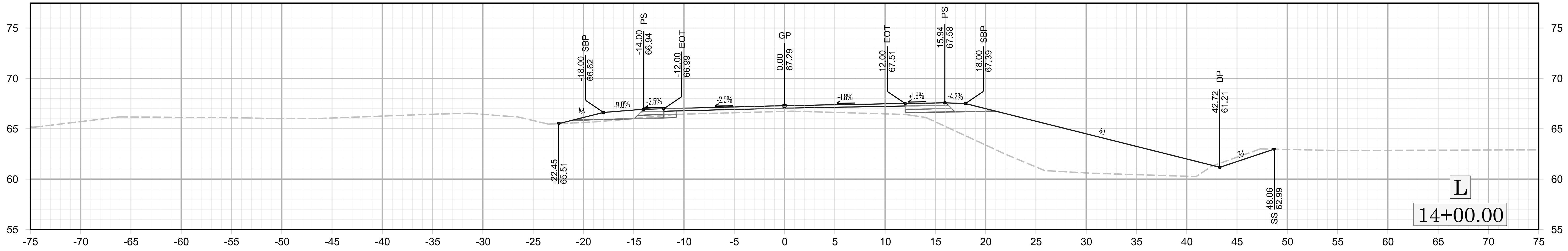
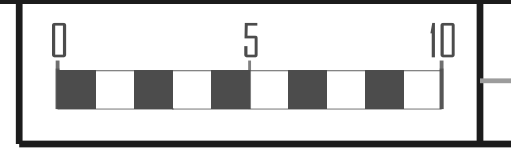

L  
14+00.00

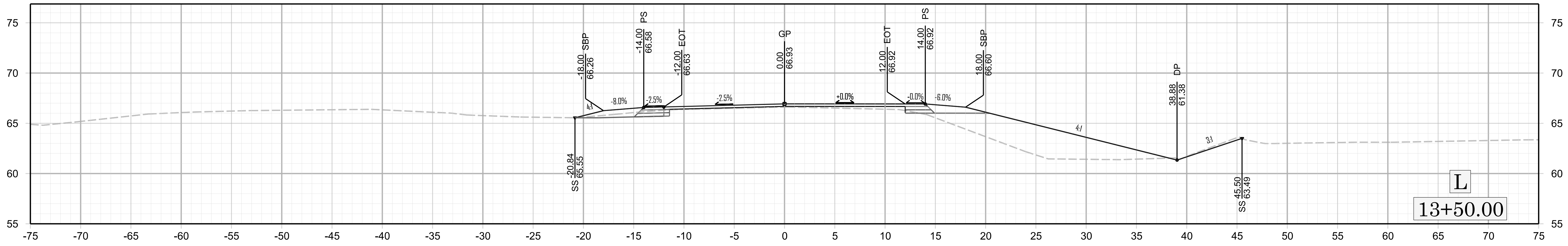

L  
13+50.00

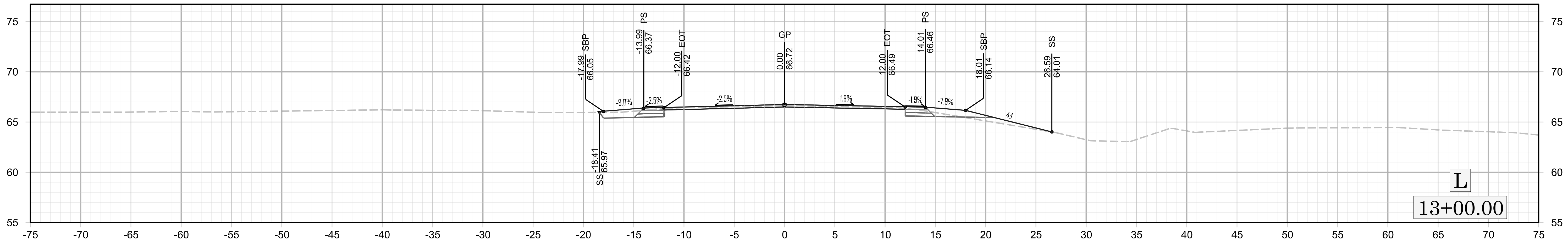

L  
13+00.00

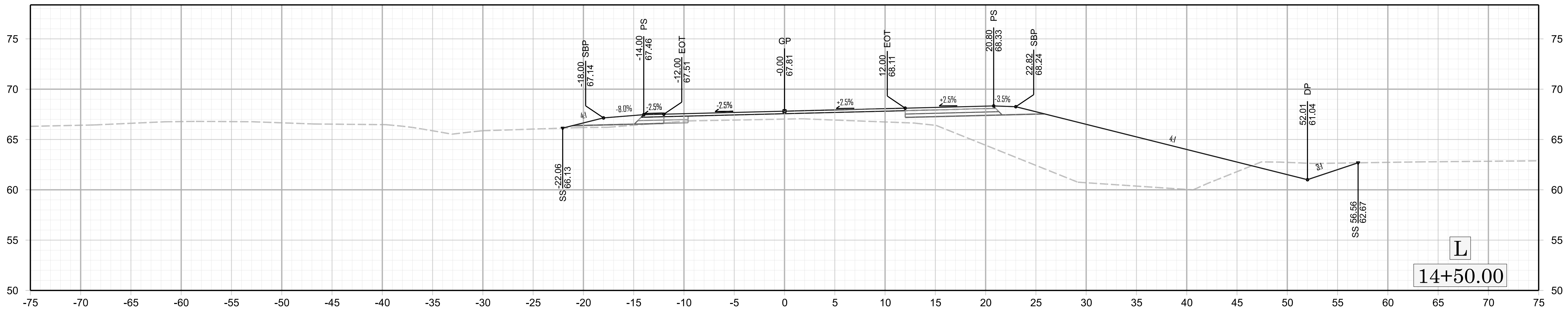
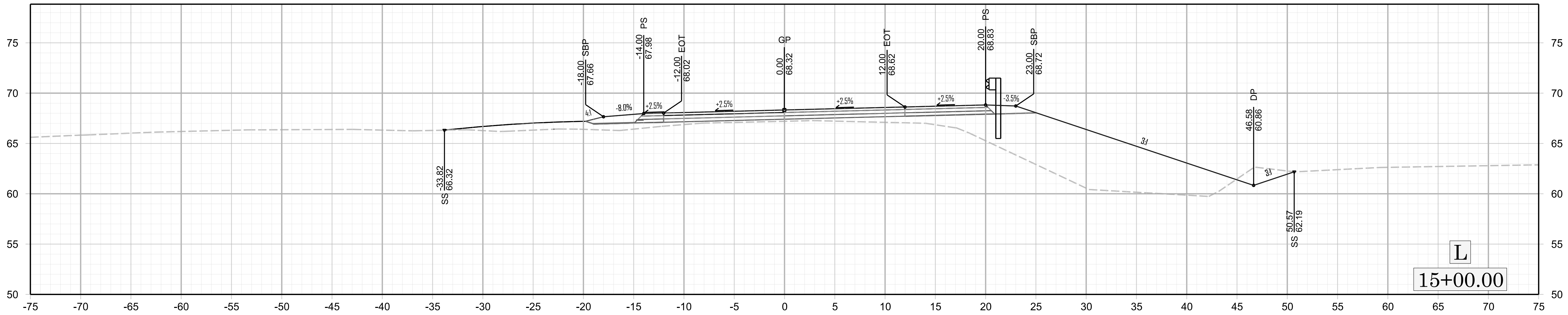
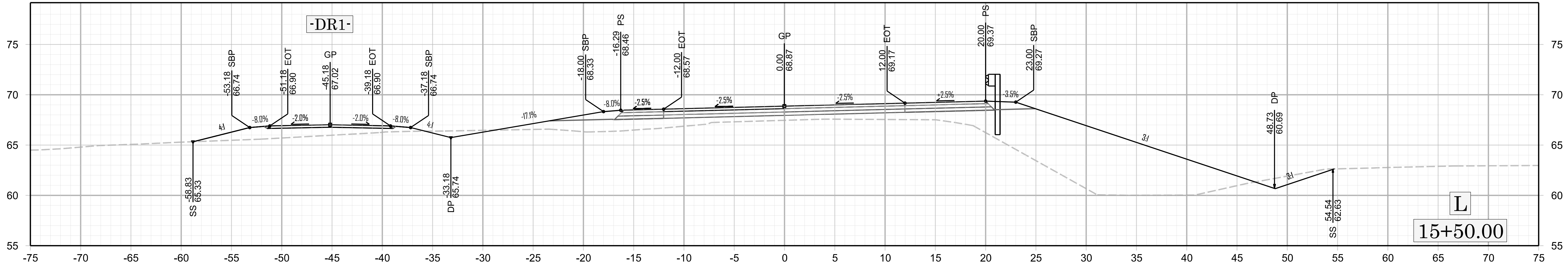
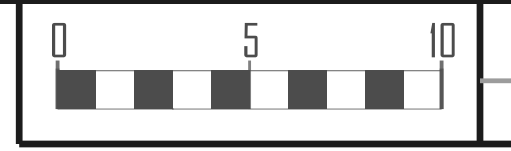

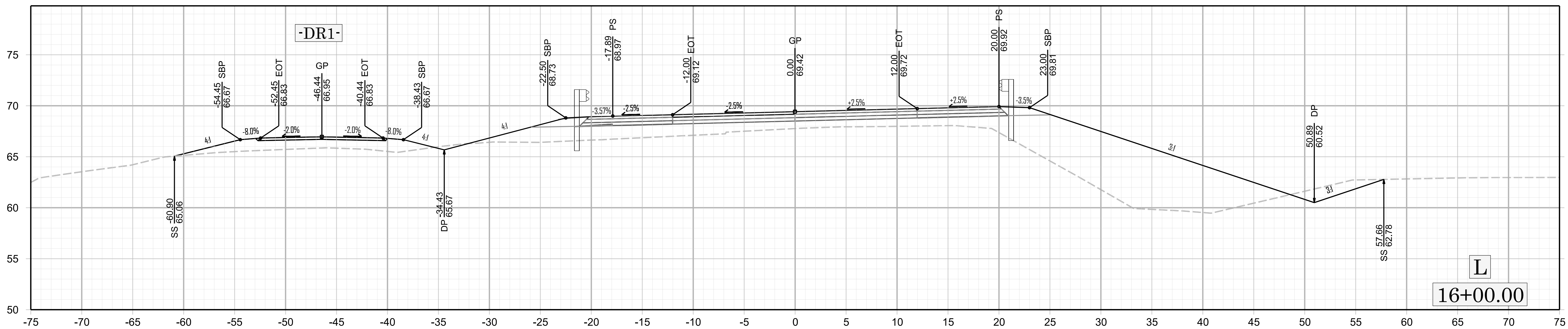
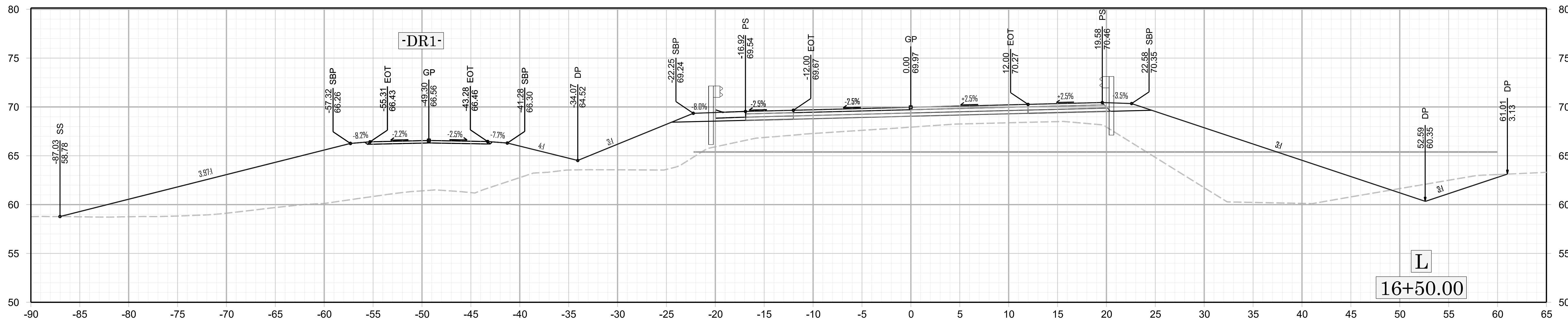
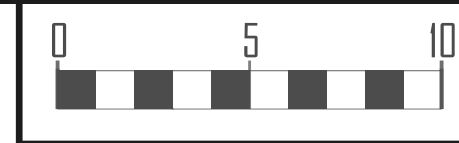

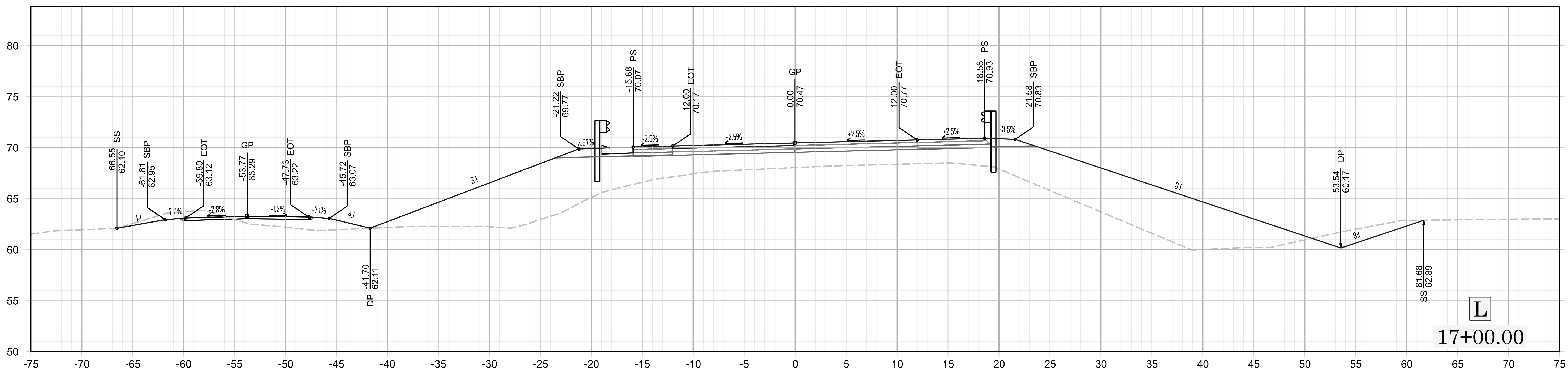
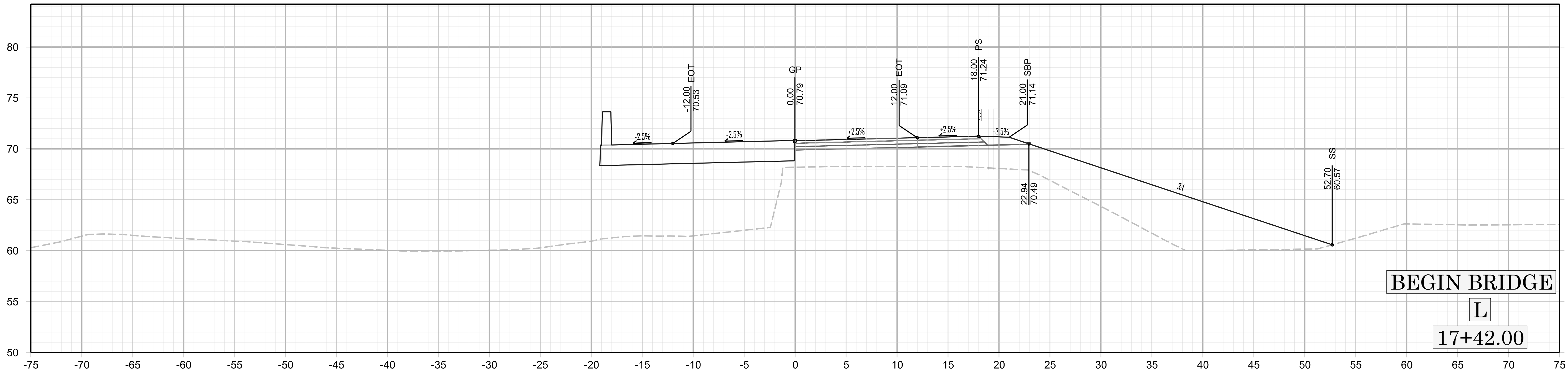
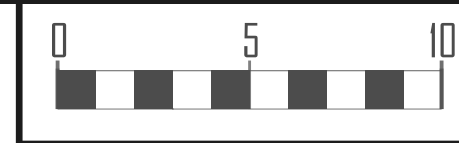

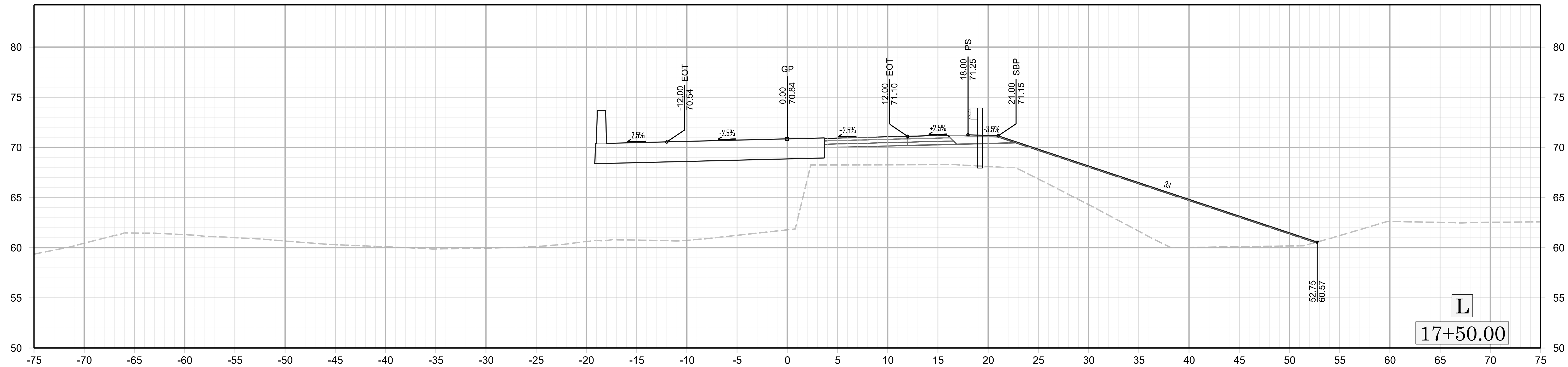
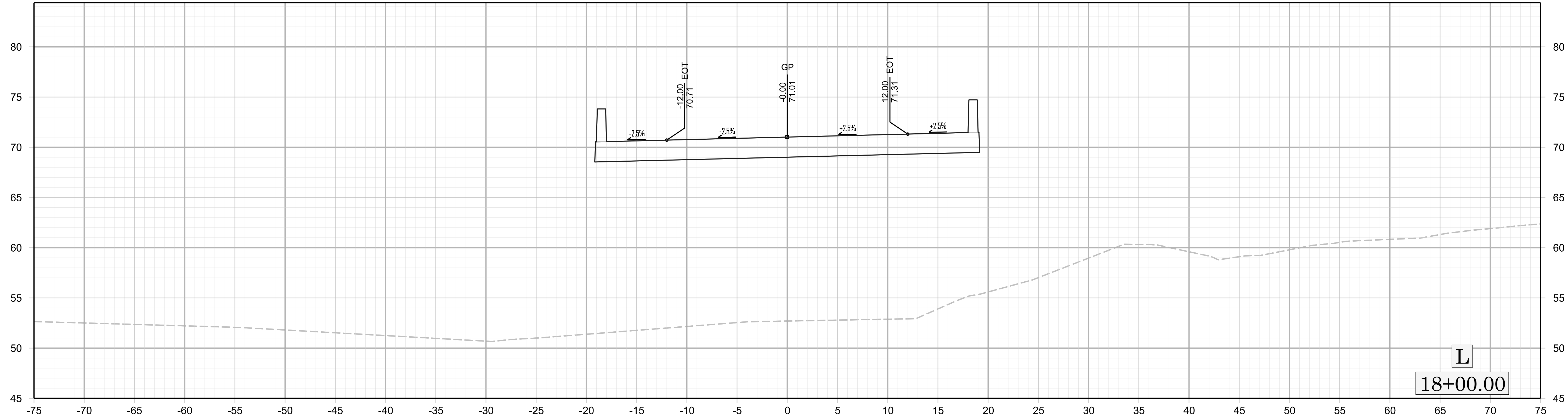
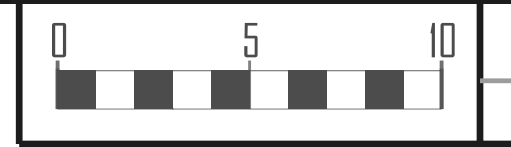

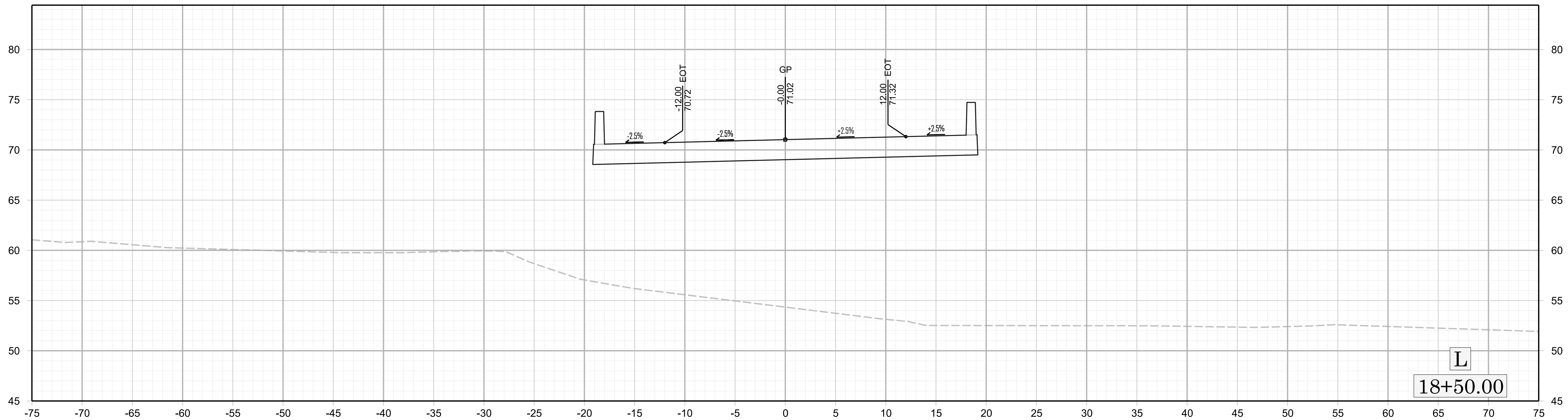
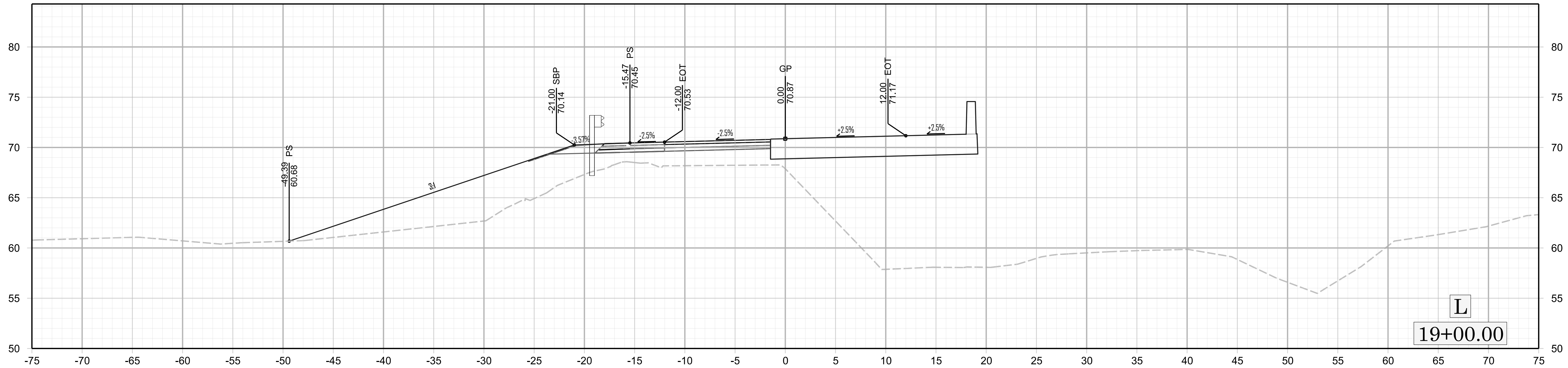
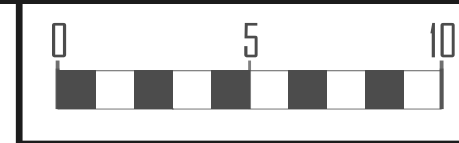



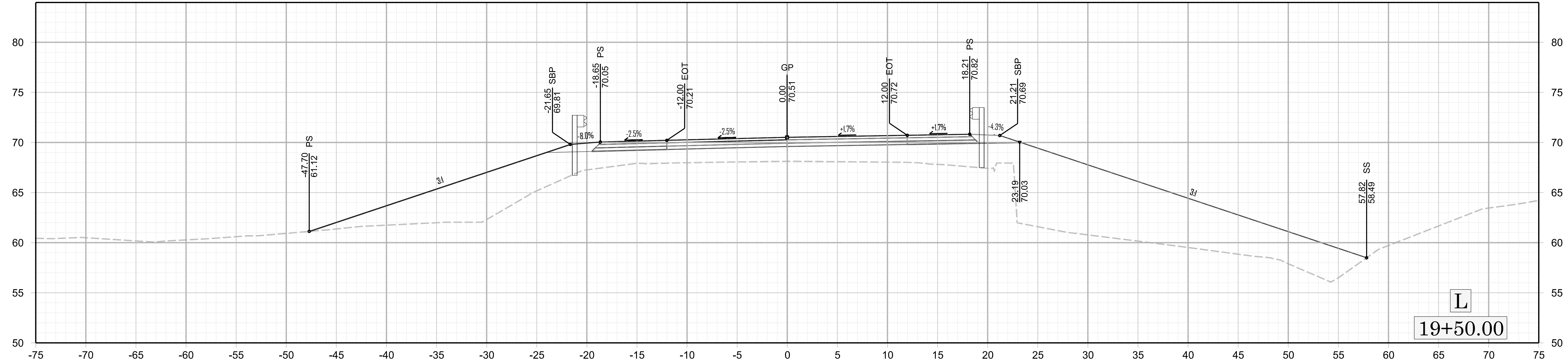
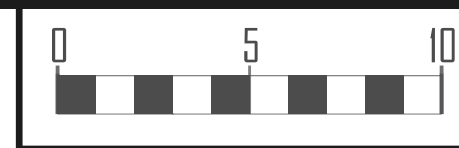

L  
19+50.00

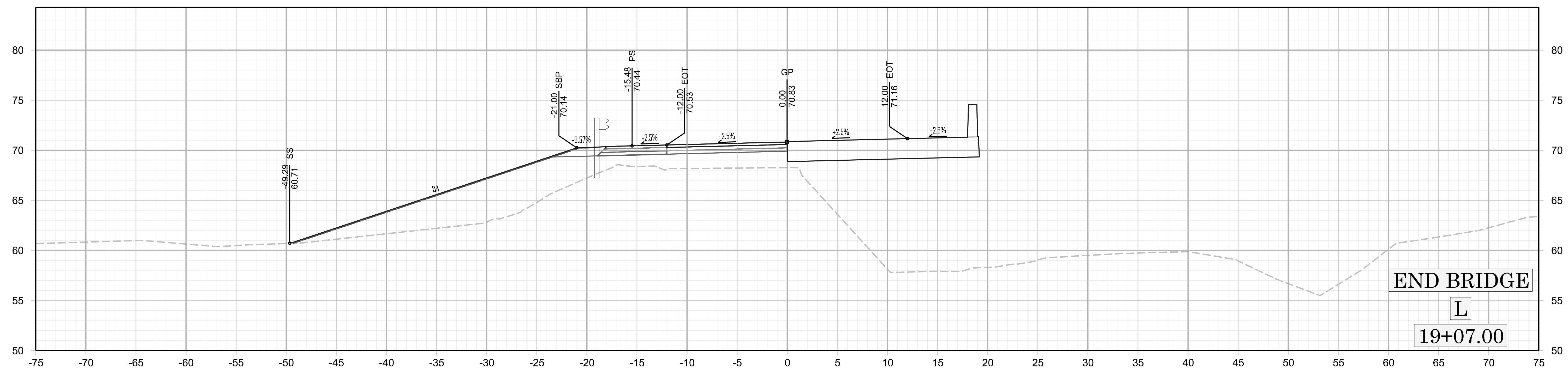

END BRIDGE  
L  
19+07.00

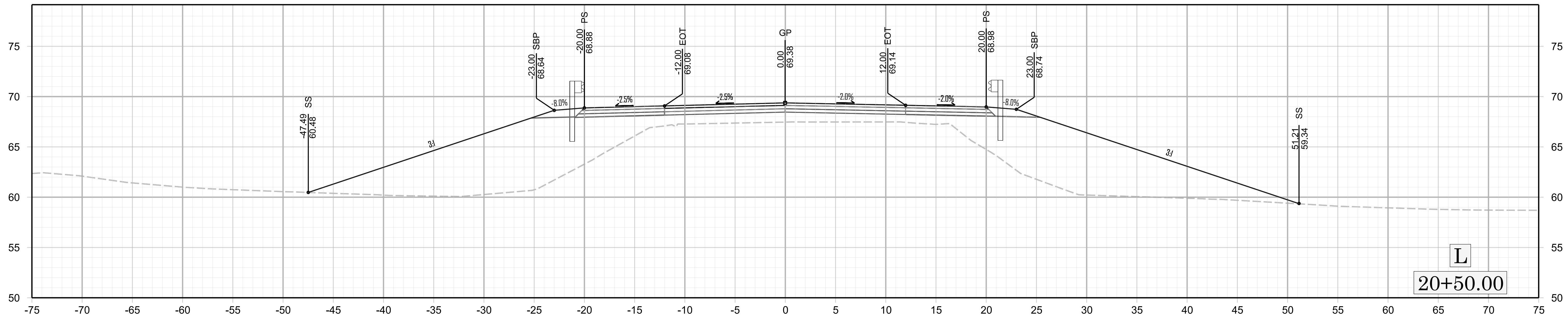
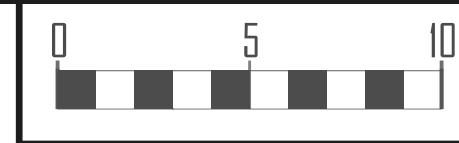

L  
20+50.00

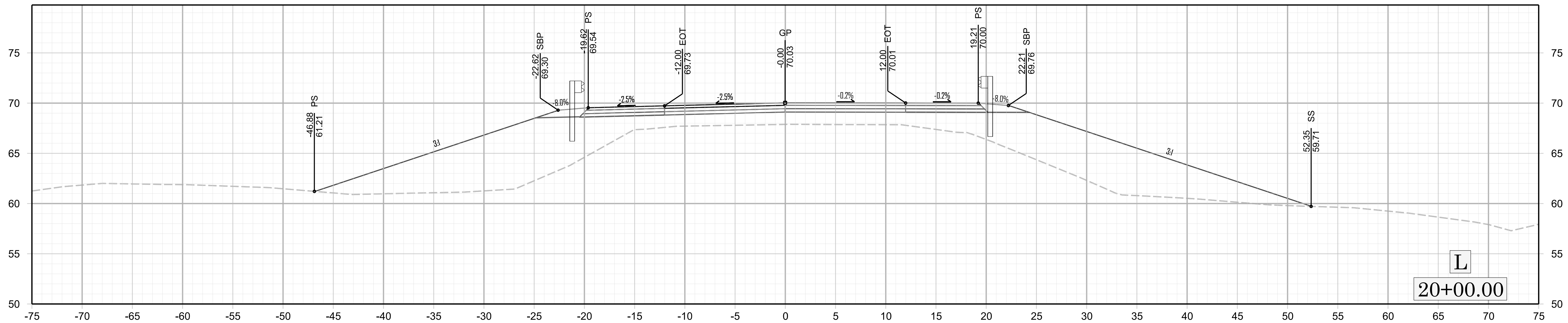

L  
20+00.00

