

SPAN F

SPAN E

BOTTOM OF CAP @ BENT 4

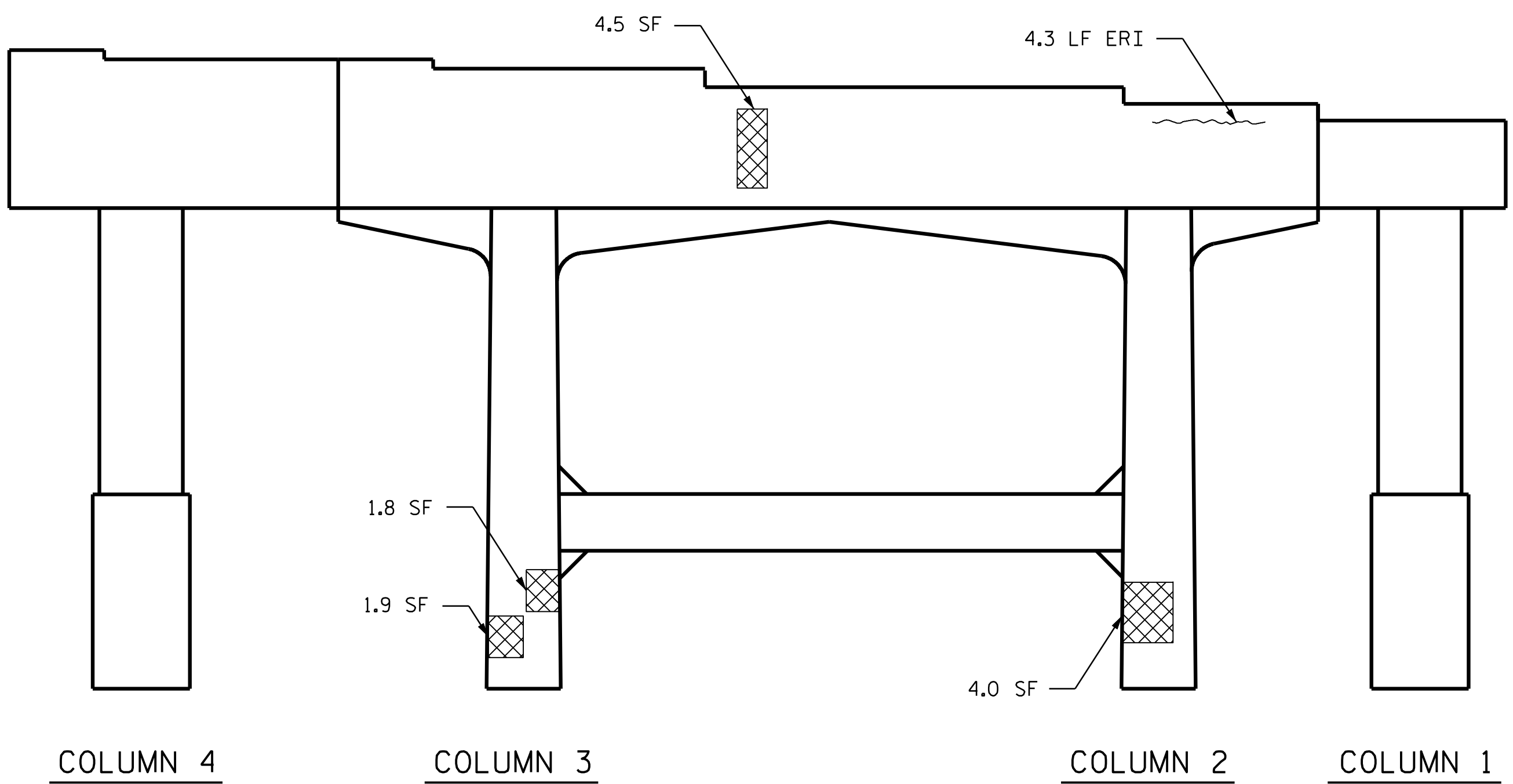

ELEVATION @ BENT 4 (SPAN E)

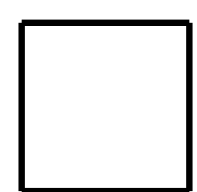

END OF CAP  
(J-J)

**AS-BUILT REPAIR QUANTITY TABLE**

REPAIRS BENT 5	QUANTITIES			
	ESTIMATE		ACTUAL	
SHOTCRETE REPAIRS	AREA SF	VOLUME CF	AREA SF	VOLUME CF
CAP	17.0	8.5		
COLUMN	9.7	4.9		
CONCRETE REPAIRS	AREA SF	VOLUME CF	AREA SF	VOLUME CF
CAP	0.0	0.0		
COLUMN	0.0	0.0		
EPOXY RESIN INJECTION		LN. FT.	LN. FT.	
CAP		4.3		
COLUMN		0.0		
EPOXY COATING		SQ. FT.	SQ. FT.	
TOP OF BENT CAP		195.0		

VALUES IN CHART REPRESENT ESTIMATED REPAIR TOTALS AFTER REMOVAL OF UNSOUND CONCRETE, MIN. OF 1" BEHIND REBAR AND 2" MIN. CLEAR TO SAWCUT.

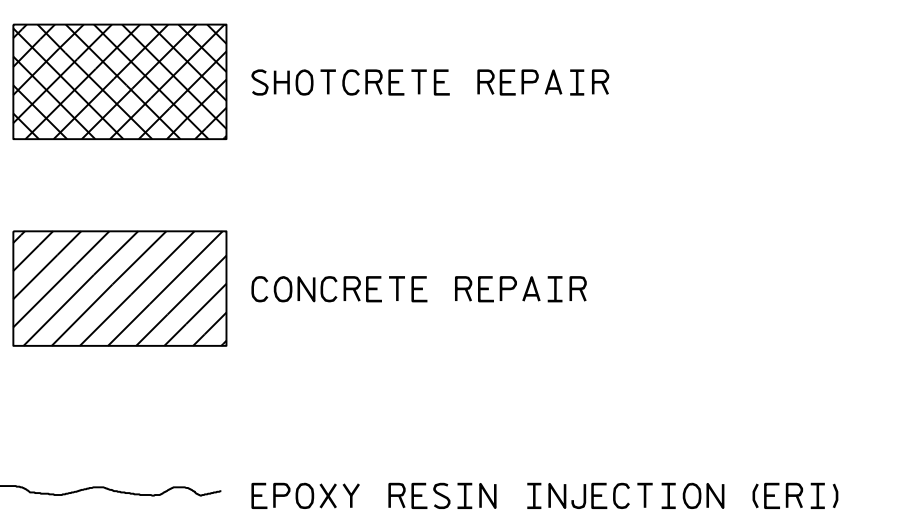

PROJECT NO. I-5927  
POLK COUNTY  
 BRIDGE NO. 740048

SHEET 2 OF 2



STATE OF NORTH CAROLINA  
 DEPARTMENT OF TRANSPORTATION  
 RALEIGH

**BENT 5  
 (SPAN F)**

**VOLKERT**  
 5540 Centerview Drive, Suite 305  
 Raleigh, NC 27606  
 Tel. 919-854-0344 Fax. 919-854-0355  
 NC License No. F-0765

DOCUMENT NOT CONSIDERED  
 FINAL UNLESS ALL  
 SIGNATURES COMPLETED

REVISIONS						SHEET NO.
NO.	BY:	DATE:	NO.	BY:	DATE:	S-51
1			3			TOTAL SHEETS
2			4			79

DRAWN BY : D. A. GLADDEN DATE : 5/21  
 CHECKED BY : E. MURRAY DATE : 12/22