

SPAN C

SPAN D

BOTTOM OF CAP @ BENT 3

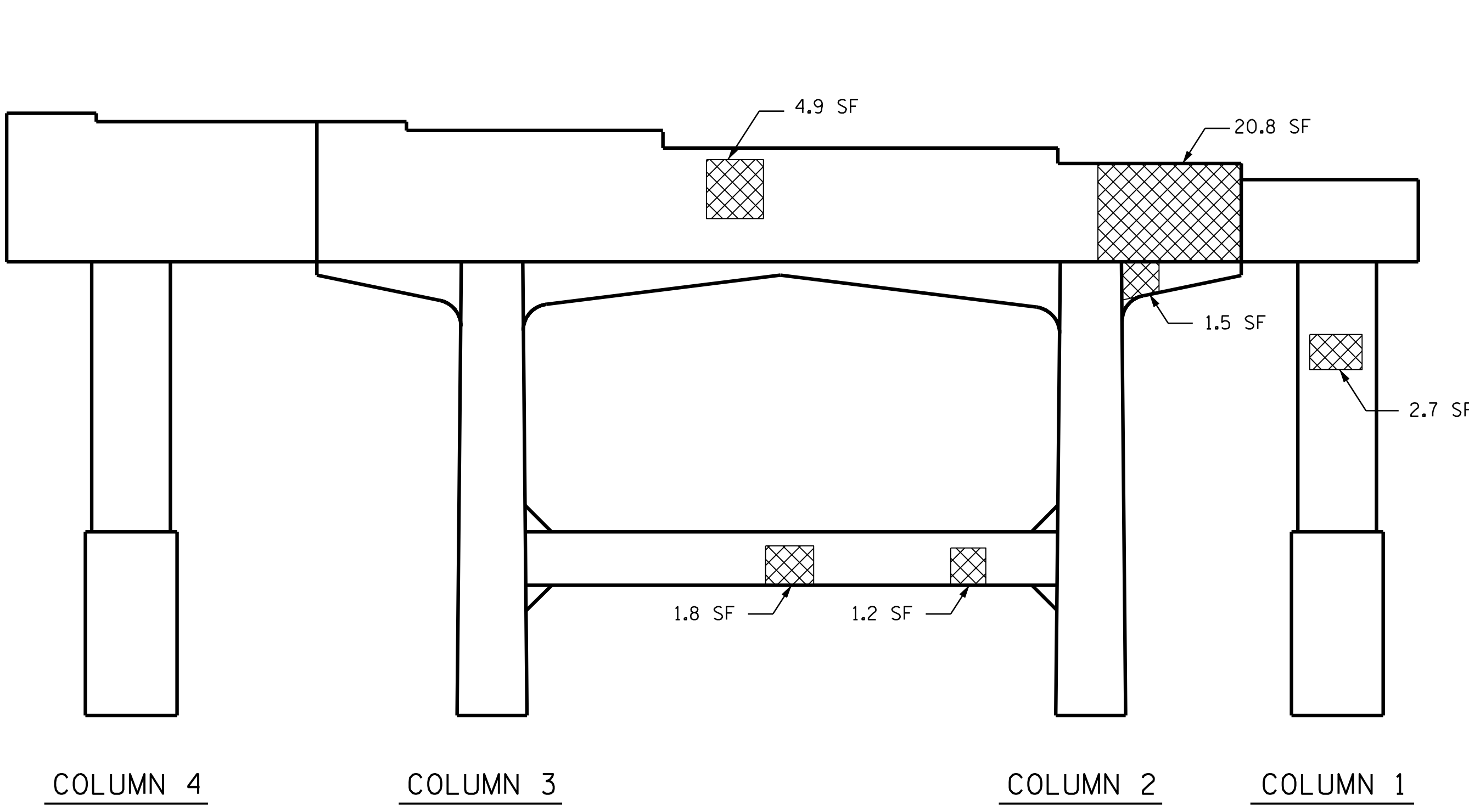

END OF CAP  
(F-F)

**AS-BUILT REPAIR QUANTITY TABLE**

REPAIRS BENT 3	QUANTITIES			
	ESTIMATE		ACTUAL	
<b>SHOTCRETE REPAIRS</b>	AREA SF	VOLUME CF	AREA SF	VOLUME CF
CAP	25.7	12.9		
COLUMN	23.5	11.8		
<b>CONCRETE REPAIRS</b>	AREA SF	VOLUME CF	AREA SF	VOLUME CF
CAP	0.0	0.0		
COLUMN	0.0	0.0		
<b>EPOXY RESIN INJECTION</b>		LN. FT.		LN. FT.
CAP		0.0		
COLUMN		0.0		
<b>EPOXY COATING</b>		SO. FT.		SO. FT.
TOP OF BENT CAP		186.9		

VALUES IN CHART REPRESENT ESTIMATED REPAIR TOTALS AFTER REMOVAL OF UNSOUND CONCRETE, MIN. OF 1" BEHIND REBAR AND 2" MIN. CLEAR TO SAWCUT.

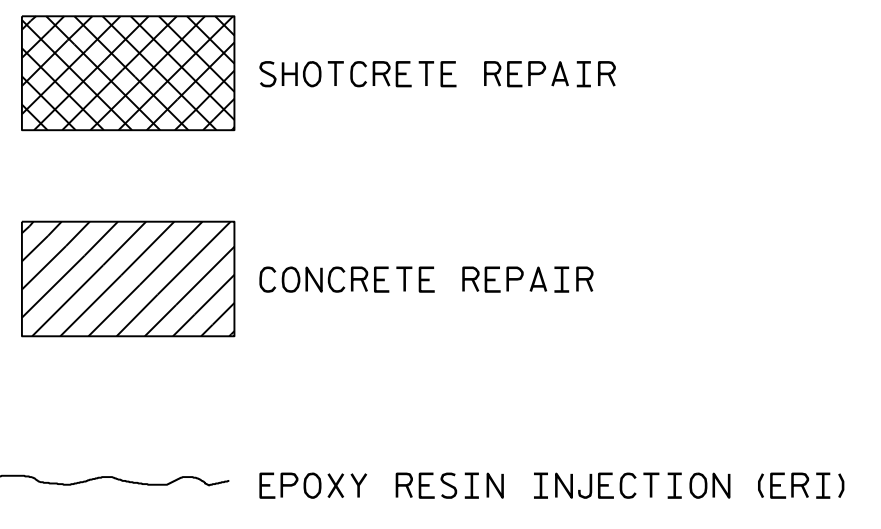

ELEVATION @ BENT 3 (SPAN D)

PROJECT NO. I-5927  
POLK COUNTY  
 BRIDGE NO. 740048

SHEET 2 OF 2



STATE OF NORTH CAROLINA  
 DEPARTMENT OF TRANSPORTATION  
 RALEIGH

**BENT 3  
 (SPAN D)**

**VOLKERT**  
 5540 Centerview Drive, Suite 305  
 Raleigh, NC 27606  
 Tel. 919-854-0344 Fax. 919-854-0355  
 NC License No. F-0765

DOCUMENT NOT CONSIDERED FINAL UNLESS ALL SIGNATURES COMPLETED

REVISIONS						SHEET NO.
NO.	BY:	DATE:	NO.	BY:	DATE:	S-47
1			3			TOTAL SHEETS
2			4			79

DRAWN BY : D. A. GLADDEN DATE : 5/21  
 CHECKED BY : E. MURRAY DATE : 12/22