

### TRAFFIC CONTROL PHASING NOTES:

#### PHASE I (SR 1516):

1. USE TMP-10, TMP-11, ROADWAY STANDARD DRAWINGS (RSD) 1101.02 SHEET 1 OF 14 AND RSD 1101.01 SHEET 3 OF 3, TO PLACE ADVANCED WARNING SIGNS AND TRAFFIC CONTROL DEVICES.
2. COMPLETE PHASE I BRIDGE WORK.
3. REMOVE ALL TRAFFIC CONTROL DEVICES. COVER OR REMOVE ALL ADVANCED WARNING SIGNS AND RETURN TRAFFIC TO EXISTING PATTERN.

#### PHASE II (SR 1516):

1. USE TMP-10, TMP-12, ROADWAY STANDARD DRAWINGS (RSD) 1101.02 SHEET 1 OF 14 AND RSD 1101.01 SHEET 3 OF 3, TO PLACE ADVANCED WARNING SIGNS AND TRAFFIC CONTROL DEVICES.
2. COMPLETE STAGE II BRIDGE WORK.
3. REMOVE ALL TRAFFIC CONTROL DEVICES. COVER OR REMOVE ALL ADVANCED WARNING SIGNS AND RETURN TRAFFIC TO EXISTING PATTERN.

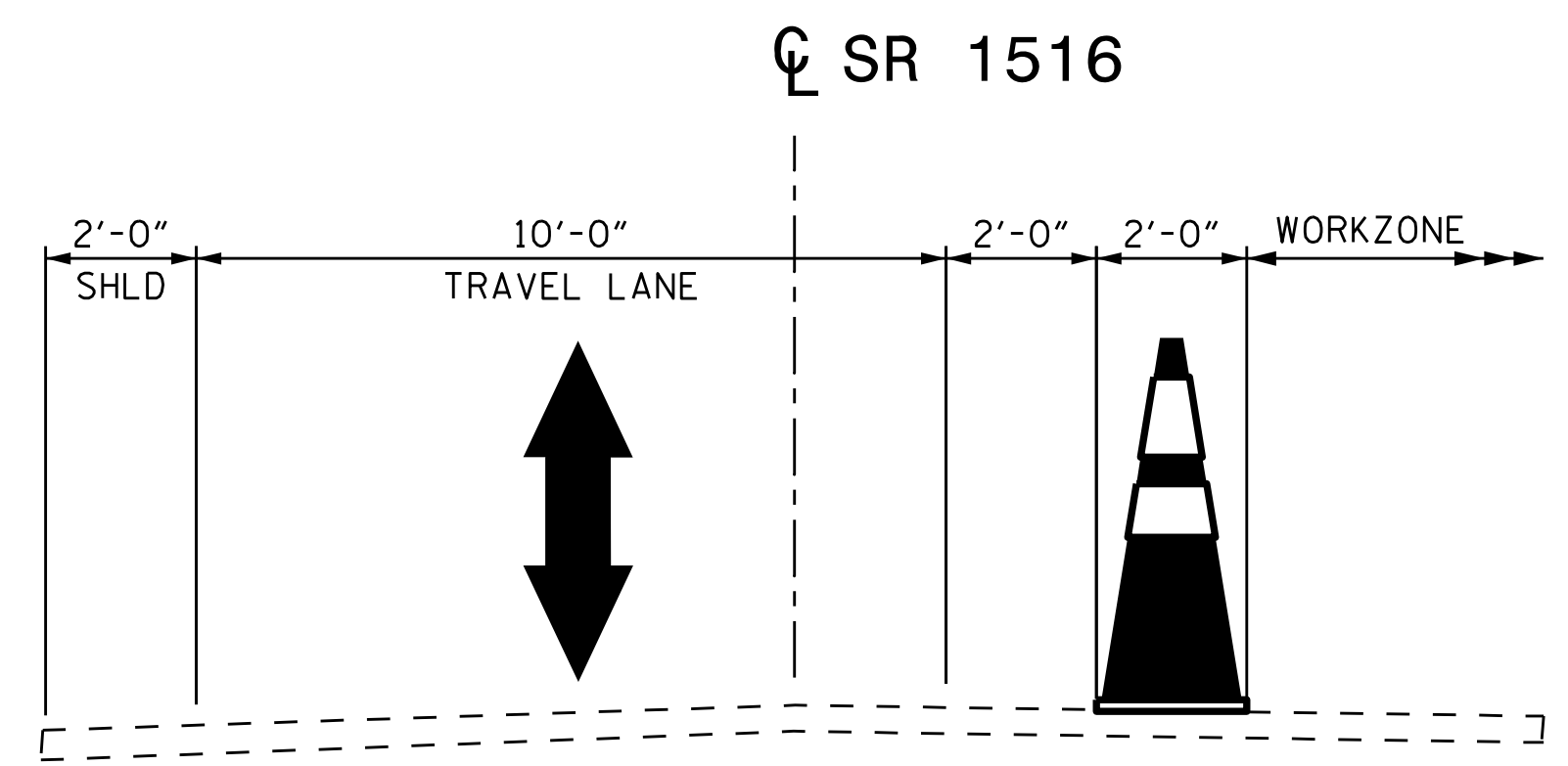

**TYPICAL SECTION - PHASE I (SR-1516)**

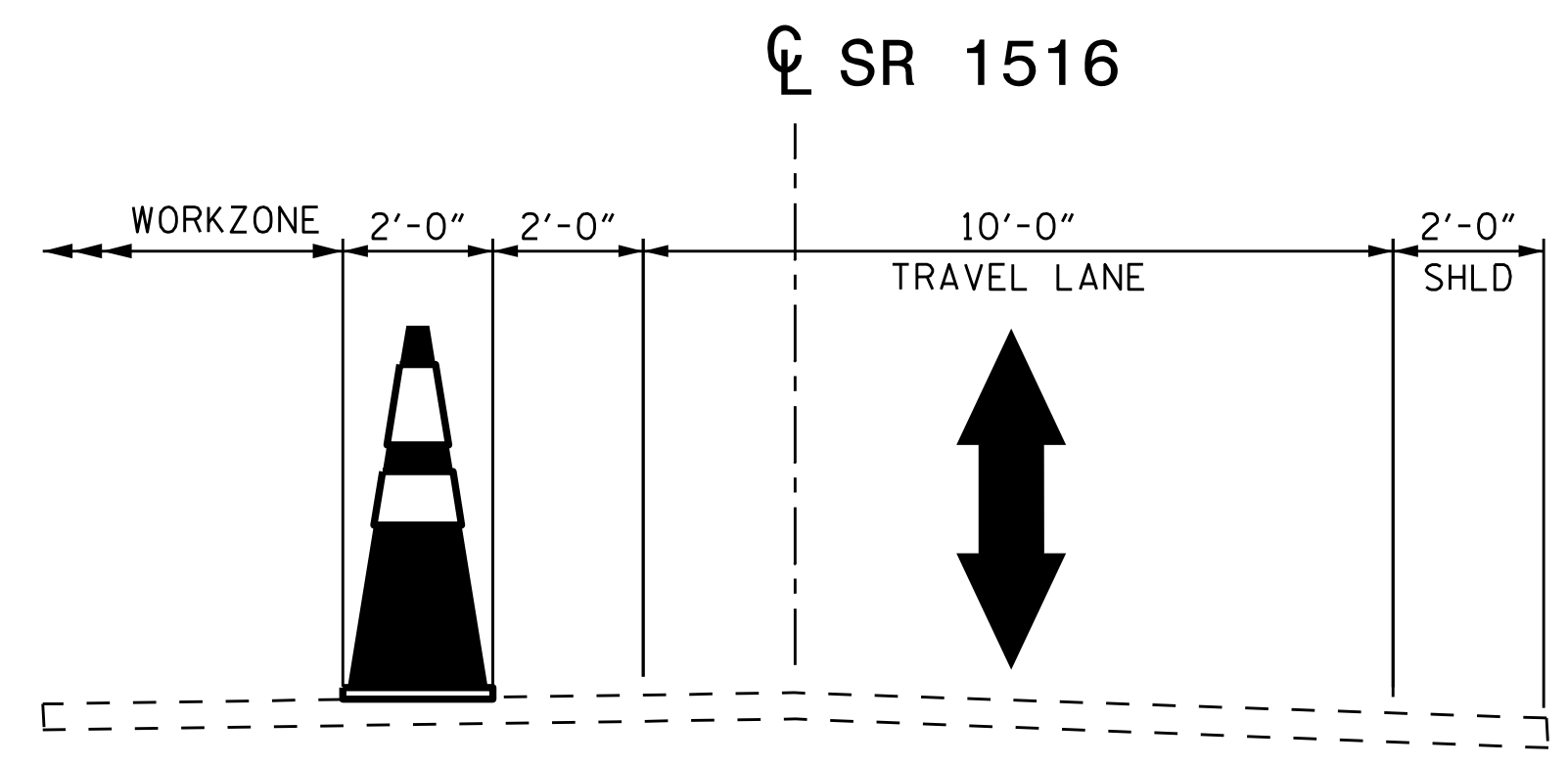

**TYPICAL SECTION - PHASE II (SR-1516)**

23 JAN 2023 14:16 C:\Users\paul\Documents\Projects\I0420160 I-5927 Polk County Bridge Preservation\WZTC\I-5927 POLK.WZTC.TMP-10.dgn

**VOLKERT**  
 5430 Wade Park Blvd., Suite 410  
 Raleigh, NC 27607  
 Tel. 919-854-0344 Fax. 919-854-0355  
 NC License No. F-0785

APPROVED: \_\_\_\_\_  
 DATE: \_\_\_\_\_

SEAL 1/23/2023  
 Documented by  
 Patrick N. Holder  
 31822A298FC7473

**DOCUMENT NOT CONSIDERED FINAL  
 UNLESS ALL SIGNATURES COMPLETED**

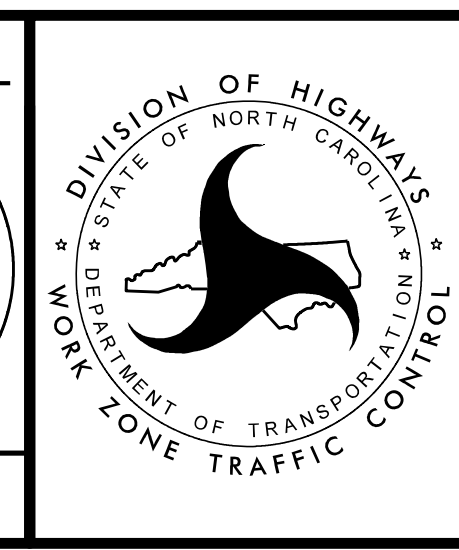

POLK COUNTY  
 BRIDGES 740048 & 740050

TYPICAL SECTION  
 PHASE I & II (SR 1516)