

LAYOUT FOR COMPUTING AREA OF REINFORCED CONCRETE DECK SLAB
(SQ. FT. = 8,056)

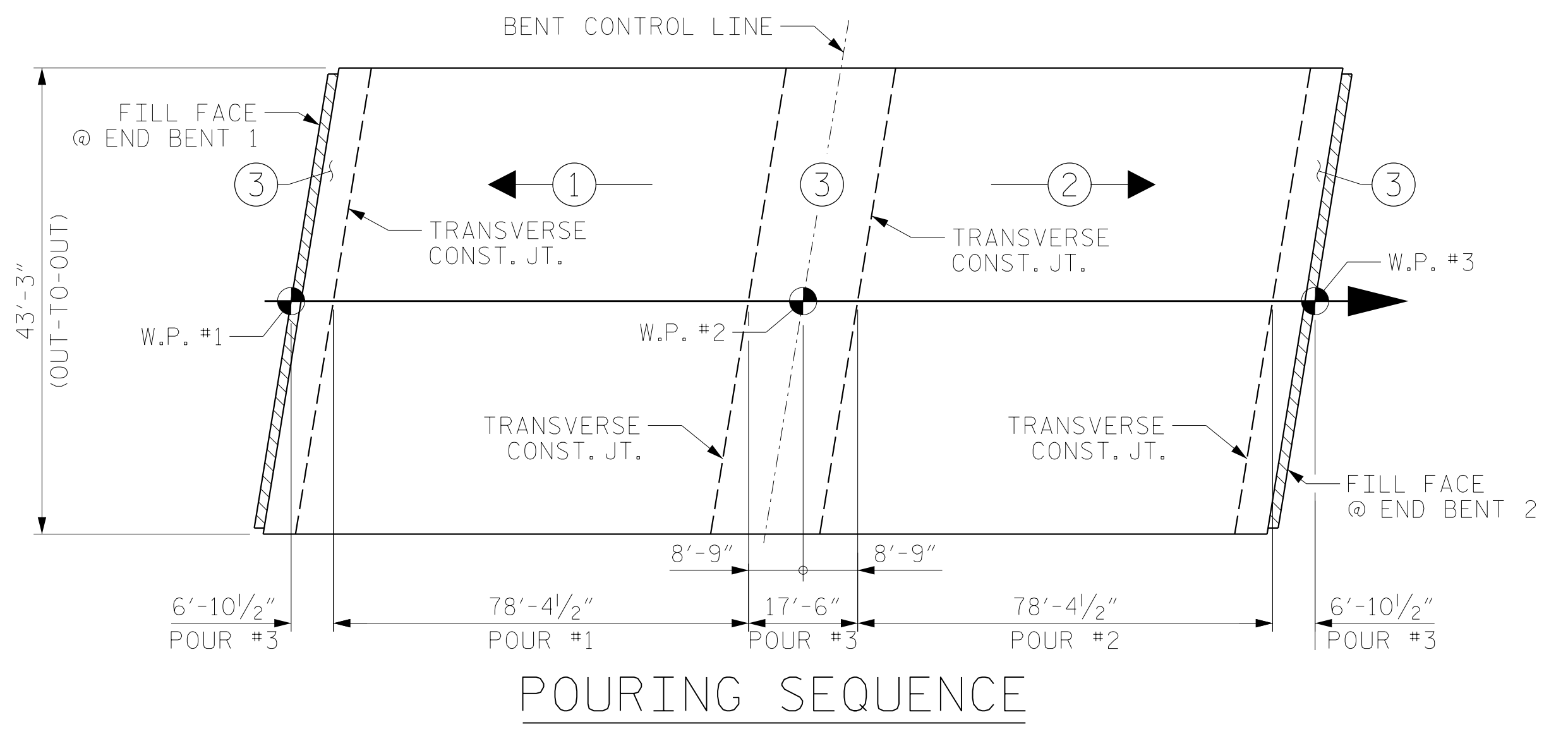

POURING SEQUENCE

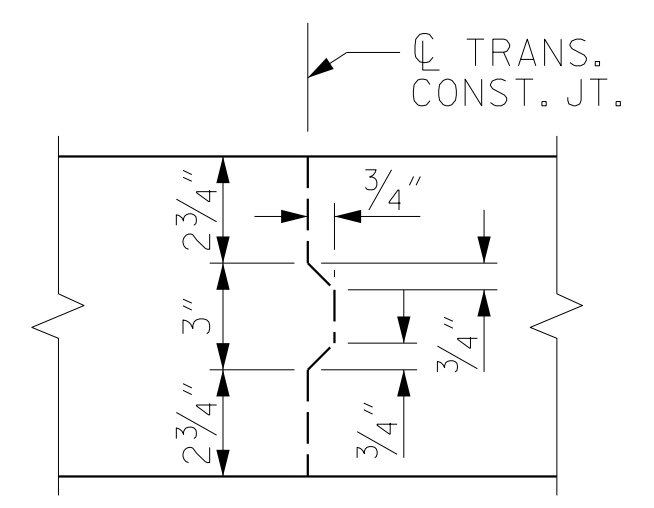

TRANSVERSE CONSTRUCTION JOINT DETAIL

REINFORCING STEEL IN SLAB NOT SHOWN. LONGITUDINAL REINFORCEMENT SHALL BE CONTINUOUS THROUGH JOINT.

SUPERSTRUCTURE REINFORCING STEEL LENGTHS ARE BASED ON THE FOLLOWING MINIMUM SPLICE LENGTHS

BAR SIZE	SUPERSTRUCTURE EXCEPT APPROACH SLABS, PARAPET, AND BARRIER RAIL		APPROACH SLABS		PARAPET AND BARRIER RAIL
	EPOXY COATED	UNCOATED	EPOXY COATED	UNCOATED	
#4	1'-11"	1'-7"	1'-11"	1'-7"	2'-6"
#5	2'-5"	2'-0"	2'-5"	2'-0"	3'-1"
#6	2'-10"	2'-5"	3'-7"	2'-5"	3'-8"
#7	4'-2"	2'-9"			
#8	4'-9"	3'-2"			

GROOVING BRIDGE FLOORS

APPROACH SLABS	1,814 SQ.FT.
BRIDGE DECK	6,891 SQ.FT.
TOTAL	8,705 SQ.FT.

CLASS AA CONCRETE

	CU. YDS.
POUR 1	104.1
POUR 2	104.1
POUR 3	95.6
TOTALS**	303.8

**QUANTITIES FOR BARRIER RAIL ARE NOT INCLUDED.

REINFORCING BAR SCHEDULE

BAR NO.	NO.	SIZE	TYPE	LENGTH	WEIGHT	BAR NO.	NO.	SIZE	TYPE	LENGTH	WEIGHT
*A101	2	#5	STR.	2'-0"	4	A208	2	#5	STR.	12'-10"	27
*A102	2	#5	STR.	3'-7"	7	A209	2	#5	STR.	14'-4"	30
*A103	2	#5	STR.	5'-1"	11	A210	2	#5	STR.	15'-10"	33
*A104	2	#5	STR.	6'-8"	14	A211	2	#5	STR.	17'-5"	36
*A105	2	#5	STR.	8'-2"	17	A212	2	#5	STR.	18'-11"	39
*A106	2	#5	STR.	9'-9"	20	A213	2	#5	STR.	20'-6"	43
*A107	2	#5	STR.	11'-3"	23	A214	2	#5	STR.	22'-0"	46
*A108	2	#5	STR.	12'-10"	27	A215	2	#5	STR.	23'-7"	49
*A109	2	#5	STR.	14'-4"	30	A216	2	#5	STR.	25'-1"	52
*A110	2	#5	STR.	15'-10"	33	A217	2	#5	STR.	26'-8"	56
*A111	2	#5	STR.	17'-5"	36	A218	2	#5	STR.	28'-2"	59
*A112	2	#5	STR.	18'-11"	39	A219	2	#5	STR.	29'-9"	62
*A113	2	#5	STR.	20'-6"	43	A220	2	#5	STR.	31'-3"	65
*A114	2	#5	STR.	22'-0"	46	A221	2	#5	STR.	32'-10"	68
*A115	2	#5	STR.	23'-7"	49	A222	2	#5	STR.	34'-4"	72
*A116	2	#5	STR.	25'-1"	52	A223	2	#5	STR.	35'-11"	75
*A117	2	#5	STR.	26'-8"	56	A224	2	#5	STR.	37'-5"	78
*A118	2	#5	STR.	28'-2"	59	A225	2	#5	STR.	38'-11"	81
*A119	2	#5	STR.	29'-9"	62	A226	2	#5	STR.	40'-6"	84
*A120	2	#5	STR.	31'-3"	65	A227	2	#5	STR.	42'-0"	88
*A121	2	#5	STR.	32'-10"	68	A228	344	#5	STR.	42'-11"	15398
*A122	2	#5	STR.	34'-4"	72						
*A123	2	#5	STR.	35'-11"	75	*B1	174	#6	STR.	19'-0"	4966
*A124	2	#5	STR.	37'-5"	78	*B2	180	#4	STR.	23'-3"	2796
*A125	2	#5	STR.	38'-11"	81	*B3	45	#6	STR.	9'-4"	631
*A126	2	#5	STR.	40'-6"	84	*B4	42	#6	STR.	38'-4"	2418
*A127	2	#5	STR.	42'-0"	88	*B5	45	#6	STR.	60'-0"	4055
*A128	344	#5	STR.	42'-11"	15398	B6	216	#5	STR.	34'-1"	7679
						B7	54	#4	STR.	40'-0"	1443
A201	2	#5	STR.	2'-0"	4	B8	46	#4	STR.	40'-0"	1229
A202	2	#5	STR.	3'-7"	7	B9	46	#4	STR.	9'-3"	284
A203	2	#5	STR.	5'-1"	11	B10	54	#4	STR.	18'-7"	670
A204	2	#5	STR.	6'-8"	14						
A205	2	#5	STR.	8'-2"	17	K1	10	#5	STR.	43'-1"	449
A206	2	#5	STR.	9'-9"	20	K2	8	#5	STR.	7'-4"	61
A207	2	#5	STR.	11'-3"	23	K3	16	#5	STR.	8'-5"	140
						K4	8	#5	STR.	7'-7"	63
						K5	8	#5	STR.	6'-10"	57
						K6	8	#5	STR.	2'-7"	22
						K7	8	#5	STR.	3'-1"	26
						K8	4	#5	STR.	2'-4"	10
						*S1	64	#4	2	10'-11"	467
						*S2	64	#4	2	11'-11"	509
						U1	64	#5	1	11'-8"	779
						U2	4	#5	1	10'-10"	45

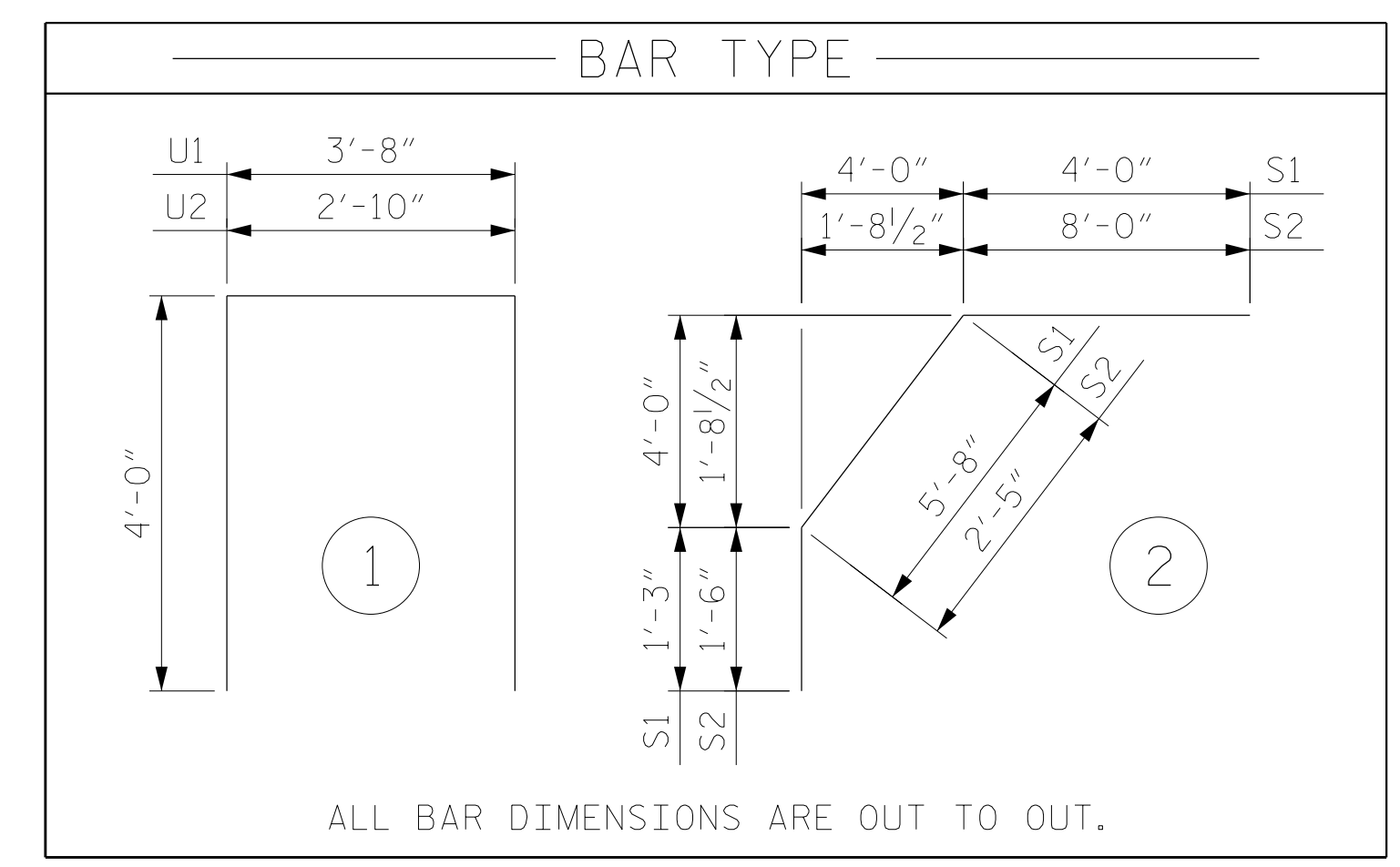

REINFORCING STEEL 29,594 LBS.
* EPOXY COATED
REINFORCING STEEL 32,479 LBS.

PROJECT NO. R-5751
ROBESON COUNTY
STATION: 37+99.89 -Y1B-

STATE OF NORTH CAROLINA DEPARTMENT OF TRANSPORTATION RALEIGH SUPERSTRUCTURE BILL OF MATERIAL											
REVISIONS										SHEET NO.	
NO.	BY:	DATE:	NO.	BY:	DATE:	S-17		TOTAL SHEETS		28	
1			3								
2			4								

DRAWN BY: TWL DATE: 10/2021
CHECKED BY: MRA DATE: 10/2021
DESIGN ENGINEER OF RECORD: MKO DATE: 10/2022

DOCUMENT NOT CONSIDERED FINAL UNLESS ALL SIGNATURES COMPLETED